

uponor

Product Catalogue 2020

Piping Systems For Marine
Applications



Water is our element

Ships are not only the largest moving vehicles in the world, but are an essential part of today's global economy. Water is their element – and so is ours.

With over 50 years of experience in engineered plastic pipes, Uponor's innovative pipe systems cover a multitude of uses in all industries. Uponor Marine Solutions stand for Uponor multilayer pipes, pipe components and flexible pipe systems suitable for use in marine applications. In most situations where you need to transport fluids, Uponor Marine Pipe Systems can help you simplify, improve and reduce costs. Whether you are transporting hot, cold, abrasive or clean materials, Uponor delivers regardless of demands imposed by the surrounding environment.

Applications

- Cooling & Heating systems
- Hot & Cold drinking water

Approvals Overview



Lloyd's Register



Our offer includes

- Different pipe systems with comprehensive range of fittings and accessories for various applications in shipbuilding
- Lightweight and flexible plastic pipes that reduce the number of connections and save up to 50% weight compared to other materials
- Cost reductions through quick and easy jointing technologies
- Modular fittings and space-saving connections
- Cold jointing that eliminates the fire hazards of welding, brazing or any other installation method with open flames
- Systems for new build and renovation
- International approvals from shipping and military authorities
- Extensive services from planning to installation
- A certified installation partner with over 10 years of expertise in installing Uponor systems on any type of vessel*

* Please contact us for further details.



Uponor piping systems for marine applications



The secret is in the material

Uponor Marine Pipe Systems withstand high temperatures, pressures and vibrations. The material is low in weight and the corrosion-free system provides a safe installation. Combined with our specialists' knowledge, experience and resources, the material can bring substantial savings in installation time and maintenance.

Innovative jointing systems

Uponor's flexible marine pipe systems save time and labor with fittings that reduce installation time up to 60%. Connections can be made wet or dry which is perfect for installation while in operation and if you have dry-docks for repairs, you want the downtime to be minimal. More durable, easier and lower overall cost – these are just some of the advantages.

Each unique characteristic of Uponor pipes opens up new opportunities for simplification and higher efficiency. From engine room, HVAC and sanitary systems, our sales team always provides our customers with the most reliable and cost-effective solutions.

With all these benefits in mind, Uponor systems are the perfect choice for any of your marine new-build or refurbishment projects and even pre-fabricated solutions.

Your benefits at a glance

- Cost-effective solutions
- Quick and easy installation
- Corrosion-free
- Light weight and flexible
- Easy handling
- Space-saving
- Sound absorbing
- Vibration resistant
- Long service life
- Maintenance free
- Permanently leak-proof
- 10-Year System Warranty

Save more with Uponor

- Corrosion-free piping systems equal cash. With the increased service life of our pipe systems, your dry dock-time, service and maintenance needs will drastically reduce paying you higher profits.
- Time is money. With only a few handy tools, our unique installation technology drastically reduces the installation time on board. And the best part about it, anyone can do it! No special knowledge or skills required. Perfect for any renovation, new-built or even prefabricated solutions.
- Less is more. Weighing only one fifth of comparable metal systems, our pipe system can save you several tons per ship allowing for more passenger or freight load to be carried.
- The greatest wealth is health. Our Smatrix Aqua Plus Flushing station can help prevent legionella and ensure the health and well-being of your most valuable resources aboard – your passengers and crew.



Content

Multilayer Pipe System	07
Pipes	
Uni Pipe PLUS	08
MLC Multilayer composite pipe overlapped welded	11
Uni	13
Fittings	
S-Press PLUS	14
RS Modular fittings for bigger dimensions	33
Uni-X	37
Uni-C	40
Flexible Pipe Systems	43
Pipes	
Aqua Pipe PE-Xa pipe for tap water installation	44
Fittings	
Q&E Q&E fittings for flexible pipes	46
RS Modular fittings for bigger dimensions	70
Tools	75
Cutting & Preperation.....	76
Pressing	79
Expanding	84
Appendix	87
Abbreviations	87
Comparisons of inner and outer pipe diameter.....	88

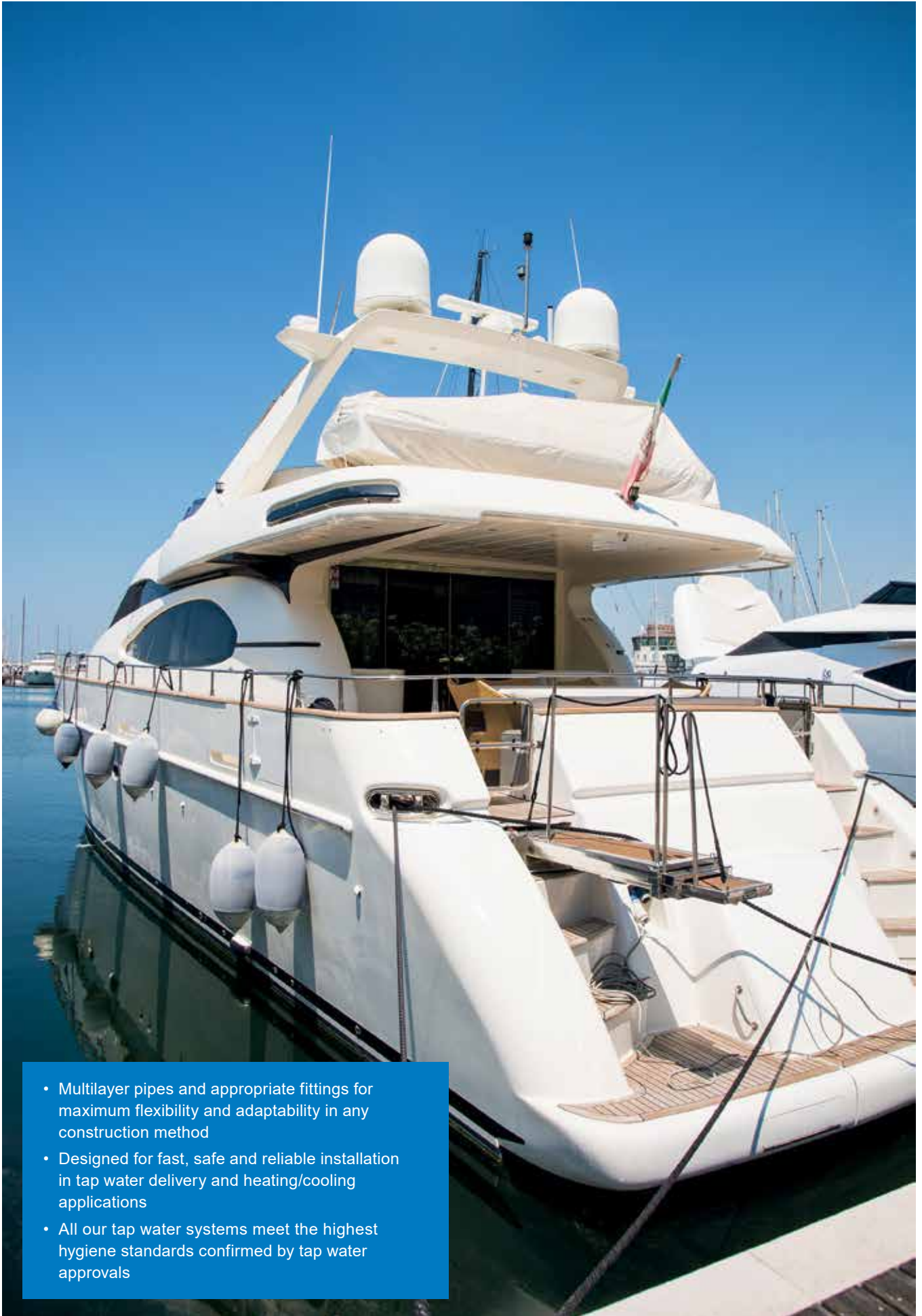

- Multilayer pipes and appropriate fittings for maximum flexibility and adaptability in any construction method
- Designed for fast, safe and reliable installation in tap water delivery and heating/cooling applications
- All our tap water systems meet the highest hygiene standards confirmed by tap water approvals

Multilayer Pipe Systems

Pipes

Uni Pipe PLUS	08
MLC	11
Uni	13

Fittings

S-Press PLUS	14
RS	33
Uni-X	37
Uni-C	40

Uponor Uni Pipe PLUS



The Uni Pipe PLUS is Uponor's unique multilayer composite pipe for tap water and heating/cooling application. Its bend radius is up to 40 per cent smaller than current multilayer composite pipes: changes of direction

when installing can be achieved by bending the pipe, reducing fitting requirements and installation time.

Your benefits

- Seamless or OWC-technology for highest level of safety
- High dimensional stability, low expansion rates
- Increased flexibility
- 100% oxygen barrier
- Lightweight



Specification

- Oxygen diffusion resistant multi-layer composite pipe (PE-RT - adhesive – seamless aluminium/longitudinally welded aluminium - adhesive - PE-RT) produced using SACP and OWC-technology.
- Fire classification E according to EN 13501-1.
- With pipe end caps as hygienic seal according EN 806.

Application

- Tested/Approved according EN ISO 21003 Multilayer piping systems for hot and cold water installations inside buildings for application class 1,2,4,5/10bar
- Tap water: The permanent operating temperature ranges from 0°C to 70°C at a maximum permanent operating pressure of 10 bar. The short-term malfunction temperature is 95°C for a period of 100 hours in the operating life time.
- Heating: The permanent operating temperature ranges up to 80°C at a maximum permanent operating pressure of 10 bar. The short-term malfunction temperature is 100°C for a period of 100 hours in the operating life time.

Certification

- Approvals by local OM.

E.g.

- DVGW
- AENOR

Uponor Uni Pipe PLUS white S

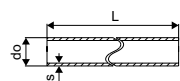

Item no.	Dimension	L do s			Qty 2	Qty 1	UOM
		m	mm	mm			
1059572	16x2,0 5m	5	16	2,0	125	5	m
1059573	20x2,25 5m	5	20	2,25	85	5	m
1059574	25x2,5 5m	5	25	2,5	55	5	m
1059575	32x3,0 5m	5	32	3	35	5	m

Uponor Uni Pipe PLUS

Uponor MLC pipe white S

■ bar

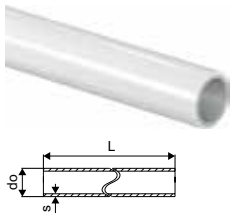

Item no.	Dimension	L m	do mm	s mm	Qty 2	Qty 1	UOM
1013432	16x2,0 5m	5	16	2	125	5	m
1013438	20x2,25 5m	5	20	2,25	85	5	m
1013442	25x2,5 5m	5	25	2,5	55	5	m
1013444	32x3,0 5m	5	32	3	35	5	m
1013446	40x4,0 5m	5	40	4	20	5	m
1013449	50x4,5 5m	5	50	4,5	20	5	m
1013451	63x6,0 5m	5	63	6	15	5	m
1013453	75x7,5 5m	5	75	7,5	5	5	m
1013455	90x8,5 5m	5	90	8,5	5	5	m
1013457	110x10,0 5m	5	110	10	5	5	m

Uponor Uni Pipe PLUS white



Item no.	Dimension	L m	do mm	s mm	uPo- ints	Qty 2	Qty 1	UOM
1059576	16x2,0 100m	100	16	2,0	500	2000	100	m
1059578	16x2,0 500m	500	16	2,0	2500	3500	500	m

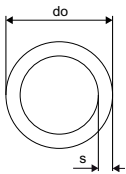

Uponor Uni Pipe PLUS white IPPC

■ coil on IPPC palette



Item no.	Dimension	L m	do mm	s mm	Qty 2	Qty 1	UOM
1084909	16x2,0 200m	200	16	2,0	2600	200	m
1084910	20x2,25 100m	100	20	2,25	1300	100	m
1084911	25x2,5 50m	50	25	2,5	700	50	m
1084912	32x3,0 50m	50	32	3,0	400	50	m

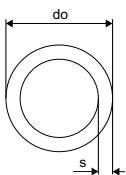

Uponor Uni Pipe PLUS

Uponor MLC insulated

Specification

- Consists of pipe and insulating layer.
- Supplied in coils.
- Round extruded pipe insulation made of polyethylene foam with closed-cell material structure.
- With sturdy, seamless foil coating

Uponor Uni Pipe PLUS white insulated S6 WLS 040

- Insulation thickness 6 mm
- thermal conductivity $\lambda=0,040$ W/m*k
- round extruded



NEW

Item no.	Dimension	L m	do mm	do1 mm	s mm	s1 mm	colour	uPoints	Qty 2	Qty 1	UOM
1091725	25x2,5 blue 50m	50	25	37	2,5	6,0	blue	1050	400	50	m

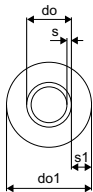

Uponor Uni Pipe PLUS white insulated S10 WLS 035

- Insulation thickness 10 mm
- thermal conductivity $\lambda=0,035$ W/m*k
- round extruded



Item no.	Dimension	L m	do mm	do1 mm	s mm	s1 mm	colour	uPoints	Qty 2	Qty 1	UOM
1062181	16x2,0 blue 75m	75	16	36	2	10	blue	800	450	75	m
1062182	20x2,25 blue 75m	75	20	40	2,25	10	blue	1000	525	75	m
1062183	25x2,5 blue 50m	50	25	45	2,5	10	blue	1100	350	50	m

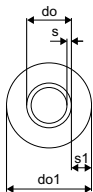

Uponor MLC

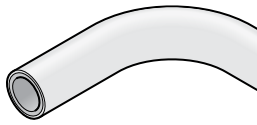

Uponor MLC multilayer composite pipe is ideal for tap water and heating/cooling application. MLC pipes can be installed in walls, floors or ceilings, and embedded in concrete. High flexibility ensures easy rollouts.

Your benefits

- Lightweight and flexible
- High form stability
- Traceable in walls
- Fast, flame-free installation
- 100% oxygen barrier and low expansion rates



Specification

- Oxygen diffusion resistant multi-layer composite pipe (PE-RT - adhesive - longitudinally welded aluminium - adhesive - PE-RT)
- Fire classification E according to EN 13501-1.
- With pipe end caps as hygienic seal according to EN 806.

Application

- Tap water: The permanent operating temperature ranges from 0°C to 70°C at a maximum permanent operating pressure of 10 bar. The short-term malfunction temperature is 95°C for a period of 100 hours in the operating life time.
- Heating: The permanent operating temperature ranges up to 80°C at a maximum permanent operating pressure of 10 bar. The short-term malfunction temperature is 100°C for a period of 100 hours in the operating life time.

Certification

- Approvals by local OM.
- E.g.
- DVGW
 - AENOR

Uponor MLC pipe white

- coil
(IPPC = special export pallet)

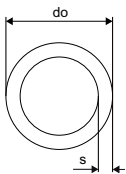

Item no.	Dimension	L m	do mm	s mm	uPoints	Qty 2	Qty 1	UOM
1013378	16x2,0 100m	100	16	2,0	500	2000	100	m
1013372	16x2,0 200m IPPC	200	16	2,0	100	2600	200	m
1013380	16x2,0 500m IPPC	500	16	2,0	2500	3000	500	m
1030549	20x2,25 100m IPPC	100	20	2,25	150	1300	100	m
1013392	20x2,25 200m IPPC	200	20	2,25	1500	2600	200	m
1030550	25x2,5 50m IPPC	50	25	2,5	150	700	50	m
1030551	32x3,0 50m IPPC	50	32	3,0	250	500	50	m

Uponor MLC

Uponor MLC insulated

Specification

- Consists of pipe and insulating layer.
- Supplied in coils.
- Round extruded pipe insulation made of polyethylene foam with closed-cell material structure.
- With sturdy, seamless foil coating

Uponor MLC pipe white insulated S9

- Insulation thickness 9 mm

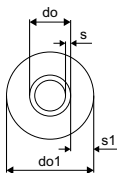

Item no.	Dimension	L m	do mm	do1 mm	s mm	s1 mm	colour	uPoints	Qty 2	Qty 1	UOM
1013625	16x2,0 blue 75m	75	16	34	2,0	9,0	blue	700	450	75	m
1013626	20x2,25 blue 75m	75	20	38	2,25	9,0	blue	900	450	75	m
1013627	25x2,5 blue 50m	50	25	43	2,5	9,0	blue	1050	350	50	m

Uponor Uni

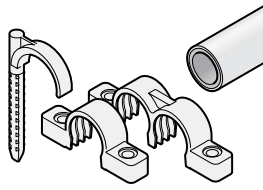

Uponor Uni brings together all accessories needed for installing the multilayer pipe systems.

Your benefits

- Quick installation
- Full range of accessories
- Easy to use



Uponor Uni pipe clamps

Uponor MLC pipe clip white

- Easy opening with screwdriver
- Connectable up to 25 mm.

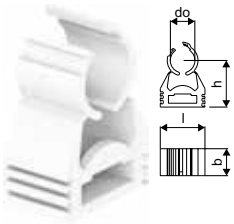

Item no.	Dimension	Qty 2	Qty 1	UOM
1013142	16		100	pcs
1013144	20		50	pcs
1013145	25		50	pcs
1013146	32	500	50	pcs
1013147	40	500	25	pcs

Uponor S-Press PLUS

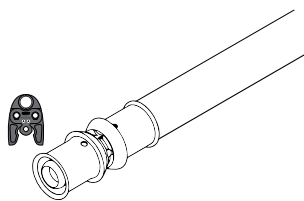

S-Press PLUS/ S-Press, our new generation of press fittings, is the perfect solution for ensuring permanently tight pipe connections. It's 100% backward compatible with current Uponor composite pipes and tools. Availa-

ble in dimensions from 14 to 75 mm in both metal and plastic, S-Press PLUS/ S-Press are the fittings that knows no compromise.

Your benefits

- **TOUGH:** Withstand harshest conditions
- **SAFE:** Ensuring your perfect pressing result
- **EASY:** Simplifying planning and installation
- **SMART:** Answering all your questions on site



Specification

- Fixed press sleeve with inspection window
- Precise jaw fixation
- Fast diameter recognition
- Accurate test safety function
- 100% backward compatible with existing Uponor components
- Flow rate optimized fitting body

Application

- Tap water: The permanent operating temperature ranges from 0°C to 70°C at a maximum permanent operating pressure of 10 bar. The short-term malfunction temperature is 95°C for a period of 100 hours in the operating life time.
- Heating: The permanent operating temperature ranges up to 80°C at a maximum permanent operating pressure of 10 bar. The short-term malfunction temperature is 100°C for a period of 100 hours in the operating life time.

if not different mentioned:

- Male and female threads acc.to EN 10226-1.

Certification

- Approvals by local OM.

E.g.

- DVGW
- AENOR

Uponor S-Press PLUS/ S-Press made of PPSU

Specification

- made of PPSU

Uponor S-Press PLUS

Uponor S-Press PLUS elbow PPSU

- Unique press indicator
- Fast 3-step installation (press without bevel)
- Innovative QR code for immediate digital access
- Colour code



Item no.	Dimension	l1 mm	l2 mm	z1 mm	z2 mm	Qty 2	Qty 1	UOM
1039929	16-16	33	33	13	13	80	10	pcs
1039930	20-20	37	37	16	16	80	10	pcs
1039931	25-25	48	48	19	19	40	5	pcs
1039932	32-32	51	51	23	23	20	5	pcs

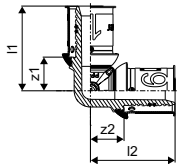

Uponor S-Press composite elbow PPSU

- Fast installation with easy bevel and without calibration
- Colour code



Item no.	Dimension	l1 mm	l2 mm	z1 mm	z2 mm	Qty 1	UOM
1046386	40-40	68	68	29	29	5	pcs
1046387	50-50	73	73	34	34	3	pcs
1032877	63-63	101	101	40	40	1	pcs
1032878	75-75	108	108	47	47	1	pcs

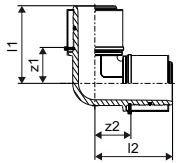

Uponor S-Press composite elbow 45° PPSU

- Fast installation with easy bevel and without calibration
- Colour code



Item no.	Dimension	l1 mm	l2 mm	z1 mm	z2 mm	Qty 1	UOM
1046388	40-40	56	56	17	17	5	pcs
1046389	50-50	59	59	20	20	3	pcs
1032879	63-63	83	83	23	23	1	pcs
1032879	75-75	86	86	25	25	1	pcs

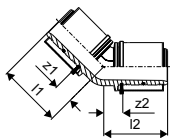

Uponor S-Press PLUS

Uponor S-Press PLUS coupling PPSU

- Unique press indicator
- Fast 3-step installation (press without bevel)
- Innovative QR code for immediate digital access
- Colour code

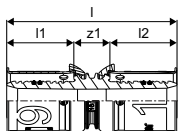

NEW
NEW
NEW
NEW

Item no.	Dimension	l mm	l1 mm	l2 mm	z1 mm	Qty 2	Qty 1	UOM
1039933	16-16	51	20	20	11	80	10	pcs
1039934	20-20	54	21	21	11	80	10	pcs
1039935	25-25	68	28	28	11	40	5	pcs
1039936	32-32	69	28	28	13	40	5	pcs

Uponor S-Press composite coupling PPSU

- Fast installation with easy bevel and without calibration
- Colour code

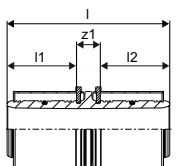

NEW
NEW

Item no.	Dimension	l mm	l1 mm	l2 mm	z1 mm	Qty 1	UOM
1046401	40-40	91	39	39	13	5	pcs
1046402	50-50	91	39	39	13	3	pcs
1032881	63-63	137	61	61	15	1	pcs
1032882	75-75	137	61	61	15	1	pcs

Uponor S-Press PLUS reducer PPSU

- Unique press indicator
- Fast 3-step installation (press without bevel)
- Innovative QR code for immediate digital access
- Colour code

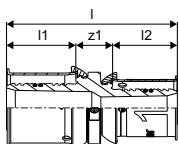

NEW
NEW
NEW
NEW

Item no.	Dimension	l mm	l1 mm	l2 mm	z1 mm	Qty 2	Qty 1	UOM
1039937	20-16	53	21	20	11	80	10	pcs
1039938	25-16	60	28	20	11	40	5	pcs
1039939	25-20	61	28	21	11	40	5	pcs
1039940	32-25	69	28	28	13	40	5	pcs

Uponor S-Press PLUS

Uponor S-Press reducer PPSU

- Fast installation with easy bevel and without calibration
- Colour code

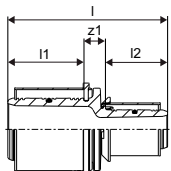

Item no.	Dimension	l mm	l1 mm	l2 mm	z1 mm	Qty 1	UOM
1039941	40-25	80	39	28	12	5	pcs
1039942	40-32	80	39	28	13	5	pcs
1039943	50-32	80	39	28	13	3	pcs
1046406	50-40	91	39	39	13	3	pcs
1032883	63-40	115	61	37	17	1	pcs
1032884	63-50	115	61	37	17	1	pcs
1032885	75-50	115	61	37	17	1	pcs
1032886	75-63	137	61	59	17	1	pcs

Uponor S-Press PLUS tee PPSU

- Unique press indicator
- Fast 3-step installation (press without bevel)
- Innovative QR code for immediate digital access
- Colour code

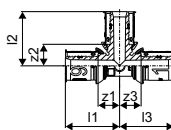

Item no.	Dimension	l1 mm	l2 mm	l3 mm	z1 mm	z2 mm	z3 mm	Qty 2	Qty 1	UOM
1039944	16-16-16	33	33	33	13	13	13	80	10	pcs
1039945	20-20-20	37	37	37	16	16	16	40	10	pcs
1039946	25-25-25	48	48	48	19	19	19	20	5	pcs
1039947	32-32-32	51	51	51	23	23	23	20	5	pcs

Uponor S-Press composite tee PPSU

- Fast installation with easy bevel and without calibration
- Colour code

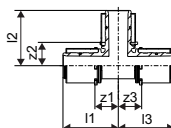

Item no.	Dimension	l1 mm	l2 mm	l3 mm	z1 mm	z2 mm	z3 mm	Qty 1	UOM
1046390	40-40-40	68	68	68	29	29	29	5	pcs
1046391	50-50-50	73	73	73	33	33	33	3	pcs
1032887	63-63-63	101	101	101	42	40	42	1	pcs
1032888	75-75-75	108	107	108	47	47	47	1	pcs

Uponor S-Press PLUS

Uponor S-Press PLUS tee red. PPSU

- Fixed stainless steel sleeve
- Unique press indicator
- Fast 3-step installation (press without bevel)
- Innovative QR code for immediate digital access
- Colour code

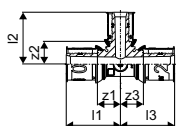

Item no.	Dimension	l1 mm	l2 mm	l3 mm	z1 mm	z2 mm	z3 mm	Qty 2	Qty 1	UOM
NEW 1039948	16-20-16	35	35	35	15	13	15	40	10	pcs
NEW 1039949	20-16-16	37	36	36	16	16	16	40	10	pcs
NEW 1039950	20-16-20	37	36	37	16	16	16	40	10	pcs
NEW 1039951	20-20-16	37	37	36	16	16	16	40	10	pcs
NEW 1039952	20-25-20	41	48	41	19	19	19	40	10	pcs
NEW 1039953	25-16-16	48	39	39	19	19	19	40	5	pcs
NEW 1039954	25-16-20	48	39	41	19	19	19	40	5	pcs
NEW 1039955	25-16-25	48	39	48	19	19	19	40	5	pcs
NEW 1039956	25-20-20	48	41	41	19	19	19	40	5	pcs
NEW 1039957	25-20-25	48	41	48	19	19	19	40	5	pcs
NEW 1039958	32-16-32	51	43	51	23	23	23	40	5	pcs
NEW 1039959	32-20-32	51	44	51	23	23	23	40	5	pcs
NEW 1039960	32-25-25	51	51	51	23	23	23	40	5	pcs
NEW 1039961	32-25-32	51	51	51	23	23	23	40	5	pcs

Uponor S-Press tee red. PPSU

- Fast installation with easy bevel and without calibration
- Colour code



Item no.	Dimension	l1 mm	l2 mm	l3 mm	z1 mm	z2 mm	z3 mm	Qty 1	UOM
NEW 1039962	40-20-40	68	49	68	29	28	29	5	pcs
NEW 1039963	40-25-32	68	56	56	29	28	28	5	pcs
NEW 1039964	40-25-40	68	56	68	29	28	29	5	pcs
NEW 1039965	40-32-32	68	56	56	29	28	28	5	pcs
NEW 1039966	40-32-40	68	56	68	29	28	29	5	pcs
NEW 1039967	50-25-40	73	61	73	34	33	34	3	pcs
NEW 1039968	50-25-50	73	61	73	34	33	34	3	pcs
NEW 1039969	50-32-50	73	61	73	34	33	34	3	pcs

Uponor S-Press composite tee reducer PPSU

- Fast installation with easy bevel and without calibration
- Colour code

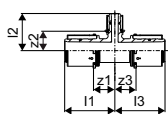

Item no.	Dimension	l1 mm	l2 mm	l3 mm	z1 mm	z2 mm	z3 mm	Qty 1	UOM
NEW 1046400	50-40-50	73	73	73	33	33	33	3	pcs
NEW 1032889	63-25-63	101	68	101	40	39	40	1	pcs
NEW 1032890	63-32-63	101	68	101	40	39	40	1	pcs
NEW 1032891	63-40-63	101	79	101	40	40	40	1	pcs
NEW 1032892	75-32-75	108	74	108	47	45	47	1	pcs
NEW 1032893	75-40-75	108	86	108	47	44	47	1	pcs
NEW 1032894	75-50-75	108	86	108	47	49	47	1	pcs

Uponor S-Press PLUS

Uponor S-Press PLUS

Specification

- made of tin-plated DR brass

Uponor S-Press PLUS adapter male thread

- Unique press indicator
- Fast 3-step installation (press without bevel)
- Innovative QR code for immediate digital access

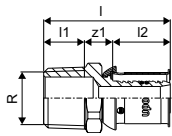

Item no.	Dimension	l mm	l1 mm	l2 mm	R "	z1 mm	Qty 2	Qty 1	UOM
NEW 1070502	16-R1/2"MT	44	14	20	1/2	10	80	10	pcs
NEW 1070503	16-R3/4"MT	46	16	20	3/4	11	120	15	pcs
NEW 1070504	20-R1/2"MT	45	14	21	1/2	10	80	10	pcs
NEW 1070505	20-R3/4"MT	48	15	21	3/4	11	80	10	pcs
NEW 1070506	20-R1"MT	54	17	21	1	16	40	10	pcs
NEW 1070507	25-R3/4"MT	55	15	28	3/4	11	40	5	pcs
NEW 1070508	25-R1"MT	62	18	28	1	16	40	5	pcs
NEW 1070509	32-R1"MT	62	17	28	1	16	40	5	pcs
NEW 1070510	32-R1 1/4"MT	66	19	28	1 1/4	19	20	5	pcs

Uponor S-Press adapter male thread

- Made of tin-plated brass
- Fast installation with easy bevel and without calibration
- Colour code

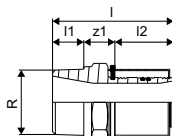

Item no.	Dimension	l mm	l1 mm	l2 mm	R "	z1 mm	d mm	Qty 1	UOM
NEW 1046901	40-R1 1/4"MT	78	20	38	1 1/4	20		5	pcs
NEW 1046902	40-R1 1/2"MT	80	20	38	1 1/2	22	40	5	pcs
NEW 1046905	50-R1 1/2"MT	80	20	38	1 1/2	22	50	3	pcs
NEW 1046906	50-R2"MT	84	24	38	2	22	50	3	pcs
NEW 1032895	63-R2"MT	111	28	61	2	22		1	pcs
NEW 1032896	75-R2 1/2"MT	110	27	61	2 1/2	22		1	pcs

Uponor S-Press PLUS adapt. female thread

- Unique press indicator
- Fast 3-step installation (press without bevel)
- Innovative QR code for immediate digital access

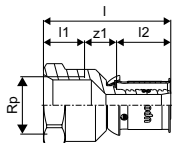

Item no.	Dimension	l mm	l1 mm	l2 mm	Rp "	z1 mm	Qty 2	Qty 1	UOM
NEW 1070515	16-Rp1/2"FT	47	15	20	1/2	12	80	10	pcs
NEW 1070516	20-Rp1/2"FT	47	15	21	1/2	10	120	15	pcs
NEW 1070517	20-Rp3/4"FT	51	16	21	3/4	14	80	10	pcs
NEW 1070518	20-Rp1"FT	52	19	21	1	12	80	20	pcs
NEW 1070519	25-Rp3/4"FT	56	17	28	3/4	11	40	5	pcs
NEW 1070520	25-Rp1"FT	59	19	28	1	12	40	5	pcs
NEW 1070521	32-Rp1"FT	58	20	28	1	10	40	5	pcs
NEW 1070522	32-Rp1 1/4"FT	62	21	28	1 1/4	13	20	5	pcs

Uponor S-Press PLUS

Uponor S-Press adapter female thread

- Made of tin-plated brass
- Fast installation with easy bevel and without calibration
- Colour code

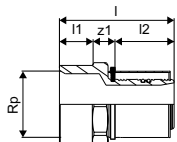

NEW
NEW
NEW

Item no.	Dimension	l	l1	l2	Rp	z1	Qty 1	UOM
		mm	mm	mm	"	mm		
1046903	40-Rp1 1/4"FT	73	21	38	1 1/4	14	5	pcs
1046904	40-Rp1 1/2"FT	77	21	38	1 1/2	18	5	pcs
1046907	50-Rp1 1/2"FT	73	21	38	1 1/2	14	3	pcs

Uponor S-Press PLUS elbow

- Unique press indicator
- Fast 3-step installation (press without bevel)
- Innovative QR code for immediate digital access

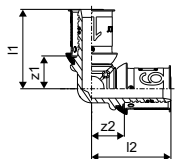

NEW
NEW
NEW
NEW

Item no.	Dimension	l1	l2	z1	z2	Qty 2	Qty 1	UOM
		mm	mm	mm	mm			
1070523	16-16	34	34	14	14	80	10	pcs
1070524	20-20	37	37	16	16	80	10	pcs
1070525	25-25	47	47	19	19	40	5	pcs
1070526	32-32	51	51	23	23	20	5	pcs

Uponor S-Press elbow

- Made of tin-plated brass
- Fast installation with easy bevel and without calibration
- Colour code

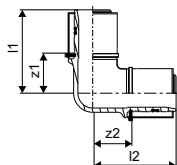

NEW
NEW

Item no.	Dimension	l1	l2	z1	z2	Qty 1	UOM
		mm	mm	mm	mm		
1046908	40-40	72	72	34	34	5	pcs
1046911	50-50	79	79	41	41	3	pcs

Uponor S-Press PLUS

Uponor S-Press PLUS bend

- Made of casted DR brass
- Unique press indicator
- Fast 3-step installation (press without bevel)
- Innovative QR code for immediate digital access
- extra low pressure loss

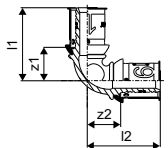

Item no.	Dimension	l1 mm	l2 mm	z1 mm	z2 mm	Qty 2	Qty 1	UOM
1070527	16-16	37	37	17	17	80	10	pcs
1070528	20-20	40	40	19	19	80	10	pcs
1070529	25-25	50	50	22	22	40	5	pcs
1070530	32-32	56	56	28	28	20	5	pcs

Uponor S-Press PLUS elbow male thread

- Unique press indicator
- Fast 3-step installation (press without bevel)
- Innovative QR code for immediate digital access

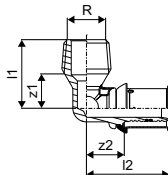

Item no.	Dimension	l1 mm	l2 mm	R "	z1 mm	z2 mm	Qty 2	Qty 1	UOM
1070532	16-R1/2"MT	30	37	1/2	15	17	80	10	pcs
1070533	20-R1/2"MT	32	41	1/2	15	19	80	10	pcs
1070534	20-R3/4"MT	34	41	3/4	18	19	80	10	pcs
1070535	25-R3/4"MT	36	48	3/4	20	19	40	5	pcs
1070536	25-R1"MT	43	51	1	22	23	40	5	pcs
1070537	32-R1"MT	43	51	1	22	23	20	5	pcs

Uponor S-Press elbow adapter male thread

- Made of tin-plated brass
- Fast installation with easy bevel and without calibration
- Colour code

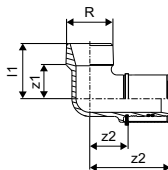

Item no.	Dimension	l1 mm	l2 mm	R "	z1 mm	z2 mm	Qty 1	UOM
1046909	40-R1 1/4"MT	49	72	1 1/4	30	34	5	pcs

Uponor S-Press PLUS

Uponor S-Press PLUS elbow female thread

- Unique press indicator
- Fast 3-step installation (press without bevel)
- Innovative QR code for immediate digital access

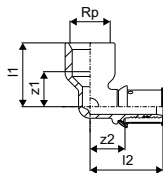

Item no.	Dimension	l1 mm	l2 mm	Rp "	z1 mm	z2 mm	Qty 2	Qty 1	UOM
1070539	16-Rp1/2"FT	33	38	1/2	18	18	80	10	pcs
1070540	20-Rp1/2"FT	36	41	1/2	21	19	80	10	pcs
1070541	20-Rp3/4"FT	36	43	3/4	19	22	40	10	pcs
1070542	25-Rp3/4"FT	40	50	3/4	23	22	20	5	pcs
1070543	25-Rp1"FT	45	54	1	25	26	20	5	pcs
1070544	32-Rp1"FT	49	54	1	30	26	20	5	pcs

Uponor S-Press elbow adap. female thread

- Made of tin-plated brass
- Fast installation with easy bevel and without calibration
- Colour code

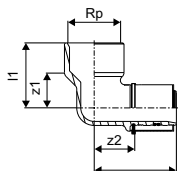

Item no.	Dimension	l1 mm	l2 mm	Rp "	z1 mm	z2 mm	Qty 1	UOM
1046910	40-Rp1 1/2"FT	59	75	1 1/2	38	37	5	pcs
1046912	50-Rp1 1/2"FT	59	79	1 1/2	38	41	3	pcs

Uponor S-Press PLUS elbow 45°

- Unique press indicator
- Fast 3-step installation (press without bevel)
- Innovative QR code for immediate digital access

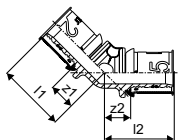

Item no.	Dimension	l1 mm	l2 mm	z1 mm	z2 mm	Qty 2	Qty 1	UOM
1070545	25-25	46	46	18	18	20	5	pcs
1070546	32-32	49	49	23	23	20	5	pcs

Uponor S-Press PLUS

Uponor S-Press elbow 45°

- Made of tin-plated brass
- Fast installation with easy bevel and without calibration
- Colour code



NEW
NEW

Item no.	Dimension	l1 mm	l2 mm	z1 mm	z2 mm	Qty 1	UOM
1046913	40-40	59	59	21	21	5	pcs
1046914	50-50	63	63	25	25	3	pcs

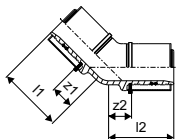

Uponor S-Press PLUS coupling

- Unique press indicator
- Fast 3-step installation (press without bevel)
- Innovative QR code for immediate digital access



NEW
NEW
NEW
NEW

Item no.	Dimension	l mm	l1 mm	l2 mm	z1 mm	Qty 2	Qty 1	UOM
1070547	16-16	51	20	20	12	80	10	pcs
1070548	20-20	54	21	21	12	80	10	pcs
1070549	25-25	68	28	28	12	40	5	pcs
1070550	32-32	68	28	28	12	40	5	pcs

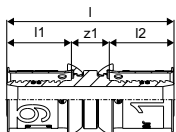

Uponor S-Press coupling

- Made of tin-plated brass
- Fast installation with easy bevel and without calibration
- Colour code



NEW
NEW

Item no.	Dimension	l mm	l1 mm	l2 mm	z1 mm	Qty 1	UOM
1046932	40-40	88	38	38	12	5	pcs
1046935	50-50	88	38	38	12	3	pcs

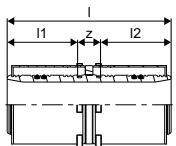

Uponor S-Press PLUS

Uponor S-Press PLUS reducer

- Unique press indicator
- Fast 3-step installation (press without bevel)
- Innovative QR code for immediate digital access

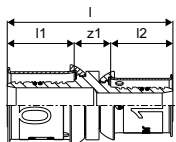

NEW
NEW
NEW
NEW
NEW

Item no.	Dimension	l mm	l1 mm	l2 mm	z1 mm	Qty 2	Qty 1	UOM
1070552	20-16	53	21	20	12	80	10	pcs
1070553	25-16	60	28	20	12	40	5	pcs
1070554	25-20	61	28	21	12	40	5	pcs
1070555	32-20	61	28	21	12	40	5	pcs
1070556	32-25	68	28	28	12	40	5	pcs

Uponor S-Press reducer

- Made of tin-plated brass

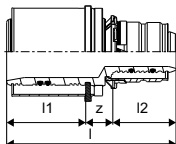

NEW
NEW
NEW
NEW

Item no.	Dimension	l mm	l1 mm	l2 mm	z1 mm	Qty 1	UOM
1046930	40-25	81	38	30	13	5	pcs
1046931	40-32	81	38	30	13	5	pcs
1046933	50-32	81	38	30	13	3	pcs
1046934	50-40	89	38	38	14	3	pcs

Uponor S-Press PLUS tee

- Unique press indicator
- Fast 3-step installation (press without bevel)
- Innovative QR code for immediate digital access

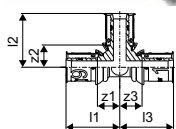

NEW
NEW
NEW
NEW

Item no.	Dimension	l1 mm	l2 mm	l3 mm	z1 mm	z2 mm	z3 mm	Qty 2	Qty 1	UOM
1070560	16-16-16	34	34	34	14	14	14	80	10	pcs
1070561	20-20-20	37	37	37	16	16	16	40	10	pcs
1070562	25-25-25	47	47	47	19	19	19	20	5	pcs
1070563	32-32-32	51	51	51	23	23	23	20	5	pcs

Uponor S-Press tee

- Made of tin-plated brass
- Fast installation with easy bevel and without calibration
- Colour code

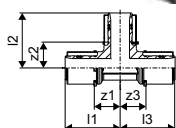

NEW
NEW

Item no.	Dimension	l1 mm	l2 mm	l3 mm	z1 mm	z2 mm	z3 mm	Qty 1	UOM
1046921	40-40-40	72	72	72	34	34	34	5	pcs
1046928	50-50-50	79	79	79	41	41	41	3	pcs

Uponor S-Press PLUS

Uponor S-Press PLUS tee reducer

- Unique press indicator
- Fast 3-step installation (press without bevel)
- Innovative QR code for immediate digital access

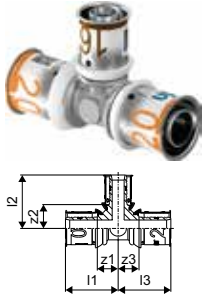

Item no.	Dimension	l1 mm	l2 mm	l3 mm	z1 mm	z2 mm	z3 mm	Qty 2	Qty 1	UOM
NEW 1070566	16-20-16	36	37	36	16	16	16	80	10	pcs
NEW 1070567	20-16-16	35	36	34	14	16	14	40	10	pcs
NEW 1070568	20-16-20	35	36	35	14	16	14	80	20	pcs
NEW 1070569	20-20-16	37	37	36	16	16	16	80	20	pcs
NEW 1070570	20-25-16	40	47	38	19	19	19	40	10	pcs
NEW 1070571	20-25-20	40	47	40	19	19	19	40	10	pcs
NEW 1070572	25-16-16	44	38	36	16	19	17	40	5	pcs
NEW 1070573	25-16-20	44	38	38	16	19	17	40	5	pcs
NEW 1070574	25-16-25	42	38	42	14	19	14	20	5	pcs
NEW 1070575	25-20-16	44	40	36	16	19	17	40	5	pcs
NEW 1070576	25-20-20	44	40	38	16	19	17	40	5	pcs
NEW 1070577	25-20-25	44	40	44	16	19	16	20	5	pcs
NEW 1070578	25-25-16	47	47	38	19	19	19	20	5	pcs
NEW 1070579	25-32-25	50	48	50	22	20	22	20	5	pcs
NEW 1070580	32-16-32	43	42	43	15	22	15	20	5	pcs
NEW 1070581	32-20-32	45	43	45	17	22	17	20	5	pcs
NEW 1070582	32-25-25	48	50	48	20	22	20	20	5	pcs
NEW 1070583	32-25-32	48	50	48	20	22	20	20	5	pcs

Uponor S-Press tee reducer

- Made of tin-plated brass
- Fast installation with easy bevel and without calibration
- Colour code

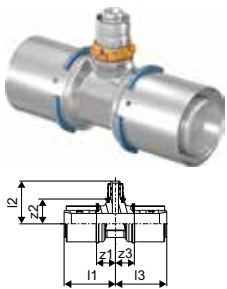

Item no.	Dimension	l1 mm	l2 mm	l3 mm	z1 mm	z2 mm	z3 mm	Qty 1	UOM
NEW 1046916	40-20-40	60	50	60	22	28	22	5	pcs
NEW 1046917	40-25-32	61	60	53	23	30	23	5	pcs
NEW 1046918	40-25-40	61	60	61	23	30	23	5	pcs
NEW 1046919	40-32-32	65	60	57	27	30	26	5	pcs
NEW 1046920	40-32-40	65	60	65	27	30	27	5	pcs
NEW 1046924	50-25-40	61	65	61	23	35	23	3	pcs
NEW 1046925	50-25-50	61	65	61	23	35	23	3	pcs
NEW 1046926	50-32-50	65	65	65	27	35	27	3	pcs
NEW 1046927	50-40-50	72	79	72	34	41	34	3	pcs

Uponor S-Press PLUS

Uponor S-Press PLUS tee male thread

- Unique press indicator
- Fast 3-step installation (press without bevel)
- Innovative QR code for immediate digital access



Item no.	Dimension	l1 mm	l2 mm	l3 mm	R mm	z1 mm	z2 mm	z3 mm	Qty 2	Qty 1	UOM
1070592	16-R1/2"MT-16	38	30	38	1/2	18	15	18	40	10	pcs
1070593	25-R3/4"MT-25	48	36	48	3/4	19	21	19	20	5	pcs
1070594	32-R3/4"MT-32	48	40	48	3/4	19	25	19	20	5	pcs

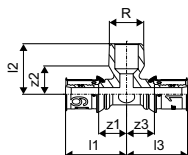

Uponor S-Press PLUS tee female thread

- Unique press indicator
- Fast 3-step installation (press without bevel)
- Innovative QR code for immediate digital access



Item no.	Dimension	l1 mm	l2 mm	l3 mm	Rp mm	z1 mm	z2 mm	z3 mm	Qty 2	Qty 1	UOM
1070595	16-Rp1/2"FT-16	38	33	38	1/2	18	18	18	40	10	pcs
1070596	20-Rp1/2"FT-20	40	35	40	1/2	19	20	19	60	15	pcs
1070597	20-Rp3/4"FT-20	43	37	43	3/4	22	20	22	40	10	pcs
1070598	25-Rp1/2"FT-25	48	37	48	1/2	19	22	19	20	5	pcs
1070599	25-Rp3/4"FT-25	50	40	50	3/4	22	23	22	20	5	pcs
1070600	32-Rp1/2"FT-32	47	40	47	1/2	18	25	18	20	5	pcs
1070601	32-Rp3/4"FT-32	51	44	51	3/4	23	27	23	20	5	pcs

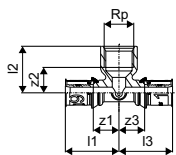

Uponor S-Press tee adapter female thread

- Made of tin-plated brass
- Fast installation with easy bevel and without calibration
- Colour code



Item no.	Dimension	l1 mm	l2 mm	l3 mm	Rp mm	z1 mm	z2 mm	z3 mm	Qty 1	UOM
1046922	40-Rp1/2"FT-40	69	47	69	1/2	31	30	31	5	pcs
1046923	40-Rp3/4"FT-40	64	47	64	3/4	26	31	26	5	pcs
1046929	50-Rp1"FT-50	72	56	72	1	34	37	34	3	pcs

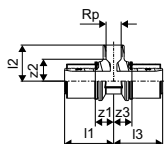

Uponor S-Press PLUS

Uponor S-Press PLUS adapter swivel nut

- Unique press indicator
- Fast 3-step installation (press without bevel)
- Innovative QR code for immediate digital access
- Releasable screw connector for connection to on-wall fittings, filters and shut-off valves
- Thread acc. to EN ISO 228-1.

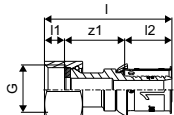

Item no.	Dimension	l mm	l1 mm	l2 mm	G "	z1 mm	Qty 2	Qty 1	UOM
1070602	16-G1/2"SN	53	8	20	1/2	25	30	1	pcs
1070603	16-G3/4"SN	44	8	20	3/4	17	20	1	pcs
1070604	20-G1/2"SN	59	8	21	1/2	30	20	1	pcs
1070605	20-G3/4"SN	46	8	21	3/4	17	20	1	pcs
1070606	25-G3/4"SN	64	8	28	3/4	28	15	1	pcs
1070607	25-G1"SN	57	9	28	1	20	15	1	pcs
1070610	32-G1 1/4"SN	59	9	28	1 1/4	22	10	1	pcs

Uponor S-Press adapter swivel nut

- Made of tin-plated brass
- Fast installation with easy bevel and without calibration
- Colour code
- Releasable screw connector for connection to on-wall fittings, filters and shut-off valves
- Thread acc. to EN ISO 228-1.

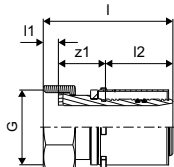

Item no.	Dimension	l mm	l1 mm	l2 mm	G "	z1 mm	Qty 1	UOM
1046937	40-G1 1/2"SN	77	10	38	1 1/2	30	5	pcs
1046938	50-G1 3/4"SN	82	12	38	1 3/4	32	3	pcs
1046939	50-G2"SN	82	12	38	2	32	3	pcs

Uponor S-Press PLUS tap elbow

- Unique press indicator
- Fast 3-step installation (press without bevel)
- Innovative QR code for immediate digital access
- for on wall installation or attachment with rotation protection to the Uponor Smart Aqua mounting angles and plates.

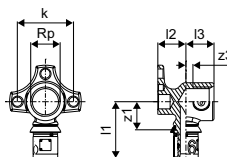

Item no.	Dimension	l1 mm	l2 mm	l3 mm	Rp "	z1 mm	z3 mm	k mm	Qty 2	Qty 1	UOM
1070638	16-Rp3/8"FT	45	20	20	3/8	25	8	40	40	10	pcs
1070639	16-Rp1/2"FT	41	20	20	1/2	21	5	40	40	10	pcs
1070640	20-Rp1/2"FT	44	20	21	1/2	23	6	40	40	10	pcs
1070641	20-Rp3/4"FT	45	20	23	3/4	24	7	40	20	5	pcs
1070642	25-Rp3/4"FT	54	27	25	3/4	26	8	40	20	5	pcs

Uponor S-Press PLUS

Uponor S-Press PLUS tap elbow long

- Unique press indicator
- Fast 3-step installation (press without bevel)
- Innovative QR code for immediate digital access
- for on wall installation or attachment with rotation protection to the Uponor Smart Aqua mounting angles and plates.



NEW

NEW

Item no.	Dimension	l1 mm	l2 mm	l3 mm	Rp "	z1 mm	z3 mm	k mm	Qty 2	Qty 1	UOM
1070644	16-Rp1/2"FT	42	20	30	1/2	22	15	40	40	10	pcs
1070645	20-Rp1/2"FT	46	20	30	1/2	25	15	40	40	10	pcs

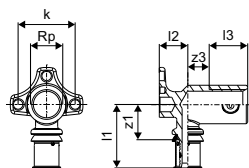

Uponor S-Press PLUS U-tap elbow

- Unique press indicator
- Fast 3-step installation (press without bevel)
- Innovative QR code for immediate digital access
- For on wall installation or attachment with rotation protection to the Uponor Smart Aqua mounting angles and plates.



NEW

NEW

NEW

NEW

NEW

NEW

NEW

Item no.	Dimension	l1 mm	l2 mm	l3 mm	l4 mm	Rp "	z1 mm	z2 mm	z4 mm	b mm	k mm	Qty 2	Qty 1	UOM
1070629	16-Rp1/2"FT-16	56	56	20	23	1/2	36	36	8	45	40	20	5	pcs
1070630	20-Rp1/2"FT-20	57	57	20	23	1/2	36	36	8	45	40		5	pcs
1070631	20-Rp1/2"FT-16	57	56	20	23	1/2	36	36	8	45	40		5	pcs
1070632	16-Rp1/2"FT-20	56	57	20	23	1/2	36	36	8	45	40		5	pcs
1070633	25-Rp1/2"FT-25	64	64	27	24	1/2	36	36	9	60	40		3	pcs
1070634	25-Rp1/2"FT-20	64	57	27	24	1/2	36	36	9	60	40		3	pcs
1070635	20-Rp1/2"FT-25	57	64	27	24	1/2	36	36	9	60	40		3	pcs

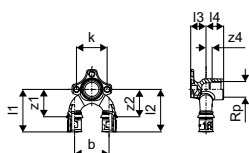

Uponor S-Press PLUS U-tap elbow mixer

- Fixed stainless steel sleeve
- Unique press indicator
- Fast 3-step installation (press without bevel)
- Innovative QR code for immediate digital access
- for inwall mixer and flushing tank connection in serial and loop installation.



NEW

NEW

Item no.	Dimension	l1 mm	l2 mm	R "	z1 mm	z2 mm	b mm	Qty 1	UOM
1070636	16-16-R1/2"MT	57	60	1/2	42	40	45	5	pcs
1070637	20-20-R3/4"MT	61	62	3/4	42	40	45	5	pcs

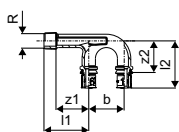

Uponor S-Press PLUS

Uponor S-Press PLUS tap elbow twin 90° long

- Unique press indicator
- Fast 3-step installation (press without bevel)
- Innovative QR code for immediate digital access
- For on wall installation or attachment with rotation protection to the Uponor Smart Aqua mounting angles and plates.
- Thread acc. to EN ISO 228-1



NEW
NEW

Item no.	Dimension	l1	l2	l3	l4	Rp	z1	z2	z3	k	k1	Qty 2	Qty 1	UOM
		mm	mm	mm	mm	mm	mm	mm	mm	mm	mm			
1070648	16-Rp1/2"FT-16	44	45	30	20	1/2	24	25	15	20	20	40	10	pcs
1070649	20-Rp1/2"FT-20	46	46	30	20	1/2	24	25	15	20	20	40	10	pcs

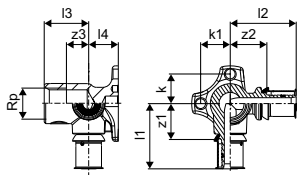

Uponor S-Press PLUS elbow adapter UPS

- Unique press indicator
- Fast 3-step installation (press without bevel)
- Innovative QR code for immediate digital access



NEW

Item no.	Dimension	l1	l2	Rp	M	z1	z2	Qty 2	Qty 1	UOM
		mm	mm	mm	mm	mm	mm			
1070657	16-Rp1/2"FT	29	48	1/2	35x1.5	8	28	10	1	pcs

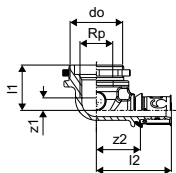

Uponor S-Press PLUS stop end

- Unique press indicator
- Fast 3-step installation (press without bevel)
- Innovative QR code for immediate digital access



NEW
NEW
NEW
NEW

Item no.	Dimension	l	l1	l2	Qty 2	Qty 1	UOM
		mm	mm	mm			
1070621	16	27	7	20	160	20	pcs
1070622	20	28	7	21		10	pcs
1070623	25	35	7	28		10	pcs
1070624	32	35	7	28		5	pcs

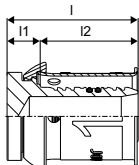

Uponor S-Press PLUS

Uponor S-Press valve U-shaped

- Made of brass
- Contoured Aluminium-sleeve
- Fast 3-step installation (press without bevel)
- Colour code
- For cold and hot tap water application

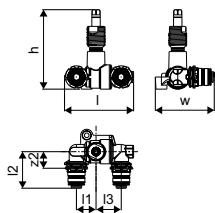

Item no.	Dimension	l	l1	l2	l3	z2	h	w	Qty 2	Qty 1	UOM
1089028	16	74	21	39	27	18	85	63	10	1	pcs
1089027	20	76	21	40	27	18	86	63	10	1	pcs
1089026	25	106	36	50	36	20	92	74	5	1	pcs

Uponor S-Press valve straight

- Made of brass
- Contoured Aluminium-sleeve
- Fast 3-step installation (press without bevel)
- Colour code
- For cold and hot tap water application

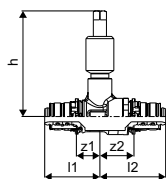

Item no.	Dimension	l1	l2	z1	z2	h	Qty 2	Qty 1	UOM
1089031	16	37	44	16	23	71	10	1	pcs
1089030	20	38	45	16	23	71	10	1	pcs
1089029	25	48	54	18	24	73	10	1	pcs

Uponor S-Press PLUS

Uponor Smart Aqua tap elbow mount. plate

- Made of galvanized steel.
- For the installation of Uponor Smart Aqua tap elbows
- Positioning of the connections in the given raster
- Plastic pins and loss protected screws M6x12 acc. DIN 965 included
- With holes and slots for easy attachment



NEW

Item no.	Dimension	l mm	s mm	h mm	k mm	k1 mm	w mm	Qty 2	Qty 1	UOM
1057840	75/150mm	265	3,0	9	75	150	35	5	1	pcs

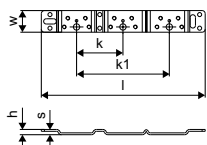

Uponor Smart Aqua mounting angle

- Made of galvanized steel.
- For the installation of Uponor Smart Aqua tap elbows
- Positioning of the connections in the given raster
- Plastic pins and loss protected screws M6x12 acc. DIN 965 included
- With holes and slots for easy attachment

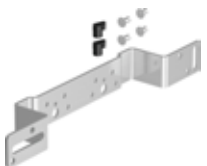

NEW

NEW

NEW

Item no.	Dimension	l mm	s mm	b mm	h mm	k mm	k1 mm	w mm	Qty 2	Qty 1	UOM
1057841	80mm	320	3	196	46	80		35	270	5	pcs
1057839	100mm	340	3	216	46	100		35		5	pcs
1057842	75/150mm	390	3	266	46	75	150	35	165	5	pcs

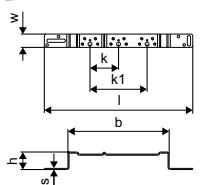

Uponor Smart Aqua single mounting angle

- Made of galvanized steel.
- For the installation of Uponor Smart Aqua tap elbows.
- Positioning of the connections in the given raster.
- Screws M6x12 acc. DIN 965 included. With holes and slots for easy attachment



NEW

Item no.	l mm	b mm	h mm	Qty 2	Qty 1	UOM
1057843	144	82	46	5	1	pcs

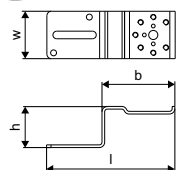

Uponor S-Press PLUS

Uponor Smart Aqua mounting rack

- Made of galvanized steel.
- For the installation of Uponor Smart Aqua tap elbows.
- Positioning of the connections in the given raster.
- Screws M6x12 acc. DIN 965 included. With holes and slots for easy attachment



NEW

Item no.	Dimension	l mm	k mm	Qty 2	Qty 1	UOM
1057844	2m	2000	75	10	1	pcs

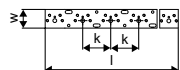

Uponor Smart Aqua 10 pins+20 screws

- Pins and screws for mounting plates, angles and tracks.



NEW

Item no.	l mm	do1 mm	do2 mm	c/c1 mm	Qty 1	UOM
1057847*	17	4	10	10	1	set

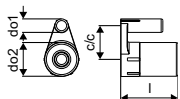

Uponor S-Press PLUS adapter

- Unique press indicator
- Fast 3-step installation (press without bevel)
- Innovative QR code for immediate digital access
- With soldered copper pipe according EN 1057 (half hard / R250)
- complete tin-plated
- Attention:

The copper side is for press connections and suitable compression fittings only.



NEW

NEW

NEW

NEW

NEW

NEW

Item no.	Dimension	l mm	l1 mm	l2 mm	z1 mm	Qty 2	Qty 1	UOM
1070615	16-15CU	76	40	20	16	160	20	pcs
1070707	20-15CU	76	39	21	16		10	pcs
1070617	20-22CU	81	41	21	19	60	15	pcs
1070618	25-22CU	88	41	28	19	20	5	pcs
1070619	25-28CU	92	43	28	21		5	pcs
1070620	32-28CU	92	43	28	21	20	5	pcs

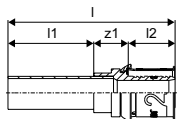

Uponor RS

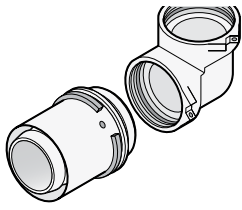

Uponor RS is a unique system that follows a modular design principle for riser systems and other distribution lines. Just 40 system components enable hundreds of variations, making the system highly adaptable.

Your benefits

- Innovative plug connection between body and adapter
- Fast and flexible: tool-free assembly, many variations
- More efficient stock management
- Re-adjustment possible until final installation
- Colour coding 16 -110mm for easy dimension selection



Specification

- with fixed press sleeve
- stop ring
- colour code
- Test safety

Application

- Tap water: The permanent operating temperature ranges from 0°C to 70°C at a maximum permanent operating pressure of 10 bar. The short-term malfunction temperature is 95°C for a period of 100 hours in the operating life time.
- Heating: The permanent operating temperature ranges up to 80°C at a maximum permanent operating pressure of 10 bar. The short-term malfunction temperature is 100°C for a period of 100 hours in the operating life time.

if not different mentioned:

- Male and female threads acc.to EN 10226-1.

Certification

- Approvals by local OM.

E.g.

- DVGW
- AENOR

Uponor RS coupling

- Made of tin-plated brass
- Base part for all RS2 or RS3 inserts including 2 lock pins.

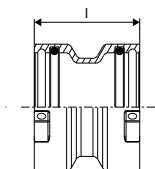

Item no.	Dimension	l mm	Qty 1	UOM
1029144	RS2-RS2	58	1	pcs
1029145	RS3-RS3	58	1	pcs

Uponor RS

Uponor RS elbow

- Made of tin-plated brass
- Base part for all RS2 or RS3 inserts including 2 lock pins.

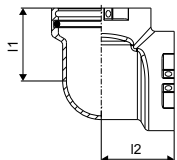

Item no.	Dimension	I1 mm	I2 mm	Qty 1	UOM
1029138	RS2-RS2	51	51	1	pcs
1029139	RS3-RS3	68	68	1	pcs

Uponor RS elbow 45°

- Made of tin-plated brass
- Base part for all RS2 or RS3 inserts including 2 lock pins.

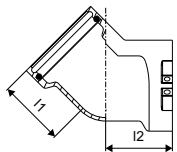

Item no.	Dimension	I1 mm	I2 mm	Qty 1	UOM
1029140	RS2-RS2	51	51	1	pcs
1029141	RS3-RS3	68	68	1	pcs

Uponor RS tee

- Made of tin-plated brass
- Base part for all RS2 or RS3 inserts including 3 lock pins.

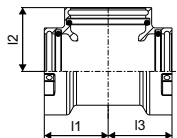

Item no.	Dimension	I1 mm	I2 mm	I3 mm	Qty 1	UOM
1029142	RS2-RS2-RS2	51	51	51	1	pcs
1029143	RS3-RS3-RS3	68	68	68	1	pcs

Uponor RS reducer

- Made of tin-plated brass
- Reducer from RS3 to RS2 including 1 lock pin.

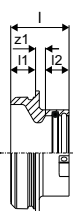
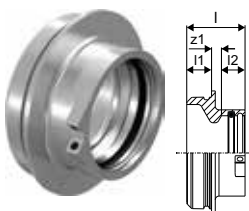

Item no.	Dimension	I mm	I1 mm	I2 mm	z1 mm	Qty 1	UOM
1029146	RS3-RS2	47	20	19	8	1	pcs

Uponor RS

Uponor RS spacer

- Made of tin plated-brass
- Spacer to connect RS base parts of equal dimensions.

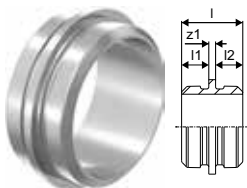

Item no.	Dimension	l	l1	l2	z1	Qty 1	UOM
		mm	mm	mm	mm		
1046750	RS2-RS2 l=5mm	45	20	20	5	1	pcs
1046751*	RS3-RS3 l=5mm	45	20	20	5	1	pcs

Uponor RS spacer

- Made of tin-plated brass
- Spacer to connect RS base parts of equal dimensions e.g to create T-manifold or shift in distribution lines.



Item no.	Dimension	l	l1	l2	l3	z1	Qty 1	UOM
		mm	mm	mm	mm	mm		
1046477*	RS2-RS2 l=130mm	170	20	20	30	130	1	pcs
1046478*	RS3-RS3 l=210mm	250	20	20	30	210	1	pcs

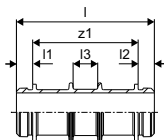

Uponor RS adapter S-Press

- Made of tin-plated brass
- Fits to all RS2 base parts.

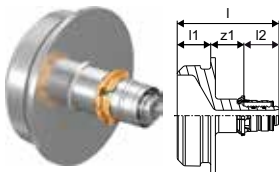

Item no.	Dimension	l	l1	l2	z1	Qty 1	UOM
		mm	mm	mm	mm		
1059397	16-RS2	61	20	21	20	1	pcs

Uponor RS adapter S-Press

- Made of tin-plated brass
- Fits to all RS2 or RS3 base parts.

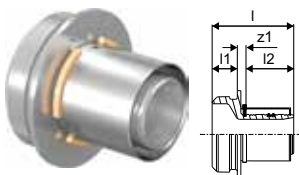

Item no.	Dimension	l	l1	l2	z1	Qty 1	UOM
		mm	mm	mm	mm		
1046940	40-RS2	65	20	38	7	1	pcs
1046941	50-RS2	65	20	38	7	1	pcs
1029125	63-RS2	88	20	61	7	1	pcs
1029126	75-RS2	88	20	61	7	1	pcs
1029127	90-RS3	93	20	62	11	1	pcs
1029128	110-RS3	93	20	62	11	1	pcs

Uponor RS

Uponor RS adapter male thread

- Made of tin-plated brass
- Fits to all RS2 or RS3 base parts

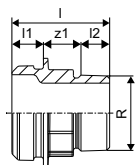

Item no.	Dimension	l mm	l1 mm	l2 mm	R "	z1 mm	Qty 1	UOM
1059402	R1 1/2"MT-RS2	62	20	24	1 1/2	18	1	pcs
1029131	R2"MT-RS2	66	20	23	2	23	1	pcs
1029132	R2 1/2"MT-RS2	63	20	27	2 1/2	16	1	pcs
1029133	R3"MT-RS3	73	20	30	3	23	1	pcs

Uponor RS adapter female thread

- Made of tin-plated brass.
- fits to all RS2 or RS3 base parts

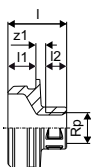

Item no.	Dimension	l mm	l1 mm	l2 mm	Rp "	z1 mm	Qty 1	UOM
1059403	Rp1/2"FT-RS2	42	20	15	1/2	7	1	pcs
1029134	Rp1"FT-RS2	45	20	19	1	6	1	pcs
1029135	Rp2"FT-RS2	54	20	26	2	8	1	pcs
1029136	Rp2 1/2"FT-RS2	63	20	30	2 1/2	12	1	pcs
1059404	Rp1/2"FT-RS3	43	20	15	1/2	8	1	pcs
1029137	Rp3"FT-RS3	65	20	33	3	12	1	pcs

Uponor RS flange adapter

- Made of tin-plated brass
- Fits to all RS2 or RS3 base parts
- Flange PN6/PN16 acc. to EN 1092-3
- Bolt circle with 4/8 holes.

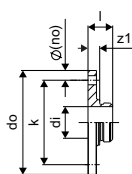

Item no.	Dimension	l mm	l3 mm	di mm	do mm	z1 mm	k mm	p bar	Qty 1	UOM
1059398	RS2-DN65 (PN6)	38	18	48,7	160	18	130	6	1	pcs
1059399*	RS2-DN65 (PN16)	45	25	48,7	185	25	145	16	1	pcs
1059400	RS3-DN80 (PN6)	38	18	78,1	190	18	150	6	1	pcs
1029129*	RS3-DN80 (PN16)	45		78,1	200	25	160	16	1	pcs
1059401	RS3-DN100 (PN6)	41	21	78,1	210	21	170	6	1	pcs
1029130	RS3-DN100 (PN16)	44		78,1	220	24	180	16	1	pcs

Uponor RS lock pin

- made of plastic
- to lock the RS insert to the RS base part.



Item no.	Dimension	colour	Qty 1	UOM
1042921	RS2 black	black	10	pcs
1042922	RS3 grey	grey	10	pcs

Uponor Uni-X

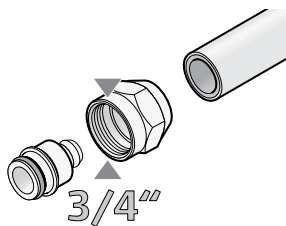

Uponor Uni-X is a compression fittings range of 3/4" eurocone connectors, metrical conus and adaptors for tap water and heating/cooling application.

Your benefits

- Simple adaption to other pipes and systems
- Flexible system design
- No special tools required



Application

- For the distribution of heating water for the radiator connection

Uponor Uni-X compression adapter MLC

- Compression adapter, union nut and inner sleeve
- made of brass
- For connection of Uponor Uni Pipe PLUS and MLC pipes to manifolds (eg. Uponor manifold H).
- Female thread 3/4" eurocone according to EN ISO 228-1

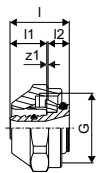

Item no.	Dimension	l	l1	G	z1	Qty 2	Qty 1	UOM
		mm	mm	"	mm			
1058089	14-3/4"FT Euro	23	13	3/4	3	25	1	pcs
1058090	16-3/4"FT Euro	23	13	3/4	3	25	1	pcs
1058092	20-3/4"FT Euro	24	14	3/4	3	25	1	pcs
1058093	25-3/4"FT Euro	27	14	3/4	7	25	1	pcs

Uponor Uni-X compression adapter MLC

- Compression adapter, union nut and inner sleeve made of brass
- For connection of Uponor Uni Pipe PLUS and MLC pipes to radiator valves similar to Comap and Herz with M22 threads.
- No bevel.

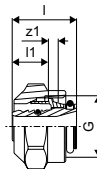

Item no.	Dimension	l	l1	l2	M	z1	Qty 2	Qty 1	UOM
		mm	mm	mm	mm	mm			
1058094	16-M22	23	13		22	4	25	1	pcs

Uponor Uni-X

Uponor Uni-X compression adapter MLC

- Compression adapter, union nut and inner sleeve made of brass
- For connection of Uponor MLC pipes to radiator valves similar to Oventrop and Heimeier with M24x1,5 threads
- No bevel.

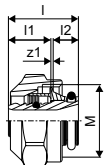

Item no.	Dimension	l	l1	M	z1	Qty 2	Qty 1	UOM
		mm	mm	mm	mm			
1058095	16-M24	23	13	24	4	25	1	pcs

Uponor Uni-X coupling male thread

- Made of tin-plated brass
- Female thread acc.to EN 10226-1
- Male thread acc. to EN ISO 228-1.

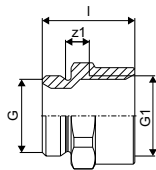

Item no.	Dimension	l	G	G1	z1	Qty 2	Qty 1	UOM
		mm	"	"	mm			
1014143	3/4"MT-3/4"FT Euro	31	3/4	3/4	8	80	10	pcs

Uponor Uni-X coupling plated

- Made of tin-plated brass
- Male thread acc. to EN ISO 228-1.

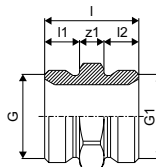

Item no.	Dimension	l	l1	l2	G	G1	z1	Qty 2	Qty 1	UOM
		mm	mm	mm	"	"	mm			
1006641	G3/4"MT Euro-G3/4"MT Euro	27	10	10	3/4	3/4	7	80	10	pcs

Uponor Uni-X

Uponor Uni-X elbow male thread

- Made of tin-plated brass
- Male thread acc. to EN ISO 228-1.

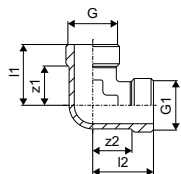

Item no.	Dimension	l1 mm	l2 mm	G "	G1 "	z1 mm	z2 mm	Qty 2	Qty 1	UOM
1014145	3/4"MT-3/4"MT Euro	30	30	3/4	3/4	19	19	80	10	pcs

Uponor Uni-X tee male thread

- Made of tin-plated brass
- Male thread acc. to EN ISO 228-1.

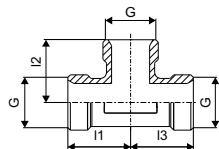

Item no.	Dimension	l1 mm	l2 mm	l3 mm	G "	G1 "	G2 "	Qty 2	Qty 1	UOM
1014147	3/4"MT-3/4"MT-3/4"MT	30	30	30	3/4	3/4	3/4	40	5	pcs

Uponor Uni-C

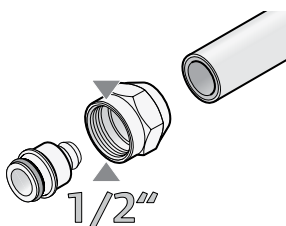

Uponor Uni-C 1/2" threaded compression manifolds made of tin-plated brass is a range of fittings and adaptors designed for tap water and heating/cooling application.

Your benefits

- Easily adaptable to other systems
- Installation flexibility
- No special tools required



Uponor Smart Aqua tap elbow Uni-C

- Made of tin-plated brass
- For on wall installation or attachment with rotation protection to the MLCP mounting angles and plate
- Male thread acc. to DIN EN ISO 228-1.

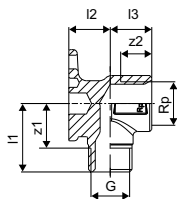

Item no.	Dimension	I1	I2	I3	Rp	R	z1	z2	Qty 2	Qty 1	UOM
		mm	mm	mm	"	"	mm	mm			
1015559	1/2"MT-1/2"FT	33	20	20	1/2	1/2	22	5	40	10	pcs



- Pe-Xa pipe from highest quality cross-linked polyethylene
- Extremely flexible for easy and quick installation
- Designed for tap water delivery and heating/cooling applications
- All our tap water systems meet the highest hygiene standards confirmed by tap water approvals

Flexible Pipe Systems

Pipes

Aqua Pipe 44

Fittings

Q&E 46

RS 70

Uponor Aqua Pipe

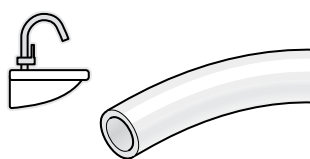

Uponor Aqua Pipe is manufactured from highest quality cross-linked polyethylene and is designed for tap water application as well as distribution pipes.

Your benefits

- Certified quality
- Corrosion resistant
- Thermal memory
- Lightweight and very flexible
- Durable



Specification

- Pipes manufactured from peroxide cross-linked polyethylene (PE-Xa) acc. EN ISO 15875
- Application class 2 - Hot water supply
- Fire classification E according to DIN EN 13501-1.
- Conduits manufactured from high density polyethylene

Application

- Tap water: The permanent operating temperature ranges from 0°C to 70°C. The short-term malfunction temperature is 95°C for a period of 100 hours in the operating life time.

Uponor Aqua Pipe natural PN6

- Operating pressure 6 bar
- Coils

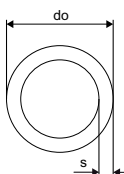

Item no.	Dimension	L m	do mm	s mm	p mm	bar	colour	Qty 2	Qty 1	UOM
1008386	16x2,0	100m	100	16	2,0	6	natural	1100	100	m
1008408	20x2,0	100m	100	20	2,0	6	natural	700	100	m
1017870	25x2,3	100m	100	25	2,3	6	natural	500	100	m
1048757	32x2,9	50m	50	32	2,9	6	natural	550	50	m
1033417	40x3,7	50m	50	40	3,7	6	natural	250	50	m
1033481	50x4,6	50m	50	50	4,6	6	natural	250	50	m
1033502	63x5,8	50m	50	63	5,8	6	natural		50	m
1033520	75x6,8	50m	50	75	6,9	6	natural		50	m

Uponor Aqua Pipe natural PN10

- Operating pressure 10 bar
- Coils

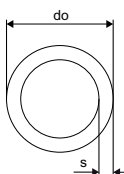

Item no.	Dimension	L m	do mm	s mm	p mm	bar	colour	Qty 2	Qty 1	UOM
1022682	16x2,2	100m	100	16	2,2	10	natural	1100	100	m
1001201	20x2,8	50m	50	20	2,8	10	natural	550	50	m
1001202	25x3,5	50m	50	25	3,5	10	natural	400	50	m
1001203	32x4,4	50m	50	32	4,4	10	natural	350	50	m
1008963*	40x5,5	50m	50	40	5,5	10	natural	350	50	m
1008964*	50x6,9	50m	50	50	6,9	10	natural		50	m

Uponor Aqua Pipe

Uponor Aqua Pipe natural PN10 S

- Operating pressure 10 bar
- Straight bars

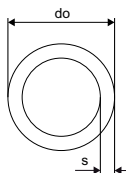

Item no.	Dimension	L m	do mm	s mm	p bar	colour	Qty 2	Qty 1	UOM
1001206	32x4,4 6m	6	32	4,4	10	natural		12	m
1033864*	40x5,5 6m	6	40	5,5	10	natural	60	6	m
1033865*	50x6,9 6m	6	50	6,9	10	natural	30	6	m
1023122*	63x8,6 6m	6	63	8,6	10	natural		6	m
1033866	90x12,3 6m	6	90	12,3	10	natural		6	m

Uponor Q&E

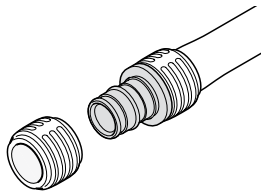

Uponor Q&E is a unique and innovative fittings system that uses the shrink-back effect of cross-linked polyethylene PE-Xa pipes for quick and easy installation. A wide range of fittings and accessories makes Q&E a complete

and secure system for cost-effective installation. Corrosion resistance makes it safe, secure and watertight.

Your benefits

- Elasticity of PE-Xa pipes for high safety
- Corrosion resistant
- Low pressure loss
- Ergonomic design of ring
- Easy identification of ring dimension



Specification

- Q&E fittings and rings for Uponor Pex pipes
- Metal fittings are made of high quality brass
- Plastic fittings are made of polyphenilsulphone
- Q&E rings must be ordered separately if not different mentioned

Application

if not different mentioned:

- Male and female threads acc.to EN 10226-1.

Uponor Q&E evolution ring red

- Connical liner shape
- With stop edge
- PE material

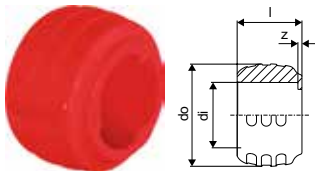

Item no.	Dimension	l mm	di mm	do mm	z mm	p bar	colour	Qty 2	Qty 1	UOM
1058010	16	16	16,2	25,3	1	6+10	red	900	20	pcs
1058011	20	20	20,2	29,2	1	6+10	red	520	20	pcs
1058012	25	25	25,3	34,6	1	6+10	red	300	20	pcs

Uponor Q&E evolution ring blue

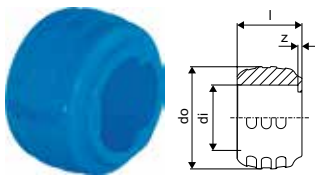

Item no.	Dimension	l mm	di mm	do mm	z mm	p bar	colour	Qty 2	Qty 1	UOM
1058013	16	16	16,2	25,3	1	6+10	blue	900	20	pcs
1058014	20	20	20,2	29,2	1	6+10	blue	520	20	pcs
1058015	25	25	25,3	34,6	1	6+10	blue	300	20	pcs

Uponor Q&E

Uponor Q&E ring with stop edge natural

- With stop edge
- Pex material

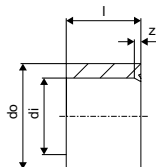

Item no.	Dimension	l mm	di mm	do mm	z mm	p bar	colour	Qty 2	Qty 1	UOM
1045464	40	41	40,8	50,2	3	6+10	natural	80	5	pcs
1045489	50	50	51	63	4	6+10	natural	70	5	pcs
1045490	63	63	64,3	75,7	4	6+10	natural	35	5	pcs
1085087	75	76	76,3	88,3	4	6+10	natural	18	2	pcs

Uponor Q&E manifold PPSU

- Main connection for Q&E 25 mm

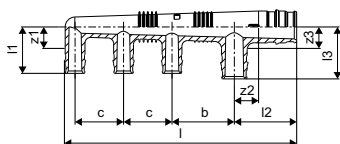

Item no.	Dimension	l mm	l1 mm	l2 mm	l3 mm	z1 mm	z2 mm	z3 mm	b mm	b1 mm	outlets	p bar	Qty 2	Qty 1	UOM
1008718	25, 3X16 c/c45+35	133	34	45	34	16	18	16	45	35	3	6+10	15	1	pcs
1008719	25 4X16 c/c45+2X35	168	34	45	34	16	18	16	45	35	4	6+10	15	1	pcs

Uponor Q&E manifold male thread PPSU

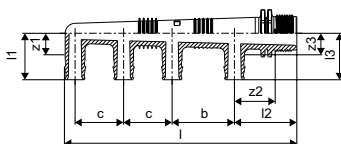

Item no.	Dimension	l mm	l1 mm	l2 mm	l3 mm	z1 mm	z2 mm	z3 mm	b mm	b1 mm	outlets	p bar	Qty 2	Qty 1	UOM
1008714	G3/4"MT 3X16 c/c45+35mm	133	34	45	34	16	29	16	45	35	3	6+10	10	1	pcs
1008715	G3/4"MT 4X16 c/c45+2X35mm	168	34	45	34	16	29	16	45	35	4	6+10	10	1	pcs
1008716	G3/4"MT 1X20+2X16 c/c45+35mm	133	34	45	38	16	29	16	45	35	3	6+10	10	1	pcs
1008717	G3/4"MT 1X20+3X16 c/c45+2X35mm	168	34	45	38	16	29	16	45	35	4	6+10	10	1	pcs

Uponor Q&E adapter male thread PPSU

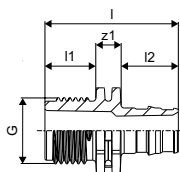

Item no.	Dimension	l mm	l1 mm	l2 mm	G "	z1 mm	p bar	Qty 2	Qty 1	UOM
1008661	16-G1/2"MT	42	16	18	1/2	8	6+10	100	5	pcs
1008662	20-G1/2"MT	46	16	22	1/2	8	6+10	90	5	pcs
1008663	20-G3/4"MT	48	18	22	3/4	8	6+10	1	5	pcs
1008664	25-G3/4"MT	54	18	28	3/4	8	6+10	50	5	pcs
1008665	25-G1"MT	58	23	28	1	8	6+10	40	5	pcs

Uponor Q&E

Uponor Q&E adapter female thread PPSU

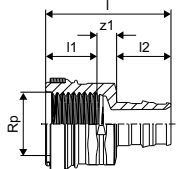

Item no.	Dimension	l	l1	l2	Rp	z1	p	Qty 2	Qty 1	UOM
		mm	mm	mm	"	mm	bar			
1042329	16-Rp1/2"FT	42	17	18	1/2	7	6+10	80	5	pcs
1042330	20-Rp1/2"FT	45	17	22	1/2	6	6+10	60	5	pcs
1042331	20-Rp3/4"FT	47	18	22	3/4	7	6+10	50	5	pcs
1042332	25-Rp3/4"FT	52	18	28	3/4	6	6+10	40	5	pcs

Uponor Q&E elbow PPSU

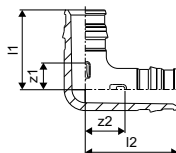

Item no.	Dimension	l1	l2	z1	z2	p	Qty 2	Qty 1	UOM
		mm	mm	mm	mm	bar			
1008679	16-16	27	32	9	13	6+10	100	5	pcs
1008680	20-20	34	39	12	16	6+10	40	5	pcs
1008681	25-25	42	47	14	19	6+10	25	5	pcs
1001245	32-32	53	59	18	23	6+10	15	1	pcs
1008683	40-40	65	74	21	29	6+10	10	1	pcs
1042859	50-50	83	98	29	44	6+10	5	1	pcs
1042858	63-63	100	112	33	44	6+10	3	1	pcs
1085080	75-75	149	149	64	65	6+10	2	1	pcs

Uponor Q&E elbow adapter male thread PPSU

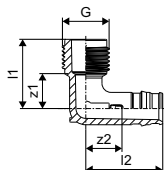

Item no.	Dimension	l1	l2	G	z1	z2	p	Qty 2	Qty 1	UOM
		mm	mm	"	mm	mm	bar			
1008666	16-G1/2"MT	31	34	1/2	15	16	6+10	80	5	pcs
1008667	20-G1/2"MT	31	38	1/2	15	16	6+10	60	5	pcs
1008668	25-G3/4"MT	36	42	3/4	18	15	6+10	40	5	pcs

Uponor Q&E elbow adapter female thread PPSU

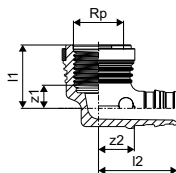

Item no.	Dimension	l1	l2	Rp	z1	z2	p	Qty 2	Qty 1	UOM
		mm	mm	"	mm	mm	bar			
1042334	16-Rp1/2"FT	27	33	1/2	10	15	6+10	50	5	pcs
1042335	20-Rp1/2"FT	27	38	1/2	9	16	6+10	50	5	pcs
1042336	20-Rp3/4"FT	30	41	3/4	12	19	6+10	40	5	pcs
1042337	25-Rp3/4"FT	32	47	3/4	14	19	6+10	35	5	pcs

Uponor Q&E

Uponor Q&E coupling PPSU

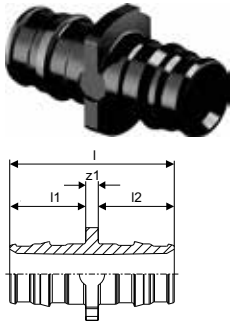

Item no.	Dimension	l mm	l1 mm	l2 mm	z1 mm	p bar	Qty 2	Qty 1	UOM
1008669	16-16	39	18	18	3	6+10	100	5	pcs
1008932	20-20	47	22	22	3	6+10	80	5	pcs
1008671	25-25	58	28	28	3	6+10	50	5	pcs
1001235	32-32	73	35	35	3	6+10	20	1	pcs
1008673	40-40	90	44	44	3	6+10	10	1	pcs
1042866	50-50	113	54	54	5	6+10	10	1	pcs
1042865	63-63	141	68	68	6	6+10	5	1	pcs
1085084	75-75	179	86	86	7	6+10	10	1	pcs

Uponor Q&E reducer PPSU

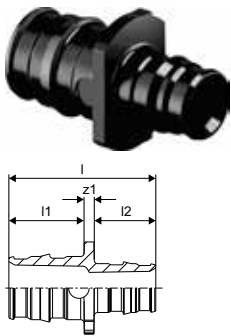

Item no.	Dimension	l mm	l1 mm	l2 mm	z1 mm	p bar	Qty 2	Qty 1	UOM
1008674	20-16	43	22	18	3	6+10	100	5	pcs
1008675	25-16	49	28	18	3	6+10	40	5	pcs
1008676	25-20	53	22	28	3	6+10	40	5	pcs
1001240	32-25	66	28	35	3	6+10	20	1	pcs
1008678	40-32	82	35	44	3	6+10	10	1	pcs
1042879	50-32	94	54	35	5	6+10	10	1	pcs
1042867	50-40	103	54	44	5	6+10	10	1	pcs
1042878	63-40	117	68	44	6	6+10	5	1	pcs
1042877	63-50	128	68	54	6	6+10	5	1	pcs
1085086	75-50	147	86	54	6	6+10	10	1	pcs
1085085	75-63	160	86	68	7	6+10	10	1	pcs

Uponor Q&E tee PPSU

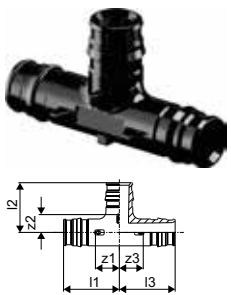

Item no.	Dimension	l1 mm	l2 mm	l3 mm	z1 mm	z2 mm	z3 mm	p bar	Qty 2	Qty 1	UOM
1008684	16-16-16	32	27	32	14	10	14	6+10	70	5	pcs
1008685	20-20-20	39	34	39	17	12	17	6+10	35	5	pcs
1008686	25-25-25	47	42	47	20	15	20	6+10	25	5	pcs
1001250	32-32-32	59	53	59	24	18	24	6+10	10	1	pcs
1008688	40-40-40	74	65	74	30	22	30	6+10	5	1	pcs
1042861	50-50-50	92	83	92	38	29	38	6+10	3	1	pcs
1042860	63-63-63	112	102	112	44	5	44	6+10	2	1	pcs
1085081	75-75-75	156	123	156	70	37	70	6+10	2	1	pcs

Uponor Q&E

Uponor Q&E tee reducer PPSU

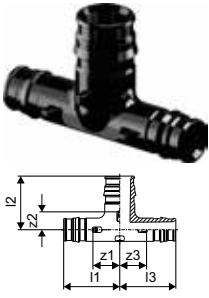

Item no.	Dimension	l1 mm	l2 mm	l3 mm	z1 mm	z2 mm	z3 mm	p bar	Qty 2	Qty 1	UOM
1008710	16-20-16	35	33	35	17	11	17	6+10	40	5	pcs
1008700	20-16-16	36	29	32	14	11	14	6+10	40	5	pcs
1008689	20-16-20	36	29	36	14	11	14	6+10	40	5	pcs
1008697	20-20-16	36	34	32	14	12	14	6+10	40	5	pcs
1008711	20-25-20	42	40	42	20	12	20	6+10	25	5	pcs
1008702	25-16-16	41	32	32	14	14	14	6+10	25	5	pcs
1008699	25-16-20	41	32	36	14	14	14	6+10	25	5	pcs
1008690	25-16-25	41	32	41	14	14	14	6+10	25	5	pcs
1008701	25-20-16	44	37	35	17	15	17	6+10	25	5	pcs
1008703	25-20-20	44	37	39	17	15	17	6+10	25	5	pcs
1008691	25-20-25	44	37	44	17	15	17	6+10	25	5	pcs
1001420	25-25-20	47	42	42	20	15	20	6+10	25	5	pcs
1008712	25-32-25	52	50	52	24	15	24	6+10	15	1	pcs
1001422	32-20-25	52	40	44	17	18	17	6+10	15	1	pcs
1001424	32-20-32	52	40	52	17	18	17	6+10	15	1	pcs
1008704	32-25-20	55	45	42	20	NaN	20	6+10	15	1	pcs
1001426	32-25-25	55	45	47	20	18	20	6+10	15	1	pcs
1001428	32-25-32	55	45	55	20	18	20	6+10	15	1	pcs
1008713	32-40-32	65	61	65	30	18	30	6+10	10	1	pcs
1008707	40-20-32	60	44	52	17	22	17	6+10	5	1	pcs
1008694	40-20-40	60	44	60	17	22	17	6+10	5	1	pcs
1008708	40-25-32	63	49	55	20	22	20	6+10	5	1	pcs
1008695	40-25-40	63	49	63	20	22	20	6+10	5	1	pcs
1008709	40-32-32	68	57	59	24	22	24	6+10	5	1	pcs
1008696	40-32-40	68	57	68	24	22	24	6+10	5	1	pcs
1042876	50-25-40	92	57	82	38	29	39	6+10	4	1	pcs
1042864	50-25-50	92	57	92	38	29	38	6+10	4	1	pcs
1042863	50-32-50	92	64	92	38	29	38	6+10	4	1	pcs
1042862	50-40-40	92	73	82	38	29	39	6+10	4	1	pcs
1042875	50-40-50	92	73	92	38	29	38	6+10	4	1	pcs
1042871	63-25-50	112	62	99	44	35	45	6+10	2	1	pcs
1042873	63-25-63	112	60	112	44	33	44	6+10	2	1	pcs
1042870	63-32-63	112	70	112	44	35	44	6+10	2	1	pcs
1042869	63-40-40	112	78	99	44	35	55	6+10	2	1	pcs
1042872	63-40-63	112	78	112	44	35	44	6+10	2	1	pcs
1042868	63-50-50	112	89	99	44	35	45	6+10	2	1	pcs
1042874	63-50-63	112	89	112	44	35	44	6+10	2	1	pcs
1085083	75-25-75	118	67	118	32	39	32	6+10	4	1	pcs
1085082	75-40-75	118	83	118	32	83	32	6+10	4	1	pcs

Uponor Q&E

Uponor Q&E tee adapter female thread PPSU

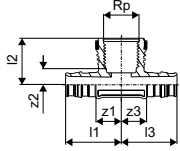

Item no.	Dimension	l1	l2	l3	Rp	z1	z2	z3	p	Qty 2	Qty 1	UOM
		mm	mm	mm	"	mm	mm	mm	bar			
1042338	16-Rp1/2"FT-16	33	28	33	1/2	15	10	15	6+10	50	5	pcs
1042339	20-Rp1/2"FT-20	38	27	38	1/2	16	10	16	6+10	40	5	pcs
1042340	25-Rp1/2"FT-25	43	30	43	1/2	15	13	15	6+10	25	5	pcs
1042341	25-Rp3/4"FT-25	47	31	47	3/4	19	13	19	6+10	25	5	pcs

Uponor Q&E adapter swivel nut PPSU

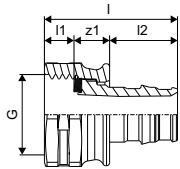

Item no.	Dimension	l	l1	l2	G	z1	p	Qty 2	Qty 1	UOM
		mm	mm	mm	"	mm	bar			
1038021	16-G1/2"SN	35	8	18	1/2	9	6+10	50	1	pcs

Uponor Q&E elbow adapter swivel nut PPSU

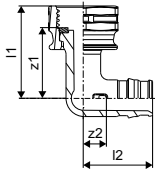
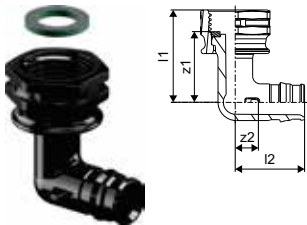

Item no.	Dimension	l1	l2	G	z1	z2	p	Qty 2	Qty 1	UOM
		mm	mm	"	mm	mm	bar			
1038037	16-G1/2"SN	36	27	1/2	28	9	6+10	40	1	pcs

Uponor Q&E manifold male female thread PL

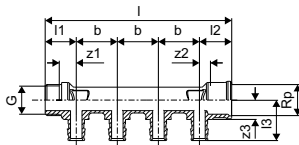

Item no.	Dimension	l	l1	l2	l3	G	Rp	z1	z2	b	outlets	p	Qty 2	Qty 1	UOM
		mm	mm	mm	mm	"	"	mm	mm	mm	-	bar			
1023027	3/4"MT/FT 2X16 c/c35mm	89	27	28	35	3/4	3/4	15	9	35	2	6+10	20	1	pcs
1023028	3/4"MT/FT 3X16 c/c35mm	124	27	28	35	3/4	3/4	15	9	35	3	6+10	15	1	pcs
1023029	3/4"MT/FT 4X16 c/c35mm	159	27	28	35	3/4	3/4	15	9	35	4	6+10	10	1	pcs

Uponor Q&E

Uponor Q&E manifold male female thread PL

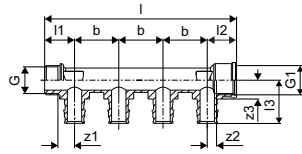

Item no.	Dimension	l	l1	l2	l3	G	G1	z1	z2	b	outlets	Qty 2	Qty 1	UOM
		mm	mm	mm	mm	"	"	mm	mm	mm	-			
1047925*	3/4"MT/FT 3X20 c/c40mm	134	27	27	39	3/4	3/4	15	12	40	3	15	1	pcs
1047926	3/4"MT/FT 4X20 c/c40mm	174	27	27	39	3/4	3/4	15	12	40	4	10	1	pcs

Uponor Q&E manifold male female thread DR

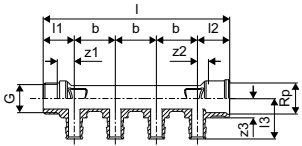

Item no.	Dimension	l	l1	l2	l3	G	Rp	z1	z2	z3	b	outlets	p	bar	Qty 2	Qty 1	UOM
		mm	mm	mm	mm	"	"	mm	mm	mm	mm	-	bar				
1063756	3/4"MT/FT 2X16 c/c35mm	89	27	28	35	3/4	3/4	15	9	17	35	2	6+10		20	1	pcs
1063757	3/4"MT/FT 3X16 c/c35mm	124	27	28	35	3/4	3/4	15	9	17	35	3	6+10		15	1	pcs
1063758	3/4"MT/FT 4X16 c/c35mm	159	27	28	35	3/4	3/4	15	9	17	35	4	6+10		10	1	pcs

Uponor Q&E manifold male female, valve PL SH

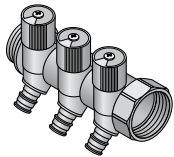

Item no.	Dimension	outlets	d	IG	p	bar	Qty 2	Qty 1	UOM
		-	mm	"	bar				
1048520	1"MT/FT 2X16 c/c38mm	2	16	G 1	6+10		32	1	pcs
1048521	1"MT/FT 3X16 c/c38mm	3	16	G 1	6+10		32	1	pcs
1048522	1"MT/FT 4X16 c/c38mm	4	16	G 1	6+10		24	1	pcs

Uponor Aqua PLUS bracket SH

■ Manifolds and accessories



Item no.	Dimension	Qty 2	Qty 1	UOM
1045451*	3/4" 1"	25	1	set

Uponor Q&E adapter male thread PL

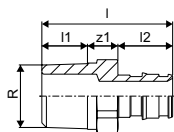

Item no.	Dimension	l	l1	l2	R	z1	p	Qty 2	Qty 1	UOM
		mm	mm	mm	"	mm	bar			
1023003	16-R1/2"MT	43	15	18	1/2	10	6+10	100	5	pcs
1023004	16-R3/4"MT	46	17	18	3/4	11	6+10	80	5	pcs
1023005	20-R1/2"MT	47	15	22	1/2	10	6+10	100	5	pcs
1023006	20-R3/4"MT	50	17	22	3/4	11	6+10	70	5	pcs
1023007	25-R3/4"MT	55	17	27	1/2	11	6+10	70	5	pcs
1023008	25-R1"MT	58	20	27	3/4	11	6+10	40	5	pcs
1047191	32-R1"MT	65	21	34	3/4	10	6+10	10	1	pcs

Uponor Q&E

Uponor Q&E adapter male thread PL/DR

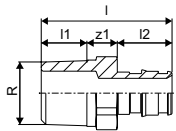

Item no.	Dimension	l mm	l1 mm	l2 mm	R "	z1 mm	p bar	Qty 2	Qty 1	UOM
1085077	40-R1 1/4"MT	73	19	42	1 1/4	12	6+10	16	1	pcs
1085076	50-R1 1/2"MT	89	20	52	1 1/2	17	6+10	8	1	pcs
1085075	63-R2"MT	100	24	65	2	11	6+10	6	1	pcs
1085074	75-R2 1/2"MT	126	27	86	2 1/2	13	6+10	6	1	pcs

Uponor Q&E adapter male thread PL

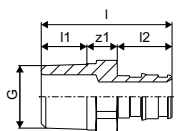

Item no.	Dimension	l mm	l1 mm	l2 mm	G "	z1 mm	p bar	Qty 2	Qty 1	UOM
1047862	25-G3/4"MT	48	11	27	3/4	10	6+10	40	5	pcs
1047863	25-G1"MT	49	11	27	1	11	6+10	40	5	pcs
1047864	50-G1 1/2"MT	82	17	52	1 1/2	13	6+10	8	1	pcs

Uponor Q&E adapter male thread PL W

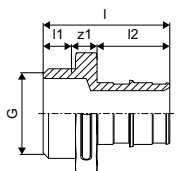

Item no.	Dimension	l mm	l1 mm	l2 mm	G "	z1 mm	p bar	Qty 2	Qty 1	UOM
1008730	32-G1"MT	56	10	34	1	12	6+10	20	1	pcs
1008732	40-G1 1/4"MT	68	14	42	1 1/4	12	6+10	8	1	pcs
1008866	50-G1 1/4"MT	78	14	52	1 1/4	12	6+10	8	1	pcs
1008867	63-G2"MT	95	17	65	2	13	6+10	6	1	pcs

Uponor Q&E adapter male thread DR

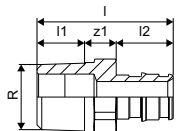

Item no.	Dimension	l mm	l1 mm	l2 mm	R "	z1 mm	e mm	k mm	o mm	p bar	Qty 2	Qty 1	UOM
1063732	16-R1/2"MT	43	11	18	1/2	14				6+10	100	5	pcs
1063733	16-R3/4"MT	46	11	18	3/4	16				6+10	80	5	pcs
1063734	20-R1/2"MT	47	11	22	1/2	14				6+10	100	5	pcs
1063735	20-R3/4"MT	50	13	22	3/4	15	78	160	200	6+10	70	5	pcs
1063736	25-R3/4"MT	55	13	22	3/4	20	78	180	220	6+10	70	5	pcs
1063737	25-R1"MT	58	15	27	1	16				6+10	40	5	pcs
1063806	32-R1"MT	65	15	34	1	17				6+10	20	1	pcs

Uponor Q&E

Uponor Q&E adapter male thread DR W

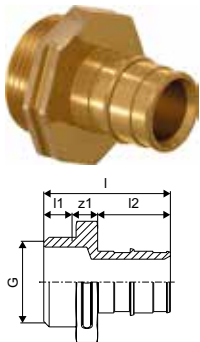

Item no.	Dimension	l	l1	l2	G	z1	p	Qty 2	Qty 1	UOM
		mm	mm	mm	"	mm	bar			
1063810	25-G1"MT	47	11	27	1	9	6+10	35	5	pcs
1063724	32-G1"MT	56	10	34	1	12	6+10	10	1	pcs
1063725	40-G1 1/4"MT	68	14	42	1 1/4	12	6+10	16	1	pcs
1063727	50-G1 1/4"MT	78	14	52	1 1/4	12	6+10	8	1	pcs
1063728	63-G2"MT	95	17	65	2	13	6+10	6	1	pcs

Uponor Q&E adapter male thread, rings DR

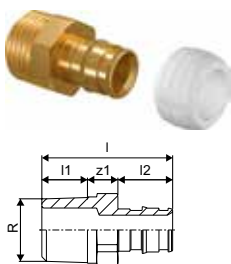

Item no.	Dimension	l	l1	l2	G	z1	Qty 2	Qty 1	UOM
		mm	mm	mm	"	mm			
1063812	16-G1/2"MT	36	9	18	1/2	9	100	5	pcs
1063813	20-G3/4"MT	43	11	22	3/4	10	70	5	pcs
1063814	25-G3/4"MT	48	11	27	3/4	10	40	5	pcs

Uponor Q&E adapter female thread PL

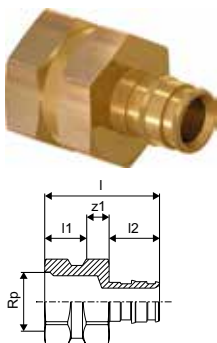

Item no.	Dimension	l	l1	l2	Rp	z1	p	Qty 2	Qty 1	UOM
		mm	mm	mm	"	mm	bar			
1023009	16-Rp1/2"FT	41	15	18	1/2	8	6+10	60	5	pcs
1023010	20-Rp1/2"FT	44	15	22	1/2	7	6+10	60	5	pcs
1023011	20-Rp3/4"FT	46	18	22	3/4	6	6+10	40	5	pcs
1023012	25-Rp3/4"FT	51	18	27	3/4	6	6+10	40	5	pcs
1023013	25-Rp1"FT	55	22	27	1	6	6+10	35	5	pcs

Uponor Q&E adapter female thread PL/DR

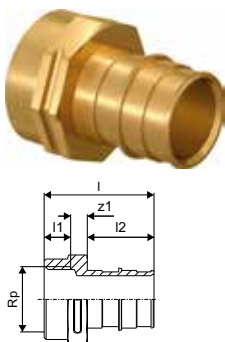

Item no.	Dimension	l	l1	l2	Rp	z1	p	Qty 2	Qty 1	UOM
		mm	mm	mm	"	mm	bar			
1085078	50-RP1 1/2"FT	92	21	52	1 1/2	19	6+10	8	1	pcs

Uponor Q&E

Uponor Q&E adapter female thread PL

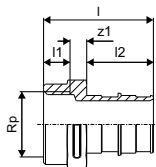

Item no.	Dimension	l mm	l1 mm	l2 mm	G "	z1 mm	p bar	Qty 2	Qty 1	UOM
1047866	32-G1"FT	56	13	34	1	9	6+10	20	1	pcs
1047867	40-G1 1/4"FT	68	16	42	1 1/4	10	6+10	20	1	pcs

Uponor Q&E adapter female thread DR

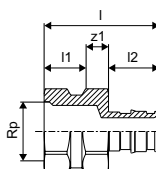

Item no.	Dimension	l mm	l1 mm	l2 mm	Rp "	z1 mm	p bar	Qty 2	Qty 1	UOM
1063738	16-Rp1/2"FT	41	15	18	1/2	8	6+10	60	5	pcs
1063739	20-Rp1/2"FT	44	15	22	1/2	7	6+10	60	5	pcs
1063740	20-Rp3/4"FT	46	18	22	3/4	6	6+10	40	5	pcs
1063741	25-Rp3/4"FT	51	18	27	3/4	6	6+10	40	5	pcs

Uponor Q&E elbow PL

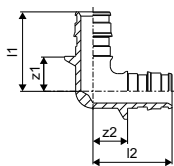

Item no.	Dimension	l1 mm	l2 mm	z1 mm	z2 mm	p bar	Qty 2	Qty 1	UOM
1047199*	25-25	48	39	12	21	6+10	25	5	pcs

Uponor Q&E elbow adapter male thread PL

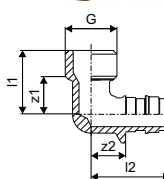

Item no.	Dimension	l1 mm	l2 mm	G "	z1 mm	z2 mm	p bar	Qty 2	Qty 1	UOM
1023019	16-G1/2"MT	26	32	1/2	16	14	6+10	80	5	pcs
1023020	20-G1/2"MT	29	33	1/2	17	21	6+10	50	5	pcs
1023021	20-G3/4"MT	29	36	3/4	18	14	6+10	40	5	pcs
1023022	25-G3/4"MT	29	41	3/4	20	14	6+10	40	5	pcs
1047877	32-G1"MT	49	60	1	26	26	6+10	20	1	pcs
1047878	40-G1 1/4"MT	61	74	1 1/4	46	32	6+10	10	1	pcs

Uponor Q&E

Uponor Q&E elbow adapter male thread DR

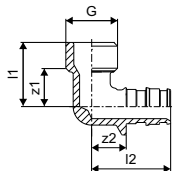

Item no.	Dimension	l1 mm	l2 mm	G "	z1 mm	z2 mm	p bar	Qty 2	Qty 1	UOM
1063748	16-G1/2"MT	26	32	1/2	16	14	6+10	80	5	pcs
1063750	20-G3/4"MT	29	36	3/4	18	14	6+10	40	5	pcs
1063751	25-G3/4"MT	29	41	3/4	20	14	6+10	40	5	pcs

Uponor Q&E elbow adapter female thread PL

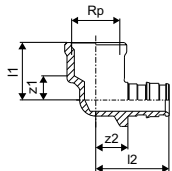

Item no.	Dimension	l1 mm	l2 mm	G "	z1 mm	z2 mm	p bar	Qty 2	Qty 1	UOM
1023023	16-G1/2"FT	25	32	1/2	11	14	6+10	70	5	pcs
1023024	20-G1/2"FT	25	36	1/2	11	14	6+10	50	5	pcs
1023025	20-G3/4"FT	26	39	3/4	10	17	6+10	30	5	pcs
1023026	25-G3/4"FT	26	44	3/4	10	17	6+10	35	5	pcs

Uponor Q&E elbow adapter female thread DR

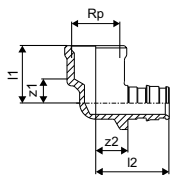

Item no.	Dimension	l1 mm	l2 mm	G "	z1 mm	z2 mm	p bar	Qty 2	Qty 1	UOM
1063752	16-G1/2"FT	25	32	1/2	11	14	6+10	70	5	pcs
1063753	20-G1/2"FT	25	36	1/2	11	14	6+10	50	5	pcs
1063754	20-G3/4"FT	26	39	3/4	10	17	6+10	30	5	pcs
1063755	25-G3/4"FT	26	44	3/4	10	17	6+10	35	5	pcs

Uponor Q&E tee adapter female thread PL

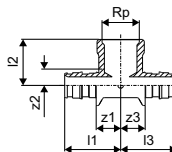

Item no.	Dimension	l1 mm	l2 mm	l3 mm	Rp1 "	z1 mm	z2 mm	z3 mm	p bar	Qty 2	Qty 1	UOM
1047885	16-Rp1/2"FT-16	32	26	32	1/2	14	9	14	6+10	50	5	pcs
1047886	20-Rp1/2"FT-20	36	28	36	1/2	14	11	14	6+10	30	5	pcs
1047888	25-Rp3/4"FT-25	44	34	44	3/4	17	16	17	6+10	20	5	pcs
1047201	32-Rp1"FT-32	59	49	59	1	25	28	25	6+10	10	1	pcs

Uponor Q&E

Uponor Q&E tee adapter female thread DR

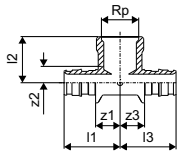

Item no.	Dimension	l1	l2	l3	Rp	z1	z2	z3	p	Qty 2	Qty 1	UOM
		mm	mm	mm	"	mm	mm	mm	bar			
1063808	32-Rp1"FT-32	59	49	59	1	25	27	25	6+10	10	1	pcs

Uponor Q&E adapter swivel nut PL

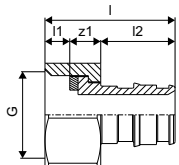

Item no.	Dimension	l	l1	l2	G	z1	p	Qty 2	Qty 1	UOM
		mm	mm	mm	"	mm	bar			
1023014	16-G1/2"SN	32	6	18	1/2	8	6+10	100	5	pcs
1023015	20-G1/2"SN	42	8	22	1/2	13	6+10	60	5	pcs
1023016	20-G3/4"SN	36	7	22	3/4	8	6+10	50	5	pcs
1023017	25-G3/4"SN	49	7	27	3/4	15	6+10	45	5	pcs
1023018	25-G1"SN	44	10	27	1	7	6+10	40	5	pcs

Uponor Q&E adapter swivel nut DR

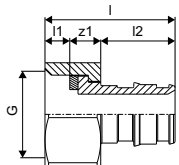

Item no.	Dimension	l	l1	l2	G	z1	p	Qty 2	Qty 1	UOM
		mm	mm	mm	"	mm	bar			
1063743	16-G1/2"SN	32	6	18	1/2	8	6+10	100	5	pcs
1063744	20-G1/2"SN	42	8	22	1/2	12	6+10	60	5	pcs
1063745	20-G3/4"SN	36	7	22	3/4	7	6+10	50	5	pcs
1063746	25-G3/4"SN	49	7	27	3/4	15	6+10	45	5	pcs

Uponor Q&E elbow adapter swivel nut PL

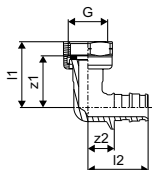

Item no.	Dimension	l1	l2	G	z1	z2	p	Qty 2	Qty 1	UOM
		mm	mm	"	mm	mm	bar			
1047879	16-G1/2"SN	35	32	1/2	28	14	6+10	70	5	pcs
1047880	20-G1/2"SN	37	33	1/2	29	11	6+10	50	5	pcs
1047881	20-G3/4"SN	39	36	3/4	32	14	6+10	35	5	pcs
1047882	25-G3/4"SN	39	41	3/4	32	14	6+10	35	5	pcs

Uponor Q&E

Uponor Q&E adapter DR S-Press

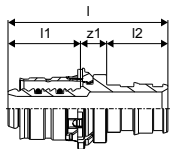

Item no.	Dimension	l mm	l1 mm	l2 mm	z1 mm	Qty 2	Qty 1	UOM
1062845	16-Q&E16	47	22	18	8	10	1	pcs
1062846	20-Q&E20	52	23	22	8	10	1	pcs
1062861	25-Q&E25	65	31	27	8	10	1	pcs

Uponor Q&E adapter for soldering PL

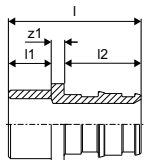

Item no.	Dimension	l mm	l1 mm	l2 mm	z1 mm	p bar	Qty 2	Qty 1	UOM
1047938	16-12CU	31	10	18	3	6+10	100	5	pcs
1023040	16-15CU	34	13	18	3	6+10	100	5	pcs
1023041	20-15CU	38	13	22	3	6+10	100	5	pcs
1047940	20-18CU	38	13	22	3	6+10	80	5	pcs
1047941	20-22CU	38	13	22	3	6+10	80	5	pcs
1023042	25-22CU	43	13	27	3	6+10	40	5	pcs

Uponor Q&E adapter DR

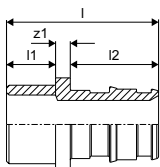

Item no.	Dimension	l mm	l1 mm	l2 mm	z1 mm	p bar	Qty 2	Qty 1	UOM
1008734	16-15CU l=16mm	36	15	18	3	6+10	100	5	pcs
1008736	20-22CU l=20mm	45	20	22	3	6+10	100	5	pcs

Uponor Q&E stop end

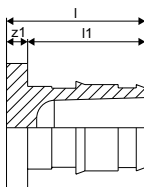

Item no.	Dimension	l mm	l1 mm	z1 mm	Qty 2	Qty 1	UOM
1084671	16	23	20	4	200	20	pcs

Uponor Q&E

Uponor Q&E valve concealed PL



Item no.	Dimension	d mm	p bar	l mm	l1 mm	z mm	z1 mm	Qty 2	Qty 1	UOM
1038419	16-16	16	6+10	38,6	28	20,6	10	10	1	pcs
1038420	20-20	20	6+10	39	34,1	17	12,1	10	1	pcs
1038421	25-25	25	6+10	44,8	40,5	17,8	13,5	10	1	pcs

Uponor Flex con. valve, long handle

- Chrome plated lever and cover rosette.
- For Concealed valves.

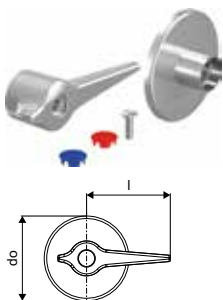

Item no.	l mm	do mm	Qty 2	Qty 1	UOM
1023161	67	67,8	10	10	pcs

Uponor Flex con valve, public handle

- Chrome plated lever and cover rosette.
- For Concealed valves.

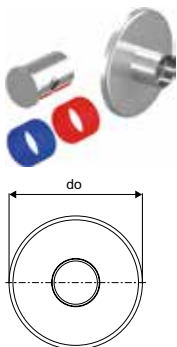

Item no.	do mm	Qty 2	Qty 1	UOM
1023162	67,8	10	1	pcs

Uponor Flex con valve, wheel handle

- For Concealed valves.



Item no.	Qty 2	Qty 1	UOM
1038462	10	1	pcs

Uponor Flex con valve handle extension

- For Concealed valves.



Item no.	Qty 1	UOM
1023163	10	pcs

Uponor Q&E

Uponor Smart Aqua

Specification

- Elbows for tap connection and
- Q&E rings must be ordered separately if not different mentioned

Application

- For tap water installations

if not different mentioned:

- Male and female threads acc.to EN 10226-1.

Uponor Smart Aqua U-tap elbow Q&E

- U elbow for loop installation

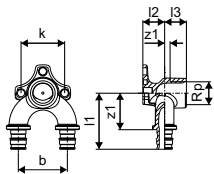

Item no.	Dimension	l1	l2	l3	Rp	z1	z2	b	k	Qty 2	Qty 1	UOM
		mm	mm	mm	"	mm	mm	mm	mm			
1059820*	16-Rp1/2"FT-16	52	20	20	1/2	34	5	45	40	5	1	pcs
1059821*	20-Rp1/2"FT-20	56	20	20	1/2	35	5	45	40	5	1	pcs

Uponor Smart Aqua tap elbow Q&E PL

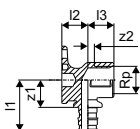

Item no.	Dimension	l1	l2	l3	Rp	z1	z2	p	Qty 2	Qty 1	UOM
		mm	mm	mm	"	mm	mm	bar			
1059822	16-Rp1/2"FT	39	20	20	1/2	21	5	6+10	40	5	pcs
1059823	20-Rp1/2"FT	40	20	20	1/2	18	5	6+10	40	5	pcs

Uponor Smart Aqua tap elbow Q&E DR M

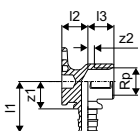

Item no.	Dimension	l1	l2	l3	Rp	z1	z2	p	Qty 2	Qty 1	UOM
		mm	mm	mm	"	mm	mm	bar			
1063871	16-1/2"	39	20	20	1/2	21	5	6+10	40	5	pcs

Uponor Q&E

Uponor Smart Aqua mounting angle

- Made of galvanized steel.
- For the installation of Uponor Smart Aqua tap elbows
- Positioning of the connections in the given raster
- Plastic pins and loss protected screws M6x12 acc. DIN 965 included
- With holes and slots for easy attachment

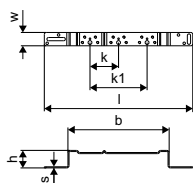
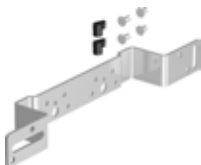

Item no.	Dimension	l mm	s mm	b mm	h mm	k mm	k1 mm	w mm	Qty 2	Qty 1	UOM
1057841	80mm	320	3	196	46	80		35	270	5	pcs
1057839	100mm	340	3	216	46	100		35		5	pcs
1057842	75/150mm	390	3	266	46	75	150	35	165	5	pcs

Uponor Smart Aqua tap elbow mount. plate

- Made of galvanized steel.
- For the installation of Uponor Smart Aqua tap elbows
- Positioning of the connections in the given raster
- Plastic pins and loss protected screws M6x12 acc. DIN 965 included
- With holes and slots for easy attachment

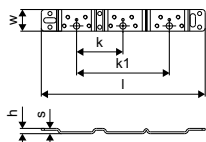

Item no.	Dimension	l mm	s mm	h mm	k mm	k1 mm	w mm	Qty 2	Qty 1	UOM
1057840	75/150mm	265	3,0	9	75	150	35	5	1	pcs

Uponor Smart Aqua single mounting angle

- Made of galvanized steel.
- For the installation of Uponor Smart Aqua tap elbows.
- Positioning of the connections in the given raster.
- Screws M6x12 acc. DIN 965 included. With holes and slots for easy attachment

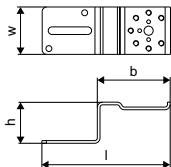
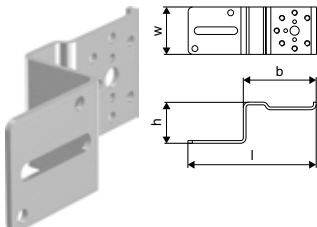

Item no.	l mm	b mm	h mm	Qty 2	Qty 1	UOM
1057843	144	82	46	5	1	pcs

Uponor Q&E

Uponor Smart Aqua mounting rack

- Made of galvanized steel.
- For the installation of Uponor Smart Aqua tap elbows.
- Positioning of the connections in the given raster.
- Screws M6x12 acc. DIN 965 included. With holes and slots for easy attachment

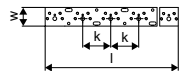

Item no.	Dimension	l mm	k mm	Qty 2	Qty 1	UOM
1057844	2m	2000	75	10	1	pcs

Uponor MLC mounting rack bending tool

- For bending the 2 meter long mounting track.



Item no.	Dimension	Qty 1	UOM
1015424	2m	1	pcs

Uponor Smart Aqua 10 pins+20 screws

- Pins and screws for mounting plates, angles and tracks.

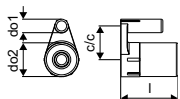

Item no.	l mm	do1 mm	do2 mm	c/c1 mm	Qty 1	UOM
1057847	17	4	10	10	1	set

Uponor Smart Aqua tap elbow Q&E PPSU

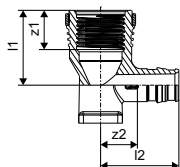

Item no.	Dimension	l1 mm	l2 mm	l3 mm	Rp "	z1 mm	z2 mm	k mm	p bar	Qty 2	Qty 1	UOM
1042342	16-Rp1/2" l=43mm	34	17	27	1/2	16	10	36	6+10	40	5	pcs
1042343	20-Rp1/2" l=43mm	38	17	27	1/2	16	10	36	6+10	30	5	pcs

Uponor Q&E

Uponor Smart Aqua tap elbow long Q&E PPSU

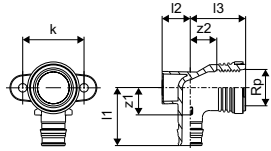

Item no.	Dimension	l1	l2	l3	Rp	z1	z2	k	p	Qty 2	Qty 1	UOM
		mm	mm	mm	mm	mm	mm	mm	bar			
1042344	16-Rp1/2" l=49mm	34	165	33	1/2	16	16	36	6+10	35	5	pcs

Uponor Smart Aqua tap elbow Q&E PL

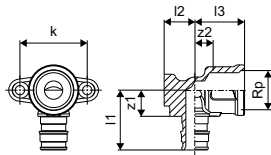

Item no.	Dimension	l1	l2	l3	Rp	z1	z2	k	p	Qty 2	Qty 1	UOM
		mm	mm	mm	mm	mm	mm	mm	bar			
1023034	16-Rp1/2"FT l=43mm	32	17	27	1/2	14	10	36	6+10	40	5	pcs
1023035	20-Rp1/2"FT l=43mm	36	17	27	1/2	14	10	36	6+10	40	5	pcs

Uponor Q&E

Uponor Aqua PLUS

Specification

- Watertight cabinets according to NT VVS 129
- For manifolds with c/c 50 mm
- For M7 cabinet sleeves
- Includes cabinte, splash covers and accesory kit with manifold clips
- Doors and frames (if needed) should be ordered separately
- RAL 9010
- Plastic manifolds for installation in Watertight cabinets
- Manifolds and accesories can be used separtelly
- In case of use only manifolds without cabintes system watertightness acc to NT VVS 129 cannot be guaranteed
- Metal fittings are made of high quality brass
- Plastic fittings are made of polyphenilsulphone
- PPM manifolds with bayonet threads

Application

- Watertight installations to prevent from damages in case of leakage
- All types of manifold installations

Uponor Aqua PLUS manifold double, rings Q&E PPM

- White Q&E evolution rings included

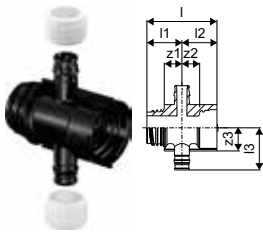

Item no.	Dimension	l	l1	l2	l3	z1	z2	z3	outlets	Qty 2	Qty 1	UOM
		mm	mm	mm	mm	mm	mm	mm	-			
1063784	1"MT/FT 1X16+1X16 c/c50mm	67	33	33	40	17	17	22	2	15	1	pcs

Uponor Aqua PLUS manifold Q&E PPM



Item no.	Dimension	l	l1	l2	l3	z1	z2	z3	b	outlets	p	Qty 2	Qty 1	UOM
		mm	mm	mm	mm	mm	mm	mm	mm	-	bar			
1047999	1" 2X16 c/c50mm	117	33	33	40	17	17	22	50	2	6+10	10	1	pcs
1048000	1" 3X16 c/c50mm									3	6+10	8	1	pcs
1048001	1" 4X16 c/c50mm									4	6+10	6	1	pcs

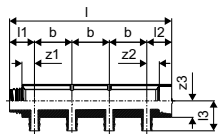

Uponor Q&E

Uponor Aqua PLUS manifold PPM

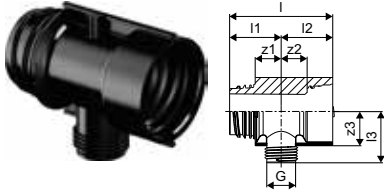

Item no.	Dimension	l	l1	l2	l3	G	z1	z2	z3	outlets	p	Qty 2	Qty 1	UOM
		mm	mm	mm	mm	"	mm	mm	mm	-	bar			
1047997	1" 1XG1/2"MT c/c50mm	67	33	33	33	1/2"	17	17	23	1	6+10	20	1	pcs
1047998	1" 1XG3/4"MT c/c50mm									1	6+10	20	1	pcs

Uponor Aqua PLUS manifold PPM

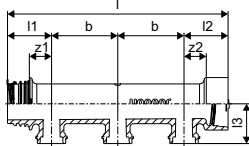

Item no.	Dimension	l	l1	l2	l3	z1	z2	b	p	Qty 2	Qty 1	UOM	
		mm	mm	mm	mm	mm	mm	mm	mm	bar			
1087121	3X c/c50mm	167	33	33	30	17	17	50	6+10	8	1	pcs	
1087122	2X c/c50mm	117	33	33	30	17	17	50	6+10	10	1	pcs	
1087123	1X c/c50mm	67	33	33	30	17	17	50	6+10	20	1	pcs	

Uponor Aqua PLUS manifold PPM

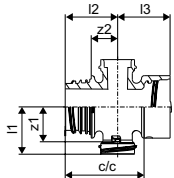

Item no.	Dimension	l1	l2	l3	c/c	z1	z2	p	Qty 2	Qty 1	UOM
		mm	mm	mm	mm	mm	mm	mm	bar		
1087124	1+1X c/c50mm	30	33	33	50	22	17	6+10	15	1	pcs

Uponor Aqua PLUS Q&E adapter PPSU PPM

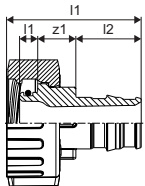

Item no.	Dimension	l1	l2	z1	Qty 2	Qty 1	UOM
		mm	mm	mm			
1087112	16	37	5	18	30	1	pcs
1087113	20	48	5	17	30	1	pcs

Uponor Q&E

Uponor S-Press adapter Aqua PLUS PPM

■ adapter Aqua PLUS

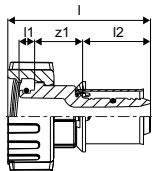

Item no.	Dimension	l mm	l1 mm	l2 mm	z1 mm	Qty 2	Qty 1	UOM
1087116	16	46	5	22	15	30	1	pcs
1087117	20	48	5	24	15	30	1	pcs

Uponor Aqua PLUS outlet plug PPSU PPM

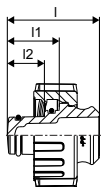

Item no.	l mm	l1 mm	l2 mm	Qty 2	Qty 1	UOM
1087110	31	18	13	30	1	pcs

Uponor Aqua PLUS outlet nut PPSU PPM

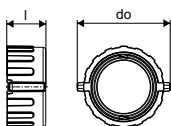

Item no.	l mm	do mm	Qty 2	Qty 1	UOM
1087120	15	35	30	5	pcs

Uponor Aqua PLUS adapter male thread PPM

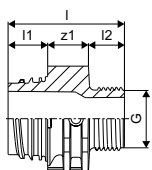

Item no.	Dimension	l mm	l1 mm	l2 mm	G "	z1 mm	p bar	Qty 2	Qty 1	UOM
1048002	1" G3/4"MT	49	17	15	3/4	17	6+10	20	1	pcs

Uponor Q&E

Uponor Aqua PLUS adapter brass nut PPM

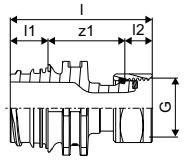

Item no.	Dimension	l	l1	l2	G	z1	outlets	Qty 2	Qty 1	UOM
		mm	mm	mm	"	mm	-			
1063785	1"MT-G3/4"SN	62	17	12	3/4	34	2	20	1	pcs

Uponor Aqua PLUS adapter brass nut PPM

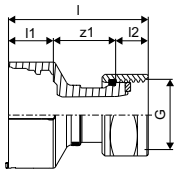

Item no.	Dimension	l	l1	l2	G	z1	Qty 2	Qty 1	UOM
		mm	mm	mm	"	mm			
1063811	1"FT-3/4"SN	51	17	12	3/4	23	25	1	pcs

Uponor Aqua PLUS elbow adapter male PPM

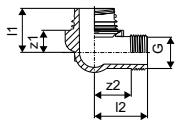

Item no.	Dimension	l1	l2	G	z1	z2	Qty 2	Qty 1	UOM
		mm	mm	"	mm	mm			
1048003	1" G3/4"MT	33	40	3/4	17	28	20	1	pcs

Uponor Aqua PLUS elbow male female PPM

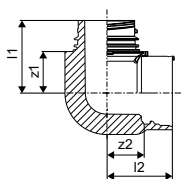

Item no.	Dimension	l1	l2	z1	z2	Qty 2	Qty 1	UOM
		mm	mm	mm	mm			
1063782	1"MT-1"FT	39	35	22	20	20	1	pcs

Uponor Q&E

Uponor Aqua PLUS manifold end cap PPM

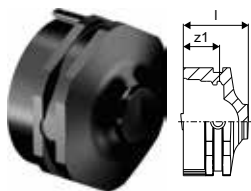

Item no.	Dimension	l mm	z1 mm	Qty 2	Qty 1	UOM
1048004	1"FT	27	15	20	1	pcs

Uponor Aqua PLUS end cap, air nipple PPM

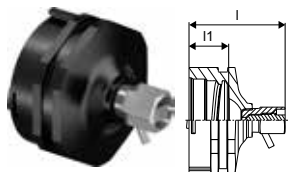

Item no.	Dimension	l mm	l1 mm	Qty 2	Qty 1	UOM
1048005	1"FT	40	17	20	1	pcs

Uponor Aqua PLUS manifold plug PPM



Item no.	Dimension	l mm	l1 mm	Qty 2	Qty 1	UOM
1087119	MT	30	12	30	1	pcs

Uponor Aqua PLUS manifold bracket PPM



NEW

Item no.	l mm	l1 mm	l2 mm	l3 mm	L m	di mm	z mm	z1 mm	b mm	b1 mm	b2 mm	h mm	h1 mm	Qty 2	Qty 1	UOM
1092021	36	38	75	150	300	6	14	62	123	102	48	58	32	50	1	set

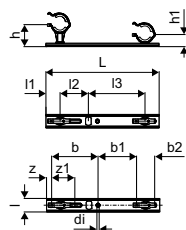

Uponor Q&E

Uponor Aqua PLUS manifold clips PPM

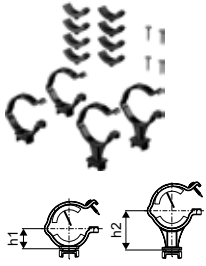

Item no.	h1 mm	h2 mm	Qty 2	Qty 1	UOM
1087375	28	50	20	1	set

Uponor Aqua PLUS manif end cap flat seal

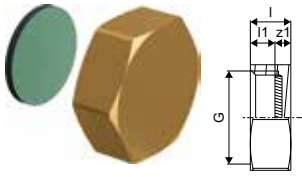

Item no.	Dimension	l mm	l1 mm	G mm	z1 mm	Qty 2	Qty 1	UOM
1001337	3/4"FT	12	7	3/4	5	250	10	pcs

Uponor RS

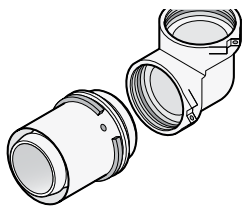

Uponor RS is a unique system that follows a modular design principle for riser systems and other distribution lines. Just 40 system components enable hundreds of variations, making the system highly adaptable.

Your benefits

- Innovative plug connection between body and adapter
- Fast and flexible: tool-free assembly, many variations
- More efficient stock management
- Re-adjustment possible until final installation
- Colour coding 16 -110mm for easy dimension selection



Uponor RS coupling

- Made of tin-plated brass
- Base part for all RS2 or RS3 inserts including 2 lock pins.



Item no.	Dimension	l mm	Qty 1	UOM
1029144	RS2-RS2	58	1	pcs
1029145	RS3-RS3	58	1	pcs

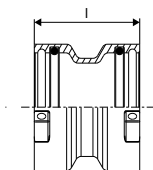

Uponor RS elbow

- Made of tin-plated brass
- Base part for all RS2 or RS3 inserts including 2 lock pins.



Item no.	Dimension	l1 mm	l2 mm	Qty 1	UOM
1029138	RS2-RS2	51	51	1	pcs
1029139	RS3-RS3	68	68	1	pcs

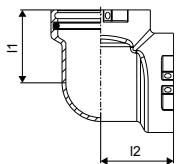

Uponor RS

Uponor RS elbow 45°

- Made of tin-plated brass
- Base part for all RS2 or RS3 inserts including 2 lock pins.

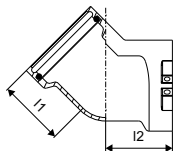

Item no.	Dimension	l1 mm	l2 mm	Qty 1	UOM
1029140	RS2-RS2	51	51	1	pcs
1029141	RS3-RS3	68	68	1	pcs

Uponor RS tee

- Made of tin-plated brass
- Base part for all RS2 or RS3 inserts including 3 lock pins.

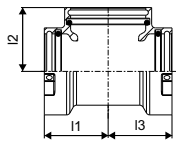

Item no.	Dimension	l1 mm	l2 mm	l3 mm	Qty 1	UOM
1029142	RS2-RS2-RS2	51	51	51	1	pcs
1029143	RS3-RS3-RS3	68	68	68	1	pcs

Uponor RS reducer

- Made of tin-plated brass
- Reducer from RS3 to RS2 including 1 lock pin.

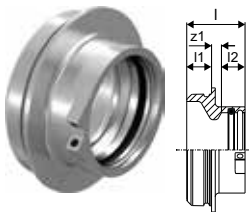

Item no.	Dimension	l mm	l1 mm	l2 mm	z1 mm	Qty 1	UOM
1029146	RS3-RS2	47	20	19	8	1	pcs

Uponor RS spacer

- Made of tin plated-brass
- Spacer to connect RS base parts of equal dimensions.

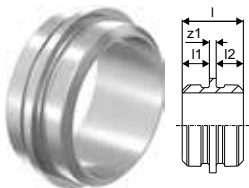

Item no.	Dimension	l mm	l1 mm	l2 mm	z1 mm	Qty 1	UOM
1046750	RS2-RS2 l=5mm	45	20	20	5	1	pcs
1046751	RS3-RS3 l=5mm	45	20	20	5	1	pcs

Uponor RS

Uponor RS spacer

- Made of tin-plated brass
- Spacer to connect RS base parts of equal dimensions e.g to create T-manifold or shift in distribution lines.

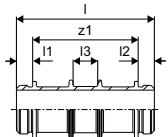

Item no.	Dimension	l mm	l1 mm	l2 mm	l3 mm	z1 mm	Qty 1	UOM
1046477	RS2-RS2 l=130mm	170	20	20	30	130	1	pcs
1046478	RS3-RS3 l=210mm	250	20	20	30	210	1	pcs

Uponor RS adapter PL Q&E

- RS
- Positive listed brass
- Uponor Q&E Ring must be ordered separately

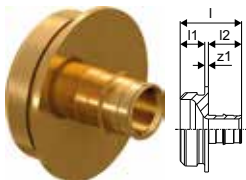

Item no.	Dimension	l mm	l1 mm	l2 mm	z1 mm	p mm bar	Qty 1	UOM
1047021*	25-RS2	50	20	27	3	6+10	1	pcs
1047022*	32-RS2	57	20	34	3	6+10	1	pcs
1047023*	40-RS2	65	20	42	3	6+10	1	pcs
1047024*	50-RS2	75	20	52	3	6+10	1	pcs
1047026	63-RS2	88	20	65	3	6+10	1	pcs

Uponor RS adapter PL/DR Q&E

- RS
- DR brass
- Uponor Q&E Ring must be ordered separately

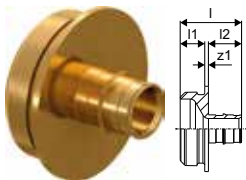

Item no.	Dimension	l mm	l1 mm	l2 mm	z1 mm	p mm bar	Qty 2	Qty 1	UOM
1085079*	75-RS2	111	20	86	5	6+10	6	1	pcs

Uponor RS adapter male thread

- Made of tin-plated brass
- Fits to all RS2 or RS3 base parts

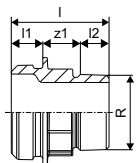

Item no.	Dimension	l mm	l1 mm	l2 mm	R "	z1 mm	Qty 1	UOM
1059402	R1 1/2"MT-RS2	62	20	24	1 1/2	18	1	pcs
1029131	R2"MT-RS2	66	20	23	2	23	1	pcs
1029132	R2 1/2"MT-RS2	63	20	27	2 1/2	16	1	pcs
1029133	R3"MT-RS3	73	20	30	3	23	1	pcs

Uponor RS

Uponor RS adapter female thread

- Made of tin-plated brass.
- Fits to all RS2 or RS3 base parts

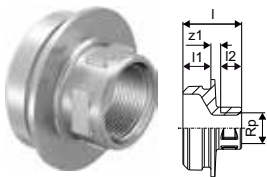

Item no.	Dimension	l mm	l1 mm	l2 mm	Rp "	z1 mm	Qty 1	UOM
1059403	Rp1/2"FT-RS2	42	20	15	1/2	7	1	pcs
1029134	Rp1"FT-RS2	45	20	19	1	6	1	pcs
1029135	Rp2"FT-RS2	54	20	26	2	8	1	pcs
1029136	Rp2 1/2"FT-RS2	63	20	30	2 1/2	12	1	pcs
1059404	Rp1/2"FT-RS3	43	20	15	1/2	8	1	pcs
1029137	Rp3"FT-RS3	65	20	33	3	12	1	pcs

Uponor RS flange adapter

- Made of tin-plated brass
- Fits to all RS2 or RS3 base parts
- Flange PN6/PN16 acc. to EN 1092-3
- Bolt circle with 4/8 holes.

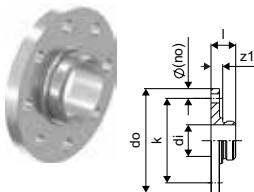

Item no.	Dimension	l mm	l3 mm	di mm	do mm	z1 mm	k mm	p bar	Qty 1	UOM
1059398	RS2-DN65 (PN6)	38	18	48,7	160	18	130	6	1	pcs
1059399	RS2-DN65 (PN16)	45	25	48,7	185	25	145	16	1	pcs
1059400	RS3-DN80 (PN6)	38	18	78,1	190	18	150	6	1	pcs
1029129	RS3-DN80 (PN16)	45		78,1	200	25	160	16	1	pcs
1029130	RS3-DN100 (PN16)	44		78,1	220	24	180	16	1	pcs
1059401	RS3-DN100 (PN6)	41	21	78,1	210	21	170	6	1	pcs

Uponor RS lock pin

- made of plastic
- to lock the RS insert to the RS base part.



Item no.	Dimension	colour	Qty 1	UOM
1042921	RS2 black	black	10	pcs
1042922	RS3 grey	grey	10	pcs



Tools

Cutting & Preperation.....	76
Pressing	79
Expanding	84

Uponor Cutting & Preperation

Uponor Multi pipe & conduit cutting tool

- Easy cutting with a speical triangle blade
- outside diameters 12-25 mm



Item no.	Dimension		Qty 2	Qty 1	UOM
1089674	12-25		36	1	pcs
1089776	12-25	blade		1	pcs

Uponor Multi pipe cutting tool

- outside diameters 32-40 mm



Item no.	Dimension		Qty 2	Qty 1	UOM
1089677	32-40		12	1	pcs
1089779	32-40	blade	50	1	pcs

Uponor Multi pipe cutting tool

- outside diameters 25-63 mm



Item no.	Dimension		Qty 2	Qty 1	UOM
1089675	25-63		12	1	pcs
1089777	25-63	blade	50	1	pcs

Uponor Multi pipe cutting tool

- outside diameters 50-125 mm



Item no.	Dimension		Qty 2	Qty 1	UOM
1089676	50-125		8	1	pcs
1089778	50-125	blade	50	1	pcs

Uponor SPI MLC pipe cutting tool blade



Item no.	Dimension		Qty 2	Qty 1	UOM
1013721		blade	10	1	pcs

Uponor Flex pipe cutting tool PEX

- For Uponor pipes, outside diameter up to 25 mm.



Item no.	Dimension		Qty 1	UOM
1001369	14-25		1	pcs

Uponor SPI MLC pipe cutting tool blade



Item no.	Dimension		Qty 2	Qty 1	UOM
1014173	50-110	blade	20	1	pcs

Uponor Cutting & Preperation

Uponor MLC pipe cutting + deburring tool



Item no.	Dimension	Qty 2	Qty 1	UOM
1014334	63-110	32	1	pcs
1014320	63-110 blade		1	pcs

Uponor MLC bevelling tool

- For bevelling the Uponor Uni Pipe PLUS and MLC pipes.
- Supplied with manual toggle. Without manual toggle to be used as attachment for self-driving screw with tapping screw thread.



Item no.	Dimension	Qty 2	Qty 1	UOM
1006830	16	50	1	pcs
1015749	20		1	pcs
1015756	25		1	pcs
1015762	32		1	pcs

Uponor MLC bevelling tool



Item no.	Dimension	Qty 1	UOM
1006638	40	1	pcs
1015808	50	1	pcs
1014339	63	1	pcs
1014344	75	1	pcs

Uponor MLC bevelling tool

- For bevelling the Uponor Uni Pipe PLUS and MLC pipes.



Item no.	Dimension	Qty 1	UOM
1015739	16/20/25	1	pcs

Uponor MLC deburring tool universal



Item no.	Qty 2	Qty 1	UOM
1060167	50	1	pcs

Uponor Cutting & Preperation

Uponor MLC bending spring inside

- bending spring for Uponor Uni Pipe PLUS and MLC pipes.



Item no.	Dimension	Qty 2	Qty 1	UOM
1013729	16		1	pcs
1013734	20		1	pcs
1013737	25	50	1	pcs

Uponor MLC bending spring outside

- bending spring for Uponor Uni Pipe PLUS and MLC pipes.



Item no.	Dimension	Qty 2	Qty 1	UOM
1006639*	14		1	pcs
1006640	16		1	pcs
1013792	20	45	1	pcs
1013794	25	45	1	pcs

Uponor MLC bending tool

- producing evenly formed bends in Uponor MLC Pipe with outer diameters up to 32 mm.
- Delivered complete in tool case with bending segments.



Item no.	Dimension	Qty 2	Qty 1	UOM
1013773*	16-32	48	1	pcs

Uponor Pressing

Uponor S-Press manual tool w/o inserts

- in conjunction with exchangeable inserts
- Supplied in case without exchangeable inserts



Item no.	Dimension	d mm	Qty 1	UOM
1015764	14-20	14-20	1	pcs

Uponor S-Press manual tool insert

- For inserting into the manual pressing tool



Item no.	Dimension	d mm	Qty 2	Qty 1	UOM
1015776*	14	14		1	pcs
1015777	16	16	50	1	pcs
1015780	20	20	50	1	pcs

Uponor S-Press tool UP110 without jaws

- supplied in carrying case, complete with battery and charger unit
- without pressing jaws.
- Range of application up to 110 mm.

Technical specifications:

- Quick pressing due to short pressing cycle
- Crimping force: linear thrust of approx. 32 kN
- Battery capacity: High-power Makita 3.0 Ah Li-Ion battery
- Charging time: 22 min
- Weight incl. battery: without jaw 3.5 kg
- Dimensions tool: 366 x 81 x 317 mm
- Revolving/rotatable: approx. 350° rotating pressing jaw holder



Item no.	Qty 2	Qty 1	UOM
1083612	20	1	set

Uponor SPI S-Press battery UP110

- Akku 18 V / 3,0 Ah, Li-Ion (54 Wh)
- Battery voltage: 18 V
- Battery capacity: 3.0 Ah
- Charging time: With SPI S-PRESS BATTERY CHARGER: 22 min
- Cell technology: Li-Ion
- Weight: 0,6 kg



Item no.	OV V	Qty 2	Qty 1	UOM
1083608*	18	12	1	pcs

Uponor Pressing

Uponor SPI S-Press battery charger

- Quick-charger for 18V Li-Ion batteries, 230 V
- Charging time: 1.3 Ah 15 min, 3.0 Ah 22 min
- Mains supply: 230 V AC
- Voltage range: 18 V
- Weight: 1,0 kg



Item no.	Dimension	OV V	Qty 1	UOM
1083610*	Mini2, UP110	230	1	pcs

Uponor S-Press electric tool w/o jaws UP75

Technical specifications:

- Weight: 3.30 kg
- Nominal voltage: 230 V AC / 50 Hz
- Nominal capacity: 200 Watt
- Press power: ca. 32 kN
- Press duration: ca. 7 sec.



Item no.	d mm	OV V	Qty 2	Qty 1	UOM
1007082	- 110	230	20	1	pcs

Uponor SPI S-Press spare battery UP75

- for the battery powered pressing machine UP 75
- Not compatible to the Ni-Cd charger unit.



Item no.	OV V	Qty 2	Qty 1	UOM
1006949*	12	12	1	pcs

Uponor SPI S-Press spare charger Mini UP75

- or the re-chargeable battery of the pressing machine UP 75 and Mini KSP0



Item no.	OV V	Qty 2	Qty 1	UOM
1006950	230	10	1	pcs

Uponor S-Press jaw UPP1

- pressing jaws for Uponor MLC press fittings



Item no.	Dimension	d mm	Qty 1	UOM
1007084	16	16	1	pcs
1007086	20	20	1	pcs
1007087	25	25	1	pcs
1007088	32	32	1	pcs

Uponor Pressing

Uponor S-Press jaw UPP1

- pressing jaws for Uponor MLC press fittings



Item no.	Dimension	d mm	Qty 1	UOM
1015768	40	40	1	pcs
1015792	50	50	1	pcs

Uponor S-Press base unit for chain

- Base unit for the pressing chain to press Uponor MLC press fittings 63 - 110 in conjunction with the pressing tool UP 110, UP 75 and UP 75 EL



Item no.	Dimension	d mm	Qty 1	UOM
1046545	63-110	63-110	1	pcs

Uponor S-Press chain

- pressing chain to be used together with the Base unit to press Uponor MLC press fittings 63 - 110 in conjunction with the pressing tool UP 110, UP 75 and UP 75 EL



Item no.	Dimension	d mm	Qty 1	UOM
1046541	63	63	1	pcs
1046542	75	75	1	pcs
1046543*	90	90	1	pcs
1046544*	110	110	1	pcs

Uponor S-Press tool Mini2 with KSP0 jaw

- Uponor S-Press tool Mini² supplied in carrying case, complete with battery and charger unit and pressing jaws.
- Range of application up to 32 mm.

Technical specifications:

- Very quick pressing thanks to short pressing cycle of 3-4 seconds
- Crimping force: linear thrust of approx. 15 kN
- Battery capacity: High-power Makita 1.3 Ah Li-Ion battery (3.0 Ah optional)
- Charging time: 1.5 Ah 15 min. 3.0 Ah 22 min
- Weight incl. battery: without jaws 1.7 kg
- Dimensions tool: 377 x 75 x 116 mm
- Revolving/rotatable: approx. 350° rotating pressing jaw holder



Item no.	Dimension	Qty 2	Qty 1	UOM
1083586	16/20/25/32	30	1	set

Uponor Pressing

Uponor S-Press tool Mini2 with KSP0 jaw

- Uponor S-Press tool Mini² supplied in carrying case, complete with battery and charger unit and pressing jaws.
- Range of application up to 25 mm.

Technical specifications:

- Very quick pressing thanks to short pressing cycle of 3-4 seconds
- Crimping force: linear thrust of approx. 15 kN
- Battery capacity: High-power Makita 1.3 Ah Li-Ion battery (3.0 Ah optional)
- Charging time: 1.5 Ah 15 min. 3.0 Ah 22 min
- Weight incl. battery: without jaws 1.7 kg
- Dimensions tool: 377 x 75 x 116 mm
- Revolving/rotatable: approx. 350° rotating pressing jaw holder



Item no.	Dimension	Qty 2	Qty 1	UOM
1083594	16/20/25	25	1	set

Uponor S-Press tool Mini2 without jaws

- Uponor S-Press tool Mini² supplied in carrying case, complete with battery and charger unit and pressing jaws.
- Range of application up to 32 mm.

Technical specifications:

- Very quick pressing thanks to short pressing cycle of 3-4 seconds
- Crimping force: linear thrust of approx. 15 kN
- Battery capacity: High-power Makita 1.5 Ah Li-Ion battery (3.0 Ah optional)
- Charging time: 1.5 Ah 15 min. 3.0 Ah 22 min
- Weight incl. battery: without jaws 1.7 kg
- Dimensions tool: 377 x 75 x 116 mm
- Revolving/rotatable: approx. 350° rotating pressing jaw holder



Item no.	Qty 1	UOM
1085388	1	pcs

Uponor SPI S-Press tool Mini2

- Uponor SPI S-Press tool Mini² without carrying case, without battery and charger unit and without pressing jaws.



Item no.	Qty 1	UOM
1087260	1	pcs

Uponor Pressing

Uponor SPI S-Press battery Mini2

- Battery 18 V / 1.5 Ah, Li-Ion (27 Wh)
- Battery voltage: 18 V
- Battery capacity: 1.5 Ah
- Charging time: With SPI S-Press Battery Charger: 15 min
- Cell technology: Li-Ion
- Weight: 0,4 kg



Item no.	OV V	Qty 2	Qty 1	UOM
1083605*	18	48	1	pcs

Uponor SPI S-Press battery charger

- Quick-charger for 18V Li-Ion batteries, 230 V
- Charging time: 1.3 Ah 15 min,
3.0 Ah 22 min
- Mains supply: 230 V AC
- Voltage range: 18 V
- Weight: 1,0 kg



Item no.	Dimension	OV V	Qty 1	UOM
1083610*	Mini2, UP110	230	1	pcs

Uponor SPI S-Press battery Mini

- Battery: 9.6V for Uponor battery pressing tool Mini KSP0.



Item no.	OV V	Qty 1	UOM
1015703*	9.6	1	pcs

Uponor S-Press jaw Mini KSP0

- Uponor pressing jaws MLC Mini KSP0



Item no.	Dimension	d mm	Qty 2	Qty 1	UOM
1007091*	16	16	5	1	pcs
1007093*	20	20	5	1	pcs
1007094*	25	25	5	1	pcs
1007095*	32	32	5	1	pcs

Uponor Expanding

Uponor Q&E manual expansion tool, heads S3,2 S5,0



Item no.	Dimension	p bar	Qty 1	UOM
1004064	16/20/25	6+10	1	set

Uponor SPI Q&E expansion tool plier



Item no.	Qty 1	UOM
1004002	1	pcs

Uponor Q&E expansion tool with heads M12



Item no.	Dimension	p bar	stroke mm	Qty 1	UOM
1057166	16/20/25	6bar	6 14	1	set
1057167	16/20/25	10bar	10 14	1	set

Uponor Q&E expansion head M12/M18



Item no.	Dimension	d mm	s mm	p bar	stroke mm	Qty 1	UOM
1057184*	14/15x2,5	14/15	2,0/2,5	6+10	14/25	1	pcs
1057172	16x1,8/2,0/2,2	16	1,8/2,0/2,2	6+10	14/25	1	pcs
1057185*	17/18x2,5	17/18	2,0/2,5	6+10	14/25	1	pcs
1057173*	20x1,9/2,0	20	1,9/2,0	6	14/25	1	pcs
1057174	20x2,8	20	2,8	10	14/25	1	pcs
1057175	25x2,3	25	2,3	6	14/25	1	pcs
1057176	25x3,5	25	3,5	10	14/25	1	pcs
1057177	32x2,9	32	2,9	6	14/25	1	pcs

Uponor Q&E expansion tool spare battery M12



Item no.	Dimension	Qty 2	Qty 1	UOM
1061185	4Ah	12	1	pcs

Uponor Expanding

Uponor Q&E expansion tool with heads M18 6bar



Item no.	Dimension	p bar	stroke mm	Qty 1	UOM
1063908	16/20/25/32	6	25	1	set

Uponor Q&E expansion tool with heads M18 10bar



Item no.	Dimension	p bar	stroke mm	Qty 1	UOM
1063909	16/20/25/H32	10	25	1	set

Uponor Q&E expansion head M18 H



Item no.	Dimension	d mm	s mm	p bar	stroke mm	Qty 1	UOM
1057182	32x2,9/4,4	32	2,9/4,4	6+10	25	1	pcs
1057183	40x3,7	40	3,7	6	25	1	pcs

Uponor Q&E expansion tool M18 VLD PEX



Item no.	Dimension	stroke mm	Qty 1	UOM
1085099	40-75	56	1	pcs

Uponor Q&E expansion head VLD



Item no.	Dimension	d mm	s mm	p bar	stroke mm	Qty 1	UOM
1085095	40x3,7/5,5	40	3,7/5,5	6+10	56	1	pcs
1085096	50x4,6/6,9	50	4,6/6,9	6+10	56	1	pcs
1085097	63x5,8/8,6	63	5,8/8,6	6+10	56	1	pcs
1085098	75x6,8/10,3	75	6,8/10,3	6+10	56	1	pcs

Uponor Expanding

Uponor SPI Q&E expansion tool battery M18 PEX



Item no.	Dimension	Qty 1	UOM
1085100*	5,0Ah	1	pcs

Uponor SPI Q&E expansion tool charger M12/M18 PEX



Item no.	Dimension	OV V	Qty 1	UOM
1085101*	220-240V/50-60Hz	230	1	pcs

Uponor Q&E graphite paste, manual tools



Item no.	Dimension	Weight kg	Qty 1	UOM
1008334	30g	0,030	20	pcs

Uponor Q&E graphite paste



Item no.	Dimension	Weight kg	Qty 1	UOM
1005017	100g	0,100	1	pcs

Abbreviations

Shortcut	unit	Description
a	[mm]	Distance a
A	[m ²]	square measure
a1	[mm]	Distance a1
a2	[mm]	Distance a2
a3	[mm]	Distance a3
A Foil	[m ²]	square measure foil
AG	[-]	male thread (metric)
AG	["]	male thread
AG1	["]	male thread 1
b	[mm]	width
B	[mm]	Distance B
B	[m]	width in meter
b1	[mm]	width 1
B1	[mm]	Distance B1
b2	[mm]	width 2
B2	[mm]	Distance B2
c	[mm]	Distance c
colour	[-]	colour
Con.	[l/m ²]	consumption
d	[mm]	diameter
d	[mm]	Depth
d1	[mm]	diameter 1
d1xs1	[mm]	Diameter1 x wall thickness1
d2	[mm]	diameter 2
d3	[mm]	diameter 3
d4	[mm]	diameter 4
da	[mm]	diameter outside
di	[mm]	diameter inside
DN	["]	Dimension Inch
DN	[mm]	diameter nominal
do3	[mm]	diameter outside 3
ds	[mm]	Diameter screw hole
DT	[d]	drying time in days
dxs	[mm]	Diameter x wall thickness
EP/a	[W]	effective power per actuator
Feet	[-]	Feet
Flow Rate	[l/h]	Flow Rate
G	[kN/m ²]	load bearing capacity
gauge	[mm]	gauge
Grid	[mm]	Grid
h	[m]	height
h	[mm]	height
H	[mm]	Height
h1	[mm]	height 1
h2	[mm]	height 2
h3	[mm]	height 3
h4	[mm]	height 4
h5	[mm]	height 5
h6	[mm]	height 6
Height max	[mm]	Height max
IG	[-]	female thread (metric)
IG	["]	female thread
IG1	["]	female thread 1
k	[mm]	Distance k

Shortcut	unit	Description
l	[mm]	length
L	[m]	length in meter
l1	[mm]	length 1
l2	[mm]	length 2
l3	[mm]	length 3
l4	[mm]	length 4
Loops	[-]	Loops
m	[mm]	Distance m
Mat Wire	[mm]	Mat Wire
Mounting orientation	[-]	Mounting orientation
no.	[pcs]	Number
outlets	[-]	Number of outlets
outlets	[-]	Number of outlets
OV	[V]	operating voltage
p	[bar]	pressure
P	[W]	effective power
P	[kW]	effective power
Q	[kW]	nominal power
r	[mm]	radius
R	[m]	radius in meter
ra	[mm]	centre - centre distance
ra1	[mm]	centre - centre distance 1
RE	[kohm]	input resistance xx
R-value	[m ² K/W]	thermal resistance
s	[mm]	strength / wall thickness
s	[mm]	thickness
s1	[mm]	strength / wall thickness 1
sa	[mm]	side distance
Sensor	[mm]	Sensor
Slab	[mm]	Slab
Sleeve	[mm]	Sleeve
Specification	[-]	Specification
stroke	[mm]	stroke
SW	[mm]	across flats
SW1	[mm]	across fl ats 1
T	[mm]	distance T
tape	[m]	tape
Total Capacity	[kPA]	Total Capacity
Type	[-]	Type
V	[l]	volume
V	[l/m]	volume
Valve Connection	[-]	Valve Connection
VD 450	[l]	VD 450
VD 550N	[l]	VD 550N
V max	[m ³ /h]	V max
VN	[m ³ /h]	VN
Vol.	[l]	Volume
Volume	[m ³]	Volume
water column height	[m]	water column height
Weight	[kg]	Unit Weight
z	[mm]	z-value
z1	[mm]	z-value 1
z2	[mm]	Z-Value 2
Δ Lw	[dB]	impact noise improvement

Uponor piping systems

Comparisons of inner and outer pipe diameter

Uponor MLCP			Uponor Pe-Xa PN6			Uponor PE-Xa PN10			PP-R SDR 6			PP-R SDR 7.4			Copper To BS EN 1057 R250		
OD	s	ID	OD	s	ID	OD	s	ID	OD	s	ID	OD	s	ID	OD	s	ID
16	2	12	16	2	12	20	2,8	14,4	20	3,4	13,2	20	2,8	14,4	15	0,7	13,6
20	2,25	15,5	20	2	16	25	3,5	18	25	4,2	16,6	25	3,5	18			
25	2,5	20	25	2,3	20,4	32	4,4	23,2	32	5,4	21,2	32	4,4	23,2	22	0,9	20,2
32	3	26	32	2,9	26,2	40	5,5	29	40	6,7	26,6	40	5,5	29	28	0,9	26,2
40	4	32	40	3,7	32,6	50	6,9	36,2	50	8,3	33,4	50	6,9	36,2	35	1,2	32,6
50	4,5	41	50	4,6	40,8	63	8,7	45,6	63	10,5	42	63	8	47	42	1,2	39,6
63	6	51	63	5,8	51,4	75	10,3	54,4	75	12,5	50	75	10,3	54,4	54	1,2	51,6
75	7,5	60	75	6,8	61,4	90	12,3	65,4	90	15,5	59	90	12,3	65,4	66,7	1,2	64,3
90	8,5	73	90	8,2	73,6	110	15,1	79,8	110	18,3	73,4	110	15,4	79,2	76,1	1,5	73,1
110	10	90	110	10	90				125	20,8	83,4	125	17,1	90,8	108	1,5	105

OD = Outer Diameter (mm) s = Wall thickness (mm) ID = Inner Diameter (mm)

Uponor piping systems



Long-term stability

Few materials have undergone such extensive long-term testing and have been well tried and tested in many different applications over a long period of time.



Flexible

The flexibility is yet another advantage compared with metal pipes. There is no need for expensive expansion elbows or their equivalents.



Clean

Our pipes do not release any harmful substances. That's why it's also approved for transporting drinking water. The material's exceptional cleanness is also utilized in medical equipment



Sound-absorbing

The pipes absorb sound, which means you can flow at higher velocities without the risk of loud noise levels.



Withstands high temperature

The pipes can be used at a working temperature of 70°C, but withstand 100°C within time and pressure limits.



Low weight

Uponor pipe weighs just a fraction of an equivalent metal pipe. This is a crucial advantage in marine applications.



Resistance to abrasion

The abrasion characteristics are very good; erosion corrosion does not occur even at high water speeds.



Ductile

The great freedom to shape Uponor plastic pipes makes them an excellent replacement for e.g. shaped metal pipes.



Low friction

The extremely low friction coefficient in Uponor pipe systems reduces the pressure drop in the pipework and minimizes the risk of deposits.



Low environmental load

Uponor pipe systems have a low environmental impact during both manufacturing and energy recovery.



Vibration-absorbing

Uponor pipes absorb and withstand vibrations. There's no need to combine our pipes with vibration-absorbing hoses or connectors, giving you higher reliability and lower costs, particularly during installation.

All technical and legal information contained in this catalogue has been carefully compiled according to the best of our knowledge. We cannot be held liable for any errors as these cannot be fully excluded. The product catalogue, including all sections, is protected by copyright.

All uses beyond those permitted under the copyright law are not allowed without the approval of Uponor. This applies particularly to reproduction, re-prints, processing, storage and processing in electronic systems, translations and microfilming. The contents of the product catalogue are subject to change without notice.

Copyright 2017
Uponor

Uponor

Uponor GmbH

Marine Applications

Industriestr. 56

97437 Hassfurt

Germany

T +49 9521 690 721

E marine.applications@uponor.com



www.uponor-marine.com

03/2020