



Multilayer Pipe Systems

Uponor Uni Pipe PLUS



The Uni Pipe PLUS is Uponor's unique multilayer composite pipe for tap water and heating/cooling application. Its bend radius is up to 40 per cent smaller than current multilayer composite pipes: changes of

direction when installing can be achieved by bending the pipe, reducing fitting requirements and installation time.

Your benefits

- Seamless or OWC-technology for highest level of safety
- High dimensional stability, low expansion rates
- Increased flexibility
- 100% oxygen barrier
- Lightweight



Specification

- Oxygen diffusion resistant multi-layer composite pipe (PE-RT - adhesive – seamless aluminium/longitudinally welded aluminium - adhesive - PE-RT) produced using SACP and OWC-technology.
- Fire classification E according to EN 13501-1.
- With pipe end caps as hygienic seal according EN 806.

Application

- Tested/Approved according EN ISO 21003 Multilayer piping systems for hot and cold water installations inside buildings for application class 1,2,4,5/10bar
- Tap water: The permanent operating temperature ranges from 0°C to 70°C at a maximum permanent operating pressure of 10 bar. The short-term malfunction temperature is 95°C for a period of 100 hours in the operating life time.
- Heating: The permanent operating temperature ranges up to 80°C at a maximum permanent operating pressure of 10 bar. The short-term malfunction temperature is 100°C for a period of 100 hours in the operating life time.

Certification

- WaterMark Certified to AS 4176.2:2010 Multilayer pipes for pressure application Part 2: Multilayer piping Systems for hot and cold water plumbing applications- Pipes (ISO 21003-2:2008, MOD)
- AS 4176.3:2010 Multilayer pipes for pressure applications Part 3: Multilayer piping systems for hot and cold water plumbing applications—Fittings (ISO 21003-3:2008, MOD)



Uponor Uni Pipe PLUS white S

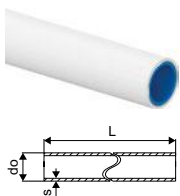

Item no.	Dimension	L do s m mm mm	Qty 2	Qty 1	UOM
1059572	16x2,0 5m	5 16 2,0	125	5	m
1059573	20x2,25 5m	5 20 2,25	85	5	m
1059574	25x2,5 5m	5 25 2,5	50	5	m
1059575	32x3,0 5m	5 32 3	35	5	m

Uponor MLC pipe white S

- bar

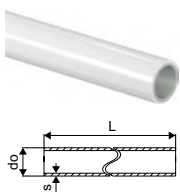

Item no.	Dimension	L do s m mm mm	Qty 2	Qty 1	UOM
1013446	40x4,0 5m	5 40 4	20	5	m
1013449	50x4,5 5m	5 50 4,5	20	5	m
1013451	63x6,0 5m	5 63 6	15	5	m
1013453	75x7,5 5m	5 75 7,5	255	5	m
1013455	90x8,5 5m	5 90 8,5	255	5	m
1013457	110x10,0 5m	5 110 10	165	5	m

Uponor Uni Pipe PLUS

Uponor Uni Pipe PLUS white

- coil

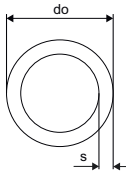

Item no.	Dimension	L m	do mm	s mm	Qty 2	Qty 1	UOM
1059576	16x2,0 100m	100	16	2,0	2000	100	m
1059578	16x2,0 500m	500	16	2,0	3500	500	m
1059577	16x2,0 200m	200	16	2	2600	200	m
1059579	20x2,25 100m	100	20	2,25	1300	100	m
1059581	25x2,5 50m	50	25	2,5	700	50	m
1059583	32x3,0 50m	50	32	3	400	50	m

Uponor Uni Pipe PLUS

Uponor Uni Pipe PLUS insulated

Specification

- Consists of pipe and insulating layer.
- Supplied in coils.
- pipe insulation made of polyethylene foam with closed-cell material structure.
- With sturdy, seamless foil coating

Uponor Uni Pipe PLUS white insulated S10 WLS 035

- coil
- Insulation thickness 10 mm
- thermal conductivity $\lambda=0,035 \text{ W/m}^{\circ}\text{k}$
- round extruded

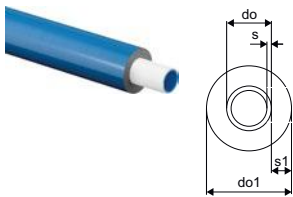

Item no.	Dimension	L m	do mm	do1 mm	s mm	s1 mm	colour	Qty 2	Qty 1	UOM
1062181	16x2,0 blue 75m	75	16	36	2	10	blue	450	75	m
1062182	20x2,25 blue 75m	75	20	40	2,25	10	blue	525	75	m
1062183	25x2,5 blue 50m	50	25	45	2,5	10	blue	350	50	m

Uponor Uni Pipe PLUS white insulated S13 BL-S2-D0

- coil
- Insulation thickness 13 mm
- thermal conductivity $\lambda=0,04 \text{ W/m}^{\circ}\text{k}$
- round extruded

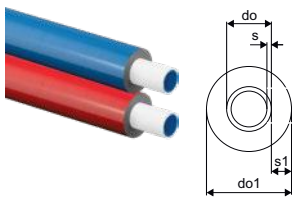

Item no.	Dimension	L m	do mm	do1 mm	s mm	s1 mm	colour	Qty 2	Qty 1	UOM
1093952	16x2,0 blue 75m	75	16	42	2	13	blue	450	75	m
1093953	16x2,0 red 75m	75	16	42	2	13	red	450	75	m
1093954	20x2,25 blue 75m	75	20	46	2,25	10	blue	450	75	m
1093955	20x2,25 red 75m	75	20	46	2,25	10	red	450	75	m
1094883	25x2,5 blue 50m	50	25	51	2,5	10	blue	200	50	m

Uponor Uni Pipe PLUS white insulated S15 Clima

- coil
- Insulation thickness 15 mm
- thermal conductivity $\lambda=0,040 \text{ W/m}^{\circ}\text{k}$
- round extruded

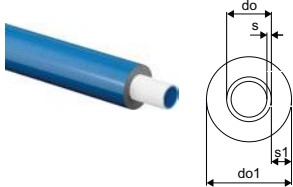

Item no.	Dimension	L m	do mm	do1 mm	s mm	s1 mm	colour	Qty 2	Qty 1	UOM
1088239	32x3,0 blue 25m	23	32	62	3	15	blue	225	25	m

Uponor Uni Pipe PLUS white in conduit

- pipe in conduit

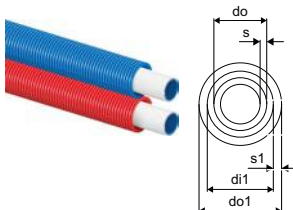

Item no.	Dimension	L m	di1 mm	do mm	do1 mm	s mm	colour	Qty 2	Qty 1	UOM
1063059	16x2,0 - 25/20 blue 75m	75	20	16	25	2,0	blue	1125	75	m
1063060	20x2,25 - 28/23 blue 75m	75	23	20	28	2,25	blue	900	75	m
1063061	16x2,0 - 25/20 red 75m	75	20	16	25	2,0	red	1125	75	m
1063062	20x2,25 - 28/23 red 75m	75	23	20	28	2,25	red	900	75	m

Uponor S-Press PLUS

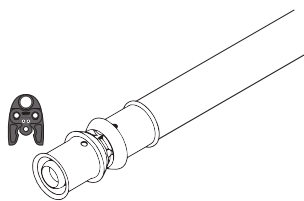

S-Press PLUS/ S-Press, our new generation of press fittings, is the perfect solution for ensuring permanently tight pipe connections. It's 100% backward compatible with current Uponor composite pipes and tools.

Available in dimensions from 16 to 75 mm in both metal and plastic, S-Press PLUS/ S-Press are the fittings that knows no compromise.

Your benefits

- **TOUGH:** Withstand harshest conditions
- **SAFE:** Ensuring your perfect pressing result
- **EASY:** Simplifying planning and installation
- **SMART:** Answering all your questions on site



Specification

- Fixed press sleeve with inspection window
- Precise jaw fixation
- Fast diameter recognition
- Accurate test safety function
- 100% backward compatible with existing Uponor components
- Flow rate optimized fitting body

Application

- Tap water: The permanent operating temperature ranges from 0°C to 70°C at a maximum permanent operating pressure of 10 bar. The short-term malfunction temperature is 95°C for a period of 100 hours in the operating life time.
- Heating: The permanent operating temperature ranges up to 80°C at a maximum permanent operating pressure of 10 bar. The short-term malfunction temperature is 100°C for a period of 100 hours in the operating life time.

if not different mentioned:

- Male and female threads acc.to EN 10226-1.

Certification

- WaterMark Certified to AS 4176.2:2010 Multilayer pipes for pressure application Part 2: Multilayer piping Systems for hot and cold water plumbing applications- Pipes (ISO 21003-2:2008, MOD)
- AS 4176.3:2010 Multilayer pipes for pressure applications Part 3: Multilayer piping systems for hot and cold water plumbing applications—Fittings (ISO 21003-3:2008, MOD)



Uponor S-Press PLUS/ S-Press made of PPSU

Specification

- made of PPSU

Uponor S-Press PLUS

Uponor S-Press PLUS elbow PPSU

- Unique press indicator
- Fast 3-step installation (press without bevel)
- Innovative QR code for immediate digital access
- Colour code

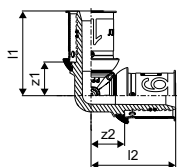

Item no.	Dimension	l1 mm	l2 mm	z1 mm	z2 mm	Qty 2	Qty 1	UOM
1039929	16-16	33	33	13	13	80	20	pce
1039930	20-20	37	37	16	16	80	10	pce
1039931	25-25	48	48	19	19	80	10	pce
1039932	32-32	51	51	23	23	20	5	pce

Uponor S-Press composite elbow PPSU

- Fast installation with easy bevel and without calibration
- Colour code

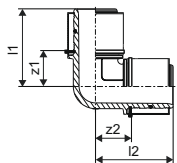

Item no.	Dimension	l1 mm	l2 mm	z1 mm	z2 mm	Qty 2	Qty 1	UOM
1046386	40-40	68	68	29	29	960	5	pce
1046387	50-50	73	73	34	34	576	3	pce
1032877	63-63	101	101	40	40	210	1	pce
1032878	75-75	108	108	47	47	210	1	pce

Uponor S-Press composite elbow 45° PPSU

- Fast installation with easy bevel and without calibration
- Colour code

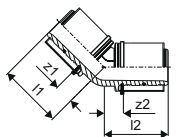

Item no.	Dimension	l1 mm	l2 mm	z1 mm	z2 mm	Qty 2	Qty 1	UOM
1046388	40-40	56	56	17	17	960	5	pce
1046389	50-50	59	59	20	20	576	3	pce
1032879	63-63	83	83	23	23	192	1	pce
1032880	75-75	86	86	25	25	192	1	pce

Uponor S-Press PLUS

Uponor S-Press PLUS coupling PPSU

- Unique press indicator
- Fast 3-step installation (press without bevel)
- Innovative QR code for immediate digital access
- Colour code

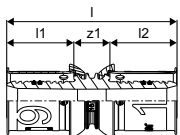

Item no.	Dimension	l mm	l1 mm	l2 mm	z1 mm	Qty 2	Qty 1	UOM
1039933	16-16	51	20	20	11	80	20	pce
1039934	20-20	54	21	21	11	80	10	pce
1039935	25-25	68	28	28	11	80	10	pce
1039936	32-32	69	28	28	13	80	10	pce

Uponor S-Press composite coupling PPSU

- Fast installation with easy bevel and without calibration
- Colour code

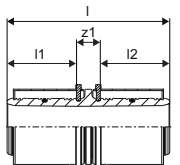
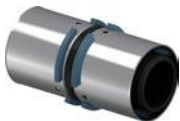

Item no.	Dimension	l mm	l1 mm	l2 mm	z1 mm	Qty 2	Qty 1	UOM
1046401	40-40	91	39	39	13	960	5	pce
1046402	50-50	91	39	39	13	576	3	pce
1032881	63-63	137	61	61	15	384	1	pce
1032882	75-75	137	61	61	15	384	1	pce

Uponor S-Press PLUS reducer PPSU

- Unique press indicator
- Fast 3-step installation (press without bevel)
- Innovative QR code for immediate digital access
- Colour code

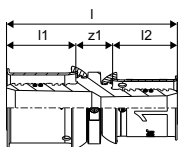

Item no.	Dimension	l mm	l1 mm	l2 mm	z1 mm	Qty 2	Qty 1	UOM
1039937	20-16	53	21	20	11	80	20	pce
1039938	25-16	60	28	20	11	80	10	pce
1039939	25-20	61	28	21	11	80	10	pce
1039940	32-25	69	28	28	13	80	10	pce

Uponor S-Press PLUS

Uponor S-Press reducer PPSU

- Fast installation with easy bevel and without calibration
- Colour code

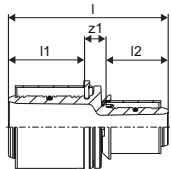

Item no.	Dimension	l mm	l1 mm	l2 mm	z1 mm	Qty 2	Qty 1	UOM
1039941	40-25	80	39	28	12	960	5	pce
1039942	40-32	80	39	28	13	960	5	pce
1039943	50-32	80	39	28	13	1152	3	pce
1046406	50-40	91	39	39	13	576	3	pce
1032883	63-40	115	61	37	17	384	1	pce
1032884	63-50	115	61	37	17	384	1	pce
1032885	75-50	115	61	37	17	384	1	pce
1032886	75-63	137	61	59	17	384	1	pce

Uponor S-Press PLUS tee PPSU

- Unique press indicator
- Fast 3-step installation (press without bevel)
- Innovative QR code for immediate digital access
- Colour code

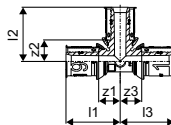

Item no.	Dimension	l1 mm	l2 mm	l3 mm	z1 mm	z2 mm	z3 mm	Qty 2	Qty 1	UOM
1039944	16-16-16	33	33	33	13	13	13	80	10	pce
1039945	20-20-20	37	37	37	16	16	16	80	10	pce
1039946	25-25-25	48	48	48	19	19	19	20	5	pce
1039947	32-32-32	51	51	51	23	23	23	20	5	pce

Uponor S-Press composite tee PPSU

- Fast installation with easy bevel and without calibration
- Colour code

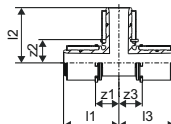

Item no.	Dimension	l1 mm	l2 mm	l3 mm	z1 mm	z2 mm	z3 mm	Qty 2	Qty 1	UOM
1046390	40-40-40	68	68	68	29	29	29	720	5	pce
1046391	50-50-50	73	73	73	33	33	33	288	3	pce
1032887	63-63-63	101	101	101	42	40	42	150	1	pce
1032888	75-75-75	108	107	108	47	47	47	150	1	pce

Uponor S-Press PLUS

Uponor S-Press PLUS tee red. PPSU

- Fixed stainless steel sleeve
- Unique press indicator
- Fast 3-step installation (press without bevel)
- Innovative QR code for immediate digital access
- Colour code

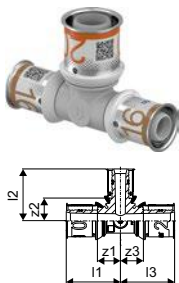

Item no.	Dimension	l1 mm	l2 mm	l3 mm	z1 mm	z2 mm	z3 mm	Qty 2	Qty 1	UOM
1039948	16-20-16	35	35	35	15	13	15	80	10	pce
1039949	20-16-16	37	36	36	16	16	16	80	10	pce
1039950	20-16-20	37	36	37	16	16	16	80	10	pce
1039951	20-20-16	37	37	36	16	16	16	80	10	pce
1039952	20-25-20	41	48	41	19	19	19	80	10	pce
1039953	25-16-16	48	39	39	19	19	19	80	10	pce
1039954	25-16-20	48	39	41	19	19	19	80	10	pce
1039955	25-16-25	48	39	48	19	19	19	80	10	pce
1039956	25-20-20	48	41	41	19	19	19	80	10	pce
1039957	25-20-25	48	41	48	19	19	19	80	10	pce
1039958	32-16-32	51	43	51	23	23	23	20	5	pce
1039959	32-20-32	51	44	51	23	23	23	20	5	pce
1039960	32-25-25	51	51	51	23	23	23	20	5	pce
1039961	32-25-32	51	51	51	23	23	23	20	5	pce

Uponor S-Press tee red. PPSU

- Fast installation with easy bevel and without calibration
- Colour code

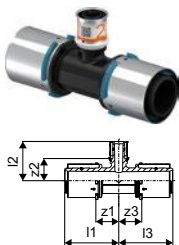

Item no.	Dimension	l1 mm	l2 mm	l3 mm	z1 mm	z2 mm	z3 mm	Qty 2	Qty 1	UOM
1039962	40-20-40	68	49	68	29	28	29	960	5	pce
1039963	40-25-32	68	56	56	29	28	28	960	5	pce
1039964	40-25-40	68	56	68	29	28	29	720	5	pce
1039965	40-32-32	68	56	56	29	28	28	960	5	pce
1039966	40-32-40	68	56	68	29	28	29	720	5	pce
1039967	50-25-40	73	61	73	34	33	34	432	3	pce
1039968	50-25-50	73	61	73	34	33	34	432	3	pce
1039969	50-32-50	73	61	73	34	33	34	432	3	pce

Uponor S-Press composite tee reducer PPSU

- Fast installation with easy bevel and without calibration
- Colour code

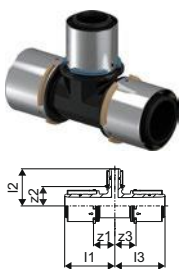

Item no.	Dimension	l1 mm	l2 mm	l3 mm	z1 mm	z2 mm	z3 mm	Qty 2	Qty 1	UOM
1046400	50-40-50	73	73	73	33	33	33	288	3	pce
1032889	63-25-63	101	68	101	40	39	40	150	1	pce
1032890	63-32-63	101	68	101	40	39	40	150	1	pce
1032891	63-40-63	101	79	101	40	40	40	150	1	pce
1032892	75-32-75	108	74	108	47	45	47	150	1	pce
1032893	75-40-75	108	86	108	47	44	47	150	1	pce
1032894	75-50-75	108	86	108	47	49	47	150	1	pce

Uponor S-Press PLUS

Uponor S-Press PLUS

Specification

- made of tin-plated DR brass

Uponor S-Press PLUS adapter male thread

- Unique press indicator
- Fast 3-step installation (press without bevel)
- Innovative QR code for immediate digital access

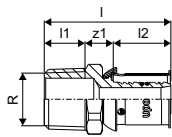

Item no.	Dimension	l mm	l1 mm	l2 mm	R inch	z1 mm	Qty 2	Qty 1	UOM
1070502	16-R $\frac{1}{2}$ "MT	44	14	20	$\frac{1}{2}$	10	80	20	pce
1070503	16-R $\frac{3}{4}$ "MT	46	16	20	$\frac{3}{4}$	11	120	15	pce
1133523	20-R $\frac{1}{2}$ "MT	45	14	21	$\frac{1}{2}$	10	80	20	pce
1070505	20-R $\frac{3}{4}$ "MT	48	15	21	$\frac{3}{4}$	11	80	10	pce
1070506	20-R1"MT	54	17	21	1	16	80	10	pce
1070507	25-R $\frac{3}{4}$ "MT	55	15	28	$\frac{3}{4}$	11	80	10	pce
1070508	25-R1"MT	62	18	28	1	16	40	5	pce
1070509	32-R1"MT	62	17	28	1	16	40	5	pce
1070510	32-R1 $\frac{1}{4}$ "MT	66	19	28	1 $\frac{1}{4}$	19	20	5	pce

Uponor S-Press adapter male thread

- Made of tin-plated brass
- Fast installation with easy bevel and without calibration
- Colour code

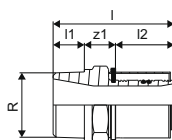

Item no.	Dimension	l mm	l1 mm	l2 mm	R inch	z1 mm	d mm	Qty 2	Qty 1	UOM
1046901	40-R1 $\frac{1}{4}$ "MT	78	20	38	1 $\frac{1}{4}$	20		960	5	pce
1046902	40-R1 $\frac{1}{2}$ "MT	80	20	38	1 $\frac{1}{2}$	22	40	960	5	pce
1046905	50-R1 $\frac{1}{2}$ "MT	80	20	38	1 $\frac{1}{2}$	22	50	1152	3	pce
1046906	50-R2"MT	84	24	38	2	22	50	576	3	pce
1032895	63-R2"MT	111	28	61	2	22		336	1	pce
1032896	75-R2 $\frac{1}{2}$ "MT	110	27	61	2 $\frac{1}{2}$	22		336	1	pce

Uponor S-Press PLUS

Uponor S-Press PLUS adapt. female thread

- Unique press indicator
- Fast 3-step installation (press without bevel)
- Innovative QR code for immediate digital access

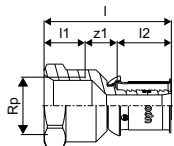

Item no.	Dimension	l mm	l1 mm	l2 mm	Rp inch	z1 mm	Qty 2	Qty 1	UOM
1070515	16-Rp1/2"FT	47	15	20	1/2	12	80	20	pce
1070516	20-Rp1/2"FT	47	15	21	1/2	10	120	15	pce
1070517	20-Rp3/4"FT	51	16	21	3/4	14	80	10	pce
1070518	20-Rp1"FT	52	19	21	1	12	80	20	pce
1070519	25-Rp3/4"FT	56	17	28	3/4	11	40	5	pce
1070520	25-Rp1"FT	59	19	28	1	12	40	5	pce
1070521	32-Rp1"FT	58	20	28	1	10	40	5	pce
1070522	32-Rp1 1/4"FT	62	21	28	1 1/4	13	20	5	pce

Uponor S-Press adapter female thread

- Made of tin-plated brass
- Fast installation with easy bevel and without calibration
- Colour code

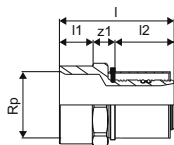

Item no.	Dimension	l mm	l1 mm	l2 mm	Rp inch	z1 mm	Qty 2	Qty 1	UOM
1046903	40-Rp1 1/4"FT	73	21	38	1 1/4	14	960	5	pce
1046904	40-Rp1 1/2"FT	77	21	38	1 1/2	18	960	5	pce
1046907	50-Rp1 1/2"FT	73	21	38	1 1/2	14	1152	3	pce

Uponor S-Press PLUS

Uponor S-Press PLUS elbow

- Unique press indicator
- Fast 3-step installation (press without bevel)
- Innovative QR code for immediate digital access



Item no.	Dimension	l1 mm	l2 mm	z1 mm	z2 mm	Qty 2	Qty 1	UOM
1070523	16-16	34	34	14	14	80	20	pce
1070524	20-20	37	37	16	16	80	10	pce
1070525	25-25	47	47	19	19	40	5	pce
1070526	32-32	51	51	23	23	20	5	pce

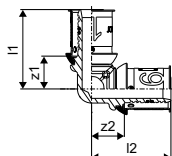

Uponor S-Press elbow

- Made of tin-plated brass
- Fast installation with easy bevel and without calibration
- Colour code



Item no.	Dimension	l1 mm	l2 mm	z1 mm	z2 mm	Qty 2	Qty 1	UOM
1046908	40-40	72	72	34	34	600	5	pce
1046911	50-50	79	79	41	41	240	3	pce

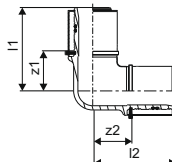

Uponor S-Press PLUS bend

- Made of casted DR brass
- Unique press indicator
- Fast 3-step installation (press without bevel)
- Innovative QR code for immediate digital access
- extra low pressure loss



Item no.	Dimension	l1 mm	l2 mm	z1 mm	z2 mm	Qty 2	Qty 1	UOM
1070527	16-16	37	37	17	17	80	10	pce
1070528	20-20	40	40	19	19	80	10	pce
1070529	25-25	50	50	22	22	40	5	pce
1070530	32-32	56	56	28	28	20	5	pce

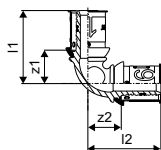

Uponor S-Press PLUS

Uponor S-Press PLUS elbow male thread

- Unique press indicator
- Fast 3-step installation (press without bevel)
- Innovative QR code for immediate digital access

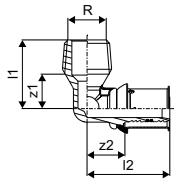

Item no.	Dimension	l1 mm	l2 mm	R inch	z1 mm	z2 mm	Qty 2	Qty 1	UOM
1070532	16-R $\frac{1}{2}$ "MT	30	37	$\frac{1}{2}$	15	17	80	20	pce
1070533	20-R $\frac{1}{2}$ "MT	32	41	$\frac{1}{2}$	15	19	80	10	pce
1070534	20-R $\frac{3}{4}$ "MT	34	41	$\frac{3}{4}$	18	19	80	10	pce
1070535	25-R $\frac{3}{4}$ "MT	36	48	$\frac{3}{4}$	20	19	40	5	pce
1070536	25-R1"MT	43	51	1	22	23	40	5	pce
1070537	32-R1"MT	43	51	1	22	23	20	5	pce

Uponor S-Press elbow adapter male thread

- Made of tin-plated brass
- Fast installation with easy bevel and without calibration
- Colour code

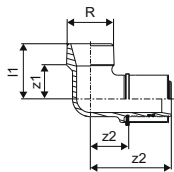

Item no.	Dimension	l1 mm	l2 mm	R inch	z1 mm	z2 mm	Qty 2	Qty 1	UOM
1046909	40-R1 $\frac{1}{4}$ "MT	49	72	1 $\frac{1}{4}$	30	34	500	5	pce

Uponor S-Press PLUS elbow female thread

- Unique press indicator
- Fast 3-step installation (press without bevel)
- Innovative QR code for immediate digital access

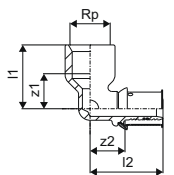

Item no.	Dimension	l1 mm	l2 mm	Rp inch	z1 mm	z2 mm	Qty 2	Qty 1	UOM
1070539	16-Rp $\frac{1}{2}$ "FT	33	38	$\frac{1}{2}$	18	18	80	10	pce
1070540	20-Rp $\frac{1}{2}$ "FT	36	41	$\frac{1}{2}$	21	19	80	10	pce
1070541	20-Rp $\frac{3}{4}$ "FT	36	43	$\frac{3}{4}$	19	22	40	10	pce
1070542	25-Rp $\frac{3}{4}$ "FT	40	50	$\frac{3}{4}$	23	22	20	5	pce
1070543	25-Rp1"FT	45	54	1	25	26	20	5	pce
1070544	32-Rp1"FT	49	54	1	30	26	20	5	pce

Uponor S-Press PLUS

Uponor S-Press elbow adap. female thread

- Made of tin-plated brass
- Fast installation with easy bevel and without calibration
- Colour code

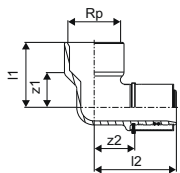

Item no.	Dimension	l1 mm	l2 mm	Rp inch	z1 mm	z2 mm	Qty 2	Qty 1	UOM
1046910	40-Rp1 ½"FT	59	75	1 ½	38	37	500	5	pce
1046912	50-Rp1 ½"FT	59	79	1 ½	38	41	300	3	pce

Uponor S-Press PLUS elbow 45

- Unique press indicator
- Fast 3-step installation (press without bevel)
- Innovative QR code for immediate digital access

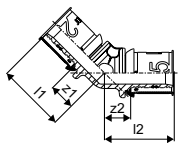

Item no.	Dimension	l1 mm	l2 mm	z1 mm	z2 mm	Qty 2	Qty 1	UOM
1070545	25-25	46	46	18	18	20	5	pce
1070546	32-32	49	49	23	23	20	5	pce

Uponor S-Press elbow 45

- Made of tin-plated brass
- Fast installation with easy bevel and without calibration
- Colour code

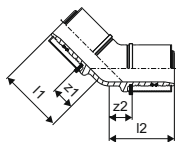

Item no.	Dimension	l1 mm	l2 mm	z1 mm	z2 mm	Qty 2	Qty 1	UOM
1046913	40-40	59	59	21	21	500	5	pce
1046914	50-50	63	63	25	25	300	3	pce

Uponor S-Press PLUS

Uponor S-Press PLUS coupling

- Unique press indicator
- Fast 3-step installation (press without bevel)
- Innovative QR code for immediate digital access

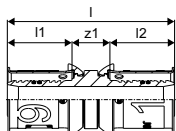

Item no.	Dimension	l mm	l1 mm	l2 mm	z1 mm	Qty 2	Qty 1	UOM
1070547	16-16	51	20	20	12	80	20	pce
1133566	20-20	54	21	21	12	80	10	pce
1133567	25-25	68	28	28	12	80	10	pce
1133568	32-32	68	28	28	12	40	5	pce

Uponor S-Press coupling

- Made of tin-plated brass
- Fast installation with easy bevel and without calibration
- Colour code

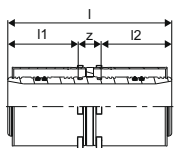

Item no.	Dimension	l mm	l1 mm	l2 mm	z1 mm	Qty 2	Qty 1	UOM
1046932	40-40	88	38	38	12	960	5	pce
1046935	50-50	88	38	38	12	576	3	pce

Uponor S-Press PLUS reducer

- Unique press indicator
- Fast 3-step installation (press without bevel)
- Innovative QR code for immediate digital access

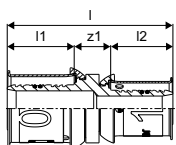

Item no.	Dimension	l mm	l1 mm	l2 mm	z1 mm	Qty 2	Qty 1	UOM
1133569	20-16	53	21	20	12	80	20	pce
1133570	25-16	60	28	20	12	80	10	pce
1133571	25-20	61	28	21	12	80	10	pce
1133572	32-20	61	28	21	12	80	10	pce
1133573	32-25	68	28	28	12	80	10	pce

Uponor S-Press PLUS

Uponor S-Press reducer

- Made of tin-plated brass



Item no.	Dimension	l	l1	l2	z1	Qty 2	Qty 1	UOM
		mm	mm	mm	mm			
1046934	50-40	89	38	38	14	576	3	pce

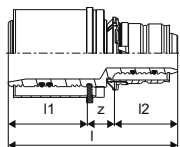

Uponor S-Press PLUS tee

- Unique press indicator
- Fast 3-step installation (press without bevel)
- Innovative QR code for immediate digital access



Item no.	Dimension	l1	l2	l3	z1	z2	z3	Qty 2	Qty 1	UOM
		mm	mm	mm	mm	mm	mm			
1070560	16-16-16	34	34	34	14	14	14	80	10	pce
1070561	20-20-20	37	37	37	16	16	16	80	10	pce
1070562	25-25-25	47	47	47	19	19	19	20	5	pce
1070563	32-32-32	51	51	51	23	23	23	20	5	pce

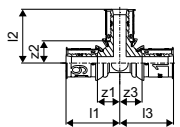

Uponor S-Press tee

- Made of tin-plated brass
- Fast installation with easy bevel and without calibration
- Colour code



Item no.	Dimension	l1	l2	l3	z1	z2	z3	Qty 2	Qty 1	UOM
		mm	mm	mm	mm	mm	mm			
1046921	40-40-40	72	72	72	34	34	34	400	5	pce
1046928	50-50-50	79	79	79	41	41	41	300	3	pce

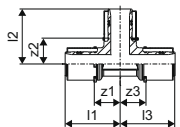

Uponor S-Press PLUS

Uponor S-Press PLUS tee reducer

- Unique press indicator
- Fast 3-step installation (press without bevel)
- Innovative QR code for immediate digital access

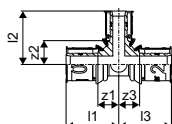

Item no.	Dimension	l1 mm	l2 mm	l3 mm	z1 mm	z2 mm	z3 mm	Qty 2	Qty 1	UOM
1070566	16-20-16	36	37	36	16	16	16	80	10	pce
1070567	20-16-16	35	36	34	14	16	14	40	10	pce
1070568	20-16-20	35	36	35	14	16	14	80	20	pce
1070569	20-20-16	37	37	36	16	16	16	80	20	pce
1070570	20-25-16	40	47	38	19	19	19	40	10	pce
1070571	20-25-20	40	47	40	19	19	19	40	10	pce
1070572	25-16-16	44	38	36	16	19	17	40	5	pce
1070573	25-16-20	44	38	38	16	19	17	40	5	pce
1070574	25-16-25	42	38	42	14	19	14	20	5	pce
1070575	25-20-16	44	40	36	16	19	17	40	5	pce
1070576	25-20-20	44	40	38	16	19	17	40	5	pce
1070577	25-20-25	44	40	44	16	19	16	20	5	pce
1070578	25-25-16	47	47	38	19	19	19	20	5	pce
1070579	25-32-25	50	48	50	22	20	22	20	5	pce
1070580	32-16-32	43	42	43	15	22	15	20	5	pce
1070581	32-20-32	45	43	45	17	22	17	20	5	pce
1070582	32-25-25	48	50	48	20	22	20	20	5	pce
1070583	32-25-32	48	50	48	20	22	20	20	5	pce

Uponor S-Press PLUS

Uponor S-Press PLUS tee male thread

- Unique press indicator
- Fast 3-step installation (press without bevel)
- Innovative QR code for immediate digital access

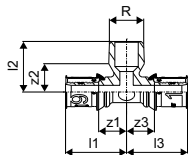

Item no.	Dimension	l1 mm	l2 mm	l3 mm	R mm	z1 mm	z2 mm	z3 mm	Qty 2	Qty 1	UOM
1070592	16-R $\frac{1}{2}$ "MT-16	38	30	38	$\frac{1}{2}$	18	15	18	40	10	pce
1070593	25-R $\frac{3}{4}$ "MT-25	48	36	48	$\frac{3}{4}$	19	21	19	20	5	pce
1070594	32-R $\frac{3}{4}$ "MT-32	48	40	48	$\frac{3}{4}$	19	25	19	20	5	pce

Uponor S-Press PLUS tee female thread

- Unique press indicator
- Fast 3-step installation (press without bevel)
- Innovative QR code for immediate digital access

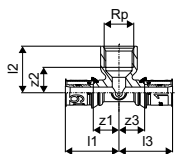

Item no.	Dimension	l1 mm	l2 mm	l3 mm	Rp mm	z1 mm	z2 mm	z3 mm	Qty 2	Qty 1	UOM
1070595	16-Rp $\frac{1}{2}$ "FT-16	38	33	38	$\frac{1}{2}$	18	18	18	40	10	pce
1070596	20-Rp $\frac{1}{2}$ "FT-20	40	35	40	$\frac{1}{2}$	19	20	19	60	15	pce
1070597	20-Rp $\frac{3}{4}$ "FT-20	43	37	43	$\frac{3}{4}$	22	20	22	40	10	pce
1070598	25-Rp $\frac{1}{2}$ "FT-25	48	37	48	$\frac{1}{2}$	19	22	19	20	5	pce
1070599	25-Rp $\frac{3}{4}$ "FT-25	50	40	50	$\frac{3}{4}$	22	23	22	20	5	pce
1070600	32-Rp $\frac{1}{2}$ "FT-32	47	40	47	$\frac{1}{2}$	18	25	18	20	5	pce
1070601	32-Rp $\frac{3}{4}$ "FT-32	51	44	51	$\frac{3}{4}$	23	27	23	20	5	pce

Uponor S-Press tee adapter female thread

- Made of tin-plated brass
- Fast installation with easy bevel and without calibration
- Colour code

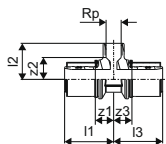

Item no.	Dimension	l1 mm	l2 mm	l3 mm	Rp mm	z1 mm	z2 mm	z3 mm	Qty 2	Qty 1	UOM
1046922	40-Rp $\frac{1}{2}$ "FT-40	69	47	69	$\frac{1}{2}$	31	30	31	500	5	pce
1046923	40-Rp $\frac{3}{4}$ "FT-40	64	47	64	$\frac{3}{4}$	26	31	26	400	5	pce
1046929	50-Rp1"FT-50	72	56	72	1	34	37	34	240	3	pce

Uponor S-Press PLUS

Uponor S-Press PLUS adapter swivel nut

- Unique press indicator
- Fast 3-step installation (press without bevel)
- Innovative QR code for immediate digital access
- Releasable screw connector for connection to on-wall fittings, filters and shut-off valves
- Thread acc. to EN ISO 228-1.

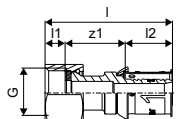

Item no.	Dimension	l	l1	l2	G	z1	Qty 2	Qty 1	UOM
		mm	mm	mm	inch	mm			
1070602	16-G $\frac{1}{2}$ "SN	53	8	20	$\frac{1}{2}$	25	30	1	pce
1070603	16-G $\frac{3}{4}$ "SN	44	8	20	$\frac{3}{4}$	17	20	1	pce
1070604	20-G $\frac{1}{2}$ "SN	59	8	21	$\frac{1}{2}$	30	20	1	pce
1070605	20-G $\frac{3}{4}$ "SN	46	8	21	$\frac{3}{4}$	17	20	1	pce
1070606	25-G $\frac{3}{4}$ "SN	64	8	28	$\frac{3}{4}$	28	15	1	pce
1070607	25-G1"SN	57	9	28	1	20	15	1	pce
1070610	32-G1 $\frac{1}{4}$ "SN	59	9	28	1 $\frac{1}{4}$	22	10	1	pce

Uponor S-Press adapter swivel nut

- Made of tin-plated brass
- Fast installation with easy bevel and without calibration
- Colour code
- Releasable screw connector for connection to on-wall fittings, filters and shut-off valves
- Thread acc. to EN ISO 228-1.

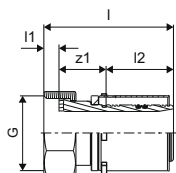

Item no.	Dimension	l	l1	l2	G	z1	Qty 2	Qty 1	UOM
		mm	mm	mm	inch	mm			
1046937	40-G1 $\frac{1}{2}$ "SN	77	10	38	1 $\frac{1}{2}$	30	960	5	pce
1046939	50-G2"SN	82	12	38	2	32	576	3	pce

Uponor S-Press PLUS

Uponor S-Press PLUS tap elbow M

- Unique press indicator
- Fast 3-step installation (press without bevel)
- Innovative QR code for immediate digital access
- for on wall installation or attachment with rotation protection to the Uponor Smart Aqua mounting angles and plates.

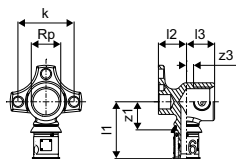

Item no.	Dimension	I1 mm	I2 mm	I3 mm	Rp inch	z1 mm	z3 mm	k mm	Qty 2	Qty 1	UOM
1070638	16-Rp $\frac{3}{8}$ "FT	41	17	22	$\frac{3}{8}$	21	11	40	40	10	pce
1070639	16-Rp $\frac{1}{2}$ "FT	41	17	22	$\frac{1}{2}$	21	7	40	40	10	pce
1070640	20-Rp $\frac{1}{2}$ "FT	42	17	23	$\frac{1}{2}$	21	8	40	40	10	pce
1070641	20-Rp $\frac{3}{4}$ "FT	45	17	23	$\frac{3}{4}$	24	7	40	20	5	pce
1070642	25-Rp $\frac{3}{4}$ "FT	54	27	25	$\frac{3}{4}$	26	8	40	20	5	pce

Uponor S-Press PLUS tap elbow L

- Unique press indicator
- Fast 3-step installation (press without bevel)
- Innovative QR code for immediate digital access
- for on wall installation or attachment with rotation protection to the Uponor Smart Aqua mounting angles and plates.

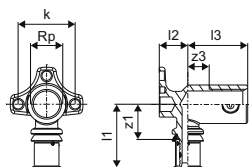

Item no.	Dimension	I1 mm	I2 mm	I3 mm	Rp inch	z1 mm	z3 mm	k mm	Qty 2	Qty 1	UOM
1070644	16-Rp $\frac{1}{2}$ "FT	42	20	30	$\frac{1}{2}$	22	15	40	40	10	pce
1070645	20-Rp $\frac{1}{2}$ "FT	46	20	30	$\frac{1}{2}$	25	15	40	40	10	pce

Uponor S-Press PLUS sound + leak protect

- Set is suitable for two Uponor S-Press PLUS tap elbows 16-Rp $\frac{1}{2}$ "FT or 20-Rp $\frac{1}{2}$ "FT
- Pins and screws M6 x 16 included
- Made of EPP
- Sound protection acc., VDI 4100
- Drainage function conform to DIN 18534

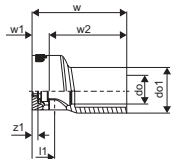

Item no.	Dimension	I1 mm	I2 mm	z1 mm	Qty 2	Qty 1	UOM
1121193	16-20	20	74	3	192	1	set
1121194	16-20	23	71	3	192	1	set

Uponor S-Press PLUS

Uponor S-Press PLUS U-tap elbow

- Unique press indicator
- Fast 3-step installation (press without bevel)
- Innovative QR code for immediate digital access
- For on wall installation or attachment with rotation protection to the Uponor Smart Aqua mounting angles and plates.

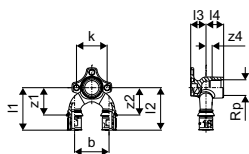

Item no.	Dimension	l1	l2	l3	l4	Rp	z1	z2	z4	b	k	Qty 2	Qty 1	UOM
		mm	mm	mm	mm	inch	mm	mm	mm	mm	mm			
1070629	16-Rp½"FT-16	56	56	20	23	½	36	36	8	45	40	20	5	pce
1070630	20-Rp½"FT-20	57	57	20	23	½	36	36	8	45	40	960	5	pce
1070631	20-Rp½"FT-16	57	56	20	23	½	36	36	8	45	40	960	5	pce
1070632	16-Rp½"FT-20	56	57	20	23	½	36	36	8	45	40	960	5	pce
1070633	25-Rp½"FT-25	64	64	27	24	½	36	36	9	60	40	576	3	pce
1070634	25-Rp½"FT-20	64	57	27	24	½	36	36	9	60	40	576	3	pce

Uponor S-Press PLUS tap elbow twin 90 long

- Unique press indicator
- Fast 3-step installation (press without bevel)
- Innovative QR code for immediate digital access
- For on wall installation or attachment with rotation protection to the Uponor Smart Aqua mounting angles and plates.
- Thread acc. to EN ISO 228-1

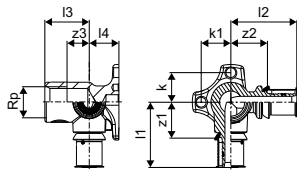

Item no.	Dimension	l1	l2	l3	l4	Rp	z1	z2	z3	k	k1	Qty 2	Qty 1	UOM
		mm	mm	mm	mm	inch	mm	mm	mm	mm	mm			
1070648	16-Rp½"FT-16	44	45	30	20	½	24	25	15	20	20	40	10	pce
1070649	20-Rp½"FT-20	46	46	30	20	½	24	25	15	20	20	40	10	pce

Uponor S-Press PLUS stop end

- Unique press indicator
- Fast 3-step installation (press without bevel)
- Innovative QR code for immediate digital access

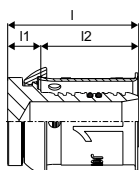

Item no.	Dimension	l	l1	l2	Qty 2	Qty 1	UOM
		mm	mm	mm			
1133625	16	27	7	20	160	40	pce
1133626	20	28	7	21	7680	20	pce
1133627	25	35	7	28	3840	10	pce
1133628	32	35	7	28	1920	5	pce

Uponor S-Press PLUS

Uponor S-Press PLUS adapter wall penetr.

- Unique press indicator
- Fast 3-step installation (press without bevel)
- Innovative QR code for immediate digital access
- For lead-through through walls.
- Dimensions of attachment plate (H x W x D) 100 x 50 x 2 mm.
- Hole circle diameter 33 mm.

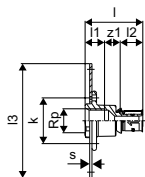

Item no.	Dimension	l	l1	l2	l3	s	Rp	z1	k	Qty 2	Qty 1	UOM
		mm	mm	mm	mm	mm	inch	mm	mm			
1070652	16-G $\frac{1}{2}$ "FT	51	17	20	100	2	$\frac{1}{2}$	14	40	5	1	pce

Uponor S-Press PLUS adapter

- Unique press indicator
- Fast 3-step installation (press without bevel)
- Innovative QR code for immediate digital access
- With soldered copper pipe according EN 1057 (half hard / R250)
- complete tin-plated
- Attention:
The copper side is for press connections and suitable compression fittings only.

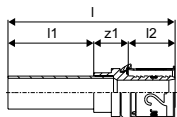

Item no.	Dimension	l	l1	l2	z1	Qty 2	Qty 1	UOM
		mm	mm	mm	mm			
1070615	16-15CU	76	40	20	16	160	20	pce
1070707	20-15CU	76	39	21	16	3840	10	pce

Uponor S-Press PLUS

Uponor S-Press PLUS mounting plate

- Made of galvanized steel.
- For the installation of Uponor Smart Aqua tap elbows
- Positioning of the connections in the given raster
- Plastic pins and loss protected screws M6x12 acc. DIN 965 included
- With holes and slots for easy attachment



NEW

Item no.	Dimension	l mm	s mm	h mm	k mm	k1 mm	w mm	Qty 2	Qty 1	UOM
1121197	80/150mm	265	3	9	80	150	35	5	1	pce

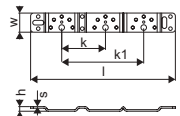

Uponor S-Press PLUS mounting angle

- Made of galvanized steel.
- For the installation of Uponor Smart Aqua tap elbows
- Positioning of the connections in the given raster
- Plastic pins and loss protected screws M6x12 acc. DIN 965 included
- With holes and slots for easy attachment

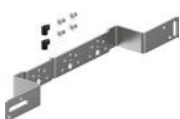

NEW

Item no.	Dimension	l mm	s mm	b mm	h mm	k mm	k1 mm	w mm	Qty 2	Qty 1	UOM
1121195	80/150mm	440	3	266	57	80	150	35	5	1	pce

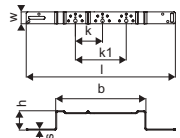

Uponor Smart Aqua single mounting angle

- Made of galvanized steel.
- For the installation of Uponor Smart Aqua tap elbows.
- Positioning of the connections in the given raster.
- Screws M6x12 acc. DIN 965 included. With holes and slots for easy attachment



Item no.	Dimension	l mm	b mm	h mm	Qty 2	Qty 1	UOM
1057843		144	82	46	5	1	pce

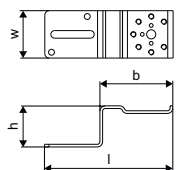

Uponor S-Press PLUS

Uponor Smart Aqua mounting rack

- Made of galvanized steel.
- For the installation of Uponor Smart Aqua tap elbows.
- Positioning of the connections in the given raster.
- Screws M6x12 acc. DIN 965 included. With holes and slots for easy attachment

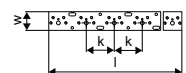
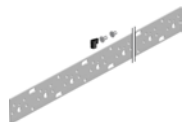

Item no.	Dimension	l mm	k mm	Qty 2	Qty 1	UOM
1057844	2m	2000	75	10	1	pce

Uponor Smart Aqua 10 pins+20 screws

- Pins and screws for mounting plates, angles and tracks.

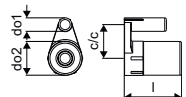

Item no.	Dimension	l mm	do1 mm	do2 mm	c/c1 mm	Qty 1	UOM
1057847*		17	4	10	10	1	set

uponor

Uponor GmbH

P.O. Box 1641
97433 Hassfurt
Germany

Australia

T +49-(0)9521 690 0
F +49-(0)9521 690 750
E international@uponor.com

T +61 (0)7 3202 6831
M +61 (0)477 136 977
E international@uponor.com

01/2024



www.uponor.com