

# Adaptateurs ProPEX pour coude de collecteur

## Renseignements sur le projet

Nom du poste :	Lieu :
Ingénieur :	Date de soumission:
Entrepreneur :	Présentée par:
Représentant du fabricant :	Approuvé par :

## Données techniques

Material	Brass
Temp/pressure ratings	73 °F (23 °C) at 160 psi (11 bar) 180 °F (82 °C) at 100 psi (6.9 bar) 200 °F (93 °C) at 80 psi (5.5 bar)
Prop 65 label required?	Yes

## Informations sur le produit et utilisation de l'application

Uponor ProPEX® Manifold Elbow Adapter threads into Uponor TruFLOW™ and Engineered Polymer (EP) Heating Manifolds to adapt to ProPEX connections in radiant heating and cooling applications.<sup>1</sup>

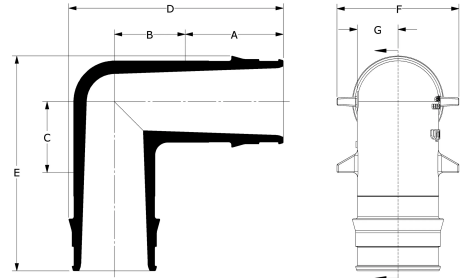

Nom de la pièce	Numéro de pièce	A [inch]	B [inch]	C [inch]	D [inch]	E [inch]	F [inch]	End Type 1	End Type 2	Cv	Equivalent length branch [ft]
ProPEX Manifold Elbow Adapter, R32 x 3/4" ProPEX	Q4153275	0.945	0.9	1.15	2.663	2.33	1.635	ProPEX 3/4"	ISO 228-G 1-1/4"	-	-
ProPEX Manifold Elbow Adapter, R32 x 1" ProPEX	Q4153210	1.181	0.9	1.15	2.898	2.33	1.635	ProPEX 1"	ISO 228-G 1-1/4"	-	-
ProPEX Manifold Elbow Adapter, R32 x 1 1/4" ProPEX	Q4153213	1.445	0.85	1.3	3.113	2.775	1.635	ProPEX 1-1/4"	ISO 228-G 1-1/4"	-	-
ProPEX Manifold Elbow Adapter, R32 x 1 1/2" ProPEX	Q4153215	1.704	0.85	1.3	3.372	2.775	1.635	ProPEX 1-1/2"	ISO 228-G 1-1/4"	-	-
Commercial Stainless-steel Manifold ProPEX Male Elbow Adapter, 1 1/2" PEX x 1 1/2" NPT	A2791515	1.704	0.85	1.25	3.504	3.025	1.9	ProPEX 1-1/2"	MNPT 1-1/2"	29.5	12.4

Nom de la pièce	Numéro de pièce	Weight per UOM [lbs/UOM]
ProPEX Manifold Elbow Adapter, R32 x 3/4" ProPEX	Q4153275	0.6
ProPEX Manifold Elbow Adapter, R32 x 1" ProPEX	Q4153210	0.62
ProPEX Manifold Elbow Adapter, R32 x 1 1/4" ProPEX	Q4153213	0.89
ProPEX Manifold Elbow Adapter, R32 x 1 1/2" ProPEX	Q4153215	0.91
Commercial Stainless-steel Manifold ProPEX Male Elbow Adapter, 1 1/2" PEX x 1 1/2" NPT	A2791515	1.06

Nom de la pièce	Numéro de pièce	Les codes	Normes	Annonces
Adaptateurs ProPEX pour coude de collecteur	All	IMC IRC NBC of Canada UMC	ASTM F1960 ASTM F877	cNSFus-rfh
In addition, the following parts have additional codes, standards, or listings:				
ProPEX Manifold Elbow Adapter, R32 x 3/4" ProPEX	Q4153275		R32: ISO 228-G 1¼"	
ProPEX Manifold Elbow Adapter, R32 x 1" ProPEX	Q4153210		R32: ISO 228-G 1¼"	
ProPEX Manifold Elbow Adapter, R32 x 1 1/4" ProPEX	Q4153213		R32: ISO 228-G 1¼"	
ProPEX Manifold Elbow Adapter, R32 x 1 1/2" ProPEX	Q4153215		R32: ISO 228-G 1¼"	
Commercial Stainless-steel Manifold ProPEX Male Elbow Adapter, 1 1/2" PEX x 1 1/2" NPT	A2791515		CSA B137.5 NSF/ANSI 14	ICC-ES-PMG ICC-ES-PMG 1012

L'installation	Applications connexes
R32 threads into the Uponor TruFLOW and EP Heating Manifolds. ProPEX end enables direct, 90-degree contact to Uponor PEX-a tubing. For additional information, refer to the Uponor Radiant Floor Heating Installation Handbook.	Radiant Heating and Cooling Systems

Notes de bas de page	Coordonnées de la personne-ressource		
-	<table border="0"> <tr> <td>Uponor Inc. 5925 148th Street West Apple Valley, MN 55124 T 800.321.4739 F 952.891.2008</td> <td>Uponor Ltd. 6510 Kennedy Road Mississauga, ON L5T 2X4 T 888.594.7726 F 800.638.9517</td> </tr> </table>	Uponor Inc. 5925 148th Street West Apple Valley, MN 55124 T 800.321.4739 F 952.891.2008	Uponor Ltd. 6510 Kennedy Road Mississauga, ON L5T 2X4 T 888.594.7726 F 800.638.9517
Uponor Inc. 5925 148th Street West Apple Valley, MN 55124 T 800.321.4739 F 952.891.2008	Uponor Ltd. 6510 Kennedy Road Mississauga, ON L5T 2X4 T 888.594.7726 F 800.638.9517		