

# Tés ProPEX en laiton sans plomb (LF)

## Renseignements sur le projet

Nom du poste :	Lieu :
Ingénieur :	Date de soumission:
Entrepreneur :	Présentée par:
Représentant du fabricant :	Approuvé par :

## Données techniques

Material	LF Brass
Temp/pressure ratings	73 °F (23 °C) at 160 psi (11 bar) 180 °F (82 °C) at 100 psi (6.9 bar) 200 °F (93 °C) at 80 psi (5.5 bar)
Prop 65 label required?	Yes

## Informations sur le produit et utilisation de l'application

Uponor's ProPEX® Lead-free Brass Tees are ideal for use in hot and cold domestic potable water systems.1 This product is approved for use in the AquaSAFE™ Residential Fire Safety System. Also approved for any hydronic heating system application. Each end of the ProPEX LF Brass Tee is manufactured with the Uponor ProPEX Fitting for connections to Wirsbo hePEX™ or Uponor AquaPEX® tubing. This product is safe for direct burial in soil.

Note: Temperature and pressure ratings stated are hydrostatic ratings. For domestic hot-water (DHW) and DHW recirculation installations, operating conditions should not exceed 140°F (60°C) at 80 psi (5.5 bar) in accordance with ASTM F2023. For additional information regarding application-specific temperature and pressure ratings, refer to the Uponor PEX Piping Systems Design and Installation Manual.

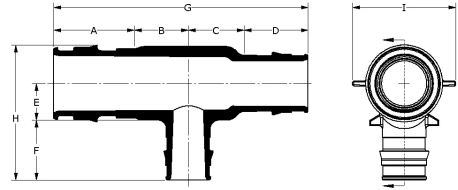

Nom de la pièce	Numéro de pièce	A [inch]	B [inch]	C [inch]	D [inch]	E [inch]	F [inch]	G [inch]	H [inch]	I [inch]	Cv Through
ProPEX LF Brass Tee, 1/2" PEX x 1/2" PEX x 1/2" PEX	LF4705050	0.709	0.55	0.55	0.709	0.3	0.709	2.517	1.316	0.85	7.3
ProPEX LF Brass Tee, 3/4" PEX x 3/4" PEX x 3/4" PEX	LF4707575	0.945	0.689	0.689	0.945	0.406	0.945	3.268	1.789	1.2	19.6
ProPEX LF Brass Tee, 1" PEX x 1" PEX x 1" PEX	LF4701010	1.181	0.865	0.865	1.181	0.559	1.181	4.092	2.295	1.46	35

Nom de la pièce	Numéro de pièce	Equivalent length branch [ft]	Equivalent length through [ft]	Cv Branch	End Type 1	End Type 2	End Type 3	Weight per UOM [lbs/UOM]
ProPEX LF Brass Tee, 1/2" PEX x 1/2" PEX x 1/2" PEX	LF4705050	5.12	1.15	3.7	ProPEX 1/2"	ProPEX 1/2"	ProPEX 1/2"	0.2
ProPEX LF Brass Tee, 3/4" PEX x 3/4" PEX x 3/4" PEX	LF4707575	4.91	0.8	9.4	ProPEX 3/4"	ProPEX 3/4"	ProPEX 3/4"	0.4
ProPEX LF Brass Tee, 1" PEX x 1" PEX x 1" PEX	LF4701010	5.92	0.83	16.2	ProPEX 1"	ProPEX 1"	ProPEX 1"	0.4

Nom de la pièce	Numéro de pièce	Les codes	Normes	Annonces
Tés ProPEX en laiton sans plomb (LF)	All	UPC IBC IRC IPC NPC of Canada UMC NSPC IMC	NSF/ANSI/CAN 372 ASTM F877 ASTM F1960 CSA B137.5 NSF/ANSI/CAN 61 NSF/ANSI 14	ICC-ES-PMG IAPMO 3558 U.P.Code

In addition, the following parts have additional codes, standards, or listings:

ProPEX LF Brass Tee, 1/2" PEX x 1/2" PEX x 1/2" PEX	LF4705050			cNSFus-pw-G
ProPEX LF Brass Tee, 3/4" PEX x 3/4" PEX x 3/4" PEX	LF4707575		UL 1821	cNSFus-pw-fs-G
ProPEX LF Brass Tee, 1" PEX x 1" PEX x 1" PEX	LF4701010		UL 1821	cNSFus-pw-fs-G

## L'installation

ProPEX Tool and ProPEX Rings (sold separately) are required for connecting the PEX tubing. Do not solder within 18 inches of the ProPEX connection. Refer to the AquaPEX Professional Plumbing Installation Guide, AquaSAFE Homeowner Handbook or Radiant Floor Heating Installation Handbook for additional information.

## Applications connexes

PEX-a Plumbing Systems  
Uponor Residential Fire Safety Systems  
Radiant Heating and Cooling Systems

Uponor Inc.  
5925 148th Street West  
Apple Valley, MN 55124  
T 800.321.4739  
F 952.891.2008

Uponor Ltd.  
6510 Kennedy Road  
Mississauga, ON L5T 2X4  
T 888.594.7726  
F 800.638.9517

---