

# Tés réducteurs ProPEX en laiton sans plomb (LF)

## Renseignements sur le projet

Nom du poste :	Lieu :
Ingénieur :	Date de soumission:
Entrepreneur :	Présentée par:
Représentant du fabricant :	Approuvé par :

## Données techniques

Material	LF Brass
End type 1	ProPEX 3/4"
End type 2	ProPEX 3/4"
End type 3	ProPEX 1"
Temp/pressure ratings	73 °F (23 °C) at 160 psi (11 bar) 180 °F (82 °C) at 100 psi (6.9 bar) 200 °F (93 °C) at 80 psi (5.5 bar)
Prop 65 label required?	Yes

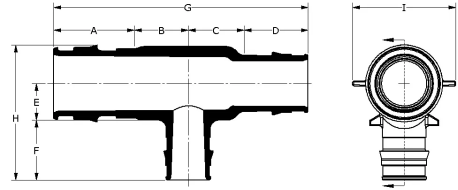

## Informations sur le produit et utilisation de l'application

Uponor's ProPEX® LF Brass Reducing Tee makes diverting connections for Uponor PEX tubing in supply and return mains. This product is available for use in hot and cold domestic potable water systems, in any hydronic heating system and in the AquaSAFE™ Residential Fire Safety System. Uponor manufactures each end of the tee with the ProPEX Fitting for easy connections to Wirsbo hePEX™ or Uponor AquaPEX® tubing. This product is safe for direct burial in soil. Note: Branch size is listed last in the part description.

Note: Temperature and pressure ratings stated are hydrostatic ratings. For domestic hot-water (DHW) and DHW recirculation installations, operating conditions should not exceed 140°F (60°C) at 80 psi (5.5 bar) in accordance with ASTM F2023. For additional information regarding application-specific temperature and pressure ratings, refer to the Uponor PEX Piping Systems Design and Installation Manual.

Nom de la pièce	Numéro de pièce	A [inch]	B [inch]	C [inch]	D [inch]	E [inch]	F [inch]	G [inch]	H [inch]	I [inch]	Weight per UOM [lbs/UOM]
ProPEX LF Brass Reducing Tee, 3/4" PEX x 3/4" PEX x 1" PEX	LF4707710	0.945	0.865	0.865	0.945	0.559	1.181	3.62	2.295	1.46	0.5

Nom de la pièce	Numéro de pièce	Les codes	Normes	Annonces
Tés réducteurs ProPEX en laiton sans plomb (LF)	LF4707710	UPC IBC IRC IPC NPC of Canada UMC NSPC IMC	NSF/ANSI/CAN 372 ASTM F877 ASTM F1960 CSA B137.5 UL 1821 NSF/ANSI/CAN 61 NSF/ANSI 14	cNSFus-pw-fs-G ICC-ES-PMG IAPMO 3558 U.P.Code

## L'installation

ProPEX Tool and ProPEX Rings (sold separately) are required for connecting PEX tubing. Refer to the AquaPEX Professional Plumbing Installation Guide, the AquaSAFE Residential Fire Sprinkler Installation Guide or the Radiant Floor Heating Installation Handbook for additional information.

## Applications connexes

- PEX-a Plumbing Systems
- Uponor Residential Fire Safety Systems
- Radiant Heating and Cooling Systems
- Permafrost Protection Systems
- Turf Conditioning Systems

## Notes de bas de page

## Coordonnées de la personne-ressource

Uponor Inc.  
5925 148th Street West  
Apple Valley, MN 55124  
T 800.321.4739  
F 952.891.2008

Uponor Ltd.  
6510 Kennedy Road  
Mississauga, ON L5T 2X4  
T 888.594.7726  
F 800.638.9517