

Coudes ProPEX en EP

Renseignements sur le projet

Nom du poste :	Lieu :
Ingénieur :	Date de soumission:
Entrepreneur :	Présentée par:
Représentant du fabricant :	Approuvé par :

Données techniques

Material	Engineered Polymer
Temp/pressure ratings	73 °F (23 °C) at 160 psi (11 bar) 180 °F (82 °C) at 100 psi (6.9 bar) 200 °F (93 °C) at 80 psi (5.5 bar)

Informations sur le produit et utilisation de l'application

ProPEX® engineered polymer (EP) elbows make 90-degree connections for Uponor crosslinked polyethylene (PEX-a) tubing for use in hot and cold domestic potable water systems, residential fire safety and hydronic radiant heating and cooling systems. Each end of the elbow is manufactured with an Uponor ProPEX fitting for connections to Uponor AquaPEX® or Wirsbo hePEX™ tubing.1

Note: Temperature and pressure ratings stated are hydrostatic ratings. For domestic hot-water (DHW) and DHW recirculation installations, operating conditions should not exceed 140°F (60°C) at 80 psi (5.5 bar) in accordance with ASTM F2023. For additional information regarding application-specific temperature and pressure ratings, refer to the Uponor PEX Piping Systems Design and Installation Manual.

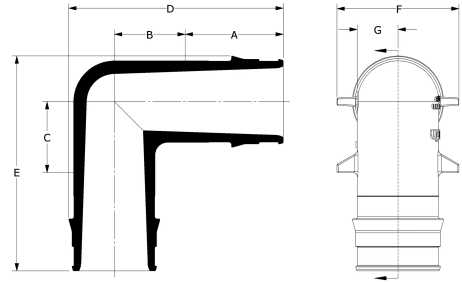

Nom de la pièce	Numéro de pièce	A [inch]	B [inch]	C [inch]	D [inch]	E [inch]	F [inch]	G [inch]	Cv	Equivalent length through [ft]	End Type 1
ProPEX EP Elbow, 1/2" PEX x 1/2" PEX	Q4760500	0.719	0.55	0.55	1.578	1.578	0.87	0.28	2.6	10.4	ProPEX 1/2"
ProPEX EP Elbow, 1" PEX x 1" PEX	Q4761000	1.191	0.86	0.86	2.606	2.606	1.48	0.494	11.9	11.52	ProPEX 1"
ProPEX EP Elbow, 1 1/4" PEX x 1 1/4" PEX	Q4761250	1.455	1.1	1.1	3.236	3.236	1.82	0.613	22.2	10	ProPEX 1-1/4"
ProPEX EP Elbow, 1 1/2" PEX x 1 1/2" PEX	Q4761500	1.714	1.2	1.2	3.661	3.661	2.07	0.67	29.7	11.52	ProPEX 1-1/2"
ProPEX EP Elbow, 2" PEX x 2" PEX	Q4762000	2.157	1.6	1.6	4.797	4.797	2.82	0.95	50.2	17.1	ProPEX 2"
ProPEX EP Elbow, 2 1/2" PEX x 2 1/2" PEX	Q4762500	2.83	2.1	2.1	6.22	6.22	3.6	1.22	86	20	ProPEX 2-1/2"
ProPEX EP Elbow, 3" PEX x 3" PEX	Q4763000	3.38	2.5	2.5	7.417	7.417	4.2	1.46	125	23.2	ProPEX 3"
ProPEX EP Elbow, 3/4" PEX x 3/4" PEX	Q4760750	0.955	0.675	0.675	2.067	2.067	1.22	0.386	6.7	10.8	ProPEX 3/4"

Nom de la pièce	Numéro de pièce	End Type 2	Prop 65 label required?	Weight per UOM [lbs/UOM]
ProPEX EP Elbow, 1/2" PEX x 1/2" PEX	Q4760500	ProPEX 1/2"	-	0.02
ProPEX EP Elbow, 1" PEX x 1" PEX	Q4761000	ProPEX 1"	-	0.07
ProPEX EP Elbow, 1 1/4" PEX x 1 1/4" PEX	Q4761250	ProPEX 1-1/4"	No	0.11
ProPEX EP Elbow, 1 1/2" PEX x 1 1/2" PEX	Q4761500	ProPEX 1-1/2"	No	0.18
ProPEX EP Elbow, 2" PEX x 2" PEX	Q4762000	ProPEX 2"	-	0.3
ProPEX EP Elbow, 2 1/2" PEX x 2 1/2" PEX	Q4762500	ProPEX 2-1/2"	-	0.85
ProPEX EP Elbow, 3" PEX x 3" PEX	Q4763000	ProPEX 3"	-	1.44
ProPEX EP Elbow, 3/4" PEX x 3/4" PEX	Q4760750	ProPEX 3/4"	-	0.03

Nom de la pièce	Numéro de pièce	Les codes	Normes	Annonces
Coudes ProPEX en EP	All	IMC UPC IBC IRC IPC NPC of Canada UMC NSPC	ASTM F1960 ASTM E119/UL 263 ASTM E84 ASTM E814/ULC S115 ASTM F877 CSA B137.5 ULC S102.2 NSF/ANSI/CAN 61 ULC S101 NSF/ANSI 14	IAPMO-ES ICC-ES-PMG UL U.P.Code cQAlus P321 HUD MR 1269
In addition, the following parts have additional codes, standards, or listings:				
ProPEX EP Elbow, 1/2" PEX x 1/2" PEX	Q4760500			cNSFus-pw
ProPEX EP Elbow, 1" PEX x 1" PEX	Q4761000		UL 1821	cNSFus-pw-fs
ProPEX EP Elbow, 1 1/4" PEX x 1 1/4" PEX	Q4761250		UL 1821	cNSFus-pw-fs
ProPEX EP Elbow, 1 1/2" PEX x 1 1/2" PEX	Q4761500			cNSFus-pw
ProPEX EP Elbow, 2" PEX x 2" PEX	Q4762000			cNSFus-pw
ProPEX EP Elbow, 2 1/2" PEX x 2 1/2" PEX	Q4762500			cNSFus-pw
ProPEX EP Elbow, 3" PEX x 3" PEX	Q4763000			cNSFus-pw
ProPEX EP Elbow, 3/4" PEX x 3/4" PEX	Q4760750		UL 1821	cNSFus-pw-fs

L'installation	Applications connexes
Use the appropriate ProPEX ring for PEX-a tubing. Refer to the Uponor Piping Pocket Guide, AquaSAFE™ Residential Fire Sprinkler Installation Guide or Uponor Radiant Installation Handbook for additional information.	PEX-a Plumbing Systems Hydronic Radiant Heating and Cooling Systems Turf Conditioning Systems Permafrost Prevention Systems AquaSAFE™ Fire Safety Systems

Notes de bas de page	Coordonnées de la personne-ressource
-	Uponor Inc. 5925 148th Street West Apple Valley, MN 55124 T 800.321.4739 F 952.891.2008
	Uponor Ltd. 6510 Kennedy Road Mississauga, ON L5T 2X4 T 888.594.7726 F 800.638.9517