

Coudes ProPEX en EP

Renseignements sur le projet

| | |
|-----------------------------|---------------------|
| Nom du poste : | Lieu : |
| Ingénieur : | Date de soumission: |
| Entrepreneur : | Présentée par: |
| Représentant du fabricant : | Approuvé par : |

Données techniques

| | |
|-----------------------|--|
| Material | Engineered Polymer |
| Temp/pressure ratings | 73 °F (23 °C) at 160 psi (11 bar) 180 °F (82 °C) at 100 psi (6.9 bar) 200 °F (93 °C) at 80 psi (5.5 bar) |

Informations sur le produit et utilisation de l'application

ProPEX® engineered polymer (EP) elbows make 90-degree connections for Uponor crosslinked polyethylene (PEX-a) tubing for use in hot and cold domestic potable water systems, residential fire safety and hydronic radiant heating and cooling systems. Each end of the elbow is manufactured with an Uponor ProPEX fitting for connections to Uponor AquaPEX® or Wirsbo hePEX™ tubing.1

Note: Temperature and pressure ratings stated are hydrostatic ratings. For domestic hot-water (DHW) and DHW recirculation installations, operating conditions should not exceed 140°F (60°C) at 80 psi (5.5 bar) in accordance with ASTM F2023. For additional information regarding application-specific temperature and pressure ratings, refer to the Uponor PEX Piping Systems Design and Installation Manual.

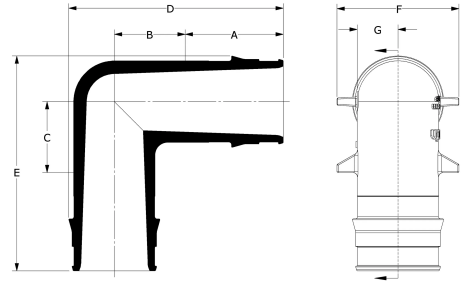

| Nom de la pièce | Numéro de pièce | A [inch] | B [inch] | C [inch] | D [inch] | E [inch] | F [inch] | G [inch] | Cv | Equivalent length through [ft] | End Type 1 |
|--|-----------------|----------|----------|----------|----------|----------|----------|----------|------|--------------------------------|---------------|
| ProPEX EP Elbow, 1/2" PEX x 1/2" PEX | Q4760500 | 0.719 | 0.55 | 0.55 | 1.578 | 1.578 | 0.87 | 0.28 | 2.6 | 10.4 | ProPEX 1/2" |
| ProPEX EP Elbow, 1" PEX x 1" PEX | Q4761000 | 1.191 | 0.86 | 0.86 | 2.606 | 2.606 | 1.48 | 0.494 | 11.9 | 11.52 | ProPEX 1" |
| ProPEX EP Elbow, 1 1/4" PEX x 1 1/4" PEX | Q4761250 | 1.455 | 1.1 | 1.1 | 3.236 | 3.236 | 1.82 | 0.613 | 22.2 | 10 | ProPEX 1-1/4" |
| ProPEX EP Elbow, 1 1/2" PEX x 1 1/2" PEX | Q4761500 | 1.714 | 1.2 | 1.2 | 3.661 | 3.661 | 2.07 | 0.67 | 29.7 | 11.52 | ProPEX 1-1/2" |
| ProPEX EP Elbow, 2" PEX x 2" PEX | Q4762000 | 2.157 | 1.6 | 1.6 | 4.797 | 4.797 | 2.82 | 0.95 | 50.2 | 17.1 | ProPEX 2" |
| ProPEX EP Elbow, 2 1/2" PEX x 2 1/2" PEX | Q4762500 | 2.83 | 2.1 | 2.1 | 6.22 | 6.22 | 3.6 | 1.22 | 86 | 20 | ProPEX 2-1/2" |
| ProPEX EP Elbow, 3" PEX x 3" PEX | Q4763000 | 3.38 | 2.5 | 2.5 | 7.417 | 7.417 | 4.2 | 1.46 | 125 | 23.2 | ProPEX 3" |
| ProPEX EP Elbow, 3/4" PEX x 3/4" PEX | Q4760750 | 0.955 | 0.675 | 0.675 | 2.067 | 2.067 | 1.22 | 0.386 | 6.7 | 10.8 | ProPEX 3/4" |

| Nom de la pièce | Numéro de pièce | End Type 2 | Prop 65 label required? | Weight per UOM [lbs/UOM] |
|--|-----------------|---------------|-------------------------|--------------------------|
| ProPEX EP Elbow, 1/2" PEX x 1/2" PEX | Q4760500 | ProPEX 1/2" | - | 0.02 |
| ProPEX EP Elbow, 1" PEX x 1" PEX | Q4761000 | ProPEX 1" | - | 0.07 |
| ProPEX EP Elbow, 1 1/4" PEX x 1 1/4" PEX | Q4761250 | ProPEX 1-1/4" | No | 0.11 |
| ProPEX EP Elbow, 1 1/2" PEX x 1 1/2" PEX | Q4761500 | ProPEX 1-1/2" | No | 0.18 |
| ProPEX EP Elbow, 2" PEX x 2" PEX | Q4762000 | ProPEX 2" | - | 0.3 |
| ProPEX EP Elbow, 2 1/2" PEX x 2 1/2" PEX | Q4762500 | ProPEX 2-1/2" | - | 0.85 |
| ProPEX EP Elbow, 3" PEX x 3" PEX | Q4763000 | ProPEX 3" | - | 1.44 |
| ProPEX EP Elbow, 3/4" PEX x 3/4" PEX | Q4760750 | ProPEX 3/4" | - | 0.03 |

| Nom de la pièce | Numéro de pièce | Les codes | Normes | Annonces |
|---|-----------------|--|--|---|
| Coudes ProPEX en EP | All | IMC UPC IBC IRC IPC NPC of Canada UMC NSPC | ASTM F1960 ASTM E119/UL 263 ASTM E84 ASTM E814/ULC S115 ASTM F877 CSA B137.5 ULC S102.2 NSF/ANSI/CAN 61 ULC S101 NSF/ANSI 14 | IAPMO-ES ICC-ES-PMG UL U.P.Code cQAlus P321 HUD MR 1269 |
| In addition, the following parts have additional codes, standards, or listings: | | | | |
| ProPEX EP Elbow, 1/2" PEX x 1/2" PEX | Q4760500 | | | cNSFus-pw |
| ProPEX EP Elbow, 1" PEX x 1" PEX | Q4761000 | | UL 1821 | cNSFus-pw-fs |
| ProPEX EP Elbow, 1 1/4" PEX x 1 1/4" PEX | Q4761250 | | UL 1821 | cNSFus-pw-fs |
| ProPEX EP Elbow, 1 1/2" PEX x 1 1/2" PEX | Q4761500 | | | cNSFus-pw |
| ProPEX EP Elbow, 2" PEX x 2" PEX | Q4762000 | | | cNSFus-pw |
| ProPEX EP Elbow, 2 1/2" PEX x 2 1/2" PEX | Q4762500 | | | cNSFus-pw |
| ProPEX EP Elbow, 3" PEX x 3" PEX | Q4763000 | | | cNSFus-pw |
| ProPEX EP Elbow, 3/4" PEX x 3/4" PEX | Q4760750 | | UL 1821 | cNSFus-pw-fs |

| L'installation | Applications connexes |
|--|---|
| Use the appropriate ProPEX ring for PEX-a tubing. Refer to the Uponor Piping Pocket Guide, AquaSAFE™ Residential Fire Sprinkler Installation Guide or Uponor Radiant Installation Handbook for additional information. | PEX-a Plumbing Systems Hydronic Radiant Heating and Cooling Systems Turf Conditioning Systems Permafrost Prevention Systems AquaSAFE™ Fire Safety Systems |

| Notes de bas de page | Coordonnées de la personne-ressource |
|----------------------|---|
| - | Uponor Inc. 5925 148th Street West Apple Valley, MN 55124 T 800.321.4739 F 952.891.2008 |
| | Uponor Ltd. 6510 Kennedy Road Mississauga, ON L5T 2X4 T 888.594.7726 F 800.638.9517 |