

Coudes au quart pour bain ProPEX en cuivre sans plomb (LF)



Renseignements sur le projet

Nom du poste :	Lieu :
Ingénieur :	Date de soumission:
Entrepreneur :	Présentée par:
Représentant du fabricant :	Approuvé par :

Données techniques

Material	Copper
Subcomponent Material	LF Brass
	Copper
Temp/pressure ratings	73 °F (23 °C) at 160 psi (11 bar) 180 °F (82 °C) at 100 psi (6.9 bar) 200 °F (93 °C) at 80 psi (5.5 bar)
Prop 65 label required?	Yes

Informations sur le produit et utilisation de l'application

Uponor ProPEX® lead-free (LF) copper stub ells provide a 90-degree transition from Uponor AquaPEX® tubing to copper. 1 Copper stub ells are comprised of 1/2", 3/4" or 1" type L copper pipe with an Uponor ProPEX fitting on one end and the other end spun closed.

Note: Temperature and pressure ratings stated are hydrostatic ratings. For domestic hot-water (DHW) and DHW recirculation installations, operating conditions should not exceed 140°F (60°C) at 80 psi (5.5 bar) in accordance with ASTM F2023. For additional information regarding application-specific temperature and pressure ratings, refer to the Uponor PEX Piping Systems Design and Installation Manual.

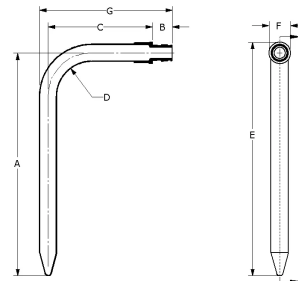

Nom de la pièce	Numéro de pièce	A [inch]	B [inch]	C [inch]	D [inch]	E [inch]	F [inch]	G [inch]	End Type 1	Weight per UOM [lbs/UOM]
ProPEX LF Copper Stub Ell, 1/2" PEX LF Brass x 1/2" Copper (3 1/2" x 8")	LF2865050	7.987	0.709	3.749	3.084	8.372	0.77	4.77	ProPEX 1/2"	0.2
ProPEX LF Copper Stub Ell, 1/2" PEX LF Brass x 1/2" Copper (13" x 8")	LF2855050	7.987	0.709	12.299	3.084	8.372	0.77	13.32	ProPEX 1/2"	0.5
ProPEX LF Copper Stub Ell, 1/2" PEX LF Brass x 1/2" Copper (8" x 13")	LF2895050	12.985	0.709	7.295	3.04	13.37	0.77	8.316	ProPEX 1/2"	0.48
ProPEX LF Copper Stub Ell, 3/4" PEX LF Brass x 3/4" Copper (4" x 8")	LF2897575	8.002	0.945	4.057	3.959	8.552	1.1	5.44	ProPEX 3/4"	0.5
ProPEX LF Copper Stub Ell, 1" PEX x 1" Copper (13" x 8")	LF2891010	13	1.181	6.507	8	13.68	1.36	8.25	ProPEX 1"	1.7

Nom de la pièce	Numéro de pièce	Les codes	Normes	Annonces
Coudes au quart pour bain ProPEX en cuivre sans plomb (LF)	All	UPC IBC IRC IPC NPC of Canada UMC NSPC IMC	NSF/ANSI/CAN 372 ASTM F877 ASTM F1960 CSA B137.5 NSF/ANSI/CAN 61 NSF/ANSI 14	IAPMO-ES HUD MR 1269

In addition, the following parts have additional codes, standards, or listings:

ProPEX LF Copper Stub Ell, 1/2" PEX LF Brass x 1/2" Copper (3 1/2" x 8")	LF2865050
ProPEX LF Copper Stub Ell, 1/2" PEX LF Brass x 1/2" Copper (8" x 13")	LF2895050
ProPEX LF Copper Stub Ell, 3/4" PEX LF Brass x 3/4" Copper (4" x 8")	LF2897575
ProPEX LF Copper Stub Ell, 1" PEX x 1" Copper (13" x 8")	LF2891010

L'installation

Refer to the Uponor AquaPEX Professional Plumbing Installation Guide for additional information

Applications connexes

PEX-a Plumbing Systems

Notes de bas de page

Coordonnées de la personne-ressource

-	Uponor Inc. 5925 148th Street West Apple Valley, MN 55124 T 800.321.4739 F 952.891.2008	Uponor Ltd. 6510 Kennedy Road Mississauga, ON L5T 2X4 T 888.594.7726 F 800.638.9517
---	---	---