

# Supports de cintrage en métal

## Renseignements sur le projet

Nom du poste :

Lieu :

Ingénieur :

Date de soumission:

Entrepreneur :

Présentée par:

Représentant du fabricant :

Approuvé par :

## Données techniques

Material Metal

## Informations sur le produit et utilisation de l'application

Snap the tubing into the Metal Bend Support at the beginning of the bend. Continue the bend through the support and snap the tubing into the support at the end of the bend. Refer to the Uponor AquaPEX® Professional Plumbing Installation Guide or the Uponor Radiant Floor Heating Installation Handbook for additional information.

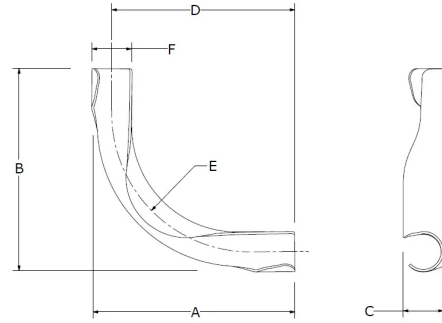

Nom de la pièce	Numéro de pièce	A [Inch]	B [Inch]	C [Inch]	D [Inch]	E [Inch]	F [Inch]	Subcomponent Material	Weight per UOM [lbs/UOM]
3/8" Metal Bend Support	A5110375	3.176	3.176	0.63	2.857	1.811	0.64	SPHC steel	0.04
1/2" Metal Bend Support	A5110500	3.583	3.583	0.807	3.169	2.352	0.827	-	0.1
5/8" Metal Bend Support	A5110625	4.98	4.98	0.984	4.488	3.079	1.033	-	0.16
3/4" Metal Bend Support	A5110750	6.43	6.43	1.181	5.827	5.276	1.177	-	0.32

## L'installation

Snap the tubing into the Metal Bend Support at the beginning of the bend. Continue the bend through the support and snap the tubing into the support at the end of the bend. Refer to the Uponor AquaPEX® Professional Plumbing Installation Guide or the Uponor Radiant Floor Heating Installation Handbook for additional information.

## Applications connexes

PEX-a Plumbing Systems  
 Radiant Heating and Cooling Systems  
 AquaSAFE™ Fire Safety Systems  
 AquaSAFE™ Fire Safety Systems

## Notes de bas de page

## Coordonnées de la personne-ressource

Uponor Inc.  
 5925 148th Street West  
 Apple Valley, MN 55124  
 T 800.321.4739  
 F 952.891.2008

Uponor Ltd.  
 6510 Kennedy Road  
 Mississauga, ON L5T 2X4  
 T 888.594.7726  
 F 800.638.9517