

# Abrazaderas de sujeción de PP-RCT de Uponor (fusión de toma y salida)



## Project Information

|                                |                 |
|--------------------------------|-----------------|
| Job name:                      | Location:       |
| Engineer:                      | Fecha de envío: |
| Contractor:                    | Presentada por: |
| Manufacturer's representative: | Approved by:    |

## Technical data

|                       |   |
|-----------------------|---|
| Material              | PP-RCT  |
| Temp/pressure ratings | 73 °F (23 °C) at 340 psi (23.44 bar)<br>140 °F (60 °C) at 190 psi (13.1 bar)<br>180 °F (82 °C) at 100 psi (6.9 bar) |

## Product Information and application use

Utilice los monturas de fusión de enchufes y salidas PP-RCT de Uponor con tubería mecánica PP-RCT de Uponor para transportar fluidos para calefacción y refrigeración hidráulicas o aplicaciones industriales y con tubería potable PP-RCT de Uponor para transportar agua para aplicaciones de plomería potable.

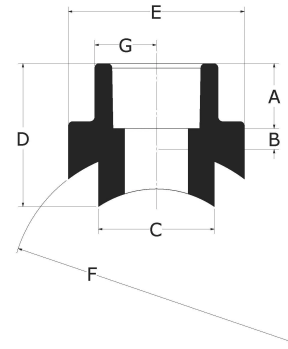

| Part name  | Part no.   | A [inch] | B [inch] | C [inch] | D [inch] | E [inch] | F [inch] | G [inch] | Equivalent length through [ft] | End Type 1    | End Type 2    |
|--|------------|----------|----------|----------|----------|----------|----------|----------|--------------------------------|---------------|---------------|
| Uponor PP-RCT Saddle, 10" x 1", for Outlet Fusion      | PR47810010 | 0.748    | 0.276    | 1.264    | 1.979    | 1.535    | 9.874    | 0.768    | 1                              | Saddle 10"    | Socket 1"     |
| Uponor PP-RCT Saddle, 10" x 2 1/2", for Outlet Fusion  | PR47810025 | 1.26     | 0.394    | 2.961    | 3.074    | 3.63     | 9.874    | 1.815    | 2.5                            | Saddle 10"    | Socket 2-1/2" |
| Uponor PP-RCT Saddle, 10" x 3", for Outlet Fusion      | PR47810030 | 1.378    | 0.433    | 3.559    | 3.374    | 4.354    | 9.874    | 2.177    | 3                              | Saddle 10"    | Socket 3"     |
| Uponor PP-RCT Saddle, 10" x 4", for Outlet Fusion      | PR47810040 | 1.732    | 0.512    | 4.929    | 4.269    | 6.043    | 9.874    | 3.022    | 5                              | Saddle 10"    | Socket 4"     |
| Uponor PP-RCT Saddle, 12" x 2", for Outlet Fusion      | PR47812020 | 1.122    | 0.354    | 2.488    | 3.054    | 3.039    | 12.433   | 1.52     | 2.1                            | Saddle 12"    | Socket 2"     |
| Uponor PP-RCT Saddle, 12" x 2 1/2", for Outlet Fusion  | PR47812025 | 1.26     | 0.394    | 2.961    | 3.301    | 3.63     | 12.433   | 1.815    | 2.5                            | Saddle 12"    | Socket 2-1/2" |
| Uponor PP-RCT Saddle, 12" x 3", for Outlet Fusion      | PR47812030 | 1.378    | 0.433    | 3.559    | 3.566    | 4.354    | 12.433   | 2.177    | 3                              | Saddle 12"    | Socket 3"     |
| Uponor PP-RCT Saddle, 12" x 4", for Outlet Fusion      | PR47812040 | 1.732    | 0.512    | 4.929    | 4.338    | 6.043    | 12.433   | 3.022    | 5                              | Saddle 12"    | Socket 4"     |
| Uponor PP-RCT Saddle, 1 1/4" x 1/2", for Outlet Fusion | PR4781350  | 0.571    | 0.157    | 0.984    | 1.27     | 1.496    | 1.575    | 0.524    | 0.6                            | Saddle 1-1/4" | Socket 1/2"   |
| Uponor PP-RCT Saddle, 1 1/4" x 3/4", for Outlet Fusion | PR4781375  | 0.63     | 0.169    | 0.984    | 1.341    | 1.496    | 1.575    | 0.644    | 0.8                            | Saddle 1-1/4" | Socket 1/2"   |
| Uponor PP-RCT Saddle, 1 1/2" x 1/2", for Outlet Fusion | PR4781550  | 0.571    | 0.157    | 0.984    | 1.128    | 1.496    | 1.969    | 0.524    | 0.6                            | Saddle 1-1/2" | Socket 1/2"   |
| Uponor PP-RCT Saddle, 1 1/2" x 3/4", for Outlet Fusion | PR4781575  | 0.63     | 0.169    | 0.984    | 1.199    | 1.496    | 1.969    | 0.644    | 0.8                            | Saddle 1-1/2" | Socket 3/4"   |
| Uponor PP-RCT Saddle, 2" x 1", for Outlet Fusion       | PR4782010  | 0.713    | 0.24     | 1.26     | 1.548    | 1.65     | 2.48     | 0.825    | 1                              | Saddle 2"     | Socket 1"     |
| Uponor PP-RCT Saddle, 2" x 1/2", for Outlet Fusion     | PR4782050  | 0.571    | 0.157    | 0.984    | 1.213    | 1.496    | 2.48     | 0.524    | 0.6                            | Saddle 2"     | Socket 1/2"   |
| Uponor PP-RCT Saddle, 2" x 3/4", for Outlet Fusion     | PR4782075  | 0.63     | 0.165    | 0.984    | 1.28     | 1.496    | 2.48     | 0.644    | 0.8                            | Saddle 2"     | Socket 3/4"   |
| Uponor PP-RCT Saddle, 2 1/2" x 1", for Outlet Fusion   | PR4782510  | 0.713    | 0.24     | 1.26     | 1.563    | 1.65     | 2.953    | 0.825    | 1                              | Saddle 2-1/2" | Socket 1"     |
| Uponor PP-RCT Saddle, 2 1/2" x 1/2", for Outlet Fusion | PR4782550  | 0.571    | 0.157    | 0.984    | 1.254    | 1.496    | 2.953    | 0.524    | 0.6                            | Saddle 2-1/2" | Socket 1/2"   |
| Uponor PP-RCT Saddle, 2 1/2" x 3/4", for Outlet Fusion | PR4782575  | 0.63     | 0.169    | 0.984    | 1.324    | 1.496    | 2.953    | 0.644    | 0.8                            | Saddle 2-1/2" | Socket 3/4"   |
| Uponor PP-RCT Saddle, 3" x 1", for Outlet Fusion       | PR4783010  | 0.713    | 0.24     | 1.26     | 1.602    | 1.65     | 3.543    | 0.825    | 1                              | Saddle 3"     | Socket 1"     |

|  |            |       |       |       |       |       |       |       |     |               |               |
|--|------------|-------|-------|-------|-------|-------|-------|-------|-----|---------------|---------------|
| Uponor PP-RCT Saddle, 3" x 1/2", for Outlet Fusion       | PR4783050  | 0.571 | 0.157 | 0.984 | 1.31  | 1.496 | 3.543 | 0.524 | 0.6 | Saddle 3"     | Socket 1/2"   |
| Uponor PP-RCT Saddle, 3" x 3/4", for Outlet Fusion       | PR4783075  | 0.63  | 0.165 | 0.984 | 1.377 | 1.496 | 3.543 | 0.644 | 0.8 | Saddle 3"     | Socket 3/4"   |
| Uponor PP-RCT Saddle, 4" x 1", for Outlet Fusion         | PR4784010  | 0.713 | 0.24  | 1.26  | 1.741 | 1.65  | 4.921 | 0.825 | 1   | Saddle 4"     | Socket 1"     |
| Uponor PP-RCT Saddle, 4" x 1 1/4", for Outlet Fusion     | PR4784013  | 0.807 | 0.264 | 1.575 | 1.927 | 2.047 | 4.921 | 1.024 | 1.3 | Saddle 4"     | Socket 1-1/4" |
| Uponor PP-RCT Saddle, 4" x 1 1/2", for Outlet Fusion     | PR4784015  | 0.925 | 0.335 | 1.969 | 2.228 | 2.594 | 4.921 | 1.297 | 1.7 | Saddle 4"     | Socket 1-1/2" |
| Uponor PP-RCT Saddle, 4" x 2", for Outlet Fusion         | PR4784020  | 1.079 | 0.413 | 2.48  | 2.666 | 3.264 | 4.921 | 1.632 | 2.1 | Saddle 4"     | Socket 2"     |
| Uponor PP-RCT Saddle, 4" x 1/2", for Outlet Fusion       | PR4784050  | 0.571 | 0.157 | 0.984 | 1.47  | 1.496 | 4.921 | 0.524 | 0.6 | Saddle 4"     | Socket 1/2"   |
| Uponor PP-RCT Saddle, 4" x 3/4", for Outlet Fusion       | PR4784075  | 0.63  | 0.165 | 0.984 | 1.537 | 1.496 | 4.921 | 0.644 | 0.8 | Saddle 4"     | Socket 3/4"   |
| Uponor PP-RCT Saddle, 6" x 1", for Outlet Fusion         | PR4786010  | 0.713 | 0.24  | 1.26  | 1.74  | 1.65  | 6.299 | 0.825 | 1   | Saddle 6"     | Socket 1"     |
| Uponor PP-RCT Saddle, 6" x 1 1/4", for Outlet Fusion     | PR4786013  | 0.807 | 0.264 | 1.575 | 1.906 | 2.047 | 6.299 | 1.024 | 1.3 | Saddle 6"     | Socket 1-1/4" |
| Uponor PP-RCT Saddle, 6" x 1 1/2", for Outlet Fusion     | PR4786015  | 0.925 | 0.335 | 1.969 | 2.171 | 2.594 | 6.299 | 1.297 | 1.7 | Saddle 6"     | Socket 1-1/2" |
| Uponor PP-RCT Saddle, 6" x 2", for Outlet Fusion         | PR4786020  | 1.079 | 0.413 | 2.48  | 2.535 | 3.264 | 6.299 | 1.632 | 2.1 | Saddle 6"     | Socket 2"     |
| Uponor PP-RCT Saddle, 6" x 2 1/2", for Outlet Fusion     | PR4786025  | 1.181 | 0.492 | 2.953 | 2.874 | 3.909 | 6.299 | 1.955 | 2.5 | Saddle 6"     | Socket 2-1/2" |
| Uponor PP-RCT Saddle, 8" x 1", for Outlet Fusion         | PR4788010  | 0.748 | 0.276 | 1.264 | 1.995 | 1.535 | 7.898 | 0.768 | 1   | Saddle 8"     | Socket 1"     |
| Uponor PP-RCT Saddle, 8" x 1 1/2", for Outlet Fusion     | PR4788015  | 0.984 | 0.315 | 1.976 | 2.37  | 2.409 | 7.898 | 1.205 | 1.7 | Saddle 8"     | Socket 1-1/2" |
| Uponor PP-RCT Saddle, 8" x 2", for Outlet Fusion         | PR4788020  | 1.122 | 0.354 | 2.488 | 2.648 | 3.039 | 7.898 | 1.52  | 2.1 | Saddle 8"     | Socket 2"     |
| Uponor PP-RCT Saddle, 8" x 2 1/2", for Outlet Fusion     | PR4788025  | 1.26  | 0.394 | 2.961 | 2.943 | 3.63  | 7.898 | 1.815 | 2.5 | Saddle 8"     | Socket 2-1/2" |
| Uponor PP-RCT Saddle, 8" x 3", for Outlet Fusion         | PR4788030  | 1.378 | 0.433 | 3.559 | 3.291 | 4.354 | 7.898 | 2.177 | 3   | Saddle 8"     | Socket 3"     |
| Uponor PP-RCT Saddle, 8" x 4", for Outlet Fusion         | PR4788040  | 1.732 | 0.512 | 4.929 | 4.407 | 6.043 | 7.898 | 3.022 | 5   | Saddle 8"     | Socket 4"     |
| Uponor PP-RCT Saddle, 6" x 3", for Outlet Fusion         | PR4786030  | 1.181 | 0.591 | 3.543 | 3.237 | 4.697 | 6.299 | 2.348 | 3   | Saddle 6"     | Socket 3"     |
| Uponor PP-RCT Saddle, 10" x 2", for Outlet Fusion        | PR47810020 | 1.122 | 0.354 | 2.488 | 2.807 | 3.039 | 9.874 | 1.52  | 2.1 | Saddle 10"    | Socket 2"     |
| Uponor PP-RCT Saddle, 10" x 1 1/4", for Outlet Fusion    | PR47810013 | 0.807 | 0.315 | 1.575 | 2.339 | 2.047 | 9.877 | 1.024 | 1.3 | Saddle 10"    | Socket 1-1/4" |
| Uponor PP-RCT Saddle, 10" x 1 1/2", for Outlet Fusion    | PR47810015 | 0.925 | 0.197 | 1.969 | 2.393 | 2.594 | 9.875 | 1.297 | 1.7 | Saddle 10"    | Socket 1-1/2" |
| Uponor PP-RCT Saddle, 10" x 1/2", for Outlet Fusion      | PR47810050 | 0.61  | 0.197 | 0.787 | 1.952 | 1.087 | 9.882 | 0.543 | 0.6 | Saddle 10"    | Socket 1/2"   |
| Uponor PP-RCT Saddle, 10" x 3/4", for Outlet Fusion      | PR47810075 | 0.709 | 0.236 | 0.996 | 2.1   | 1.354 | 9.875 | 0.677 | 0.8 | Saddle 10"    | Socket 3/4"   |
| Uponor PP-RCT Saddle, 2 1/2" x 1 1/4", for Outlet Fusion | PR4782513  | 0.807 | 0.264 | 1.575 | 1.715 | 2.047 | 2.953 | 1.024 | 1.3 | Saddle 2-1/2" | Socket 1-1/4" |
| Uponor PP-RCT Saddle, 3" x 1 1/4", for Outlet Fusion     | PR4783013  | 0.807 | 0.264 | 1.575 | 1.716 | 2.047 | 3.544 | 1.024 | 1.3 | Saddle 3"     | Socket 1-1/4" |
| Uponor PP-RCT Saddle, 6" x 1/2", for Outlet Fusion       | PR4786050  | 0.571 | 0.157 | 0.984 | 1.483 | 1.496 | 6.304 | 0.524 | 0.6 | Saddle 6"     | Socket 1/2"   |
| Uponor PP-RCT Saddle, 6" x 3/4", for Outlet Fusion       | PR4786075  | 0.63  | 0.165 | 0.984 | 1.55  | 1.496 | 6.304 | 0.644 | 0.8 | Saddle 6"     | Socket 3/4"   |
| Uponor PP-RCT Saddle, 8" x 1 1/4", for Outlet Fusion     | PR4788013  | 0.807 | 0.315 | 1.575 | 2.107 | 2.047 | 7.899 | 1.024 | 1.3 | Saddle 8"     | Socket 1-1/4" |
| Uponor PP-RCT Saddle, 8" x 1/2", for Outlet Fusion       | PR4788050  | 0.571 | 0.197 | 0.787 | 1.699 | 1.046 | 7.904 | 0.523 | 0.6 | Saddle 8"     | Socket 1/2"   |
| Uponor PP-RCT Saddle, 8" x 3/4", for Outlet Fusion       | PR4788075  | 0.63  | 0.236 | 0.984 | 1.788 | 1.287 | 7.906 | 0.644 | 0.8 | Saddle 8"     | Socket 3/4"   |

| Part name   | Part no.   | Weight per UOM [lbs/UOM] |
|---|------------|--------------------------|
| Uponor PP-RCT Saddle, 10" x 1", for Outlet Fusion     | PR47810010 | 0.06                     |
| Uponor PP-RCT Saddle, 10" x 2 1/2", for Outlet Fusion | PR47810025 | 0.67                     |

|  |            |      |
|--|------------|------|
| Uponor PP-RCT Saddle, 10" x 3", for Outlet Fusion        | PR47810030 | 0.87 |
| Uponor PP-RCT Saddle, 10" x 4", for Outlet Fusion        | PR47810040 | 2.12 |
| Uponor PP-RCT Saddle, 12" x 2", for Outlet Fusion        | PR47812020 | 0.25 |
| Uponor PP-RCT Saddle, 12" x 2 1/2", for Outlet Fusion    | PR47812025 | 0.69 |
| Uponor PP-RCT Saddle, 12" x 3", for Outlet Fusion        | PR47812030 | 0.89 |
| Uponor PP-RCT Saddle, 12" x 4", for Outlet Fusion        | PR47812040 | 2.11 |
| Uponor PP-RCT Saddle, 1 1/4" x 1/2", for Outlet Fusion   | PR4781350  | 0.03 |
| Uponor PP-RCT Saddle, 1 1/4" x 3/4", for Outlet Fusion   | PR4781375  | 0.03 |
| Uponor PP-RCT Saddle, 1 1/2" x 1/2", for Outlet Fusion   | PR4781550  | 0.03 |
| Uponor PP-RCT Saddle, 1 1/2" x 3/4", for Outlet Fusion   | PR4781575  | 0.03 |
| Uponor PP-RCT Saddle, 2" x 1", for Outlet Fusion         | PR4782010  | 0.05 |
| Uponor PP-RCT Saddle, 2" x 1/2", for Outlet Fusion       | PR4782050  | 0.03 |
| Uponor PP-RCT Saddle, 2" x 3/4", for Outlet Fusion       | PR4782075  | 0.03 |
| Uponor PP-RCT Saddle, 2 1/2" x 1", for Outlet Fusion     | PR4782510  | 0.05 |
| Uponor PP-RCT Saddle, 2 1/2" x 1/2", for Outlet Fusion   | PR4782550  | 0.03 |
| Uponor PP-RCT Saddle, 2 1/2" x 3/4", for Outlet Fusion   | PR4782575  | 0.03 |
| Uponor PP-RCT Saddle, 3" x 1", for Outlet Fusion         | PR4783010  | 0.05 |
| Uponor PP-RCT Saddle, 3" x 1/2", for Outlet Fusion       | PR4783050  | 0.03 |
| Uponor PP-RCT Saddle, 3" x 3/4", for Outlet Fusion       | PR4783075  | 0.03 |
| Uponor PP-RCT Saddle, 4" x 1", for Outlet Fusion         | PR4784010  | 0.05 |
| Uponor PP-RCT Saddle, 4" x 1 1/4", for Outlet Fusion     | PR4784013  | 0.09 |
| Uponor PP-RCT Saddle, 4" x 1 1/2", for Outlet Fusion     | PR4784015  | 0.18 |
| Uponor PP-RCT Saddle, 4" x 2", for Outlet Fusion         | PR4784020  | 0.33 |
| Uponor PP-RCT Saddle, 4" x 1/2", for Outlet Fusion       | PR4784050  | 0.03 |
| Uponor PP-RCT Saddle, 4" x 3/4", for Outlet Fusion       | PR4784075  | 0.03 |
| Uponor PP-RCT Saddle, 6" x 1", for Outlet Fusion         | PR4786010  | 0.05 |
| Uponor PP-RCT Saddle, 6" x 1 1/4", for Outlet Fusion     | PR4786013  | 0.08 |
| Uponor PP-RCT Saddle, 6" x 1 1/2", for Outlet Fusion     | PR4786015  | 0.16 |
| Uponor PP-RCT Saddle, 6" x 2", for Outlet Fusion         | PR4786020  | 0.3  |
| Uponor PP-RCT Saddle, 6" x 2 1/2", for Outlet Fusion     | PR4786025  | 0.49 |
| Uponor PP-RCT Saddle, 8" x 1", for Outlet Fusion         | PR4788010  | 0.06 |
| Uponor PP-RCT Saddle, 8" x 1 1/2", for Outlet Fusion     | PR4788015  | 0.2  |
| Uponor PP-RCT Saddle, 8" x 2", for Outlet Fusion         | PR4788020  | 0.22 |
| Uponor PP-RCT Saddle, 8" x 2 1/2", for Outlet Fusion     | PR4788025  | 0.68 |
| Uponor PP-RCT Saddle, 8" x 3", for Outlet Fusion         | PR4788030  | 0.88 |
| Uponor PP-RCT Saddle, 8" x 4", for Outlet Fusion         | PR4788040  | 2.18 |
| Uponor PP-RCT Saddle, 6" x 3", for Outlet Fusion         | PR4786030  | 0.75 |
| Uponor PP-RCT Saddle, 10" x 2", for Outlet Fusion        | PR47810020 | 0.23 |
| Uponor PP-RCT Saddle, 10" x 1 1/4", for Outlet Fusion    | PR47810013 | 0.11 |
| Uponor PP-RCT Saddle, 10" x 1 1/2", for Outlet Fusion    | PR47810015 | 0.2  |
| Uponor PP-RCT Saddle, 10" x 1/2", for Outlet Fusion      | PR47810050 | 0.02 |
| Uponor PP-RCT Saddle, 10" x 3/4", for Outlet Fusion      | PR47810075 | 0.03 |
| Uponor PP-RCT Saddle, 2 1/2" x 1 1/4", for Outlet Fusion | PR4782513  | 0.09 |
| Uponor PP-RCT Saddle, 3" x 1 1/4", for Outlet Fusion     | PR4783013  | 0.09 |
| Uponor PP-RCT Saddle, 6" x 1/2", for Outlet Fusion       | PR4786050  | 0.03 |
| Uponor PP-RCT Saddle, 6" x 3/4", for Outlet Fusion       | PR4786075  | 0.03 |
| Uponor PP-RCT Saddle, 8" x 1 1/4", for Outlet Fusion     | PR4788013  | 0.11 |

Uponor PP-RCT Saddle, 8" x 1/2", for Outlet Fusion

PR4788050

0.02

Uponor PP-RCT Saddle, 8" x 3/4", for Outlet Fusion

PR4788075

0.03

| Part name   | Part no.   | Codes       | Standards                                   | Listings  |
|---|------------|-------------|---|---|
| Abrazaderas de sujeción de PP-RCT de Uponor (fusión de toma y salida)           | All        | CMC IMC UMC | ASTM E84 NSF/ANSI 14 ASTM F2389 CSA B137.11 | ICC-ES-PMG 1106 IAPMO-R&T 8358 QAI P321-5 IAPMO K-12775 |
| In addition, the following parts have additional codes, standards, or listings: |            |             |   |   |
| Uponor PP-RCT Saddle, 10" x 1 1/4", for Outlet Fusion                           | PR47810013 |             | NSF/ANSI/CAN 61                             |   |
| Uponor PP-RCT Saddle, 10" x 1 1/2", for Outlet Fusion                           | PR47810015 |             | NSF/ANSI/CAN 61                             |   |
| Uponor PP-RCT Saddle, 10" x 1/2", for Outlet Fusion                             | PR47810050 |             | NSF/ANSI/CAN 61                             |   |
| Uponor PP-RCT Saddle, 10" x 3/4", for Outlet Fusion                             | PR47810075 |             | NSF/ANSI/CAN 61                             |   |
| Uponor PP-RCT Saddle, 2 1/2" x 1 1/4", for Outlet Fusion                        | PR4782513  |             | NSF/ANSI/CAN 61                             |   |
| Uponor PP-RCT Saddle, 3" x 1 1/4", for Outlet Fusion                            | PR4783013  |             | NSF/ANSI/CAN 61                             |   |
| Uponor PP-RCT Saddle, 6" x 1/2", for Outlet Fusion                              | PR4786050  |             | NSF/ANSI/CAN 61                             |   |
| Uponor PP-RCT Saddle, 6" x 3/4", for Outlet Fusion                              | PR4786075  |             | NSF/ANSI/CAN 61                             |   |
| Uponor PP-RCT Saddle, 8" x 1 1/4", for Outlet Fusion                            | PR4788013  |             | NSF/ANSI/CAN 61                             |   |
| Uponor PP-RCT Saddle, 8" x 1/2", for Outlet Fusion                              | PR4788050  |             | NSF/ANSI/CAN 61                             |   |
| Uponor PP-RCT Saddle, 8" x 3/4", for Outlet Fusion                              | PR4788075  |             | NSF/ANSI/CAN 61                             |   |

| Installation   | Related applications  |
|--|---|
| Utilice métodos de conexión de fusión de socket aprobados. Consulte el manual de PP-RCT de Uponor para obtener todos los detalles. | Sistemas hidrónicos de calefacción y refrigeración<br>Industrial<br>Sistemas de agua domésticos |

| Footnotes   | Contact information  |   |   |
|---|--|---|---|
| -   | <table border="0"> <tr> <td>Uponor Inc.<br/>5925 148th Street West<br/>Apple Valley, MN 55124<br/>T 800.321.4739<br/>F 952.891.2008</td> <td>Uponor Ltd.<br/>6510 Kennedy Road<br/>Mississauga, ON L5T 2X4<br/>T 888.594.7726<br/>F 800.638.9517</td> </tr> </table> | Uponor Inc.<br>5925 148th Street West<br>Apple Valley, MN 55124<br>T 800.321.4739<br>F 952.891.2008 | Uponor Ltd.<br>6510 Kennedy Road<br>Mississauga, ON L5T 2X4<br>T 888.594.7726<br>F 800.638.9517 |
| Uponor Inc.<br>5925 148th Street West<br>Apple Valley, MN 55124<br>T 800.321.4739<br>F 952.891.2008 | Uponor Ltd.<br>6510 Kennedy Road<br>Mississauga, ON L5T 2X4<br>T 888.594.7726<br>F 800.638.9517  |   |   |