

Conectores reductores de PP-RCT de Uponor (fusión de toma)



Project Information

| | |
|--------------------------------|-----------------|
| Job name: | Location: |
| Engineer: | Fecha de envío: |
| Contractor: | Presentada por: |
| Manufacturer's representative: | Approved by: |

Technical data

Material PP-RCT

Product information and application use

Utilice los reductores de conexión por fusión de zócalo PP-RCT de Uponor con tubería mecánica PP-RCT de Uponor para transportar fluidos para calefacción y refrigeración hidrónica o aplicaciones industriales y con tubería potable PP-RCT de Uponor para transportar agua para aplicaciones de plomería potable.

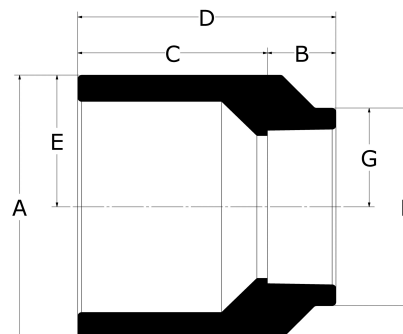

| Part name | Part no. | A [inch] | B [inch] | C [inch] | D [inch] | E [inch] | F [inch] | G [inch] | Equivalent length through [ft] | End Type 1 | End Type 2 |
|--|-------------|----------|----------|----------|----------|----------|----------|----------|--------------------------------|---------------|---------------|
| Uponor PP-RCT Fitting Reducer, 4" x 2 1/2", SDR 11 | PR114774025 | 4.921 | 1.299 | 1.339 | 2.638 | 2.461 | 3.976 | 1.988 | 8.4 | Butt 4" | Socket 2-1/2" |
| Uponor PP-RCT Fitting Reducer, 4" x 2 1/2", SDR 17.6 | PR174774025 | 4.921 | 1.299 | 1.339 | 2.638 | 2.461 | 3.976 | 1.988 | 8.4 | Butt 4" | Socket 2-1/2" |
| Uponor PP-RCT Fitting Reducer, 4" x 3", SDR 17.6 | PR174774030 | 4.921 | 1.299 | 1.339 | 2.638 | 2.461 | 3.976 | 1.988 | 6.7 | Butt 4" | Socket 3" |
| Uponor PP-RCT Fitting Reducer, 1" x 1/2 | PR4771050 | 1.272 | 0.693 | 0.933 | 1.626 | 0.636 | 1.339 | 0.669 | 1.4 | Socket 1" | Socket 1/2" |
| Uponor PP-RCT Fitting Reducer, 1 1/4" x 1 | PR4771310 | 1.575 | 0.752 | 1.126 | 1.878 | 0.787 | 1.732 | 0.866 | 1.7 | Socket 1-1/4" | Socket 1" |
| Uponor PP-RCT Fitting Reducer, 1 1/4" x 1/2 | PR4771350 | 1.575 | 0.571 | 0.931 | 1.502 | 0.787 | 1.047 | 0.524 | 1.7 | Socket 1-1/4" | Socket 1/2" |
| Uponor PP-RCT Fitting Reducer, 1 1/4" x 3/4 | PR4771375 | 1.575 | 0.63 | 0.886 | 1.516 | 0.787 | 1.287 | 0.644 | 1.7 | Socket 1-1/4" | Socket 3/4" |
| Uponor PP-RCT Fitting Reducer, 1 1/2" x 1 | PR4771510 | 1.969 | 0.713 | 0.868 | 1.58 | 0.984 | 1.65 | 0.825 | 2.2 | Socket 1-1/2" | Socket 1" |
| Uponor PP-RCT Fitting Reducer, 1 1/2" x 1 1/4 | PR4771513 | 1.969 | 0.846 | 1.004 | 1.85 | 0.984 | 2.185 | 1.093 | 2.2 | Socket 1-1/2" | Socket 1-1/4" |
| Uponor PP-RCT Fitting Reducer, 1 1/2" x 1/2 | PR4771550 | 1.969 | 0.571 | 0.813 | 1.384 | 0.984 | 1.024 | 0.512 | 2.2 | Socket 1-1/2" | Socket 1/2" |
| Uponor PP-RCT Fitting Reducer, 2" x 1 | PR4772010 | 2.48 | 0.728 | 1.713 | 2.441 | 1.24 | 1.705 | 0.852 | 2.8 | Socket 2" | Socket 1" |
| Uponor PP-RCT Fitting Reducer, 2" x 1 1/4 | PR4772013 | 2.48 | 0.827 | 1.732 | 2.559 | 1.24 | 2.067 | 1.033 | 2.8 | Socket 2" | Socket 1-1/4" |
| Uponor PP-RCT Fitting Reducer, 2" x 1 1/2 | PR4772015 | 2.48 | 0.945 | 1.232 | 2.177 | 1.24 | 2.717 | 1.358 | 2.8 | Socket 2" | Socket 1-1/2" |
| Uponor PP-RCT Fitting Reducer, 2" x 3/4 | PR4772075 | 2.48 | 0.65 | 1.909 | 2.559 | 1.24 | 1.358 | 0.679 | 4.9 | Socket 2" | Socket 3/4" |
| Uponor PP-RCT Fitting Reducer, 2 1/2" x 1 | PR4772510 | 2.953 | 0.713 | 1.215 | 1.927 | 1.476 | 1.65 | 0.825 | 4.1 | Socket 2-1/2" | Socket 1" |
| Uponor PP-RCT Fitting Reducer, 2 1/2" x 1 1/4 | PR4772513 | 2.953 | 0.807 | 1.135 | 1.942 | 1.476 | 2.047 | 1.024 | 4.1 | Socket 2-1/2" | Socket 1-1/4" |
| Uponor PP-RCT Fitting Reducer, 2 1/2" x 1 1/2 | PR4772515 | 2.953 | 0.925 | 1.033 | 1.958 | 1.476 | 2.594 | 1.297 | 3.3 | Socket 2-1/2" | Socket 1-1/2" |
| Uponor PP-RCT Fitting Reducer, 2 1/2" x 2" | PR4772520 | 2.953 | 1.079 | 1.539 | 2.618 | 1.476 | 3.425 | 1.713 | 3.3 | Socket 2-1/2" | Socket 2" |
| Uponor PP-RCT Fitting Reducer, 2 1/2" x 1/2 | PR4772550 | 2.953 | 0.571 | 1.202 | 1.772 | 1.476 | 1.024 | 0.512 | 4.1 | Socket 2-1/2" | Socket 1/2" |

| | | | | | | | | | | | |
|---|-------------|-------|-------|-------|-------|-------|-------|-------|-----|---------------|---------------|
| Uponor PP-RCT Fitting Reducer, 2 1/2" x 3/4 | PR4772575 | 2.953 | 0.63 | 1.305 | 1.935 | 1.476 | 1.287 | 0.644 | 4.1 | Socket 2-1/2" | Socket 3/4" |
| Uponor PP-RCT Fitting Reducer, 3" x 1 1/2 | PR4773015 | 3.543 | 0.925 | 1.207 | 2.133 | 1.772 | 2.594 | 1.297 | 4.9 | Socket 3" | Socket 1-1/2" |
| Uponor PP-RCT Fitting Reducer, 3" x 2 | PR4773020 | 3.543 | 1.079 | 1.091 | 2.17 | 1.772 | 3.264 | 1.632 | 3.9 | Socket 3" | Socket 2" |
| Uponor PP-RCT Fitting Reducer, 3" x 2 1/2 | PR4773025 | 3.559 | 1.22 | 1.811 | 3.031 | 1.78 | 4.13 | 2.065 | 3.9 | Socket 3" | Socket 2-1/2" |
| Uponor PP-RCT Fitting Reducer, 3/4" x 1/2 | PR4777550 | 0.984 | 0.571 | 0.61 | 1.181 | 0.492 | 1.024 | 0.512 | 1.1 | Socket 3/4" | Socket 1/2" |
| Uponor PP-RCT Fitting Reducer, 1" x 3/4 | PR4771075 | 1.272 | 0.685 | 0.941 | 1.626 | 0.636 | 1.339 | 0.669 | 1.4 | Socket 1" | Socket 3/4" |
| Uponor PP-RCT Fitting Reducer, 1 1/2" x 3/4 | PR4771575 | 1.969 | 0.63 | 0.936 | 1.566 | 0.984 | 1.287 | 0.644 | 2.2 | Socket 1-1/2" | Socket 3/4" |
| Uponor PP-RCT Fitting Reducer, 4" x 3", SDR 11 | PR114774030 | 4.921 | 1.299 | 1.339 | 2.638 | 2.461 | 4.213 | 2.106 | 6.7 | Butt 4" | Socket 3" |
| Uponor PP-RCT Fitting Reducer, 4" x 2 1/2", SDR 9 | PR94774025 | 4.921 | 1.181 | 1.371 | 2.552 | 2.461 | 3.909 | 1.955 | 8.4 | Butt 4" | Socket 2-1/2" |
| Uponor PP-RCT Fitting Reducer, 4" x 3", SDR 9 | PR94774030 | 4.921 | 1.299 | 1.457 | 2.756 | 2.461 | 4.697 | 2.348 | 6.7 | Butt 4" | Socket 3" |

| Part name | Part no. | Operating Temperature 1 [°F] | Operating Temperature 2 [°F] | Operating Temperature 3 [°F] | Weight per UOM [lbs/UOM] |
|--|-------------|----------------------------------|-----------------------------------|-----------------------------------|--------------------------|
| Uponor PP-RCT Fitting Reducer, 4" x 2 1/2", SDR 11 | PR114774025 | 73 °F (23 °C) at 215 psi (23 °C) | 140 °F (60 °C) at 120 psi (60 °C) | 180 °F (82 °C) at 80 psi (82 °C) | 0.71 |
| Uponor PP-RCT Fitting Reducer, 4" x 2 1/2", SDR 17.6 | PR174774025 | 73 °F (23 °C) at 130 psi (23 °C) | 140 °F (60 °C) at 70 psi (60 °C) | 180 °F (82 °C) at 50 psi (82 °C) | 0.62 |
| Uponor PP-RCT Fitting Reducer, 4" x 3", SDR 17.6 | PR174774030 | 73 °F (23 °C) at 130 psi (23 °C) | 140 °F (60 °C) at 70 psi (60 °C) | 180 °F (82 °C) at 50 psi (82 °C) | 0.44 |
| Uponor PP-RCT Fitting Reducer, 1" x 1/2 | PR4771050 | 73 °F (23 °C) at 340 psi (23 °C) | 140 °F (60 °C) at 190 psi (60 °C) | 180 °F (82 °C) at 100 psi (82 °C) | 0.05 |
| Uponor PP-RCT Fitting Reducer, 1 1/4" x 1 | PR4771310 | 73 °F (23 °C) at 340 psi (23 °C) | 140 °F (60 °C) at 190 psi (60 °C) | 180 °F (82 °C) at 100 psi (82 °C) | 0.08 |
| Uponor PP-RCT Fitting Reducer, 1 1/4" x 1/2 | PR4771350 | 73 °F (23 °C) at 340 psi (23 °C) | 140 °F (60 °C) at 190 psi (60 °C) | 180 °F (82 °C) at 100 psi (82 °C) | 0.04 |
| Uponor PP-RCT Fitting Reducer, 1 1/4" x 3/4 | PR4771375 | 73 °F (23 °C) at 340 psi (23 °C) | 140 °F (60 °C) at 190 psi (60 °C) | 180 °F (82 °C) at 100 psi (82 °C) | 0.04 |
| Uponor PP-RCT Fitting Reducer, 1 1/2" x 1 | PR4771510 | 73 °F (23 °C) at 340 psi (23 °C) | 140 °F (60 °C) at 190 psi (60 °C) | 180 °F (82 °C) at 100 psi (82 °C) | 0.08 |
| Uponor PP-RCT Fitting Reducer, 1 1/2" x 1 1/4 | PR4771513 | 73 °F (23 °C) at 340 psi (23 °C) | 140 °F (60 °C) at 190 psi (60 °C) | 180 °F (82 °C) at 100 psi (82 °C) | 0.12 |
| Uponor PP-RCT Fitting Reducer, 1 1/2" x 1/2 | PR4771550 | 73 °F (23 °C) at 340 psi (23 °C) | 140 °F (60 °C) at 190 psi (60 °C) | 180 °F (82 °C) at 100 psi (82 °C) | 0.07 |
| Uponor PP-RCT Fitting Reducer, 2" x 1 | PR4772010 | 73 °F (23 °C) at 340 psi (23 °C) | 140 °F (60 °C) at 190 psi (60 °C) | 180 °F (82 °C) at 100 psi (82 °C) | 0.19 |
| Uponor PP-RCT Fitting Reducer, 2" x 1 1/4 | PR4772013 | 73 °F (23 °C) at 340 psi (23 °C) | 140 °F (60 °C) at 190 psi (60 °C) | 180 °F (82 °C) at 100 psi (82 °C) | 0.19 |
| Uponor PP-RCT Fitting Reducer, 2" x 1 1/2 | PR4772015 | 73 °F (23 °C) at 340 psi (23 °C) | 140 °F (60 °C) at 190 psi (60 °C) | 180 °F (82 °C) at 100 psi (82 °C) | 0.22 |
| Uponor PP-RCT Fitting Reducer, 2" x 3/4 | PR4772075 | 73 °F (23 °C) at 340 psi (23 °C) | 140 °F (60 °C) at 190 psi (60 °C) | 180 °F (82 °C) at 100 psi (82 °C) | 0.19 |
| Uponor PP-RCT Fitting Reducer, 2 1/2" x 1 | PR4772510 | 73 °F (23 °C) at 340 psi (23 °C) | 140 °F (60 °C) at 190 psi (60 °C) | 180 °F (82 °C) at 100 psi (82 °C) | 0.22 |
| Uponor PP-RCT Fitting Reducer, 2 1/2" x 1 1/4 | PR4772513 | 73 °F (23 °C) at 340 psi (23 °C) | 140 °F (60 °C) at 190 psi (60 °C) | 180 °F (82 °C) at 100 psi (82 °C) | 0.22 |
| Uponor PP-RCT Fitting Reducer, 2 1/2" x 1 1/2 | PR4772515 | 73 °F (23 °C) at 340 psi (23 °C) | 140 °F (60 °C) at 190 psi (60 °C) | 180 °F (82 °C) at 100 psi (82 °C) | 0.23 |
| Uponor PP-RCT Fitting Reducer, 2 1/2" x 2" | PR4772520 | 73 °F (23 °C) at 340 psi (23 °C) | 140 °F (60 °C) at 190 psi (60 °C) | 180 °F (82 °C) at 100 psi (82 °C) | 0.38 |
| Uponor PP-RCT Fitting Reducer, 2 1/2" x 1/2 | PR4772550 | 73 °F (23 °C) at 340 psi (23 °C) | 140 °F (60 °C) at 190 psi (60 °C) | 180 °F (82 °C) at 100 psi (82 °C) | 0.21 |
| Uponor PP-RCT Fitting Reducer, 2 1/2" x 3/4 | PR4772575 | 73 °F (23 °C) at 340 psi (23 °C) | 140 °F (60 °C) at 190 psi (60 °C) | 180 °F (82 °C) at 100 psi (82 °C) | 0.22 |
| Uponor PP-RCT Fitting Reducer, 3" x 1 1/2 | PR4773015 | 73 °F (23 °C) at 340 psi (23 °C) | 140 °F (60 °C) at 190 psi (60 °C) | 180 °F (82 °C) at 100 psi (82 °C) | 0.35 |
| Uponor PP-RCT Fitting Reducer, 3" x 2 | PR4773020 | 73 °F (23 °C) at 340 psi (23 °C) | 140 °F (60 °C) at 190 psi (60 °C) | 180 °F (82 °C) at 100 psi (82 °C) | 0.36 |
| Uponor PP-RCT Fitting Reducer, 3" x 2 1/2 | PR4773025 | 73 °F (23 °C) at 340 psi (23 °C) | 140 °F (60 °C) at 190 psi (60 °C) | 180 °F (82 °C) at 100 psi (82 °C) | 0.7 |

| | | | | | |
|---|-------------|----------------------------------|-----------------------------------|-----------------------------------|------|
| Uponor PP-RCT Fitting Reducer, 3/4" x 1/2 | PR4777550 | 73 °F (23 °C) at 340 psi (23 °C) | 140 °F (60 °C) at 190 psi (60 °C) | 180 °F (82 °C) at 100 psi (82 °C) | 0.02 |
| Uponor PP-RCT Fitting Reducer, 1" x 3/4 | PR4771075 | 73 °F (23 °C) at 340 psi (23 °C) | 140 °F (60 °C) at 190 psi (60 °C) | 180 °F (82 °C) at 100 psi (82 °C) | 0.04 |
| Uponor PP-RCT Fitting Reducer, 1 1/2" x 3/4 | PR4771575 | 73 °F (23 °C) at 340 psi (23 °C) | 140 °F (60 °C) at 190 psi (60 °C) | 180 °F (82 °C) at 100 psi (82 °C) | 0.08 |
| Uponor PP-RCT Fitting Reducer, 4" x 3", SDR 11 | PR114774030 | 73 °F (23 °C) at 215 psi (23 °C) | 140 °F (60 °C) at 120 psi (60 °C) | 180 °F (82 °C) at 80 psi (82 °C) | 0.58 |
| Uponor PP-RCT Fitting Reducer, 4" x 2 1/2", SDR 9 | PR94774025 | 73 °F (23 °C) at 265 psi (23 °C) | 140 °F (60 °C) at 150 psi (60 °C) | 180 °F (82 °C) at 100 psi (82 °C) | 0.82 |
| Uponor PP-RCT Fitting Reducer, 4" x 3", SDR 9 | PR94774030 | 73 °F (23 °C) at 265 psi (23 °C) | 140 °F (60 °C) at 150 psi (60 °C) | 180 °F (82 °C) at 100 psi (82 °C) | 0.89 |

| Part name | Part no. | Codes | Standards | Listings |
|--|----------|-------------|---|---|
| Conectores reductores de PP-RCT de Uponor (fusión de toma) | All | CMC IMC UMC | NSF/ANSI/CAN 61 ASTM E84 NSF/ANSI 14 ASTM F2389 CSA B137.11 | ICC-ES-PMG 1106 IAPMO-R&T 8358 QAI P321-5 IAPMO K-12775 |

| Installation | Related applications |
|--|--|
| Utilice métodos de conexión de fusión de socket aprobados. Consulte el manual de PP-RCT de Uponor para obtener todos los detalles. | Hydronic heating and cooling systems Industrial Domestic water systems |

| Footnotes | Contact information |
|-----------|---|
| - | <p>Uponor Inc. 5925 148th Street West Apple Valley, MN 55124 T 800.321.4739 F 952.891.2008</p> <p>Uponor Ltd. 6510 Kennedy Road Mississauga, ON L5T 2X4 T 888.594.7726 F 800.638.9517</p> |