

# Conectores en T reductores de EP ProPEX de 2 in y más

## Project Information

Job name:	Location:
Engineer:	Fecha de envío:
Contractor:	Presentada por:
Manufacturer's representative:	Approved by:

## Technical data

Material	Engineered Polymer
Temp/pressure ratings	73 °F (23 °C) at 160 psi (11 bar) 180 °F (82 °C) at 100 psi (6.9 bar) 200 °F (93 °C) at 80 psi (5.5 bar)

## Product Information and application use

ProPEX® engineered polymer (EP) reducing tees make diverting connections for Uponor crosslinked polyethylene (PEX-a) tubing for use in hot and cold domestic potable water systems, residential fire sprinkler systems and hydronic radiant heating and cooling systems. Each end of the tee is manufactured with an Uponor ProPEX fitting for connections to Uponor AquaPEX® or Wirsbo hePEX™ tubing. Note: Branch size is listed last in the part descriptions.

Related: [ProPEX EP reducing tees - up to 1.5in](#)

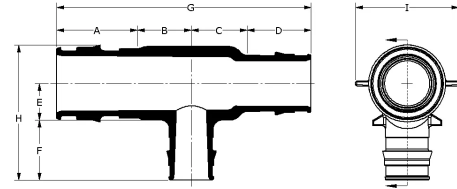

Note: Temperature and pressure ratings stated are hydrostatic ratings. For domestic hot-water (DHW) and DHW recirculation installations, operating conditions should not exceed 140°F (60°C) at 80 psi (5.5 bar) in accordance with ASTM F2023. For additional information regarding application-specific temperature and pressure ratings, refer to the Uponor PEX Piping Systems Design and Installation Manual.

Part name	Part no.	A [inch]	B [inch]	C [inch]	D [inch]	E [inch]	F [inch]	G [inch]	H [inch]	I [inch]	Cv Through
ProPEX EP Reducing Tee, 2" PEX x 1 1/2" PEX x 3/4" PEX	Q4752575	2.157	1.32	1.32	1.714	1.305	0.955	6.511	3.3	2.62	43.5
ProPEX EP Reducing Tee, 2" PEX x 1 1/2" PEX x 1" PEX	Q4752051	2.157	1.32	1.32	1.714	1.305	1.191	6.511	3.536	2.62	42.4
ProPEX EP Reducing Tee, 2" PEX x 1 1/2" PEX x 1 1/4" PEX	Q4752053	2.157	1.375	1.375	1.714	1.305	1.445	6.621	3.79	2.62	41.8
ProPEX EP Reducing Tee, 2" PEX x 1 1/2" PEX x 1 1/2" PEX	Q4752055	2.157	1.375	1.375	1.714	1.305	1.714	6.621	4.059	2.62	42.1
ProPEX EP Reducing Tee, 2" PEX x 1 1/2" PEX x 2" PEX	Q4752152	2.157	1.75	1.75	1.714	1.04	2.157	7.371	4.237	2.82	38.6
ProPEX EP Reducing Tee, 2" PEX x 2" PEX x 1/2" PEX	Q4752250	2.157	0.75	0.75	2.157	1.04	0.719	5.814	2.799	2.82	111.1
ProPEX EP Reducing Tee, 2" PEX x 2" PEX x 3/4" PEX	Q4752275	2.157	0.95	0.95	2.157	1.05	0.955	6.214	3.045	2.82	115
ProPEX EP Reducing Tee, 2" PEX x 2" PEX x 1" PEX	Q4752210	2.157	1.1	1.1	2.157	1.05	1.191	6.514	3.281	2.82	119.7
ProPEX EP Reducing Tee, 2" x 2" x 1 1/4	Q4752213	2.157	1.25	1.25	2.157	1.05	1.455	6.814	3.545	2.82	107
ProPEX EP Reducing Tee, 2" PEX x 2" PEX x 1 1/2" PEX	Q4752215	2.157	1.35	1.35	2.157	1.05	1.714	7.014	3.804	2.82	115.8
ProPEX EP Reducing Tee, 2 1/2" PEX x 2" PEX x 1 1/2" PEX	Q4752525	2.83	1.6	1.6	2.157	1.31	1.714	8.187	4.314	3.6	80.4
ProPEX EP Reducing Tee, 2 1/2" PEX x 2" PEX x 2" PEX	Q4752522	2.83	2	2	2.157	1.31	2.157	8.987	4.757	3.6	79.5
ProPEX EP Reducing Tee, 2 1/2" PEX x 2 1/2" PEX x 3/4" PEX	Q4752557	2.83	1.15	1.15	2.83	1.31	0.955	7.96	3.555	3.6	209.6
ProPEX EP Reducing Tee, 2 1/2" PEX x 2 1/2" PEX x 1" PEX	Q4752510	2.83	1.25	1.25	2.83	1.31	1.191	8.16	3.791	3.6	202
ProPEX EP Reducing Tee, 2 1/2" PEX x 2 1/2" PEX x 1 1/4" PEX	Q4752513	2.83	1.5	1.5	2.83	1.31	1.455	8.66	4.055	3.6	198.8
ProPEX EP Reducing Tee, 2 1/2" PEX x 2 1/2" PEX x 1 1/2" PEX	Q4752515	2.83	1.6	1.6	2.83	1.31	1.714	8.86	4.314	3.6	200
ProPEX EP Reducing Tee, 2 1/2" PEX x 2 1/2" PEX x 2" PEX	Q4752520	2.83	2	2	2.83	1.26	2.157	9.66	4.707	3.6	193.2
ProPEX EP Reducing Tee, 3" PEX x 2" PEX x 2" PEX	Q4753220	3.38	2	2	2.157	1.55	2.157	9.537	5.244	4.2	69.9
ProPEX EP Reducing Tee, 3" PEX x 2 1/2" PEX x 1 1/2" PEX	Q4753215	3.38	1.6	1.6	2.83	1.55	1.714	9.41	4.802	4.2	132.5

ProPEX EP Reducing Tee, 3" PEX x 2 1/2" PEX x 2" PEX	Q4753252	3.38	2	2	2.83	1.55	2.157	10.21	5.244	4.2	133.2
ProPEX EP Reducing Tee, 3" PEX x 3" PEX x 3/4" PEX	Q4753375	3.38	1.15	1.15	3.38	1.55	0.955	9.06	4.043	4.2	294.9
ProPEX EP Reducing Tee, 3" PEX x 3" PEX x 1" PEX	Q4753310	3.38	1.25	1.25	3.38	1.55	1.191	9.26	4.278	4.2	291.4
ProPEX EP Reducing Tee, 3" PEX x 3" PEX x 1 1/4" PEX	Q4753313	3.38	1.5	1.5	3.38	1.55	1.455	9.76	4.543	4.2	290.4
ProPEX EP Reducing Tee, 3" PEX x 3" PEX x 1 1/2" PEX	Q4753315	3.38	1.6	1.6	3.38	1.55	1.714	9.96	4.802	4.2	290.5
ProPEX EP Reducing Tee, 3" PEX x 3" PEX x 2" PEX	Q4753320	3.38	2	2	3.38	1.55	2.157	10.76	5.244	4.2	287.6
ProPEX EP Reducing Tee, 3" PEX x 3" PEX x 2 1/2" PEX	Q4753325	3.38	2.5	2.5	3.38	1.55	2.83	11.76	5.917	4.2	288.3
ProPEX EP Reducing Tee, 2" PEX x 1" PEX x 1" PEX	Q4752110	2.157	1.1	1.1	1.191	1.08	1.191	5.548	3.311	2.82	12.7

Part name	Part no.	Equivalent length branch [ft]	Equivalent length through [ft]	Cv Branch	End Type 1	End Type 2	End Type 3	Prop 65 label required?	Weight per UOM [lbs/UOM]
ProPEX EP Reducing Tee, 2" PEX x 1 1/2" PEX x 3/4" PEX	Q4752575	6.2	4.9	8.4	ProPEX 2"	ProPEX 1-1/2"	ProPEX 3/4"	-	0.3
ProPEX EP Reducing Tee, 2" PEX x 1 1/2" PEX x 1" PEX	Q4752051	8.4	5.5	13.9	ProPEX 2"	ProPEX 1-1/2"	ProPEX 1"	-	0.3
ProPEX EP Reducing Tee, 2" PEX x 1 1/2" PEX x 1 1/4" PEX	Q4752053	10.3	5.6	22	ProPEX 2"	ProPEX 1-1/2"	ProPEX 1-1/4"	-	0.34
ProPEX EP Reducing Tee, 2" PEX x 1 1/2" PEX x 1 1/2" PEX	Q4752055	13	5.4	28.5	ProPEX 2"	ProPEX 1-1/2"	ProPEX 1-1/2"	-	0.35
ProPEX EP Reducing Tee, 2" PEX x 1 1/2" PEX x 2" PEX	Q4752152	16.1	6.6	51.8	ProPEX 2"	ProPEX 1-1/2"	ProPEX 2"	-	0.42
ProPEX EP Reducing Tee, 2" PEX x 2" PEX x 1/2" PEX	Q4752250	4	2.7	4.3	ProPEX 2"	ProPEX 2"	ProPEX 1/2"	-	0.28
ProPEX EP Reducing Tee, 2" PEX x 2" PEX x 3/4" PEX	Q4752275	6.8	2.7	8.2	ProPEX 2"	ProPEX 2"	ProPEX 3/4"	-	0.34
ProPEX EP Reducing Tee, 2" PEX x 2" PEX x 1" PEX	Q4752210	8.5	2.4	13.8	ProPEX 2"	ProPEX 2"	ProPEX 1"	-	0.36
ProPEX EP Reducing Tee, 2" x 2" x 1 1/4"	Q4752213	8.8	3.1	23.6	ProPEX 2"	ProPEX 2"	ProPEX 1-1/4"	No	0.37
ProPEX EP Reducing Tee, 2" PEX x 2" PEX x 1 1/2" PEX	Q4752215	11.7	2.5	29.9	ProPEX 2"	ProPEX 2"	ProPEX 1-1/2"	No	0.44
ProPEX EP Reducing Tee, 2 1/2" PEX x 2" PEX x 1 1/2" PEX	Q4752525	11.2	5.9	30.2	ProPEX 2-1/2"	ProPEX 2"	ProPEX 1-1/2"	-	0.65
ProPEX EP Reducing Tee, 2 1/2" PEX x 2" PEX x 2" PEX	Q4752522	16	5.7	51.8	ProPEX 2-1/2"	ProPEX 2"	ProPEX 2"	-	0.78
ProPEX EP Reducing Tee, 2 1/2" PEX x 2 1/2" PEX x 3/4" PEX	Q4752557	6	2	8.5	ProPEX 2-1/2"	ProPEX 2-1/2"	ProPEX 3/4"	-	0.66
ProPEX EP Reducing Tee, 2 1/2" PEX x 2 1/2" PEX x 1" PEX	Q4752510	5	2.4	17.5	ProPEX 2-1/2"	ProPEX 2-1/2"	ProPEX 1"	-	0.69
ProPEX EP Reducing Tee, 2 1/2" PEX x 2 1/2" PEX x 1 1/4" PEX	Q4752513	9.7	2.5	22.4	ProPEX 2-1/2"	ProPEX 2-1/2"	ProPEX 1-1/4"	-	0.75
ProPEX EP Reducing Tee, 2 1/2" PEX x 2 1/2" PEX x 1 1/2" PEX	Q4752515	11.5	2.5	29.8	ProPEX 2-1/2"	ProPEX 2-1/2"	ProPEX 1-1/2"	-	0.78
ProPEX EP Reducing Tee, 2 1/2" PEX x 2 1/2" PEX x 2" PEX	Q4752520	14.7	2.7	53.6	ProPEX 2-1/2"	ProPEX 2-1/2"	ProPEX 2"	-	0.91
ProPEX EP Reducing Tee, 3" PEX x 2" PEX x 2" PEX	Q4753220	15.3	8.1	52.8	ProPEX 3"	ProPEX 2"	ProPEX 2"	-	1.1
ProPEX EP Reducing Tee, 3" PEX x 2 1/2" PEX x 1 1/2" PEX	Q4753215	10	7.5	29.2	ProPEX 3"	ProPEX 2-1/2"	ProPEX 1-1/2"	-	1.05
ProPEX EP Reducing Tee, 3" PEX x 2 1/2" PEX x 2" PEX	Q4753252	16.4	7.4	51.7	ProPEX 3"	ProPEX 2-1/2"	ProPEX 2"	-	1.22
ProPEX EP Reducing Tee, 3" PEX x 3" PEX x 3/4" PEX	Q4753375	6	2.7	8.5	ProPEX 3"	ProPEX 3"	ProPEX 3/4"	-	1.07
ProPEX EP Reducing Tee, 3" PEX x 3" PEX x 1" PEX	Q4753310	7.3	2.8	14.8	ProPEX 3"	ProPEX 3"	ProPEX 1"	-	1.1
ProPEX EP Reducing Tee, 3" PEX x 3" PEX x 1 1/4" PEX	Q4753313	9.3	3	22.8	ProPEX 3"	ProPEX 3"	ProPEX 1-1/4"	-	1.18
ProPEX EP Reducing Tee, 3" PEX x 3" PEX x 1 1/2" PEX	Q4753315	11.3	2.9	29.9	ProPEX 3"	ProPEX 3"	ProPEX 1-1/2"	-	1.22
ProPEX EP Reducing Tee, 3" PEX x 3" PEX x 2" PEX	Q4753320	14.6	3	53.8	ProPEX 3"	ProPEX 3"	ProPEX 2"	-	1.38

ProPEX EP Reducing Tee, 3" PEX x 3" PEX x 2 1/2" PEX	Q4753325	22.2	3	82.2	ProPEX 3"	ProPEX 3"	ProPEX 2-1/2"	-	1.65
ProPEX EP Reducing Tee, 2" PEX x 1" PEX x 1" PEX	Q4752110	16.1	6.6	19.7	ProPEX 2"	ProPEX 1"	ProPEX 1"	-	0.25

Part name	Part no.	Codes	Standards	Listings
Conectores en T reductores de EP ProPEX de 2 in y más	All	IMC	ASTM E119 ASTM F877 ASTM F1960 CSA B137.5 NSF/ANSI/CAN 61 ASTM E84 NSF/ANSI 14	IAPMO-ES HUD MR 1269 ICC-ES-PMG cNSFus-pw UL U.P.Code cQAlus P321

In addition, the following parts have additional codes, standards, or listings:

ProPEX EP Reducing Tee, 2" PEX x 1 1/2" PEX x 3/4" PEX	Q4752575	UPC IBC IRC IPC NPC of Canada UMC NSPC		
ProPEX EP Reducing Tee, 2" PEX x 1 1/2" PEX x 1" PEX	Q4752051	UPC IBC IRC IPC NPC of Canada UMC NSPC	ASTM E814	
ProPEX EP Reducing Tee, 2" PEX x 1 1/2" PEX x 1 1/4" PEX	Q4752053	UPC IBC IRC IPC NPC of Canada UMC NSPC	ASTM E814	
ProPEX EP Reducing Tee, 2" PEX x 1 1/2" PEX x 1 1/2" PEX	Q4752055	UPC IBC IRC IPC NPC of Canada UMC NSPC	ASTM E814	
ProPEX EP Reducing Tee, 2" PEX x 1 1/2" PEX x 2" PEX	Q4752152	UPC IBC IRC IPC NPC of Canada UMC NSPC	ASTM E814	
ProPEX EP Reducing Tee, 2" PEX x 2" PEX x 1/2" PEX	Q4752250	UPC IBC IRC IPC NPC of Canada UMC NSPC	ASTM E814	
ProPEX EP Reducing Tee, 2" PEX x 2" PEX x 3/4" PEX	Q4752275	UPC IBC IRC IPC NPC of Canada UMC NSPC	ASTM E814	
ProPEX EP Reducing Tee, 2" PEX x 2" PEX x 1" PEX	Q4752210	UPC IBC IRC IPC NPC of Canada UMC NSPC	ASTM E814	
ProPEX EP Reducing Tee, 2" x 2" x 1 1/4"	Q4752213	UPC IBC IRC IPC NPC of Canada UMC NSPC	ASTM E814	
ProPEX EP Reducing Tee, 2" PEX x 2" PEX x 1 1/2" PEX	Q4752215	UPC IBC IRC IPC NPC of Canada UMC NSPC	ASTM E814	
ProPEX EP Reducing Tee, 2 1/2" PEX x 2" PEX x 1 1/2" PEX	Q4752525	UPC IBC IRC IPC NPC of Canada UMC NSPC	ASTM E814	
ProPEX EP Reducing Tee, 2 1/2" PEX x 2" PEX x 2" PEX	Q4752522	UPC IBC IRC IPC NPC of Canada UMC NSPC	ASTM E814	
ProPEX EP Reducing Tee, 2 1/2" PEX x 2 1/2" PEX x 3/4" PEX	Q4752557	UPC IBC IRC IPC NPC of Canada UMC NSPC	ASTM E814	
ProPEX EP Reducing Tee, 2 1/2" PEX x 2 1/2" PEX x 1" PEX	Q4752510	UPC IBC IRC IPC NPC of Canada UMC NSPC	ASTM E814	
ProPEX EP Reducing Tee, 2 1/2" PEX x 2 1/2" PEX x 1 1/4" PEX	Q4752513	UPC IBC IRC IPC NPC of Canada UMC NSPC	ASTM E814	
ProPEX EP Reducing Tee, 2 1/2" PEX x 2 1/2" PEX x 1 1/2" PEX	Q4752515	UPC IBC IRC IPC NPC of Canada UMC NSPC	ASTM E814	
ProPEX EP Reducing Tee, 2 1/2" PEX x 2 1/2" PEX x 2" PEX	Q4752520	UPC IBC IRC IPC NPC of Canada UMC NSPC	ASTM E814	
ProPEX EP Reducing Tee, 3" PEX x 2" PEX x 2" PEX	Q4753220	UPC IBC IRC IPC NPC of Canada UMC NSPC	ASTM E814	
ProPEX EP Reducing Tee, 3" PEX x 2 1/2" PEX x 1 1/2" PEX	Q4753215	UPC IBC IRC IPC NPC of Canada UMC NSPC	ASTM E814	
ProPEX EP Reducing Tee, 3" PEX x 2 1/2" PEX x 2" PEX	Q4753252	UPC IBC IRC IPC NPC of Canada UMC NSPC	ASTM E814	
ProPEX EP Reducing Tee, 3" PEX x 3" PEX x 3/4" PEX	Q4753375	UPC IBC IRC IPC NPC of Canada UMC NSPC	ASTM E814	
ProPEX EP Reducing Tee, 3" PEX x 3" PEX x 1" PEX	Q4753310	UPC IBC IRC IPC NPC of Canada UMC NSPC	ASTM E814	
ProPEX EP Reducing Tee, 3" PEX x 3" PEX x 1 1/4" PEX	Q4753313	UPC IBC IRC IPC NPC of Canada UMC NSPC	ASTM E814	
ProPEX EP Reducing Tee, 3" PEX x 3" PEX x 1 1/2" PEX	Q4753315	UPC IBC IRC IPC NPC of Canada UMC NSPC	ASTM E814	
ProPEX EP Reducing Tee, 3" PEX x 3" PEX x 2" PEX	Q4753320	UPC IBC IRC IPC NPC of Canada UMC NSPC	ASTM E814	
ProPEX EP Reducing Tee, 3" PEX x 3" PEX x 2 1/2" PEX	Q4753325	UPC IBC IRC IPC NPC of Canada UMC NSPC	ASTM E814	

Installation	Related applications
Use the appropriate ProPEX ring for PEX-a tubing. Refer to the Uponor Piping Pocket Guide, AquaSAFE™ Residential Fire Sprinkler Installation Guide or Uponor Radiant Installation Handbook for additional information.	<ul style="list-style-type: none"> <li>PEX-a Plumbing Systems</li> <li>Hydronic Radiant Heating and Cooling Systems</li> <li>Turf Conditioning Systems</li> <li>Permafrost Prevention Systems</li> </ul>

Uponor Inc.  
5925 148th Street West  
Apple Valley, MN 55124  
T 800.321.4739  
F 952.891.2008

Uponor Ltd.  
6510 Kennedy Road  
Mississauga, ON L5T 2X4  
T 888.594.7726  
F 800.638.9517