

# Conectores en T de EP ProPEX

## Project Information

Job name:	Location:
Engineer:	Fecha de envío:
Contractor:	Presentada por:
Manufacturer's representative:	Approved by:

## Technical data

Material	Engineered Polymer
Temp/pressure ratings	73 °F (23 °C) at 160 psi (11 bar) 180 °F (82 °C) at 100 psi (6.9 bar) 200 °F (93 °C) at 80 psi (5.5 bar)

## Product Information and application use

ProPEX® engineered polymer (EP) tees make diverting connections for Uponor crosslinked polyethylene (PEX-a) tubing for use in hot and cold domestic potable water systems, residential fire sprinkler systems and hydronic radiant heating and cooling systems. Each end of the tee is manufactured with an Uponor ProPEX fitting for connections to Uponor AquaPEX® or Wirsbo hePEX™ tubing. Note: Branch size is listed last in the part descriptions.

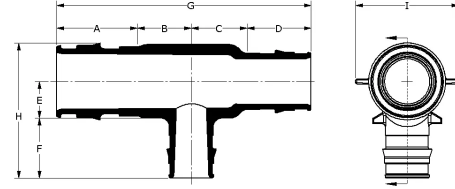

Note: Temperature and pressure ratings stated are hydrostatic ratings. For domestic hot-water (DHW) and DHW recirculation installations, operating conditions should not exceed 140°F (60°C) at 80 psi (5.5 bar) in accordance with ASTM F2023. For additional information regarding application-specific temperature and pressure ratings, refer to the Uponor PEX Piping Systems Design and Installation Manual.

Part name	Part no.	A [inch]	B [inch]	C [inch]	D [inch]	E [inch]	F [inch]	G [inch]	H [inch]	I [inch]	Cv Through
ProPEX EP Tee, 1/2" PEX x 1/2" PEX x 1/2" PEX	Q4755050	0.719	0.58	0.58	0.719	0.4	0.719	2.598	1.428	0.87	7.7
ProPEX EP Tee, 3/4" PEX x 3/4" PEX x 3/4" PEX	Q4757575	0.955	0.7	0.7	0.955	0.52	0.955	3.31	1.475	1.22	15.7
ProPEX EP Tee, 1" PEX x 1" PEX x 1" PEX	Q4751010	1.191	0.925	0.925	1.191	0.65	1.191	4.232	2.431	1.48	30.5
ProPEX EP Tee, 1 1/4" PEX x 1 1/4" PEX x 1 1/4" PEX	Q4751313	1.455	1.15	1.15	1.455	0.85	1.455	5.21	2.986	1.82	34
ProPEX EP Tee, 1 1/2" PEX x 1 1/2" PEX x 1 1/2" PEX	Q4751515	1.714	1.2	1.2	1.714	0.85	1.714	5.828	3.314	2.07	63.7
ProPEX EP Tee, 2" PEX x 2" PEX x 2" PEX	Q4752000	2.157	1.75	1.75	2.157	1.05	2.157	7.814	4.247	2.82	150.7
ProPEX EP Tee, 2 1/2" PEX x 2 1/2" PEX x 2 1/2" PEX	Q4752500	2.83	2.45	2.45	2.83	1.33	2.83	10.56	5.45	3.6	197.2
ProPEX EP Tee, 3" PEX x 3" PEX x 3" PEX	Q4753000	3.38	2.75	2.75	3.38	1.45	3.38	12.26	6.367	4.2	286.6

Part name	Part no.	Equivalent length branch [ft]	Equivalent length through [ft]	Cv Branch	End Type 1	End Type 2	End Type 3	Prop 65 label required?	Weight per UOM [lbs/UOM]
ProPEX EP Tee, 1/2" PEX x 1/2" PEX x 1/2" PEX	Q4755050	6.3	1	3.4	ProPEX 1/2"	ProPEX 1/2"	ProPEX 1/2"	-	0.02
ProPEX EP Tee, 3/4" PEX x 3/4" PEX x 3/4" PEX	Q4757575	15.6	1.5	5.4	ProPEX 3/4"	ProPEX 3/4"	ProPEX 3/4"	-	0.05
ProPEX EP Tee, 1" PEX x 1" PEX x 1" PEX	Q4751010	12.7	1.3	11.3	ProPEX 1"	ProPEX 1"	ProPEX 1"	-	0.07
ProPEX EP Tee, 1 1/4" PEX x 1 1/4" PEX x 1 1/4" PEX	Q4751313	8.6	3.8	23.9	ProPEX 1-1/4"	ProPEX 1-1/4"	ProPEX 1-1/4"	No	0.15
ProPEX EP Tee, 1 1/2" PEX x 1 1/2" PEX x 1 1/2" PEX	Q4751515	10.6	1.8	31	ProPEX 1-1/2"	ProPEX 1-1/2"	ProPEX 1-1/2"	No	0.25
ProPEX EP Tee, 2" PEX x 2" PEX x 2" PEX	Q4752000	15.5	0.8	52.5	ProPEX 2"	ProPEX 2"	ProPEX 2"	-	0.38
ProPEX EP Tee, 2 1/2" PEX x 2 1/2" PEX x 2 1/2" PEX	Q4752500	22.3	2.7	81.5	ProPEX 2-1/2"	ProPEX 2-1/2"	ProPEX 2-1/2"	-	1.14
ProPEX EP Tee, 3" PEX x 3" PEX x 3" PEX	Q4753000	23.9	2.8	122.8	ProPEX 3"	ProPEX 3"	ProPEX 3"	-	1.86

Part name	Part no.	Codes	Standards	Listings
Conectores en T de EP ProPEX	All	IMC UPC IBC IRC IPC NPC of Canada UMC NSPC	ASTM F1960 ASTM E119/UL 263 ASTM E84 ASTM E814/ULC S115 ASTM F877 CSA B137.5 ULC S102.2 NSF/ANSI/CAN 61 ULC S101 NSF/ANSI 14	IAPMO-ES ICC-ES-PMG UL U.P.Code cQAlus P321 HUD MR 1269
In addition, the following parts have additional codes, standards, or listings:				
ProPEX EP Tee, 1/2" PEX x 1/2" PEX x 1/2" PEX	Q4755050			cNSFus-pw
ProPEX EP Tee, 3/4" PEX x 3/4" PEX x 3/4" PEX	Q4757575		UL 1821	cNSFus-pw-fs
ProPEX EP Tee, 1" PEX x 1" PEX x 1" PEX	Q4751010		UL 1821	cNSFus-pw-fs
ProPEX EP Tee, 1 1/4" PEX x 1 1/4" PEX x 1 1/4" PEX	Q4751313		UL 1821	cNSFus-pw-fs
ProPEX EP Tee, 1 1/2" PEX x 1 1/2" PEX x 1 1/2" PEX	Q4751515			cNSFus-pw
ProPEX EP Tee, 2" PEX x 2" PEX x 2" PEX	Q4752000			cNSFus-pw
ProPEX EP Tee, 2 1/2" PEX x 2 1/2" PEX x 2 1/2" PEX	Q4752500		ASTM E814	cNSFus-pw
ProPEX EP Tee, 3" PEX x 3" PEX x 3" PEX	Q4753000			cNSFus-pw

Installation	Related applications
Use the appropriate ProPEX Ring for PEX-a tubing. Refer to the Uponor Professional Plumbing Installation Guide, AquaSAFE™ Residential Fire Sprinkler Installation Guide or Uponor Radiant Installation Handbook for additional information	<ul style="list-style-type: none"> <li>PEX-a Plumbing Systems</li> <li>Hydronic Radiant Heating and Cooling Systems</li> <li>Turf Conditioning Systems</li> <li>Permafrost Prevention Systems</li> </ul>

Footnotes	Contact information
-	<p>Uponor Inc. 5925 148th Street West Apple Valley, MN 55124 T 800.321.4739 F 952.891.2008</p> <p>Uponor Ltd. 6510 Kennedy Road Mississauga, ON L5T 2X4 T 888.594.7726 F 800.638.9517</p>