

Válvulas de bola comerciales de bronce sin plomo (LF) ProPEX



Project Information

Job name:	Location:
Engineer:	Fecha de envío:
Contractor:	Presentada por:
Manufacturer's representative:	Approved by:

Technical data

Cold working pressure	250 psi
Temp/pressure ratings	200 °F (93 °C) at 200 psi (13.8 bar)
Prop 65 label required?	Yes

Product information and application use

To help meet the stringent demands of commercial plumbing and hydronic distribution projects, Uponor is offering new ProPEX® ASTM F1960 lead-free (LF) brass ball valves in sizes from ½" to 2". The full-port ball valves feature a stainless-steel ball and stem for greater durability, longevity, and system performance.

Note: Temperature and pressure ratings stated are hydrostatic ratings. For domestic hot-water (DHW) and DHW recirculation installations, operating conditions should not exceed 140°F (60°C) at 80 psi (5.5 bar) in accordance with ASTM F2023. For additional information regarding application-specific temperature and pressure ratings, refer to the Uponor PEX Piping Systems Design and Installation Manual.

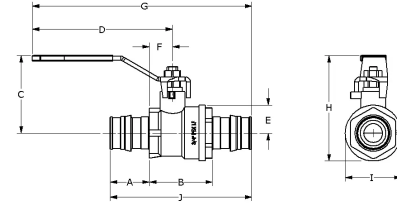

Part name	Part no.	A [inch]	B [inch]	C [inch]	D [inch]	E [inch]	F [inch]	G [inch]	H [inch]	I [inch]	J [inch]
ProPEX LF Brass Commercial Ball Valve (full port) SS Ball and Stem 1/2" PEX x 1/2" PEX	LFC4825050SS	0.709	1.228	1.679	3.37	0.447	0.465	4.843	2.126	0.959	2.646
ProPEX LF Brass Commercial Ball Valve (full port) SS Ball and Stem 3/4" PEX x 3/4" PEX	LFC4827575SS	0.945	1.358	1.789	3.37	0.634	0.522	5.151	2.423	1.268	3.248
ProPEX LF Brass Commercial Ball Valve (full port) SS Ball and Stem 1" PEX x 1" PEX	LFC4821010SS	1.181	1.618	2.181	4.52	0.748	0.685	6.504	2.181	1.496	3.98
ProPEX LF Brass Commercial Ball Valve (full port) SS Ball and Stem 1 1/4" PEX x 1 1/4" PEX	LFC4821313SS	1.445	1.862	2.388	4.516	0.915	0.821	7.002	3.303	1.831	4.752
ProPEX LF Brass Commercial Ball Valve (full port) SS Ball and Stem 1 1/2" PEX x 1 1/2" PEX	LFC4821515SS	1.705	2.059	3.114	5.584	1.024	0.98	8.368	4.138	2.087	5.469
ProPEX LF Brass Commercial Ball Valve (full port) SS Ball and Stem 2" PEX x 2" PEX	LFC4822020SS	2.146	2.413	3.339	5.584	1.358	1.122	9.021	4.697	2.638	6.705

Part name	Part no.	Cv	End Type 1	End Type 2	Weight per UOM [lbs/UOM]
ProPEX LF Brass Commercial Ball Valve (full port) SS Ball and Stem 1/2" PEX x 1/2" PEX	LFC4825050SS	6.8	ProPEX 1/2"	ProPEX 1/2"	0.33
ProPEX LF Brass Commercial Ball Valve (full port) SS Ball and Stem 3/4" PEX x 3/4" PEX	LFC4827575SS	17	ProPEX 3/4"	ProPEX 3/4"	0.45
ProPEX LF Brass Commercial Ball Valve (full port) SS Ball and Stem 1" PEX x 1" PEX	LFC4821010SS	29	ProPEX 1"	ProPEX 1"	0.87
ProPEX LF Brass Commercial Ball Valve (full port) SS Ball and Stem 1 1/4" PEX x 1 1/4" PEX	LFC4821313SS	49.1	ProPEX 1-1/4"	ProPEX 1-1/4"	1.29
ProPEX LF Brass Commercial Ball Valve (full port) SS Ball and Stem 1 1/2" PEX x 1 1/2" PEX	LFC4821515SS	58.9	ProPEX 1-1/2"	ProPEX 1-1/2"	1.9
ProPEX LF Brass Commercial Ball Valve (full port) SS Ball and Stem 2" PEX x 2" PEX	LFC4822020SS	139.1	ProPEX 2"	ProPEX 2"	2.97

Part name	Part no.	Codes	Standards	Listings
Válvulas de bola comerciales de bronce sin plomo (LF) ProPEX	All	UPC IBC IRC IPC NPC of Canada UMC IMC	ASTM F877 NSF/ANSI/CAN 372 NSF/ANSI 359 ASTM F1960 CSA B137.5 NSF/ANSI/CAN 61 NSF/ANSI 14	cNSFus-pw-G U.P.Code

In addition, the following parts have additional codes, standards, or listings:

ProPEX LF Brass Commercial Ball Valve (full port) SS Ball and Stem 2" PEX x 2" PEX	LFC4822020SS
--	--------------

Installation

Install valve and stem extension kit according to local building code. Do not dismantle. Refer to the Uponor Piping Pocket Guide or the Uponor PEX Piping Systems Design and Installation Manual for additional information.

Related applications

Hot water distribution
Hydronic heating and cooling systems
Hydronic Piping Systems
Hydronic Radiant Heating and Cooling Systems
PEX-a Plumbing Systems
Plumbing Systems
Pre-Insulated Pipe Systems
Radiant Heating and Cooling Systems

Footnotes

-

Contact information

Uponor Inc.
5925 148th Street West
Apple Valley, MN 55124
T 800.321.4739
F 952.891.2008

Uponor Ltd.
6510 Kennedy Road
Mississauga, ON L5T 2X4
T 888.594.7726
F 800.638.9517