

Extremos de tuberías en L de cobre sin plomo (LF) ProPEX

Project Information

Job name:	Location:
Engineer:	Fecha de envío:
Contractor:	Presentada por:
Manufacturer's representative:	Approved by:

Technical data

Material	Copper
Subcomponent Material	LF Brass
Temp/pressure ratings	Copper 73 °F (23 °C) at 160 psi (11 bar) 180 °F (82 °C) at 100 psi (6.9 bar) 200 °F (93 °C) at 80 psi (5.5 bar)
Prop 65 label required?	Yes

Product information and application use

Uponor ProPEX® lead-free (LF) copper stub ells provide a 90-degree transition from Uponor AquaPEX® tubing to copper. Copper stub ells are comprised of 1/2", 3/4" or 1" type L copper pipe with an Uponor ProPEX fitting on one end and the other end spun closed.

Note: Temperature and pressure ratings stated are hydrostatic ratings. For domestic hot-water (DHW) and DHW recirculation installations, operating conditions should not exceed 140°F (60°C) at 80 psi (5.5 bar) in accordance with ASTM F2023. For additional information regarding application-specific temperature and pressure ratings, refer to the Uponor PEX Piping Systems Design and Installation Manual.

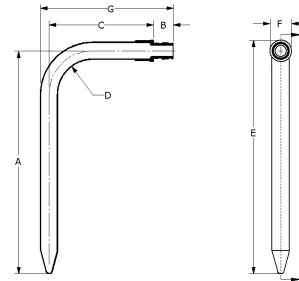

Part name	Part no.	A [inch]	B [inch]	C [inch]	D [inch]	E [inch]	F [inch]	G [inch]	End Type 1	Weight per UOM [lbs/UOM]
ProPEX LF Copper Stub Ell, 1/2" PEX LF Brass x 1/2" Copper (3 1/2" x 8")	LF2865050	7.987	0.709	3.749	3.084	8.372	0.77	4.77	ProPEX 1/2"	0.2
ProPEX LF Copper Stub Ell, 1/2" PEX LF Brass x 1/2" Copper (13" x 8")	LF2855050	7.987	0.709	12.299	3.084	8.372	0.77	13.32	ProPEX 1/2"	0.5
ProPEX LF Copper Stub Ell, 1/2" PEX LF Brass x 1/2" Copper (8" x 13")	LF2895050	12.985	0.709	7.295	3.04	13.37	0.77	8.316	ProPEX 1/2"	0.48
ProPEX LF Copper Stub Ell, 3/4" PEX LF Brass x 3/4" Copper (4" x 8")	LF2897575	8.002	0.945	4.057	3.959	8.552	1.1	5.44	ProPEX 3/4"	0.5
ProPEX LF Copper Stub Ell, 1" PEX x 1" Copper (13" x 8")	LF2891010	13	1.181	6.507	8	13.68	1.36	8.25	ProPEX 1"	1.7

Part name	Part no.	Codes	Standards	Listings
Extremos de tuberías en L de cobre sin plomo (LF) ProPEX	All	UPC IBC IRC IPC NPC of Canada UMC NSPC IMC	NSF/ANSI/CAN 372 ASTM F877 ASTM F1960 CSA B137.5 NSF/ANSI/CAN 61 NSF/ANSI 14	IAPMO-ES HUD MR 1269

In addition, the following parts have additional codes, standards, or listings:

ProPEX LF Copper Stub Ell, 1/2" PEX LF Brass x 1/2" Copper (3 1/2" x 8")	LF2865050
ProPEX LF Copper Stub Ell, 1/2" PEX LF Brass x 1/2" Copper (8" x 13")	LF2895050
ProPEX LF Copper Stub Ell, 3/4" PEX LF Brass x 3/4" Copper (4" x 8")	LF2897575
ProPEX LF Copper Stub Ell, 1" PEX x 1" Copper (13" x 8")	LF2891010

Installation

Refer to the Uponor AquaPEX Professional Plumbing Installation Guide for additional information

Related applications

PEX-a Plumbing Systems

Footnotes

Contact information

Uponor Inc.
5925 148th Street West
Apple Valley, MN 55124
T 800.321.4739
F 952.891.2008

Uponor Ltd.
6510 Kennedy Road
Mississauga, ON L5T 2X4
T 888.594.7726
F 800.638.9517