

Uponor PP-RCT LF transition saddles, female NPT (outlet fusion)



Project Information

| | |
|--------------------------------|-----------------|
| Job name: | Location: |
| Engineer: | Date submitted: |
| Contractor: | Submitted by: |
| Manufacturer's representative: | Approved by: |

Technical data

| | |
|-------------------------|---|
| Material | PP-RCT |
| Temp/pressure ratings | 73 °F (23 °C) at 340 psi (23.44 bar) 140 °F (60 °C) at 190 psi (13.1 bar) 180 °F (82 °C) at 100 psi (6.9 bar) |
| Prop 65 label required? | Yes |

Product information and application use

Use Uponor Lead-Free (LF) Female NPT Transition Saddles for outlet-fusion connections to Uponor PP-RCT Mechanical Pipe to convey fluid for hydronic heating and cooling or industrial applications and for outlet-fusion connections to Uponor PP-RCT Potable Pipe to convey water for potable plumbing applications.

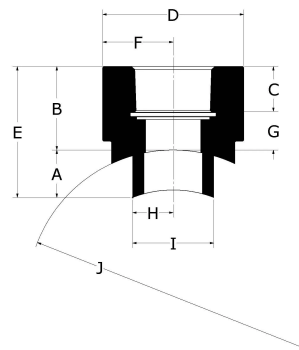

| Part name | Part no. | A [inch] | B [inch] | C [inch] | D [inch] | E [inch] | F [inch] | G [inch] | H [inch] | I [inch] | J [inch] |
|--|------------|----------|----------|----------|----------|----------|----------|----------|----------|----------|----------|
| Uponor PP-RCT LF Transition Saddle, 10" x 1", Female NPT, for Outlet Fusion | PR57910010 | 1.151 | 1.114 | 0.683 | 2.362 | 2.265 | 1.181 | 0.433 | 0.63 | 1.26 | 9.843 |
| Uponor PP-RCT LF Transition Saddle, 10" x 1/2", Female NPT, for Outlet Fusion | PR57910050 | 1.13 | 1.039 | 0.54 | 1.614 | 2.17 | 0.807 | 0.499 | 0.492 | 0.984 | 9.843 |
| Uponor PP-RCT LF Transition Saddle, 10" x 3/4", Female NPT, for Outlet Fusion | PR57910075 | 1.13 | 1.043 | 0.546 | 1.811 | 2.174 | 0.906 | 0.498 | 0.492 | 0.984 | 9.843 |
| Uponor PP-RCT LF Transition Saddle, 1 1/2" x 1/2", Female NPT, for Outlet Fusion | PR5791550 | 0.4 | 0.913 | 0.54 | 1.496 | 1.313 | 0.748 | 0.374 | 0.492 | 0.984 | 1.969 |
| Uponor PP-RCT LF Transition Saddle, 1 1/2" x 3/4", Female NPT, for Outlet Fusion | PR5791575 | 0.451 | 1.012 | 0.546 | 1.713 | 1.463 | 0.856 | 0.466 | 0.492 | 0.984 | 1.969 |
| Uponor PP-RCT LF Transition Saddle, 2" x 1/2", Female NPT, for Outlet Fusion | PR5792050 | 0.415 | 0.913 | 0.54 | 1.496 | 1.329 | 0.748 | 0.374 | 0.492 | 0.984 | 2.48 |
| Uponor PP-RCT LF Transition Saddle, 2" x 3/4", Female NPT, for Outlet Fusion | PR5792075 | 0.415 | 1.012 | 0.546 | 1.713 | 1.427 | 0.856 | 0.466 | 0.492 | 0.984 | 2.48 |
| Uponor PP-RCT LF Transition Saddle, 2 1/2" x 1", Female NPT, for Outlet Fusion | PR5792510 | 0.519 | 1.102 | 0.683 | 2.362 | 1.622 | 1.181 | 0.42 | 0.63 | 1.26 | 2.953 |
| Uponor PP-RCT LF Transition Saddle, 2 1/2" x 1/2", Female NPT, for Outlet Fusion | PR5792550 | 0.442 | 0.913 | 0.54 | 1.496 | 1.355 | 0.748 | 0.374 | 0.492 | 0.984 | 2.953 |
| Uponor PP-RCT LF Transition Saddle, 2 1/2" x 3/4", Female NPT, for Outlet Fusion | PR5792575 | 0.519 | 1.012 | 0.546 | 1.713 | 1.53 | 0.856 | 0.466 | 0.492 | 0.984 | 2.953 |
| Uponor PP-RCT LF Transition Saddle, 3" x 1", Female NPT, for Outlet Fusion | PR5793010 | 0.551 | 1.102 | 0.683 | 2.362 | 1.654 | 1.181 | 0.42 | 0.63 | 1.26 | 3.543 |
| Uponor PP-RCT LF Transition Saddle, 3" x 1/2", Female NPT, for Outlet Fusion | PR5793050 | 0.489 | 0.913 | 0.54 | 1.496 | 1.402 | 0.748 | 0.374 | 0.492 | 0.984 | 3.543 |
| Uponor PP-RCT LF Transition Saddle, 3" x 3/4", Female NPT, for Outlet Fusion | PR5793075 | 0.576 | 1.012 | 0.546 | 1.713 | 1.587 | 0.856 | 0.466 | 0.984 | 0.984 | 3.543 |
| Uponor PP-RCT LF Transition Saddle, 4" x 1", Female NPT, for Outlet Fusion | PR5794010 | 0.658 | 1.102 | 0.683 | 2.362 | 1.761 | 1.181 | 0.42 | 0.63 | 1.26 | 4.921 |
| Uponor PP-RCT LF Transition Saddle, 4" x 1/2", Female NPT, for Outlet Fusion | PR5794050 | 0.738 | 0.913 | 0.54 | 1.496 | 1.654 | 0.748 | 0.374 | 0.492 | 0.984 | 4.921 |
| Uponor PP-RCT LF Transition Saddle, 4" x 3/4", Female NPT, for Outlet Fusion | PR5794075 | 0.738 | 1.012 | 0.546 | 1.713 | 1.75 | 0.856 | 0.466 | 0.492 | 0.984 | 4.921 |
| Uponor PP-RCT LF Transition Saddle, 6" x 1", Female NPT, for Outlet Fusion | PR5796010 | 0.787 | 1.102 | 0.683 | 2.362 | 1.89 | 1.181 | 0.42 | 0.63 | 1.26 | 6.299 |
| Uponor PP-RCT LF Transition Saddle, 6" x 1/2", Female NPT, for Outlet Fusion | PR5796050 | 0.755 | 0.913 | 0.54 | 1.496 | 1.668 | 0.748 | 0.374 | 0.492 | 0.984 | 6.299 |
| Uponor PP-RCT LF Transition Saddle, 6" x 3/4", Female NPT, for Outlet Fusion | PR5796075 | 0.755 | 1.012 | 0.546 | 1.713 | 1.767 | 0.856 | 0.466 | 0.492 | 0.984 | 6.299 |
| Uponor PP-RCT LF Transition Saddle, 8" x 1", Female NPT, for Outlet Fusion | PR5798010 | 0.949 | 1.102 | 0.681 | 2.362 | 2.051 | 1.181 | 0.421 | 0.63 | 1.26 | 7.874 |

| | | | | | | | | | | | |
|--|-----------|-------|-------|-------|-------|-------|-------|-------|-------|-------|-------|
| Uponor PP-RCT LF Transition Saddle, 8" x 1/2", Female NPT, for Outlet Fusion | PR5798050 | 0.922 | 0.984 | 0.54 | 1.614 | 1.906 | 0.807 | 0.444 | 0.492 | 0.984 | 7.874 |
| Uponor PP-RCT LF Transition Saddle, 8" x 3/4", Female NPT, for Outlet Fusion | PR5798075 | 0.922 | 1.004 | 0.546 | 1.811 | 1.926 | 0.906 | 0.458 | 0.492 | 0.984 | 7.874 |

| Part name | Part no. | Equivalent length through [ft] | End Type 1 | End Type 2 | Weight per UOM [lbs/UOM] |
|--|------------|--------------------------------|---------------|------------|--------------------------|
| Uponor PP-RCT LF Transition Saddle, 10" x 1", Female NPT, for Outlet Fusion | PR57910010 | 1.7 | Saddle 10" | FNPT 1" | 0.36 |
| Uponor PP-RCT LF Transition Saddle, 10" x 1/2", Female NPT, for Outlet Fusion | PR57910050 | 1.1 | Saddle 10" | FNPT 1/2" | 0.14 |
| Uponor PP-RCT LF Transition Saddle, 10" x 3/4", Female NPT, for Outlet Fusion | PR57910075 | 1.4 | Saddle 10" | FNPT 3/4" | 0.17 |
| Uponor PP-RCT LF Transition Saddle, 1 1/2" x 1/2", Female NPT, for Outlet Fusion | PR5791550 | 1.1 | Saddle 1-1/2" | FNPT 1/2" | 0.12 |
| Uponor PP-RCT LF Transition Saddle, 1 1/2" x 3/4", Female NPT, for Outlet Fusion | PR5791575 | 1.4 | Saddle 1-1/2" | FNPT 3/4" | 0.16 |
| Uponor PP-RCT LF Transition Saddle, 2" x 1/2", Female NPT, for Outlet Fusion | PR5792050 | 1.1 | Saddle 2" | FNPT 1/2" | 0.12 |
| Uponor PP-RCT LF Transition Saddle, 2" x 3/4", Female NPT, for Outlet Fusion | PR5792075 | 1.4 | Saddle 2" | FNPT 3/4" | 0.16 |
| Uponor PP-RCT LF Transition Saddle, 2 1/2" x 1", Female NPT, for Outlet Fusion | PR5792510 | 1.7 | Saddle 2-1/2" | FNPT 1" | 0.34 |
| Uponor PP-RCT LF Transition Saddle, 2 1/2" x 1/2", Female NPT, for Outlet Fusion | PR5792550 | 1.1 | Saddle 2-1/2" | FNPT 1/2" | 0.12 |
| Uponor PP-RCT LF Transition Saddle, 2 1/2" x 3/4", Female NPT, for Outlet Fusion | PR5792575 | 1.4 | Saddle 2-1/2" | FNPT 3/4" | 0.16 |
| Uponor PP-RCT LF Transition Saddle, 3" x 1", Female NPT, for Outlet Fusion | PR5793010 | 1.7 | Saddle 3" | FNPT 1" | 0.34 |
| Uponor PP-RCT LF Transition Saddle, 3" x 1/2", Female NPT, for Outlet Fusion | PR5793050 | 1.1 | Saddle 3" | FNPT 1/2" | 0.12 |
| Uponor PP-RCT LF Transition Saddle, 3" x 3/4", Female NPT, for Outlet Fusion | PR5793075 | 1.4 | Saddle 3" | FNPT 3/4" | 0.16 |
| Uponor PP-RCT LF Transition Saddle, 4" x 1", Female NPT, for Outlet Fusion | PR5794010 | 1.7 | Saddle 4" | FNPT 1" | 0.34 |
| Uponor PP-RCT LF Transition Saddle, 4" x 1/2", Female NPT, for Outlet Fusion | PR5794050 | 1.1 | Saddle 4" | FNPT 1/2" | 0.12 |
| Uponor PP-RCT LF Transition Saddle, 4" x 3/4", Female NPT, for Outlet Fusion | PR5794075 | 1.4 | Saddle 4" | FNPT 3/4" | 0.16 |
| Uponor PP-RCT LF Transition Saddle, 6" x 1", Female NPT, for Outlet Fusion | PR5796010 | 1.7 | Saddle 6" | FNPT 1" | 0.35 |
| Uponor PP-RCT LF Transition Saddle, 6" x 1/2", Female NPT, for Outlet Fusion | PR5796050 | 1.1 | Saddle 6" | FNPT 1/2" | 0.12 |
| Uponor PP-RCT LF Transition Saddle, 6" x 3/4", Female NPT, for Outlet Fusion | PR5796075 | 1.4 | Saddle 6" | FNPT 3/4" | 0.16 |
| Uponor PP-RCT LF Transition Saddle, 8" x 1", Female NPT, for Outlet Fusion | PR5798010 | 1.7 | Saddle 8" | FNPT 1" | 0.36 |
| Uponor PP-RCT LF Transition Saddle, 8" x 1/2", Female NPT, for Outlet Fusion | PR5798050 | 1.1 | Saddle 8" | FNPT 1/2" | 0.13 |
| Uponor PP-RCT LF Transition Saddle, 8" x 3/4", Female NPT, for Outlet Fusion | PR5798075 | 1.4 | Saddle 8" | FNPT 3/4" | 0.17 |

| Part name | Part no. | Codes | Standards | Listings |
|---|----------|---|---|---|
| Uponor PP-RCT LF transition saddles, female NPT (outlet fusion) | All | UPC IRC NBC of Canada IPC UMC CMC CPC IMC | NSF/ANSI/CAN 61 ASTM E84 NSF/ANSI 14 ASTM F2389 CSA B137.11 | ICC-ES-PMG 1106 IAPMO-R&T 8358 QAI P321-5 IAPMO K-12775 |

| Installation | Related applications |
|--------------|--|
| - | Domestic water systems Hydronic heating and cooling systems Industrial |

| Footnotes | Contact information |
|-----------|--|
| - | Uponor Inc. 5925 148th Street West Apple Valley, MN 55124 T 800.321.4739 F 952.891.2008 Uponor Ltd. 6510 Kennedy Road Mississauga, ON L5T 2X4 T 888.594.7726 F 800.638.9517 |