

# Uponor PP-RCT transition saddles, male NPT (outlet fusion)

## Project Information

Job name:	Location:
Engineer:	Date submitted:
Contractor:	Submitted by:
Manufacturer's representative:	Approved by:

## Technical data

Material	PP-RCT
Temp/pressure ratings	73 °F (23 °C) at 340 psi (23.44 bar) 140 °F (60 °C) at 190 psi (13.1 bar) 180 °F (82 °C) at 100 psi (6.9 bar)
Prop 65 label required?	Yes

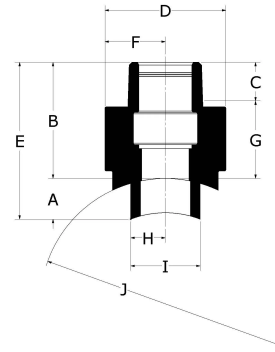

Part name	Part no.	A [inch]	B [inch]	C [inch]	D [inch]	E [inch]	F [inch]	G [inch]	H [inch]	I [inch]	J [inch]
Uponor PP-RCT Transition Saddle, 1 1/2" x 1/2", Male NPT, for Outlet Fusion	PR4811550	0.4	1.819	0.534	1.496	2.219	0.748	1.285	0.492	0.984	1.969
Uponor PP-RCT Transition Saddle, 1 1/2" x 3/4", Male NPT, for Outlet Fusion	PR4811575	0.451	1.996	0.546	1.713	2.447	0.856	1.45	0.492	0.984	1.969
Uponor PP-RCT Transition Saddle, 2" x 1/2", Male NPT, for Outlet Fusion	PR4812050	0.415	1.819	0.54	1.496	2.234	0.748	1.279	0.492	0.984	2.48
Uponor PP-RCT Transition Saddle, 2" x 3/4", Male NPT, for Outlet Fusion	PR4812075	0.415	1.996	0.546	1.713	2.411	0.856	1.45	0.492	0.984	2.48
Uponor PP-RCT Transition Saddle, 2 1/2" x 1/2", Male NPT, for Outlet Fusion	PR4812550	0.442	1.819	0.54	1.496	2.261	0.748	1.279	0.492	0.984	2.953
Uponor PP-RCT Transition Saddle, 2 1/2" x 3/4", Male NPT, for Outlet Fusion	PR4812575	0.519	1.996	0.546	1.713	2.515	0.856	1.45	0.492	0.984	2.953
Uponor PP-RCT Transition Saddle, 3" x 1/2", Male NPT, for Outlet Fusion	PR4813050	0.489	2.308	0.54	1.496	2.308	0.748	1.279	0.492	0.984	3.543
Uponor PP-RCT Transition Saddle, 3" x 3/4", Male NPT, for Outlet Fusion	PR4813075	0.576	1.996	0.546	1.713	2.572	0.856	1.45	0.492	0.984	3.543
Uponor PP-RCT Transition Saddle, 4" x 1/2", Male NPT, for Outlet Fusion	PR4814050	0.738	1.819	0.54	1.496	2.557	0.748	1.279	0.492	0.984	4.921
Uponor PP-RCT Transition Saddle, 4" x 3/4", Male NPT, for Outlet Fusion	PR4814075	0.738	1.996	0.546	1.713	2.734	0.856	1.45	0.492	0.984	4.921
Uponor PP-RCT Transition Saddle, 6" x 1/2", Male NPT, for Outlet Fusion	PR4816050	0.755	1.819	0.54	1.496	2.574	0.748	1.279	0.492	0.984	6.299
Uponor PP-RCT Transition Saddle, 6" x 3/4", Male NPT, for Outlet Fusion	PR4816075	0.755	1.996	0.546	1.713	2.751	0.856	1.45	0.492	0.984	6.299

Part name	Part no.	Equivalent length through [ft]	End Type 1	End Type 2	Weight per UOM [lbs/UOM]
Uponor PP-RCT Transition Saddle, 1 1/2" x 1/2", Male NPT, for Outlet Fusion	PR4811550	1.5	Saddle 1-1/2"	MNPT 1/2"	0.18
Uponor PP-RCT Transition Saddle, 1 1/2" x 3/4", Male NPT, for Outlet Fusion	PR4811575	1.9	Saddle 1-1/2"	MNPT 3/4"	0.26
Uponor PP-RCT Transition Saddle, 2" x 1/2", Male NPT, for Outlet Fusion	PR4812050	1.5	Saddle 2"	MNPT 1/2"	0.18
Uponor PP-RCT Transition Saddle, 2" x 3/4", Male NPT, for Outlet Fusion	PR4812075	1.9	Saddle 2"	MNPT 3/4"	0.26
Uponor PP-RCT Transition Saddle, 2 1/2" x 1/2", Male NPT, for Outlet Fusion	PR4812550	1.5	Saddle 2-1/2"	MNPT 1/2"	0.18
Uponor PP-RCT Transition Saddle, 2 1/2" x 3/4", Male NPT, for Outlet Fusion	PR4812575	1.9	Saddle 2-1/2"	MNPT 3/4"	0.26
Uponor PP-RCT Transition Saddle, 3" x 1/2", Male NPT, for Outlet Fusion	PR4813050	1.5	Saddle 3"	MNPT 1/2"	0.18

Outlet Fusion						
Uponor PP-RCT Transition Saddle, 3" x 3/4", Male NPT, for Outlet Fusion	PR4813075	1.9	Saddle 3"	MNPT 3/4"	0.26	
Uponor PP-RCT Transition Saddle, 4" x 1/2", Male NPT, for Outlet Fusion	PR4814050	1.5	Saddle 4"	MNPT 1/2"	0.19	
Uponor PP-RCT Transition Saddle, 4" x 3/4", Male NPT, for Outlet Fusion	PR4814075	1.9	Saddle 4"	MNPT 3/4"	0.27	
Uponor PP-RCT Transition Saddle, 6" x 1/2", Male NPT, for Outlet Fusion	PR4816050	1.5	Saddle 6"	MNPT 1/2"	0.19	
Uponor PP-RCT Transition Saddle, 6" x 3/4", Male NPT, for Outlet Fusion	PR4816075	1.9	Saddle 6"	MNPT 3/4"	0.27	

Part name	Part no.	Codes	Standards	Listings
Uponor PP-RCT transition saddles, male NPT (outlet fusion)	All	CMC IMC UMC	ASTM E84 NSF/ANSI 14 ASTM F2389 CSA B137.11	ICC-ES-PMG 1106 IAPMO-R&T 8358 QAI P321-5 IAPMO K-12775

Installation	Related applications
--------------	----------------------

-	-
---	---

Footnotes	Contact information
-----------	---------------------

-	<table border="0"> <tr> <td>Uponor Inc. 5925 148th Street West Apple Valley, MN 55124 T 800.321.4739 F 952.891.2008</td> <td>Uponor Ltd. 6510 Kennedy Road Mississauga, ON L5T 2X4 T 888.594.7726 F 800.638.9517</td> </tr> </table>	Uponor Inc. 5925 148th Street West Apple Valley, MN 55124 T 800.321.4739 F 952.891.2008	Uponor Ltd. 6510 Kennedy Road Mississauga, ON L5T 2X4 T 888.594.7726 F 800.638.9517
Uponor Inc. 5925 148th Street West Apple Valley, MN 55124 T 800.321.4739 F 952.891.2008	Uponor Ltd. 6510 Kennedy Road Mississauga, ON L5T 2X4 T 888.594.7726 F 800.638.9517		