

Uponor PP-RCT transition saddles, male NPT (outlet fusion)

Project Information

| | |
|--------------------------------|-----------------|
| Job name: | Location: |
| Engineer: | Date submitted: |
| Contractor: | Submitted by: |
| Manufacturer's representative: | Approved by: |

Technical data

| | |
|-------------------------|---|
| Material | PP-RCT |
| Temp/pressure ratings | 73 °F (23 °C) at 340 psi (23.44 bar) 140 °F (60 °C) at 190 psi (13.1 bar) 180 °F (82 °C) at 100 psi (6.9 bar) |
| Prop 65 label required? | Yes |

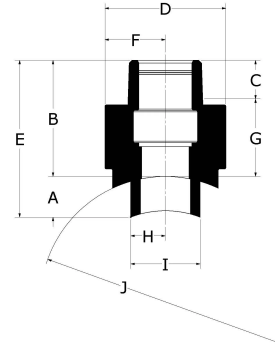

| Part name | Part no. | A [inch] | B [inch] | C [inch] | D [inch] | E [inch] | F [inch] | G [inch] | H [inch] | I [inch] | J [inch] |
|---|-----------|----------|----------|----------|----------|----------|----------|----------|----------|----------|----------|
| Uponor PP-RCT Transition Saddle, 1 1/2" x 1/2", Male NPT, for Outlet Fusion | PR4811550 | 0.4 | 1.819 | 0.534 | 1.496 | 2.219 | 0.748 | 1.285 | 0.492 | 0.984 | 1.969 |
| Uponor PP-RCT Transition Saddle, 1 1/2" x 3/4", Male NPT, for Outlet Fusion | PR4811575 | 0.451 | 1.996 | 0.546 | 1.713 | 2.447 | 0.856 | 1.45 | 0.492 | 0.984 | 1.969 |
| Uponor PP-RCT Transition Saddle, 2" x 1/2", Male NPT, for Outlet Fusion | PR4812050 | 0.415 | 1.819 | 0.54 | 1.496 | 2.234 | 0.748 | 1.279 | 0.492 | 0.984 | 2.48 |
| Uponor PP-RCT Transition Saddle, 2" x 3/4", Male NPT, for Outlet Fusion | PR4812075 | 0.415 | 1.996 | 0.546 | 1.713 | 2.411 | 0.856 | 1.45 | 0.492 | 0.984 | 2.48 |
| Uponor PP-RCT Transition Saddle, 2 1/2" x 1/2", Male NPT, for Outlet Fusion | PR4812550 | 0.442 | 1.819 | 0.54 | 1.496 | 2.261 | 0.748 | 1.279 | 0.492 | 0.984 | 2.953 |
| Uponor PP-RCT Transition Saddle, 2 1/2" x 3/4", Male NPT, for Outlet Fusion | PR4812575 | 0.519 | 1.996 | 0.546 | 1.713 | 2.515 | 0.856 | 1.45 | 0.492 | 0.984 | 2.953 |
| Uponor PP-RCT Transition Saddle, 3" x 1/2", Male NPT, for Outlet Fusion | PR4813050 | 0.489 | 2.308 | 0.54 | 1.496 | 2.308 | 0.748 | 1.279 | 0.492 | 0.984 | 3.543 |
| Uponor PP-RCT Transition Saddle, 3" x 3/4", Male NPT, for Outlet Fusion | PR4813075 | 0.576 | 1.996 | 0.546 | 1.713 | 2.572 | 0.856 | 1.45 | 0.492 | 0.984 | 3.543 |
| Uponor PP-RCT Transition Saddle, 4" x 1/2", Male NPT, for Outlet Fusion | PR4814050 | 0.738 | 1.819 | 0.54 | 1.496 | 2.557 | 0.748 | 1.279 | 0.492 | 0.984 | 4.921 |
| Uponor PP-RCT Transition Saddle, 4" x 3/4", Male NPT, for Outlet Fusion | PR4814075 | 0.738 | 1.996 | 0.546 | 1.713 | 2.734 | 0.856 | 1.45 | 0.492 | 0.984 | 4.921 |
| Uponor PP-RCT Transition Saddle, 6" x 1/2", Male NPT, for Outlet Fusion | PR4816050 | 0.755 | 1.819 | 0.54 | 1.496 | 2.574 | 0.748 | 1.279 | 0.492 | 0.984 | 6.299 |
| Uponor PP-RCT Transition Saddle, 6" x 3/4", Male NPT, for Outlet Fusion | PR4816075 | 0.755 | 1.996 | 0.546 | 1.713 | 2.751 | 0.856 | 1.45 | 0.492 | 0.984 | 6.299 |

| Part name | Part no. | Equivalent length through [ft] | End Type 1 | End Type 2 | Weight per UOM [lbs/UOM] |
|---|-----------|--------------------------------|---------------|------------|--------------------------|
| Uponor PP-RCT Transition Saddle, 1 1/2" x 1/2", Male NPT, for Outlet Fusion | PR4811550 | 1.5 | Saddle 1-1/2" | MNPT 1/2" | 0.18 |
| Uponor PP-RCT Transition Saddle, 1 1/2" x 3/4", Male NPT, for Outlet Fusion | PR4811575 | 1.9 | Saddle 1-1/2" | MNPT 3/4" | 0.26 |
| Uponor PP-RCT Transition Saddle, 2" x 1/2", Male NPT, for Outlet Fusion | PR4812050 | 1.5 | Saddle 2" | MNPT 1/2" | 0.18 |
| Uponor PP-RCT Transition Saddle, 2" x 3/4", Male NPT, for Outlet Fusion | PR4812075 | 1.9 | Saddle 2" | MNPT 3/4" | 0.26 |
| Uponor PP-RCT Transition Saddle, 2 1/2" x 1/2", Male NPT, for Outlet Fusion | PR4812550 | 1.5 | Saddle 2-1/2" | MNPT 1/2" | 0.18 |
| Uponor PP-RCT Transition Saddle, 2 1/2" x 3/4", Male NPT, for Outlet Fusion | PR4812575 | 1.9 | Saddle 2-1/2" | MNPT 3/4" | 0.26 |
| Uponor PP-RCT Transition Saddle, 3" x 1/2", Male NPT, for Outlet Fusion | PR4813050 | 1.5 | Saddle 3" | MNPT 1/2" | 0.18 |

| Outlet Fusion | | | | | | |
|---|-----------|-----|-----------|-----------|------|--|
| Uponor PP-RCT Transition Saddle, 3" x 3/4", Male NPT, for Outlet Fusion | PR4813075 | 1.9 | Saddle 3" | MNPT 3/4" | 0.26 | |
| Uponor PP-RCT Transition Saddle, 4" x 1/2", Male NPT, for Outlet Fusion | PR4814050 | 1.5 | Saddle 4" | MNPT 1/2" | 0.19 | |
| Uponor PP-RCT Transition Saddle, 4" x 3/4", Male NPT, for Outlet Fusion | PR4814075 | 1.9 | Saddle 4" | MNPT 3/4" | 0.27 | |
| Uponor PP-RCT Transition Saddle, 6" x 1/2", Male NPT, for Outlet Fusion | PR4816050 | 1.5 | Saddle 6" | MNPT 1/2" | 0.19 | |
| Uponor PP-RCT Transition Saddle, 6" x 3/4", Male NPT, for Outlet Fusion | PR4816075 | 1.9 | Saddle 6" | MNPT 3/4" | 0.27 | |

| Part name | Part no. | Codes | Standards | Listings |
|--|----------|-------------|---|---|
| Uponor PP-RCT transition saddles, male NPT (outlet fusion) | All | CMC IMC UMC | ASTM E84 NSF/ANSI 14 ASTM F2389 CSA B137.11 | ICC-ES-PMG 1106 IAPMO-R&T 8358 QAI P321-5 IAPMO K-12775 |

| Installation | Related applications |
|--------------|----------------------|
| - | - |

| Footnotes | Contact information | | |
|---|--|---|---|
| - | <table border="0"> <tr> <td>Uponor Inc. 5925 148th Street West Apple Valley, MN 55124 T 800.321.4739 F 952.891.2008</td> <td>Uponor Ltd. 6510 Kennedy Road Mississauga, ON L5T 2X4 T 888.594.7726 F 800.638.9517</td> </tr> </table> | Uponor Inc. 5925 148th Street West Apple Valley, MN 55124 T 800.321.4739 F 952.891.2008 | Uponor Ltd. 6510 Kennedy Road Mississauga, ON L5T 2X4 T 888.594.7726 F 800.638.9517 |
| Uponor Inc. 5925 148th Street West Apple Valley, MN 55124 T 800.321.4739 F 952.891.2008 | Uponor Ltd. 6510 Kennedy Road Mississauga, ON L5T 2X4 T 888.594.7726 F 800.638.9517 | | |