

Uponor ProPEX® lead-free (LF) brass saddle adapters

Project Information

Job name:	Location:
Engineer:	Date submitted:
Contractor:	Submitted by:
Manufacturer's representative:	Approved by:

Technical data

Material	PP-RCT
Temp/pressure ratings	73 °F (23 °C) at 340 psi (23.44 bar)
	140 °F (60 °C) at 190 psi (13.1 bar)
	180 °F (82 °C) at 100 psi (6.9 bar)

Product Information and application use

Use Uponor ProPEX® Lead-Free (LF) Brass Saddle Adapters with Uponor PP-RCT Mechanical Pipe to convey fluid for hydronic heating and cooling or industrial applications and with Uponor PP-RCT Potable Pipe to convey water for potable plumbing applications.

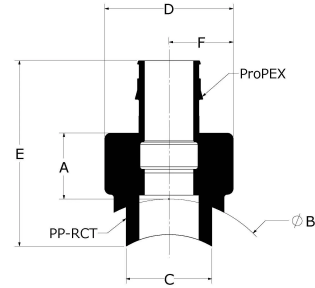

ADAPTER
(FOR SADDLE/OUTLET FUSION)

Part name	Part no.	A [Inch]	B [Inch]	C [Inch]	D [Inch]	E [Inch]	F [Inch]	End Type 1	End Type 2	Prop 65 label required?	Weight per UOM [lbs/UOM]
Uponor ProPEX LF Brass Saddle Adapter, 1 1/2" / 3/4" PP-RCT x 1/2" PEX, for Outlet Fusion	PR4511550	1.083	1.969	0.984	1.665	2.427	0.833	Saddle 1-1/2"	ProPEX 1/2"	No	0.16
Uponor ProPEX LF Brass Saddle Adapter, 2" / 3/4" PP-RCT x 3/4" PEX, for Outlet Fusion	PR4512075	1.177	2.48	0.984	1.665	2.748	0.833	Saddle 2"	ProPEX 3/4"	Yes	0.2

Part name	Part no.	Codes	Standards	Listings
Uponor ProPEX® lead-free (LF) brass saddle adapters	All	UPC IRC IPC NPC of Canada UMC CMC CPC IMC	ASTM F1960 NSF/ANSI/CAN 61 ASTM E84 NSF/ANSI 14 ASTM F2389 CSA B137.11	ICC-ES-PMG 1106 IAPMO-R&T 8358 QAI P321-5 IAPMO K-12775

Installation

For the PEX side, use the appropriate ProPEX ring and fitting. For the PP-RCT side, use approved fusion connection methods. For additional information, refer to the Uponor PP-RCT manual.

Related applications

- Hydronic heating and cooling systems
- Industrial
- Domestic water systems

Footnotes

Contact information

Uponor Inc.
5925 148th Street West
Apple Valley, MN 55124
T 800.321.4739
F 952.891.2008

Uponor Ltd.
6510 Kennedy Road
Mississauga, ON L5T 2X4
T 888.594.7726
F 800.638.9517