

# Copper valved manifold accessories - ProPEX ball and balancing valves



## Project Information

|                                |                 |
|--------------------------------|-----------------|
| Job name:                      | Location:       |
| Engineer:                      | Date submitted: |
| Contractor:                    | Submitted by:   |
| Manufacturer's representative: | Approved by:    |

## Technical data

|                         |  |
|-------------------------|--|
| Material                | Brass  |
| Subcomponent Material   | CA 360 Brass   |
| End type 2              | Sweat 3/4"   |
| Cold working pressure   | 249.5 psi  |
| Temp/pressure ratings   | 73 °F (23 °C) at 160 psi (11 bar)<br>180 °F (82 °C) at 100 psi (6.9 bar)<br>200 °F (93 °C) at 80 psi (5.5 bar) |
| Prop 65 label required? | Yes  |

## Product information and application use

The Uponor ProPEX® Ball and Balance Valve products feature in-line isolation valves.

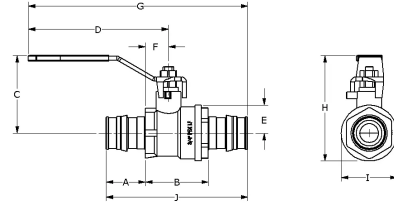

| Part name   | Part no. | A [inch] | B [inch] | C [inch] | D [inch] | E [inch] | F [inch] | G [inch] | H [inch] | I [inch] | J [inch] |
|---|----------|----------|----------|----------|----------|----------|----------|----------|----------|----------|----------|
| ProPEX Ball and Balancing Valve, 5/8" PEX x 3/4" Copper Adapter | Q5906375 | 0.866    | 2.648    | 1.301    | 0.913    | 0.5      | 0.683    | 3.743    | 2.133    | 1        | 4.415    |
| ProPEX Ball and Balancing Valve, 3/4" PEX x 3/4" Copper Adapter | Q5907575 | 0.866    | 2.65     | 1.301    | 0.913    | 0.5      | 0.683    | 3.746    | 2.133    | 1        | 4.417    |

| Part name   | Part no. | Cv  | End Type 1  | Weight per UOM [lbs/UOM] |
|---|----------|-----|-------------|--------------------------|
| ProPEX Ball and Balancing Valve, 5/8" PEX x 3/4" Copper Adapter | Q5906375 | 6.6 | ProPEX 5/8" | 0.8                      |
| ProPEX Ball and Balancing Valve, 3/4" PEX x 3/4" Copper Adapter | Q5907575 | 6.7 | ProPEX 3/4" | 0.8                      |

| Part name   | Part no. | Codes | Standards            | Listings |
|---|----------|-------|----------------------|----------|
| Copper valved manifold accessories - ProPEX ball and balancing valves | All      | -     | ASTM F1960 ASTM F877 | -        |

## Installation

Install valve according to local building code. Do not dismantle. If soldering, aim flame away from fitting. Remove safety cap. Using Allen key or hex wrench, fully close memory spindle by performing a complete clockwise turn and open it the required number of turns from the closed position. For balancing of manifolds, open the memory spindle fully for the longest loop and balance the other loops by setting their memory spindles according to their loop lengths relative to the longest loop. Refer to the Radiant Floor Installation Handbook for additional information.

## Related applications

- PEX-a Plumbing Systems
- Radiant Heating and Cooling Systems
- Permafrost Protection Systems
- Turf Conditioning Systems

## Notes

Cv (Q5906375):  
6.60  
Cv (Q5907575): 6.70

## Footnotes

-

## Contact information

Uponor Inc.  
5925 148th Street West  
Apple Valley, MN 55124  
T 800.321.4739  
F 952.891.2008

Uponor Ltd.  
6510 Kennedy Road  
Mississauga, ON L5T 2X4  
T 888.594.7726  
F 800.638.9517