

ProPEX baseboard elbows

Project Information

| | |
|--------------------------------|-----------------|
| Job name: | Location: |
| Engineer: | Date submitted: |
| Contractor: | Submitted by: |
| Manufacturer's representative: | Approved by: |

Technical data

| | |
|-------------------------|--|
| Material | Brass |
| End type 2 | Sweat 3/4" |
| Temp/pressure ratings | 73 °F (23 °C) at 160 psi (11 bar) 180 °F (82 °C) at 100 psi (6.9 bar) 200 °F (93 °C) at 80 psi (5.5 bar) |
| Prop 65 label required? | Yes |

Product information and application use

The Uponor ProPEX® Baseboard elbow Copper Adapter can be used in any heating system applying the use of fin-tube baseboard or unit-type heaters. One end of the tee adapter features a ProPEX fitting for an easy transition from copper pipe to Wirsbo hePEXTM tubing or Uponor AquaPEX® tubing.

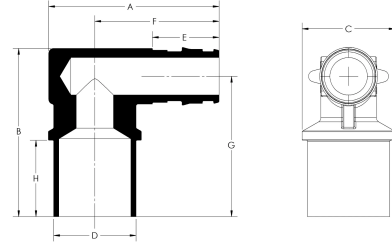

| Part name | Part no. | A [inch] | B [inch] | C [inch] | D [inch] | E [inch] | F [inch] | G [inch] | H [inch] | End Type 1 | Weight per UOM [lbs/UOM] |
|--|----------|----------|----------|----------|----------|----------|----------|----------|----------|-------------|--------------------------|
| ProPEX Baseboard Elbow, 1/2" PEX x 3/4" Copper Adapter | Q4385075 | 1.81 | 1.796 | 0.987 | 0.872 | 0.709 | 1.32 | 1.489 | 0.75 | ProPEX 1/2" | - |
| ProPEX Baseboard Elbow, 5/8" PEX x 3/4" Copper Adapter | Q4386375 | 1.861 | 0.372 | 1.489 | 0.614 | 0.866 | 1.974 | 1.04 | 0.75 | ProPEX 5/8" | 0.17 |
| ProPEX Baseboard Elbow, 3/4" PEX x 3/4" Copper Adapter | Q4387575 | 1.924 | 0.435 | 1.489 | 0.615 | 0.945 | 2.054 | 1.2 | 0.75 | ProPEX 3/4" | 0.36 |
| ProPEX Baseboard Elbow, 1/2" PEX x 3/4" Copper Fitting Adapter | Q4375075 | 1.81 | 1.796 | 0.987 | 0.869 | 0.709 | 1.32 | 1.489 | 0.81 | ProPEX 1/2" | 0.16 |
| ProPEX Baseboard Elbow, 5/8" PEX x 3/4" Copper Fitting Adapter | Q4376375 | 2.03 | 1.861 | 1.04 | 0.874 | 0.866 | 1.48 | 1.489 | 0.81 | ProPEX 5/8" | 0.19 |
| ProPEX Baseboard Elbow, 3/4" PEX x 3/4" Copper Fitting Adapter | Q4377575 | 2.13 | 1.924 | 1.2 | 0.868 | 0.945 | 1.56 | 1.489 | 0.81 | ProPEX 3/4" | - |

| Part name | Part no. | Codes | Standards | Listings |
|-------------------------|----------|-------|---------------------------------|--------------------------------|
| ProPEX baseboard elbows | All | IMC | ASTM F1960 CSA B137.5 ASTM F877 | IAPMO-ES ICC-ES-PMG cNSFus-rfh |

In addition, the following parts have additional codes, standards, or listings:

| | | |
|--|----------|-------------|
| ProPEX Baseboard Elbow, 1/2" PEX x 3/4" Copper Adapter | Q4385075 | NSF/ANSI 14 |
| ProPEX Baseboard Elbow, 5/8" PEX x 3/4" Copper Adapter | Q4386375 | NSF-14 |
| ProPEX Baseboard Elbow, 3/4" PEX x 3/4" Copper Adapter | Q4387575 | NSF-14 |
| ProPEX Baseboard Elbow, 1/2" PEX x 3/4" Copper Fitting Adapter | Q4375075 | NSF/ANSI 14 |
| ProPEX Baseboard Elbow, 5/8" PEX x 3/4" Copper Fitting Adapter | Q4376375 | NSF/ANSI 14 |
| ProPEX Baseboard Elbow, 3/4" PEX x 3/4" Copper Fitting Adapter | Q4377575 | NSF/ANSI 14 |

Installation

Use the appropriate ProPEX Ring for tubing (sold separately). Do not solder within 18 inches of the ProPEX connection. Refer to the Uponor Radiant Floor Heating Installation Handbook for additional information.

Related applications

- Radiant Heating and Cooling Systems
- Permafrost Protection Systems
- Turf Conditioning Systems
- AquaSAFE™ Fire Safety Systems

Uponor Inc.
5925 148th Street West
Apple Valley, MN 55124
T 800.321.4739
F 952.891.2008

Uponor Ltd.
6510 Kennedy Road
Mississauga, ON L5T 2X4
T 888.594.7726
F 800.638.9517
