

ProPEX lead-free (LF) brass copper press adapters

Project Information

Job name:	Location:
Engineer:	Date submitted:
Contractor:	Submitted by:
Manufacturer's representative:	Approved by:

Technical data

Material	LF Brass
Temp/pressure ratings	73 °F (23 °C) at 160 psi (11 bar) 180 °F (82 °C) at 100 psi (6.9 bar) 200 °F (93 °C) at 80 psi (5.5 bar)
Prop 65 label required?	Yes

Product information and application use

Uponor ProPEX® lead-free (LF) brass copper press adapters transition copper pipe to Uponor PEX. The adapters are approved for use in hot and cold potable water and hydronic heating and cooling systems.

Note: Temperature and pressure ratings stated are hydrostatic ratings. For domestic hot-water (DHW) and DHW recirculation installations, operating conditions should not exceed 140°F (60°C) at 80 psi (5.5 bar) in accordance with ASTM F2023. For additional information regarding application-specific temperature and pressure ratings, refer to the Uponor PEX Piping Systems Design and Installation Manual.

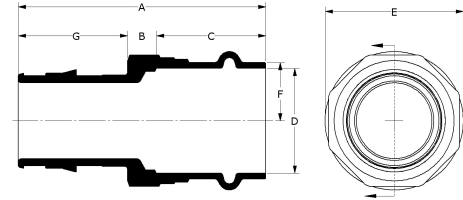

Part name	Part no.	A [inch]	B [inch]	C [inch]	D [inch]	E [inch]	F [inch]	G [inch]	Cv	Equivalent length through [ft]	End Type 1
ProPEX LF Brass Copper Press Adapter, 1/2" PEX x 1/2" Copper	LFP4515050	2.185	0.571	0.906	0.634	0.965	0.38	0.709	5.7	2	ProPEX 1/2"
ProPEX LF Brass Copper Press Adapter, 3/4" PEX x 3/4" Copper	LFP4517575	2.52	0.709	0.866	0.886	1.236	0.502	0.945	13.4	2.1	ProPEX 3/4"
ProPEX LF Brass Copper Press Adapter, 1" PEX x 1" Copper	LFP4511010	2.677	0.315	1.181	1.134	1.516	0.63	1.181	22.1	2.4	ProPEX 1"
ProPEX LF Brass Copper Press Adapter, 1 1/4" PEX x 1 1/4" Copper	LFP4511313	3.051	0.583	1.024	1.39	1.89	0.76	1.445	34	3.9	ProPEX 1-1/4"
ProPEX LF Brass Copper Press Adapter, 1 1/2" PEX x 1 1/2" Copper	LFP4511515	3.602	0.559	1.339	1.64	2.193	0.902	1.705	45.5	4.3	ProPEX 1-1/2"
ProPEX LF Brass Copper Press Adapter, 2" PEX x 2" Copper	LFP4512020	4.646	0.492	2.008	2.138	2.717	1.152	2.146	83.6	5.3	ProPEX 2"
ProPEX LF Brass Copper Press Adapter, 2 1/2" PEX x 2 1/2" Copper	LFP4512525	5.217	0.654	1.732	2.642	3.366	1.585	2.831	136.2	6.89	ProPEX 2-1/2"
ProPEX LF Brass Copper Press Adapter, 3" PEX x 3" Copper	LFP4513030	6.142	0.831	1.929	3.15	3.799	1.844	3.382	189.1	8.79	ProPEX 3"

Part name	Part no.	End Type 2	Equivalent length branch [ft]	Weight per UOM [lbs/UOM]
ProPEX LF Brass Copper Press Adapter, 1/2" PEX x 1/2" Copper	LFP4515050	Copper Press 1/2"	-	0.1
ProPEX LF Brass Copper Press Adapter, 3/4" PEX x 3/4" Copper	LFP4517575	Copper Press 3/4"	0.99	0.18
ProPEX LF Brass Copper Press Adapter, 1" PEX x 1" Copper	LFP4511010	Copper Press 1"	-	0.28
ProPEX LF Brass Copper Press Adapter, 1 1/4" PEX x 1 1/4" Copper	LFP4511313	Copper Press 1-1/4"	-	0.48
ProPEX LF Brass Copper Press Adapter, 1 1/2" PEX x 1 1/2" Copper	LFP4511515	Copper Press 1-1/2"	-	0.74
ProPEX LF Brass Copper Press Adapter, 2" PEX x 2" Copper	LFP4512020	Copper Press 2"	-	1.3
ProPEX LF Brass Copper Press Adapter, 2 1/2" PEX x 2 1/2" Copper	LFP4512525	Copper Press 2-1/2"	-	2.38
ProPEX LF Brass Copper Press Adapter, 3" PEX x 3" Copper	LFP4513030	Copper Press 3"	-	3.42

Part name	Part no.	Codes	Standards	Listings
ProPEX lead-free (LF) brass copper press adapters	All	UPC IBC IRC IPC NPC of Canada UMC NSPC IMC	ASME B16.51 IAPMO PS 117 ASTM F877 ICC-ES LC1002 ASTM F1960 CSA B137.5	IAPMO-ES cNSFus-pw-G U.P.Code ICC-PMG-1412
In addition, the following parts have additional codes, standards, or listings:				
ProPEX LF Brass Copper Press Adapter, 1/2" PEX x 1/2" Copper	LFP4515050		NSF/ANSI/CAN 372 NSF/ANSI/CAN 61 NSF/ANSI 14	
ProPEX LF Brass Copper Press Adapter, 3/4" PEX x 3/4" Copper	LFP4517575		NSF/ANSI/CAN 372 NSF/ANSI/CAN 61 NSF/ANSI 14	
ProPEX LF Brass Copper Press Adapter, 1" PEX x 1" Copper	LFP4511010		NSF-372 NSF-61 NSF-14	
ProPEX LF Brass Copper Press Adapter, 1 1/4" PEX x 1 1/4" Copper	LFP4511313		NSF/ANSI/CAN 372 NSF/ANSI/CAN 61 NSF/ANSI 14	
ProPEX LF Brass Copper Press Adapter, 1 1/2" PEX x 1 1/2" Copper	LFP4511515		NSF/ANSI/CAN 372 NSF/ANSI/CAN 61 NSF/ANSI 14	
ProPEX LF Brass Copper Press Adapter, 2" PEX x 2" Copper	LFP4512020		NSF-372 NSF-61 NSF-14	
ProPEX LF Brass Copper Press Adapter, 2 1/2" PEX x 2 1/2" Copper	LFP4512525		NSF-372 NSF-61 NSF-14	
ProPEX LF Brass Copper Press Adapter, 3" PEX x 3" Copper	LFP4513030		NSF/ANSI/CAN 372 NSF/ANSI/CAN 61 NSF/ANSI 14	

Installation	Related applications
Use ProPEX tool and ProPEX rings (sold separately) for connecting the PEX pipe. For more information, refer to the Uponor Piping Pocket Guide. Follow press tool manufacturers' install instructions for the male or female press end of the adapter.	<ul style="list-style-type: none"> PEX-a Plumbing Systems Hydronic heating and cooling systems Permafrost Protection Systems

Footnotes	Contact information		
-	<table> <tr> <td>Uponor Inc. 5925 148th Street West Apple Valley, MN 55124 T 800.321.4739 F 952.891.2008</td> <td>Uponor Ltd. 6510 Kennedy Road Mississauga, ON L5T 2X4 T 888.594.7726 F 800.638.9517</td> </tr> </table>	Uponor Inc. 5925 148th Street West Apple Valley, MN 55124 T 800.321.4739 F 952.891.2008	Uponor Ltd. 6510 Kennedy Road Mississauga, ON L5T 2X4 T 888.594.7726 F 800.638.9517
Uponor Inc. 5925 148th Street West Apple Valley, MN 55124 T 800.321.4739 F 952.891.2008	Uponor Ltd. 6510 Kennedy Road Mississauga, ON L5T 2X4 T 888.594.7726 F 800.638.9517		