

# ProPEX lead-free (LF) brass to copper ball valves

## Project information

Job name:	Location:
Engineer:	Date submitted:
Contractor:	Submitted by:
Manufacturer's representative:	Approved by:

## Technical data

Material	LF Brass
Cold working pressure	200.2 psi
Temp/pressure ratings	73 °F (23 °C) at 160 psi (11 bar) 180 °F (82 °C) at 100 psi (6.9 bar) 200 °F (93 °C) at 80 psi (5.5 bar) 210 °F (99 °C) at 149 psi (10.3 bar)
Prop 65 label required?	Yes

## Product information and application use

Uponor ProPEX® lead-free (LF) brass ball valves transition brass to copper and feature inline isolation valves. These valves are not compatible with applications using glycol.

Note: Temperature and pressure ratings stated are hydrostatic ratings. For domestic hot-water (DHW) and DHW recirculation installations, operating conditions should not exceed 140°F (60°C) at 80 psi (5.5 bar) in accordance with ASTM F2023. For additional information regarding application-specific temperature and pressure ratings, refer to the Uponor PEX Piping Systems Design and Installation Manual.

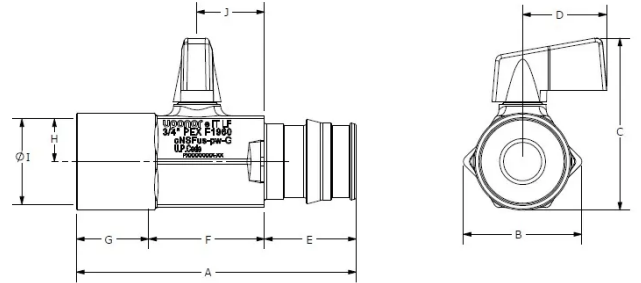

Part name	Part no.	A [inch]	B [inch]	C [inch]	D [inch]	E [inch]	F [inch]	G [inch]	H [inch]	I [inch]	J [inch]
ProPEX LF Brass Ball Valve, 1/2" PEX x 1/2" Copper Adapter	LF4805050	2.098	0.955	1.504	0.866	0.709	0.886	0.504	0.315	0.629	0.539
ProPEX LF Brass Ball Valve, 3/4" PEX x 3/4" Copper Adapter	LF4807575	2.882	1.22	1.769	0.866	0.945	1.181	0.756	0.439	0.879	0.693

Part name	Part no.	K [inch]	Cv	End Type 1	End Type 2	Weight per UOM [lbs/UOM]
ProPEX LF Brass Ball Valve, 1/2" PEX x 1/2" Copper Adapter	LF4805050	-	3.9	ProPEX 1/2"	Sweat 1/2"	0.2
ProPEX LF Brass Ball Valve, 3/4" PEX x 3/4" Copper Adapter	LF4807575	-	6.6	ProPEX 3/4"	Sweat 3/4"	0.39

Part name	Part no.	Codes	Standards	Listings
ProPEX lead-free (LF) brass to copper ball valves	All	UPC IRC IPC NPC of Canada	NSF/ANSI/CAN 372 ASTM F877 NSF/ANSI 359 ASTM F1960 CSA B137.5 NSF/ANSI/CAN 61 NSF/ANSI 14	cNSFus-pw-G U.P.Code

In addition, the following parts have additional codes, standards, or listings:

ProPEX LF Brass Ball Valve, 3/4" PEX x 3/4" Copper Adapter	LF4807575
--	-----------

## Installation

Install valve according to local building code. Do not dismantle. If soldering, aim flame away from the fitting. For more information, refer to the Uponor AquaPEX® Professional Plumbing Installation Guide or the Radiant Floor Heating Installation Handbook.

## Related applications

- PEX-a Plumbing Systems
- Radiant Heating and Cooling Systems
- Permafrost Protection Systems
- Turf Conditioning Systems

## Footnotes

## Contact information

Uponor Inc.  
5925 148th Street West  
Apple Valley, MN 55124  
T 800.321.4739  
F 952.891.2008

Uponor Ltd.  
6510 Kennedy Road  
Mississauga, ON L5T 2X4  
T 888.594.7726  
F 800.638.9517