

# ProPEX lead-free (LF) brass to copper ball valves

## Project information

|                                |                 |
|--------------------------------|-----------------|
| Job name:                      | Location:       |
| Engineer:                      | Date submitted: |
| Contractor:                    | Submitted by:   |
| Manufacturer's representative: | Approved by:    |

## Technical data

|                         |  |
|-------------------------|--|
| Material                | LF Brass   |
| Cold working pressure   | 200.2 psi  |
| Temp/pressure ratings   | 73 °F (23 °C) at 160 psi (11 bar)<br>180 °F (82 °C) at 100 psi (6.9 bar)<br>200 °F (93 °C) at 80 psi (5.5 bar)<br>210 °F (99 °C) at 149 psi (10.3 bar) |
| Prop 65 label required? | Yes  |

## Product information and application use

Uponor ProPEX® lead-free (LF) brass ball valves transition brass to copper and feature inline isolation valves. These valves are not compatible with applications using glycol.

Note: Temperature and pressure ratings stated are hydrostatic ratings. For domestic hot-water (DHW) and DHW recirculation installations, operating conditions should not exceed 140°F (60°C) at 80 psi (5.5 bar) in accordance with ASTM F2023. For additional information regarding application-specific temperature and pressure ratings, refer to the Uponor PEX Piping Systems Design and Installation Manual.

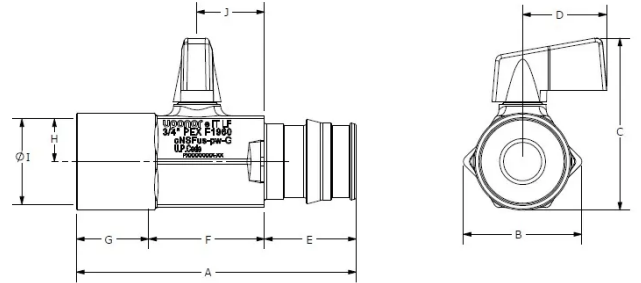

| Part name  | Part no.  | A [inch] | B [inch] | C [inch] | D [inch] | E [inch] | F [inch] | G [inch] | H [inch] | I [inch] | J [inch] |
|--|-----------|----------|----------|----------|----------|----------|----------|----------|----------|----------|----------|
| ProPEX LF Brass Ball Valve, 1/2" PEX x 1/2" Copper Adapter | LF4805050 | 2.098    | 0.955    | 1.504    | 0.866    | 0.709    | 0.886    | 0.504    | 0.315    | 0.629    | 0.539    |
| ProPEX LF Brass Ball Valve, 3/4" PEX x 3/4" Copper Adapter | LF4807575 | 2.882    | 1.22     | 1.769    | 0.866    | 0.945    | 1.181    | 0.756    | 0.439    | 0.879    | 0.693    |

| Part name  | Part no.  | K [inch] | Cv  | End Type 1  | End Type 2 | Weight per UOM [lbs/UOM] |
|--|-----------|----------|-----|-------------|------------|--------------------------|
| ProPEX LF Brass Ball Valve, 1/2" PEX x 1/2" Copper Adapter | LF4805050 | -        | 3.9 | ProPEX 1/2" | Sweat 1/2" | 0.2                      |
| ProPEX LF Brass Ball Valve, 3/4" PEX x 3/4" Copper Adapter | LF4807575 | -        | 6.6 | ProPEX 3/4" | Sweat 3/4" | 0.39                     |

| Part name   | Part no. | Codes                     | Standards   | Listings             |
|---|----------|---------------------------|---|----------------------|
| ProPEX lead-free (LF) brass to copper ball valves | All      | UPC IRC IPC NPC of Canada | NSF/ANSI/CAN 372 ASTM F877 NSF/ANSI 359 ASTM F1960 CSA B137.5 NSF/ANSI/CAN 61 NSF/ANSI 14 | cNSFus-pw-G U.P.Code |

In addition, the following parts have additional codes, standards, or listings:

|  |           |
|--|-----------|
| ProPEX LF Brass Ball Valve, 3/4" PEX x 3/4" Copper Adapter | LF4807575 |
|--|-----------|

## Installation

Install valve according to local building code. Do not dismantle. If soldering, aim flame away from the fitting. For more information, refer to the Uponor AquaPEX® Professional Plumbing Installation Guide or the Radiant Floor Heating Installation Handbook.

## Related applications

- PEX-a Plumbing Systems
- Radiant Heating and Cooling Systems
- Permafrost Protection Systems
- Turf Conditioning Systems

## Footnotes

## Contact information

Uponor Inc.  
5925 148th Street West  
Apple Valley, MN 55124  
T 800.321.4739  
F 952.891.2008

Uponor Ltd.  
6510 Kennedy Road  
Mississauga, ON L5T 2X4  
T 888.594.7726  
F 800.638.9517