

# QS-style compression manifold fitting assemblies

## Project Information

|                                |                 |
|--------------------------------|-----------------|
| Job name:                      | Location:       |
| Engineer:                      | Date submitted: |
| Contractor:                    | Submitted by:   |
| Manufacturer's representative: | Approved by:    |

## Technical data

|                         |  |
|-------------------------|--|
| Material                | Brass  |
| Temp/pressure ratings   | 73 °F (23 °C) at 160 psi (11 bar)<br>180 °F (82 °C) at 100 psi (6.9 bar)<br>200 °F (93 °C) at 80 psi (5.5 bar) |
| Prop 65 label required? | Yes  |

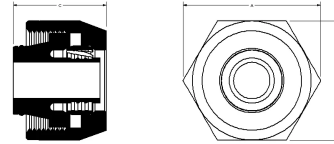

## Product information and application use

The Uponor R20 Compression Fitting Assembly threads onto manifold loop outlets. This R20 QS (Quick Seal) compression fitting connects Wirsbo hePEX™ or Uponor AquaPEX® tubing to the manifold in radiant heating applications and is designed for 5/16", 3/8", 1/2" or 5/8" tubing. The R25 QS compression fitting does not directly thread onto the manifold, but onto other R25 connections, and is designed for use with 5/8" and 3/4" tubing only.

| Part name  | Part no. | A [inch] | B [inch] | C [inch] | Subcomponent Material             | End Type 1       | End Type 2     | D [inch] | Cv   | Equivalent length through [ft] | Weight per UOM [lbs/UOM] |
|--|----------|----------|----------|----------|-----------------------------------|------------------|----------------|----------|------|--------------------------------|--------------------------|
| 5/16" QS-style Compression Fitting Assembly, R20 thread                        | A4020313 | 1.372    | 1.187    | 1.057    | Fitting: CA 360 Brass             | QS 5/16"         | ISO 228-G 3/4" | -        | -    | -                              | 0.26                     |
| 3/8" QS-style Compression Fitting Assembly, R20 thread                         | A4020375 | 1.372    | 1.187    | 1.004    | Fitting: CA 360 Brass             | QS 3/8"          | ISO 228-G 3/4" | -        | -    | -                              | 0.23                     |
| 1/2" QS-style Compression Fitting Assembly, R20 thread                         | A4020500 | 1.372    | 1.187    | 1.004    | Fitting: CA 360 Brass             | QS 1/2"          | ISO 228-G 3/4" | -        | -    | -                              | 0.21                     |
| 5/8" QS-style Compression Fitting Assembly, R20 thread                         | A4020625 | 1.372    | 1.187    | 1.004    | Fitting: CA 360 Brass             | QS 5/8"          | ISO 228-G 3/4" | -        | -    | -                              | 0.19                     |
| 5/8" QS-style Compression Fitting Assembly, R25 thread                         | A4030625 | 1.729    | 1.5      | 1.064    | Fitting: CA 360 Brass             | QS 5/8"          | ISO 228-G 1"   | -        | -    | -                              | 0.4                      |
| 3/4" QS-style Compression Fitting Assembly, R25 thread                         | A4020750 | 1.66     | 1.5      | 1.099    | Fitting: UNS C36000<br>UNS C37700 | QS 3/4"          | ISO 228-G 1"   | -        | -    | -                              | 0.33                     |
| 5/8" QS-style Compression Fitting Assembly for Commercial Manifold, R25 thread | A4050625 | 1.729    | 1.5      | 1.217    | -                                 | Compression 5/8" | ISO 228-G 1"   | -        | 6.58 | 4.56                           | 0.4                      |
| 3/4" QS-style Compression Fitting Assembly for Commercial Manifold, R25 thread | A4050750 | 1.66     | 1.5      | 1.221    | -                                 | Compression 3/4" | ISO 228-G 1"   | -        | 8.08 | 7.12                           | 0.4                      |

| Part name   | Part no. | Codes                     | Standards                     | Listings                   |
|---|----------|---------------------------|-------------------------------|----------------------------|
| QS-style compression manifold fitting assemblies                                | All      | IMC IRC NBC of Canada UMC | CSA B137.5 ASTM F877          | cNSFus-rfh ICC-ES-PMG 1012 |
| In addition, the following parts have additional codes, standards, or listings: |          |                           |                               |                            |
| 5/16" QS-style Compression Fitting Assembly, R20 thread                         | A4020313 |                           | R32: ISO 228-G 3/4"           |                            |
| 3/8" QS-style Compression Fitting Assembly, R20 thread                          | A4020375 |                           | R32: ISO 228-G 3/4"           |                            |
| 1/2" QS-style Compression Fitting Assembly, R20 thread                          | A4020500 |                           | R32: ISO 228-G 3/4"           |                            |
| 5/8" QS-style Compression Fitting Assembly, R20 thread                          | A4020625 |                           | R32: ISO 228-G 3/4"           |                            |
| 5/8" QS-style Compression Fitting Assembly, R25 thread                          | A4030625 |                           | R32: ISO 228-G 1"             |                            |
| 3/4" QS-style Compression Fitting Assembly, R25 thread                          | A4020750 |                           | R32: ISO 228-G 1"             |                            |
| 5/8" QS-style Compression Fitting Assembly for Commercial Manifold, R25 thread  | A4050625 |                           | R25: ISO 228-G 1" NSF/ANSI 14 | IAPMO-ES ICC PMG 1006      |
| 3/4" QS-style Compression Fitting Assembly for Commercial Manifold, R25 thread  | A4050750 |                           | R25: ISO 228-G 1" NSF/ANSI 14 | IAPMO-ES ICC PMG 1006      |

| Installation   | Related applications  |
|--|---|
| The R20-threaded Compression Fitting connects to Uponor manifold loop outlets. The compression end enables direct connection to Wirsbo hePEX tubing. Use the R25-threaded Compression Fitting for other R25 connections. For more information, refer to the Radiant Floor Heating Installation Handbook. | <ul style="list-style-type: none"> <li>Radiant Heating and Cooling Systems</li> <li>Permafrost Protection Systems</li> <li>Turf Conditioning Systems</li> </ul> |

| Footnotes | Contact information   |
|-----------|---|
| -         | <p>Uponor Inc.<br/>5925 148th Street West<br/>Apple Valley, MN 55124<br/>T 800.321.4739<br/>F 952.891.2008</p> <p>Uponor Ltd.<br/>6510 Kennedy Road<br/>Mississauga, ON L5T 2X4<br/>T 888.594.7726<br/>F 800.638.9517</p> |