

Uponor Wipex swivel union G1 1/4

1045457

- Rotatable double nipple
- Cylindric thread G" for O-ring sealing
- 6 bar, SDR 11 / 10 bar, SDR 7,4
- DR = dezincification resistance brass

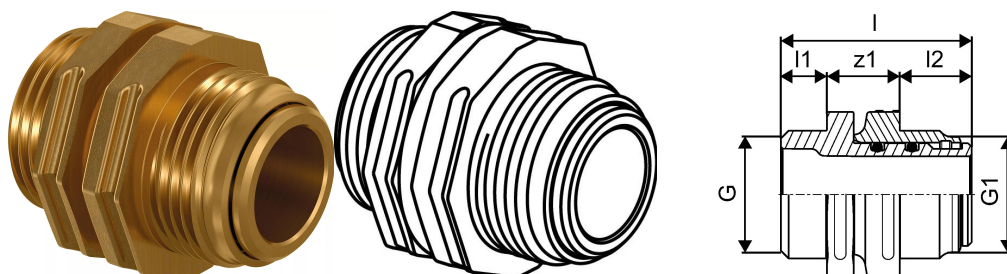

About Uponor Wipex swivel union

Specification

- Wipex fittings in corrosion-resistant brass, dezincification based on EN ISO 6509 with stainless steel screw.
- O-ring sealing between Wipex coupling and base fitting connectors
- Bolt set for couplers include a hex socket bolt in stainless steel and the nut as well as washer from brass
- Pre-open sleeve design with assembled support part for the dimension 63-110mm.

Application

- Fittings for pipe systems Thermo, Aqua, Quattro, Supra, Supra PLUS and Supra Standard
- Connection of PE and PE-Xa medium pipe to couplers with cylindrical inch male thread
- Max. operating temperature 95°C

Certification

- Approvals should be checked by local responsible person

Uponor Wipex swivel union G1 1/4

1045457

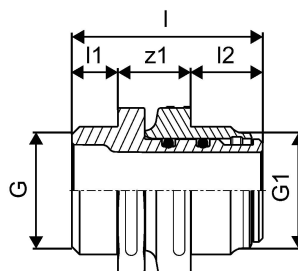
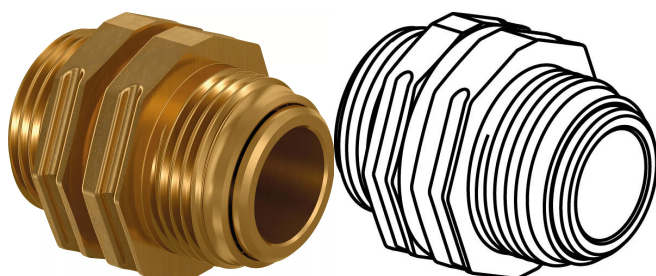

Technical data

Item no EAN	7331541201773
Item no GTIN	07331541201773
Item no VVS	087534010
RSK no.	2410703
Item no NRF	8360803
Item no LVI	1937002
Item (unit of measurement)	pce
Length (l)	58 mm
Length (l1)	16 mm
Length (l2)	21 mm
Packaging Quantity 1	1
Packaging Quantity 3	15
Packaging Quantity 4	900
Packaging GTIN PL1	06414905459513
Packaging GTIN PL3	06414905448296
Packaging GTIN PL4	06414905492749
Item Unit Length	50
Item Unit Height	60
Item Unit Weight	0,476
Item Unit Width	50

Technical documents

Download documents here

UK

T +44 (0)1923 927000
E enquiries.uk@uponor.com

www.uponor.com/en-gb