

Uponor RS coupling RS2-RS2

1029144

- Made of tin-plated brass
- Base part for all RS2 or RS3 inserts including 2 lock pins.

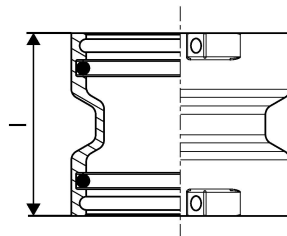
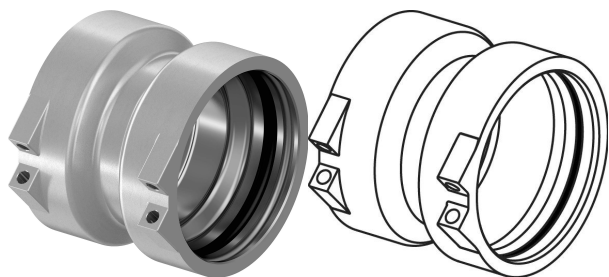

Uponor RS coupling RS2-RS2

1029144

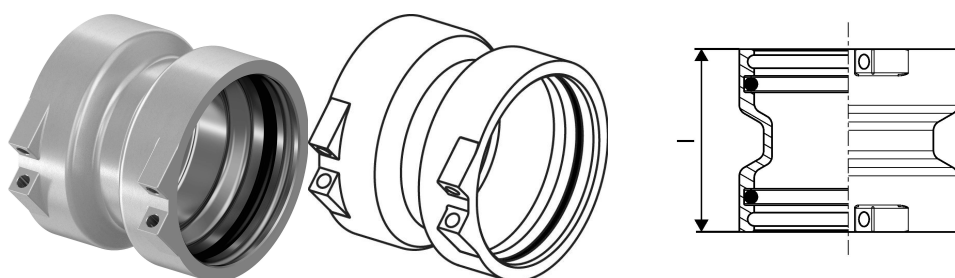

Technical data

Item no EAN	4021598106819
Item no GTIN	04021598106819
Item no VVS	045456112
RSK no.	1899480
Item no NRF	5071218
Item no LVI	1720809
Item (unit of measurement)	pce
Length (l)	58 mm
Packaging Quantity 1	1
Packaging Quantity 4	480
Packaging GTIN PL1	06414905263851
Packaging GTIN PL4	06414905263868
Item Unit Length	70
Item Unit Height	60
Item Unit Weight	0,351
Item Unit Width	70

Uponor UK

Blackmor Lane The Pavilion
WD18 8GA, Watford
UK

T +44 (0)1923 927000
E enquiries.uk@uponor.com

www.uponor.com/en-gb