

Uponor RS elbow 45deg RS2-RS2

1029140

- Made of tin-plated brass
- Base part for all RS2 or RS3 inserts including 2 lock pins.

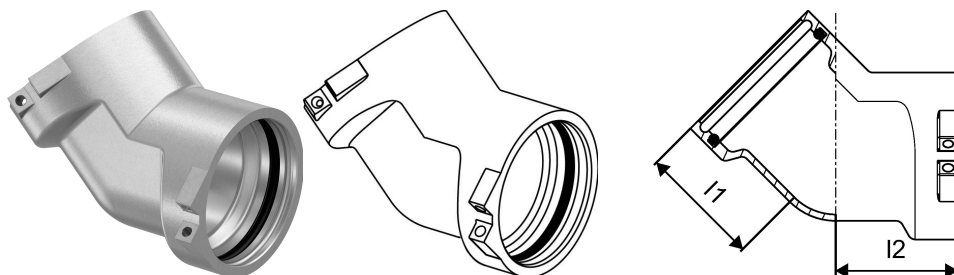

Uponor RS elbow 45deg RS2-RS2

1029140

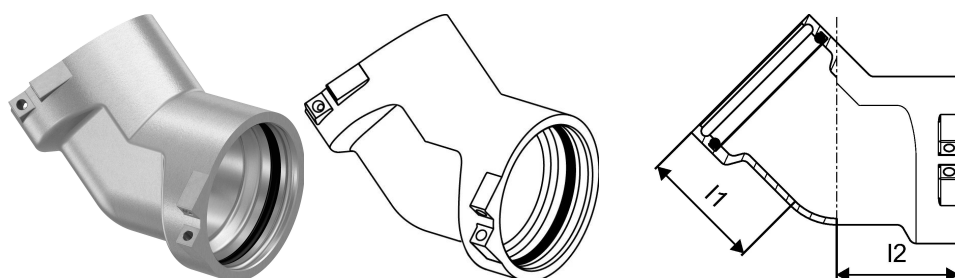

Technical data

| | |
|----------------------------|----------------|
| Item no EAN | 4021598106772 |
| Item no GTIN | 04021598106772 |
| Item no VVS | 045454112 |
| RSK no. | 1896580 |
| Item no NRF | 5071223 |
| Item no LVI | 1720813 |
| Item (unit of measurement) | pce |
| Length (l1) | 51 mm |
| Length (l2) | 51 mm |
| Packaging Quantity 1 | 1 |
| Packaging GTIN PL1 | 06414905439478 |
| Packaging GTIN PL4 | 06414905491384 |
| Item Unit Length | 116 |
| Item Unit Height | 75 |
| Item Unit Weight | 0,682 |
| Item Unit Width | 90 |

Uponor UK

Blackmor Lane The Pavilion
WD18 8GA, Watford
UK

T +44 (0)1923 927000
E enquiries.uk@uponor.com

www.uponor.com/en-gb