

# ProPEX lead-free (LF) brass residential ball valves

## Project information

|                                |                 |
|--------------------------------|-----------------|
| Job name:                      | Location:       |
| Engineer:                      | Date submitted: |
| Contractor:                    | Submitted by:   |
| Manufacturer's representative: | Approved by:    |

## Technical data

|                         |                                      |
|-------------------------|--------------------------------------|
| Material                | LF Brass                             |
| Temp/pressure ratings   | 200 °F (93 °C) at 200 psi (13.8 bar) |
| Prop 65 label required? | Yes                                  |

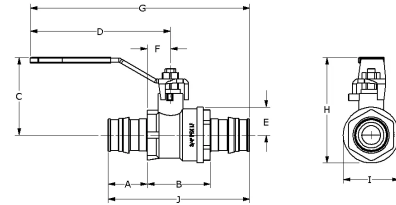

| Part name  | Part no.   | A [inch] | B [inch] | C [inch] | D [inch] | E [inch] | F [inch] | G [inch] | H [inch] | I [inch] | J [inch] |
|--|------------|----------|----------|----------|----------|----------|----------|----------|----------|----------|----------|
| ProPEX LF Brass Stop and Drain Ball Valve (full port), 1" PEX x 1" PEX     | LFD4811010 | 1.181    | 1.65     | 2.043    | 4.503    | 0.689    | 0.846    | 6.487    | 2.731    | 2.134    | 4.012    |
| ProPEX LF Brass Stop and Drain Ball Valve (full port), 1/2" PEX x 1/2" PEX | LFD4815050 | 0.709    | 1.24     | 1.44     | 3.361    | 0.394    | 0.63     | 4.68     | 1.834    | 1.459    | 2.657    |
| ProPEX LF Brass Stop and Drain Ball Valve (full port), 3/4" PEX x 3/4" PEX | LFD4817575 | 0.945    | 1.398    | 1.621    | 2.784    | 0.531    | 0.65     | 4.976    | 2.153    | 1.839    | 3.287    |
| ProPEX LF Brass Ball Valve (full port), 1" PEX x 1" PEX                    | LFR4811010 | 1.181    | 1.374    | 2.043    | 4.503    | 0.689    | 0.571    | 6.487    | 2.731    | 1.772    | 3.736    |
| ProPEX LF Brass Ball Valve (full port), 1/2" PEX x 1/2" PEX                | LFR4815050 | 0.709    | 1.004    | 1.44     | 3.361    | 0.394    | 0.394    | 4.68     | 1.834    | 1.012    | 2.421    |
| ProPEX LF Brass Ball Valve (full port), 3/4" PEX x 3/4" PEX                | LFR4817575 | 0.945    | 1.13     | 1.621    | 3.348    | 0.531    | 0.447    | 4.976    | 2.153    | 1.339    | 3.02     |

| Part name  | Part no.   | Cv   | End Type 1  | End Type 2  | Weight per UOM [lbs/UOM] |
|--|------------|------|-------------|-------------|--------------------------|
| ProPEX LF Brass Stop and Drain Ball Valve (full port), 1" PEX x 1" PEX     | LFD4811010 | 25.2 | ProPEX 1"   | ProPEX 1"   | 0.78                     |
| ProPEX LF Brass Stop and Drain Ball Valve (full port), 1/2" PEX x 1/2" PEX | LFD4815050 | 5.7  | ProPEX 1/2" | ProPEX 1/2" | 0.3                      |
| ProPEX LF Brass Stop and Drain Ball Valve (full port), 3/4" PEX x 3/4" PEX | LFD4817575 | 11.1 | ProPEX 3/4" | ProPEX 3/4" | 0.45                     |
| ProPEX LF Brass Ball Valve (full port), 1" PEX x 1" PEX                    | LFR4811010 | 21.8 | ProPEX 1"   | ProPEX 1"   | 0.67                     |
| ProPEX LF Brass Ball Valve (full port), 1/2" PEX x 1/2" PEX                | LFR4815050 | 4.6  | ProPEX 1/2" | ProPEX 1/2" | 0.26                     |
| ProPEX LF Brass Ball Valve (full port), 3/4" PEX x 3/4" PEX                | LFR4817575 | 10.1 | ProPEX 3/4" | ProPEX 3/4" | 0.39                     |

| Part name   | Part no. | Codes                                 | Standards   | Listings             |
|---|----------|---------------------------------------|---|----------------------|
| ProPEX lead-free (LF) brass residential ball valves | All      | UPC IBC IRC IPC NPC of Canada UMC IMC | NSF/ANSI/CAN 372 ASTM F877 NSF/ANSI 359 ASTM F1960 CSA B137.5 NSF/ANSI/CAN 61 NSF/ANSI 14 | cNSFus-pw-G U.P.Code |

In addition, the following parts have additional codes, standards, or listings:

|  |            |
|--|------------|
| ProPEX LF Brass Stop and Drain Ball Valve (full port), 1/2" PEX x 1/2" PEX | LFD4815050 |
| ProPEX LF Brass Stop and Drain Ball Valve (full port), 3/4" PEX x 3/4" PEX | LFD4817575 |
| ProPEX LF Brass Ball Valve (full port), 1" PEX x 1" PEX                    | LFR4811010 |
| ProPEX LF Brass Ball Valve (full port), 1/2" PEX x 1/2" PEX                | LFR4815050 |

-

-

Footnotes

Contact information

-

Uponor Inc.  
5925 148th Street West  
Apple Valley, MN 55124  
T 800.321.4739  
F 952.891.2008

Uponor Ltd.  
6510 Kennedy Road  
Mississauga, ON L5T 2X4  
T 888.594.7726  
F 800.638.9517