

ProPEX lead-free (LF) brass residential ball valves

Project Information

| | |
|--------------------------------|-----------------|
| Job name: | Location: |
| Engineer: | Date submitted: |
| Contractor: | Submitted by: |
| Manufacturer's representative: | Approved by: |

Technical data

| | |
|-------------------------|--------------------------------------|
| Material | LF Brass |
| Temp/pressure ratings | 200 °F (93 °C) at 200 psi (13.8 bar) |
| Prop 65 label required? | Yes |

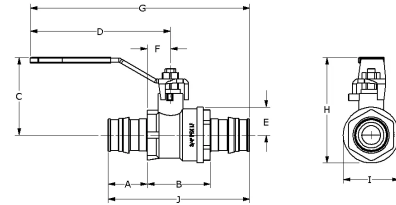

| Part name | Part no. | A [inch] | B [inch] | C [inch] | D [inch] | E [inch] | F [inch] | G [inch] | H [inch] | I [inch] | J [inch] |
|--|------------|----------|----------|----------|----------|----------|----------|----------|----------|----------|----------|
| ProPEX LF Brass Stop and Drain Ball Valve (full port), 1" PEX x 1" PEX | LFD4811010 | 1.181 | 1.65 | 2.043 | 4.503 | 0.689 | 0.846 | 6.487 | 2.731 | 2.134 | 4.012 |
| ProPEX LF Brass Stop and Drain Ball Valve (full port), 1/2" PEX x 1/2" PEX | LFD4815050 | 0.709 | 1.24 | 1.44 | 3.361 | 0.394 | 0.63 | 4.68 | 1.834 | 1.459 | 2.657 |
| ProPEX LF Brass Stop and Drain Ball Valve (full port), 3/4" PEX x 3/4" PEX | LFD4817575 | 0.945 | 1.398 | 1.621 | 2.784 | 0.531 | 0.65 | 4.976 | 2.153 | 1.839 | 3.287 |
| ProPEX LF Brass Ball Valve (full port), 1" PEX x 1" PEX | LFR4811010 | 1.181 | 1.374 | 2.043 | 4.503 | 0.689 | 0.571 | 6.487 | 2.731 | 1.772 | 3.736 |
| ProPEX LF Brass Ball Valve (full port), 1/2" PEX x 1/2" PEX | LFR4815050 | 0.709 | 1.004 | 1.44 | 3.361 | 0.394 | 0.394 | 4.68 | 1.834 | 1.012 | 2.421 |
| ProPEX LF Brass Ball Valve (full port), 3/4" PEX x 3/4" PEX | LFR4817575 | 0.945 | 1.13 | 1.621 | 3.348 | 0.531 | 0.447 | 4.976 | 2.153 | 1.339 | 3.02 |

| Part name | Part no. | Cv | End Type 1 | End Type 2 | Weight per UOM [lbs/UOM] |
|--|------------|------|-------------|-------------|--------------------------|
| ProPEX LF Brass Stop and Drain Ball Valve (full port), 1" PEX x 1" PEX | LFD4811010 | 25.2 | ProPEX 1" | ProPEX 1" | 0.78 |
| ProPEX LF Brass Stop and Drain Ball Valve (full port), 1/2" PEX x 1/2" PEX | LFD4815050 | 5.7 | ProPEX 1/2" | ProPEX 1/2" | 0.3 |
| ProPEX LF Brass Stop and Drain Ball Valve (full port), 3/4" PEX x 3/4" PEX | LFD4817575 | 11.1 | ProPEX 3/4" | ProPEX 3/4" | 0.45 |
| ProPEX LF Brass Ball Valve (full port), 1" PEX x 1" PEX | LFR4811010 | 21.8 | ProPEX 1" | ProPEX 1" | 0.67 |
| ProPEX LF Brass Ball Valve (full port), 1/2" PEX x 1/2" PEX | LFR4815050 | 4.6 | ProPEX 1/2" | ProPEX 1/2" | 0.26 |
| ProPEX LF Brass Ball Valve (full port), 3/4" PEX x 3/4" PEX | LFR4817575 | 10.1 | ProPEX 3/4" | ProPEX 3/4" | 0.39 |

| Part name | Part no. | Codes | Standards | Listings |
|---|----------|---------------------------------------|---|----------------------|
| ProPEX lead-free (LF) brass residential ball valves | All | UPC IBC IRC IPC NPC of Canada UMC IMC | NSF/ANSI/CAN 372 ASTM F877 NSF/ANSI 359 ASTM F1960 CSA B137.5 NSF/ANSI/CAN 61 NSF/ANSI 14 | cNSFus-pw-G U.P.Code |

In addition, the following parts have additional codes, standards, or listings:

| | |
|--|------------|
| ProPEX LF Brass Stop and Drain Ball Valve (full port), 1/2" PEX x 1/2" PEX | LFD4815050 |
| ProPEX LF Brass Stop and Drain Ball Valve (full port), 3/4" PEX x 3/4" PEX | LFD4817575 |
| ProPEX LF Brass Ball Valve (full port), 1" PEX x 1" PEX | LFR4811010 |
| ProPEX LF Brass Ball Valve (full port), 1/2" PEX x 1/2" PEX | LFR4815050 |

-

-

Footnotes

Contact information

-

Uponor Inc.
5925 148th Street West
Apple Valley, MN 55124
T 800.321.4739
F 952.891.2008

Uponor Ltd.
6510 Kennedy Road
Mississauga, ON L5T 2X4
T 888.594.7726
F 800.638.9517