

# ProPEX lead-free (LF) brass residential ball valves

## Project Information

Job name:	Location:
Engineer:	Date submitted:
Contractor:	Submitted by:
Manufacturer's representative:	Approved by:

## Technical data

Material	LF Brass
Temp/pressure ratings	200 °F (93 °C) at 200 psi (13.8 bar)
Prop 65 label required?	Yes

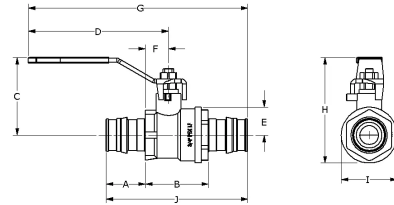

Part name	Part no.	A [inch]	B [inch]	C [inch]	D [inch]	E [inch]	F [inch]	G [inch]	H [inch]	I [inch]	J [inch]
ProPEX LF Brass Stop and Drain Ball Valve (full port), 1" PEX x 1" PEX	LFD4811010	1.181	1.65	2.043	4.503	0.689	0.846	6.487	2.731	2.134	4.012
ProPEX LF Brass Stop and Drain Ball Valve (full port), 1/2" PEX x 1/2" PEX	LFD4815050	0.709	1.24	1.44	3.361	0.394	0.63	4.68	1.834	1.459	2.657
ProPEX LF Brass Stop and Drain Ball Valve (full port), 3/4" PEX x 3/4" PEX	LFD4817575	0.945	1.398	1.621	2.784	0.531	0.65	4.976	2.153	1.839	3.287
ProPEX LF Brass Ball Valve (full port), 1" PEX x 1" PEX	LFR4811010	1.181	1.374	2.043	4.503	0.689	0.571	6.487	2.731	1.772	3.736
ProPEX LF Brass Ball Valve (full port), 1/2" PEX x 1/2" PEX	LFR4815050	0.709	1.004	1.44	3.361	0.394	0.394	4.68	1.834	1.012	2.421
ProPEX LF Brass Ball Valve (full port), 3/4" PEX x 3/4" PEX	LFR4817575	0.945	1.13	1.621	3.348	0.531	0.447	4.976	2.153	1.339	3.02

Part name	Part no.	Cv	End Type 1	End Type 2	Weight per UOM [lbs/UOM]
ProPEX LF Brass Stop and Drain Ball Valve (full port), 1" PEX x 1" PEX	LFD4811010	25.2	ProPEX 1"	ProPEX 1"	0.78
ProPEX LF Brass Stop and Drain Ball Valve (full port), 1/2" PEX x 1/2" PEX	LFD4815050	5.7	ProPEX 1/2"	ProPEX 1/2"	0.3
ProPEX LF Brass Stop and Drain Ball Valve (full port), 3/4" PEX x 3/4" PEX	LFD4817575	11.1	ProPEX 3/4"	ProPEX 3/4"	0.45
ProPEX LF Brass Ball Valve (full port), 1" PEX x 1" PEX	LFR4811010	21.8	ProPEX 1"	ProPEX 1"	0.67
ProPEX LF Brass Ball Valve (full port), 1/2" PEX x 1/2" PEX	LFR4815050	4.6	ProPEX 1/2"	ProPEX 1/2"	0.26
ProPEX LF Brass Ball Valve (full port), 3/4" PEX x 3/4" PEX	LFR4817575	10.1	ProPEX 3/4"	ProPEX 3/4"	0.39

Part name	Part no.	Codes	Standards	Listings
ProPEX lead-free (LF) brass residential ball valves	All	UPC IBC IRC IPC NPC of Canada UMC IMC	NSF/ANSI/CAN 372 ASTM F877 NSF/ANSI 359 ASTM F1960 CSA B137.5 NSF/ANSI/CAN 61 NSF/ANSI 14	cNSFus-pw-G U.P.Code

In addition, the following parts have additional codes, standards, or listings:

ProPEX LF Brass Stop and Drain Ball Valve (full port), 1/2" PEX x 1/2" PEX	LFD4815050
ProPEX LF Brass Stop and Drain Ball Valve (full port), 3/4" PEX x 3/4" PEX	LFD4817575
ProPEX LF Brass Ball Valve (full port), 1" PEX x 1" PEX	LFR4811010
ProPEX LF Brass Ball Valve (full port), 1/2" PEX x 1/2" PEX	LFR4815050

-

-

Footnotes

Contact information

-

Uponor Inc.  
5925 148th Street West  
Apple Valley, MN 55124  
T 800.321.4739  
F 952.891.2008

Uponor Ltd.  
6510 Kennedy Road  
Mississauga, ON L5T 2X4  
T 888.594.7726  
F 800.638.9517