

Lead-free (LF) brass compression straight stop valves

Project information

Job name:	Location:
Engineer:	Date submitted:
Contractor:	Submitted by:
Manufacturer's representative:	Approved by:

Product information and application use

For point-of-use shutoff at the fixture, compression straight and angle stop valves are lead-free (LF) brass, chrome-plated, quarter-turn ball valves that include a stainless-steel insert for compression connection to 1/2" Uponor AquaPEX® pipe and a 3/8" male threaded connection for fixture risers.

Note: Temperature and pressure ratings stated are hydrostatic ratings. For domestic hot-water (DHW) and DHW recirculation installations, operating conditions should not exceed 140°F (60°C) at 80 psi (5.5 bar) in accordance with ASTM F2023. For additional information regarding application-specific temperature and pressure ratings, refer to the Uponor PEX Piping Systems Design and Installation Manual.

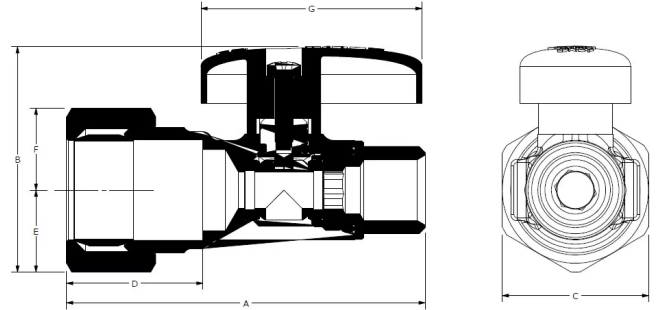

Part name	Part no.	A [inch]	B [inch]	C [inch]	Material group	Operating Temperature 1 [°F]	Operating Temperature 2 [°F]	Operating Temperature 3 [°F]	D [inch]	E [inch]	F [inch]
1/2" Insert (stainless steel)	F5400500	1	0.61	0.61	Stainless Steel	73 °F (23 °C) at 160 psi (23 °C)	180	200	-	-	-
LF Brass Compression Straight Stop Valve with PEX Stiffener, 1/2" Comp. x 3/8" OD Comp.	LF5425038	2.306	1.439	0.937	LF Brass	194 °F (23 °C) at 145 psi (23 °C)	-	-	0.88	0.52	0.52

Part name	Part no.	G [inch]	End Type 1	End Type 2	Prop 65 label required?	Weight per UOM [lbs/UOM]
1/2" Insert (stainless steel)	F5400500	-	-	-	-	0.01
LF Brass Compression Straight Stop Valve with PEX Stiffener, 1/2" Comp. x 3/8" OD Comp.	LF5425038	1.42	Compression	UNEF	Yes	0.21

Part name	Part no.	Codes	Standards	Listings
Lead-free (LF) brass compression straight stop valves	All	UPC IBC IRC IPC NPC of Canada UMC NSPC IMC	ASME A112.18.1 NSF/ANSI/CAN 372 ASTM F877 ASTM F1960 CSA B125 CSA B137.5 NSF/ANSI/CAN 61 NSF/ANSI 14	cNSFus-pw-G U.P.Code

Installation

Install valves according to local building code. Use only the stainless steel inserts supplied by Uponor with these compression stop valves. Substitution can result in valve connection failure. Do not dismantle. Refer to the Uponor PEX Piping Systems Design and Installation Manual or Uponor PEX Piping Systems Installation Guide for additional information. For rigid fixture riser connections, use the Uponor 3/8" OD Compression Nut and Nylon Sleeve (part number F5440380), sold separately.

Related applications

PEX-a Plumbing Systems

Footnotes

-

Contact information

Uponor Inc.
5925 148th Street West
Apple Valley, MN 55124
T 800.321.4739
F 952.891.2008

Uponor Ltd.
6510 Kennedy Road
Mississauga, ON L5T 2X4
T 888.594.7726
F 800.638.9517