

ProPEX manifold elbow adapters

Project Information

Job name:	Location:
Engineer:	Date submitted:
Contractor:	Submitted by:
Manufacturer's representative:	Approved by:

Technical data

Material	Brass
Temp/pressure ratings	73 °F (23 °C) at 160 psi (11 bar) 180 °F (82 °C) at 100 psi (6.9 bar) 200 °F (93 °C) at 80 psi (5.5 bar)
Prop 65 label required?	Yes

Product information and application use

Uponor ProPEX® Manifold Elbow Adapter threads into Uponor TruFLOW™ and Engineered Polymer (EP) Heating Manifolds to adapt to ProPEX connections in radiant heating and cooling applications.¹

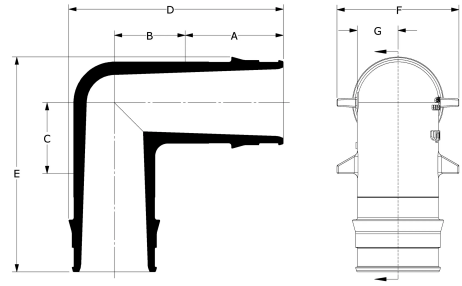

Part name	Part no.	A [Inch]	B [Inch]	C [Inch]	D [Inch]	E [Inch]	F [Inch]	End Type 1	End Type 2	Cv	Equivalent length branch [ft]
ProPEX Manifold Elbow Adapter, R32 x 3/4" ProPEX	Q4153275	0.945	0.9	1.15	2.663	2.33	1.635	ProPEX 3/4"	ISO 228-G 1-1/4"	-	-
ProPEX Manifold Elbow Adapter, R32 x 1" ProPEX	Q4153210	1.181	0.9	1.15	2.898	2.33	1.635	ProPEX 1"	ISO 228-G 1-1/4"	-	-
ProPEX Manifold Elbow Adapter, R32 x 1 1/4" ProPEX	Q4153213	1.445	0.85	1.3	3.113	2.775	1.635	ProPEX 1-1/4"	ISO 228-G 1-1/4"	-	-
ProPEX Manifold Elbow Adapter, R32 x 1 1/2" ProPEX	Q4153215	1.704	0.85	1.3	3.372	2.775	1.635	ProPEX 1-1/2"	ISO 228-G 1-1/4"	-	-
Commercial Stainless-steel Manifold ProPEX Male Elbow Adapter, 1 1/2" PEX x 1 1/2" NPT	A2791515	1.704	0.85	1.25	3.504	3.025	1.9	ProPEX 1-1/2"	MNPT 1-1/2"	29.5	12.4

Part name	Part no.	Weight per UOM [lbs/UOM]
ProPEX Manifold Elbow Adapter, R32 x 3/4" ProPEX	Q4153275	0.6
ProPEX Manifold Elbow Adapter, R32 x 1" ProPEX	Q4153210	0.62
ProPEX Manifold Elbow Adapter, R32 x 1 1/4" ProPEX	Q4153213	0.89
ProPEX Manifold Elbow Adapter, R32 x 1 1/2" ProPEX	Q4153215	0.91
Commercial Stainless-steel Manifold ProPEX Male Elbow Adapter, 1 1/2" PEX x 1 1/2" NPT	A2791515	1.06

Part name	Part no.	Codes	Standards	Listings
ProPEX manifold elbow adapters	All	IMC IRC NBC of Canada UMC	ASTM F1960 ASTM F877	cNSFus-rfh

In addition, the following parts have additional codes, standards, or listings:

ProPEX Manifold Elbow Adapter, R32 x 3/4" ProPEX	Q4153275	R32: ISO 228-G 1 1/4"
ProPEX Manifold Elbow Adapter, R32 x 1" ProPEX	Q4153210	R32: ISO 228-G 1 1/4"
ProPEX Manifold Elbow Adapter, R32 x 1 1/4" ProPEX	Q4153213	R32: ISO 228-G 1 1/4"
ProPEX Manifold Elbow Adapter, R32 x 1 1/2" ProPEX	Q4153215	R32: ISO 228-G 1 1/4"
Commercial Stainless-steel Manifold ProPEX Male Elbow Adapter, 1 1/2" PEX x 1 1/2" NPT	A2791515	CSA B137.5 NSF/ANSI 14 ICC-ES-PMG ICC-ES-PMG 1012

Installation

R32 threads into the Uponor TruFLOW and EP Heating Manifolds. ProPEX end enables direct, 90-degree contact to Uponor PEX-a tubing. For additional information, refer to the Uponor Radiant Floor Heating Installation Handbook.

Related applications

Radiant Heating and Cooling Systems

Footnotes

-

Contact information

Uponor Inc.
5925 148th Street West
Apple Valley, MN 55124
T 800.321.4739
F 952.891.2008

Uponor Ltd.
6510 Kennedy Road
Mississauga, ON L5T 2X4
T 888.594.7726
F 800.638.9517