

Copper valved manifold accessories - ProPEX ball valves

Project Information

Job name:	Location:
Engineer:	Date submitted:
Contractor:	Submitted by:
Manufacturer's representative:	Approved by:

Technical data

Material	Brass
Subcomponent Material	CA 360 Brass
End type 2	Sweat 3/4"
Cold working pressure	249.5 psi
Temp/pressure ratings	73 °F (23 °C) at 160 psi (11 bar)
	180 °F (82 °C) at 100 psi (6.9 bar)
	200 °F (93 °C) at 80 psi (5.5 bar)
Prop 65 label required?	Yes

Product information and application use

The Uponor ProPEX® Ball Valve products include 3/4" copper adapters and feature in-line isolation valves.¹

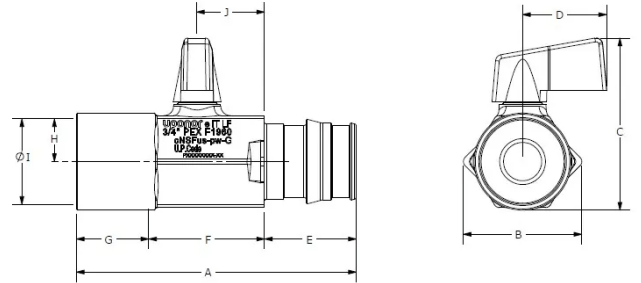

Part name	Part no.	A [inch]	B [inch]	C [inch]	D [inch]	E [inch]	F [inch]	G [inch]	H [inch]	I [inch]	J [inch]
ProPEX Ball Valve, 5/8" PEX x 3/4" Copper Adapter	Q5806375	2.776	1.364	1.846	0.866	0.866	1.157	0.752	0.439	0.879	0.492
ProPEX Ball Valve, 3/4" PEX x 3/4" Copper Adapter	Q5807575	2.854	1.364	1.846	0.866	0.945	1.157	0.752	0.439	0.879	0.492

Part name	Part no.	End Type 1	Weight per UOM [lbs/UOM]
ProPEX Ball Valve, 5/8" PEX x 3/4" Copper Adapter	Q5806375	ProPEX 5/8"	0.38
ProPEX Ball Valve, 3/4" PEX x 3/4" Copper Adapter	Q5807575	ProPEX 3/4"	0.39

Part name	Part no.	Codes	Standards	Listings
Copper valved manifold accessories - ProPEX ball valves	All	-	CSA B125 ASTM F1960 ASME A112.18.1 ASTM F877	-

Installation

Install valve according to local building code. Do not dismantle. If soldering, aim flame away from fitting. For more information, refer to the Uponor Radiant Floor Installation Handbook.

Related applications

- Radiant Heating and Cooling Systems
- Permafrost Protection Systems
- Turf Conditioning Systems

Footnotes

Contact information

-	Uponor Inc. 5925 148th Street West Apple Valley, MN 55124 T 800.321.4739 F 952.891.2008	Uponor Ltd. 6510 Kennedy Road Mississauga, ON L5T 2X4 T 888.594.7726 F 800.638.9517
---	---	---