

ProPEX lead-free (LF) brass tees

Project Information

Job name:	Location:
Engineer:	Date submitted:
Contractor:	Submitted by:
Manufacturer's representative:	Approved by:

Technical data

Material	LF Brass
Temp/pressure ratings	73 °F (23 °C) at 160 psi (11 bar) 180 °F (82 °C) at 100 psi (6.9 bar) 200 °F (93 °C) at 80 psi (5.5 bar)
Prop 65 label required?	Yes

Product information and application use

Uponor's ProPEX® Lead-free Brass Tees are ideal for use in hot and cold domestic potable water systems.1 This product is approved for use in the AquaSAFE™ Residential Fire Safety System. Also approved for any hydronic heating system application. Each end of the ProPEX LF Brass Tee is manufactured with the Uponor ProPEX Fitting for connections to Wirsbo hePEXTM or Uponor AquaPEX® tubing. This product is safe for direct burial in soil.

Note: Temperature and pressure ratings stated are hydrostatic ratings. For domestic hot-water (DHW) and DHW recirculation installations, operating conditions should not exceed 140°F (60°C) at 80 psi (5.5 bar) in accordance with ASTM F2023. For additional information regarding application-specific temperature and pressure ratings, refer to the Uponor PEX Piping Systems Design and Installation Manual.

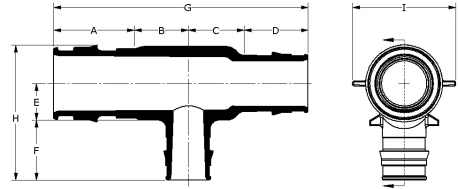

Part name	Part no.	A [inch]	B [inch]	C [inch]	D [inch]	E [inch]	F [inch]	G [inch]	H [inch]	I [inch]	Cv Through
ProPEX LF Brass Tee, 1/2" PEX x 1/2" PEX x 1/2" PEX	LF4705050	0.709	0.55	0.55	0.709	0.3	0.709	2.517	1.316	0.85	7.3
ProPEX LF Brass Tee, 3/4" PEX x 3/4" PEX x 3/4" PEX	LF4707575	0.945	0.689	0.689	0.945	0.406	0.945	3.268	1.789	1.2	19.6
ProPEX LF Brass Tee, 1" PEX x 1" PEX x 1" PEX	LF4701010	1.181	0.865	0.865	1.181	0.559	1.181	4.092	2.295	1.46	35

Part name	Part no.	Equivalent length branch [ft]	Equivalent length through [ft]	Cv Branch	End Type 1	End Type 2	End Type 3	Weight per UOM [lbs/UOM]
ProPEX LF Brass Tee, 1/2" PEX x 1/2" PEX x 1/2" PEX	LF4705050	5.12	1.15	3.7	ProPEX 1/2"	ProPEX 1/2"	ProPEX 1/2"	0.2
ProPEX LF Brass Tee, 3/4" PEX x 3/4" PEX x 3/4" PEX	LF4707575	4.91	0.8	9.4	ProPEX 3/4"	ProPEX 3/4"	ProPEX 3/4"	0.4
ProPEX LF Brass Tee, 1" PEX x 1" PEX x 1" PEX	LF4701010	5.92	0.83	16.2	ProPEX 1"	ProPEX 1"	ProPEX 1"	0.4

Part name	Part no.	Codes	Standards	Listings
ProPEX lead-free (LF) brass tees	All	UPC IBC IRC IPC NPC of Canada UMC NSPC IMC	NSF/ANSI/CAN 372 ASTM F877 ASTM F1960 CSA B137.5 NSF/ANSI/CAN 61 NSF/ANSI 14	ICC-ES-PMG IAPMO 3558 U.P.Code

In addition, the following parts have additional codes, standards, or listings:

ProPEX LF Brass Tee, 1/2" PEX x 1/2" PEX x 1/2" PEX	LF4705050			cNSFus-pw-G
ProPEX LF Brass Tee, 3/4" PEX x 3/4" PEX x 3/4" PEX	LF4707575		UL 1821	cNSFus-pw-fs-G
ProPEX LF Brass Tee, 1" PEX x 1" PEX x 1" PEX	LF4701010		UL 1821	cNSFus-pw-fs-G

Installation

ProPEX Tool and ProPEX Rings (sold separately) are required for connecting the PEX tubing. Do not solder within 18 inches of the ProPEX connection. Refer to the AquaPEX Professional Plumbing Installation Guide, AquaSAFE Homeowner Handbook or Radiant Floor Heating Installation Handbook for additional information.

Related applications

PEX-a Plumbing Systems
Uponor Residential Fire Safety Systems
Radiant Heating and Cooling Systems

Uponor Inc.
5925 148th Street West
Apple Valley, MN 55124
T 800.321.4739
F 952.891.2008

Uponor Ltd.
6510 Kennedy Road
Mississauga, ON L5T 2X4
T 888.594.7726
F 800.638.9517
